

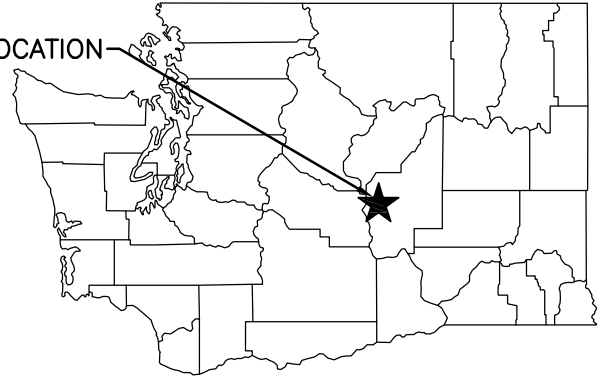

PROJECT LOCATION

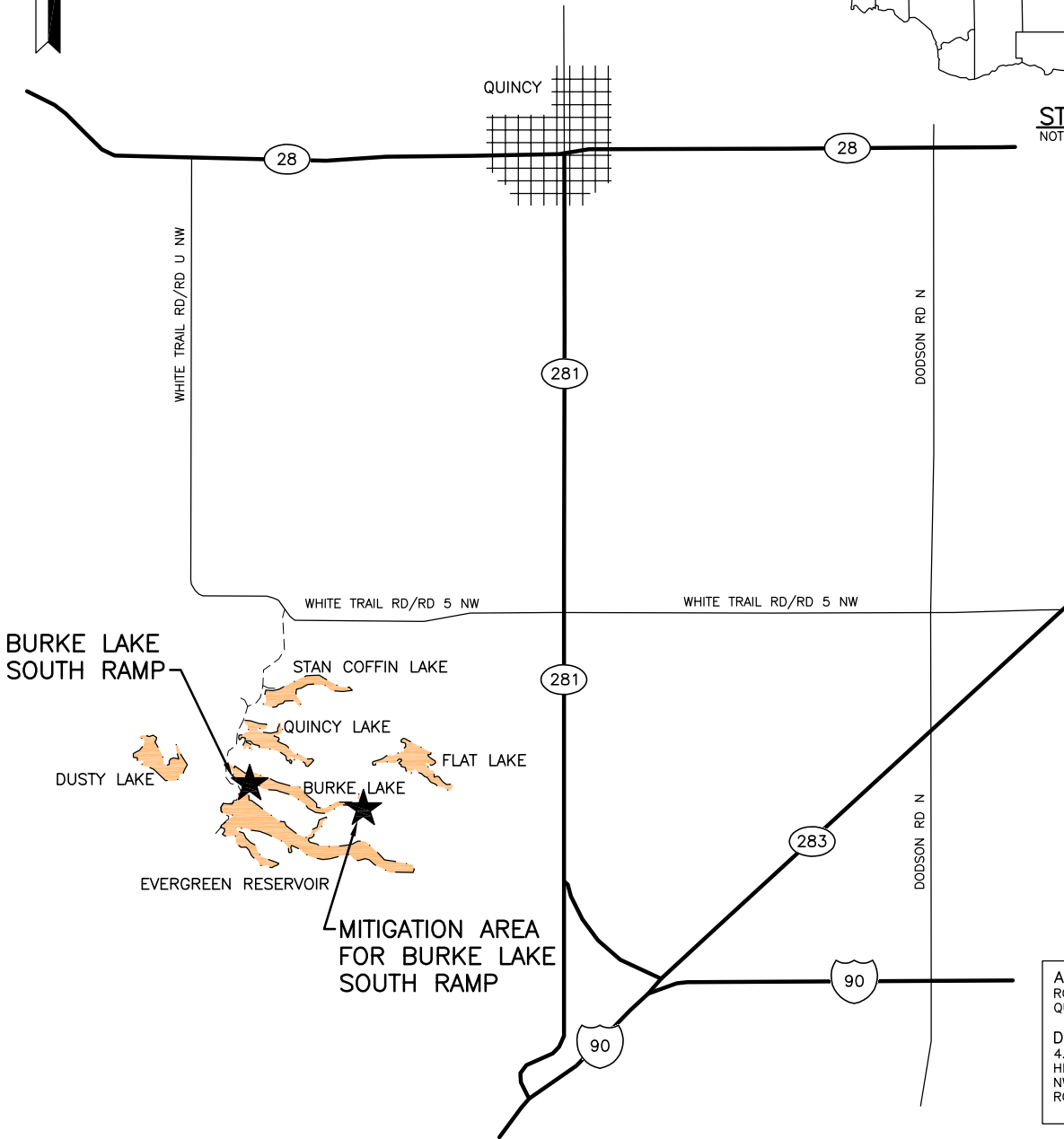

STATE MAP  
NOT TO SCALE



ADDRESS:  
ROAD 5 NW  
QUINCY, WA 98848

DIRECTIONS  
4.6 MILES SOUTH OF QUINCY ON  
HIGHWAY 281, RIGHT ONTO ROAD 5  
NW FOR 3.2 MILES, LEFT ONTO DIRT  
ROAD FOR 2.6 MILES

ENG. PROJECT NO. GT:A131:2020-1

PORTION OF: SEC 15, T 19N, R 23E, W.M

DRAWN BY: D. HENNING

REFERENCE NUMBER:  
APPLICANT:  
WASHINGTON DEPT. of FISH & WILDLIFE  
600 CAPITOL WAY N.  
OLYMPIA, WA 98501-1091

PROJECT LOCATION (ADDRESS):  
BURKE LAKE SOUTH ACCESS  
ROAD 5 NW  
QUINCY, WA 98848

PROPOSED PROJECT:  
ACCESS REDEVELOPMENT

ADJACENT PROPERTY OWNER:

LAT/LONG: 47.1342/-119.9257

IN: BURKE LAKE

1.  
2.

DATUM: NAVD88

NEAR/AT: QUINCY

SHEET 1 OF 15 DATE: 12/30/2020

COUNTY: GRANT

STATE: WA

BURKE LAKE

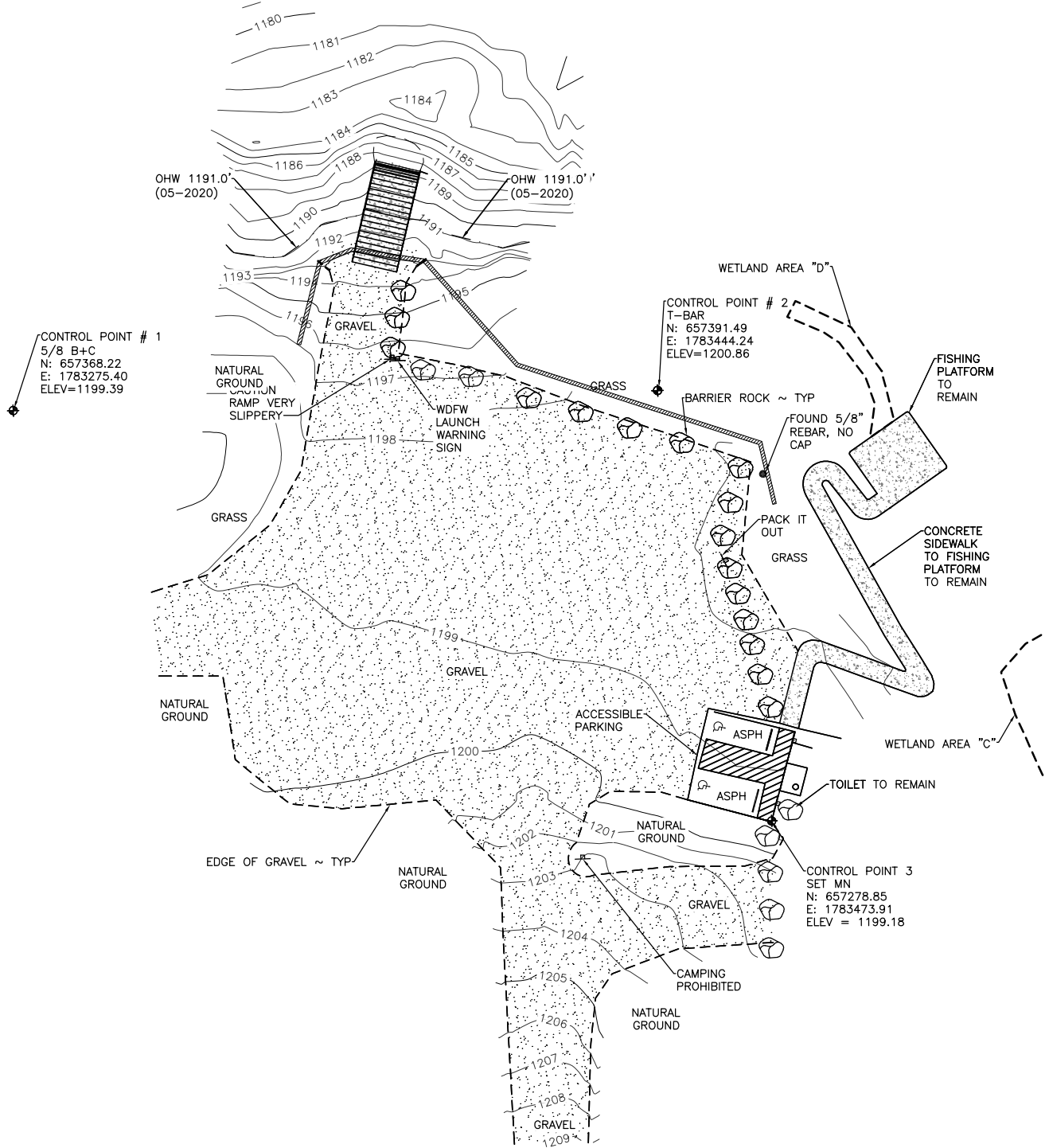

**EXISTING PLAN**

SCALE: 1" = 40'

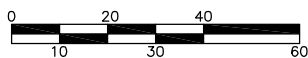

SCALE: 1" = 40'

REFERENCE NUMBER:

APPLICANT NAME:

WASHINGTON DEPT. of FISH & WILDLIFE

PROPOSED PROJECT:

BURKE LAKE SOUTH ACCESS REDEVELOPMENT

LOCATION: BURKE LAKE

SHEET 2 OF 15 DATE: 12/30/2020

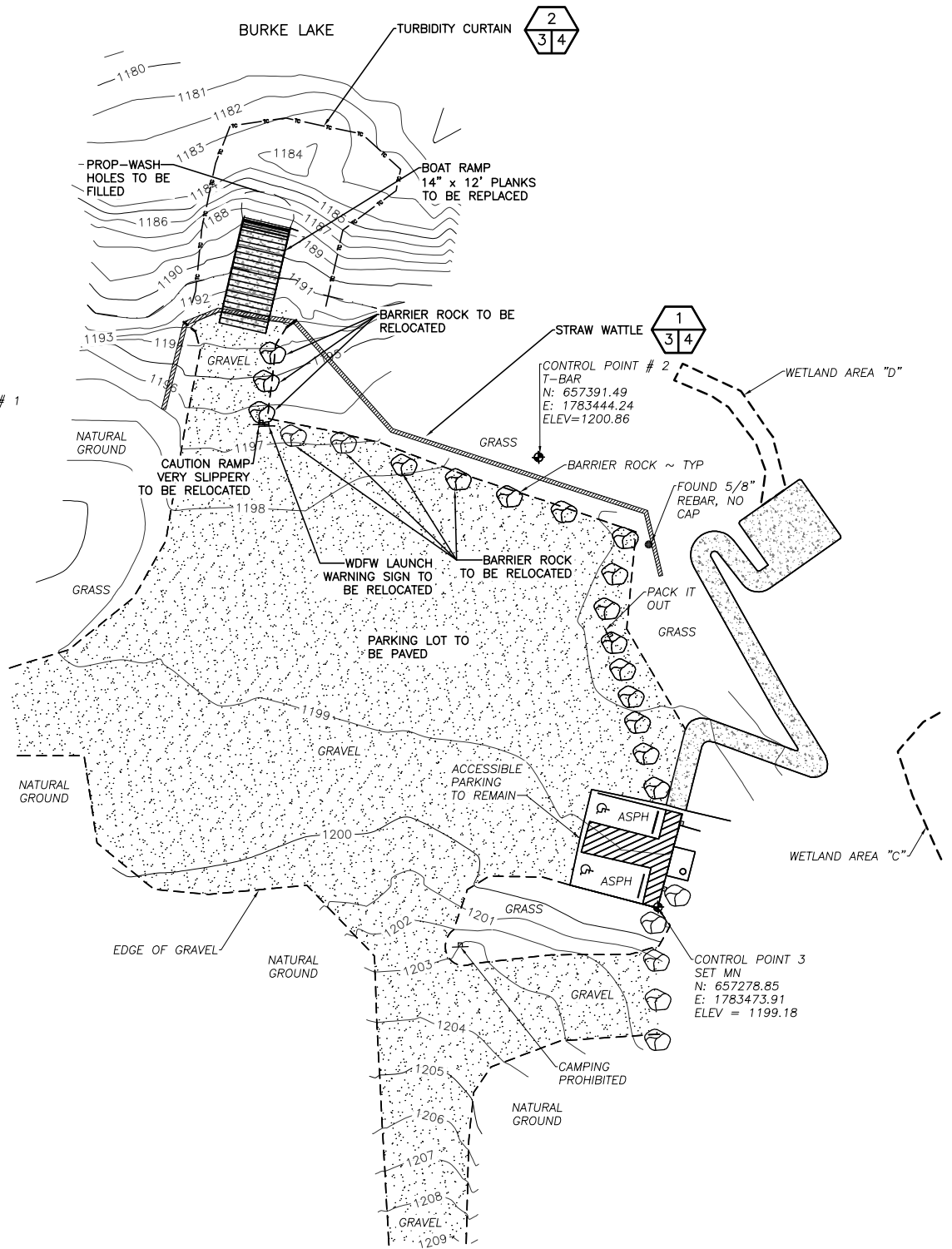

**DEMOLITION AND EROSION CONTROL PLAN**

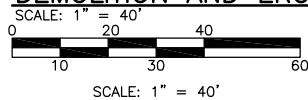

REFERENCE NUMBER:  
 APPLICANT NAME:  
 WASHINGTON DEPT. of FISH & WILDLIFE  
 PROPOSED PROJECT:  
 BURKE LAKE SOUTH ACCESS REDEVELOPMENT  
 LOCATION: BURKE LAKE  
 SHEET 3 OF 15 DATE: 12/30/2020

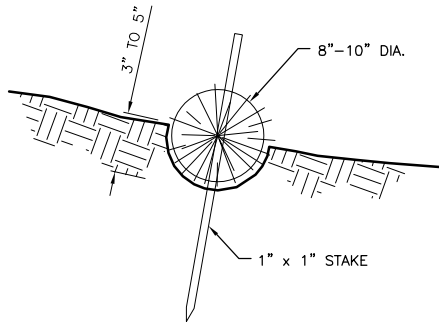

### STRAW WATTLE DETAIL

NOT TO SCALE



#### CONSTRUCTION SPECIFICATIONS:

1. PREPARE THE SLOPE BEFORE THE WATTLEING PROCEDURE IS STARTED.
2. SMOOTH SHALLOW GULLIES AS WORK PROGRESSES.
3. DIG SMALL TRENCHES ACROSS THE SLOPE ON CONTOUR, TO PLACE ROLLS IN. THE TRENCH SHOULD BE DEEP ENOUGH TO ACCOMMODATE HALF THE THICKNESS OF THE ROLL. WHEN THE SOIL IS LOOSE AND UNCOMPACTED, THE TRENCH SHOULD BE DEEP ENOUGH TO BURY THE ROLL 2/3 OF ITS THICKNESS BECAUSE THE GROUND WILL SETTLE.
4. ROLLS SHALL BE INSTALLED PERPENDICULAR TO WATER MOVEMENT, PARALLEL TO THE SLOPE CONTOUR.
5. BUILD TRENCHES AND INSTALL ROLLS FROM THE BOTTOM OF THE SLOPE AND WORK UP.
6. CONSTRUCT TRENCHES AT CONTOUR INTERVALS 3-12 FEET APART DEPENDING ON STEEPNESS OF SLOPE. THE STEEPER THE SLOPE, THE CLOSER TOGETHER THE TRENCHES. 1:1=10' 2:1=20' 3:1=30' 4:1=40'
7. LAY THE ROLL ALONG THE TRENCHES FITTING IT SNUGLY AGAINST THE SOIL. MAKE SURE NO GAPS EXIST BETWEEN THE SOIL AND THE STRAW WATTLE.
8. USE A STRAIGHT BAR TO DRIVE HOLES THROUGH THE WATTLE AND INTO THE SOIL FOR THE WILLOW OR WOODEN STAKES.
9. DRIVE THE STAKE THROUGH PREPARED HOLE INTO SOIL. LEAVE ONLY 1 OR 2 INCHES OF STAKE EXPOSED ABOVE ROLL.
10. IF USING WILLOW STAKES REFER TO LIVE STAKING BEST MANAGEMENT PRACTICES.
11. INSTALL STAKES AT LEAST EVERY 4 FEET APART THROUGH THE WATTLE. ADDITIONAL STAKES MAY BE DRIVEN ON THE DOWNSLOPE SIDE OF THE TRENCHES ON HIGHLY EROSION OR VERY STEEP SLOPES.
12. INSPECT THE STRAW ROLLS AND THE SLOPES AFTER SIGNIFICANT STORMS. MAKE SURE THE ROLLS ARE IN CONTACT WITH THE SOIL.
13. REPAIR ANY RILLS OR GULLIES PROMPTLY.
14. RESEED OR REPLANT VEGETATION IF NECESSARY UNTIL SLOPES ARE STABILIZED.

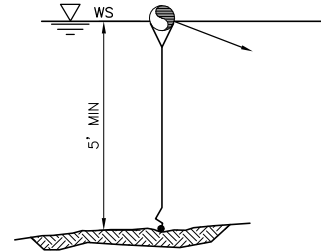

### TURBIDITY CURTAIN

NOT TO SCALE



REFERENCE NUMBER:

APPLICANT NAME:

WASHINGTON DEPT. of FISH & WILDLIFE

PROPOSED PROJECT:

BURKE LAKE SOUTH ACCESS REDEVELOPMENT

LOCATION: BURKE LAKE

SHEET 4 OF 15 DATE: 12/30/2020

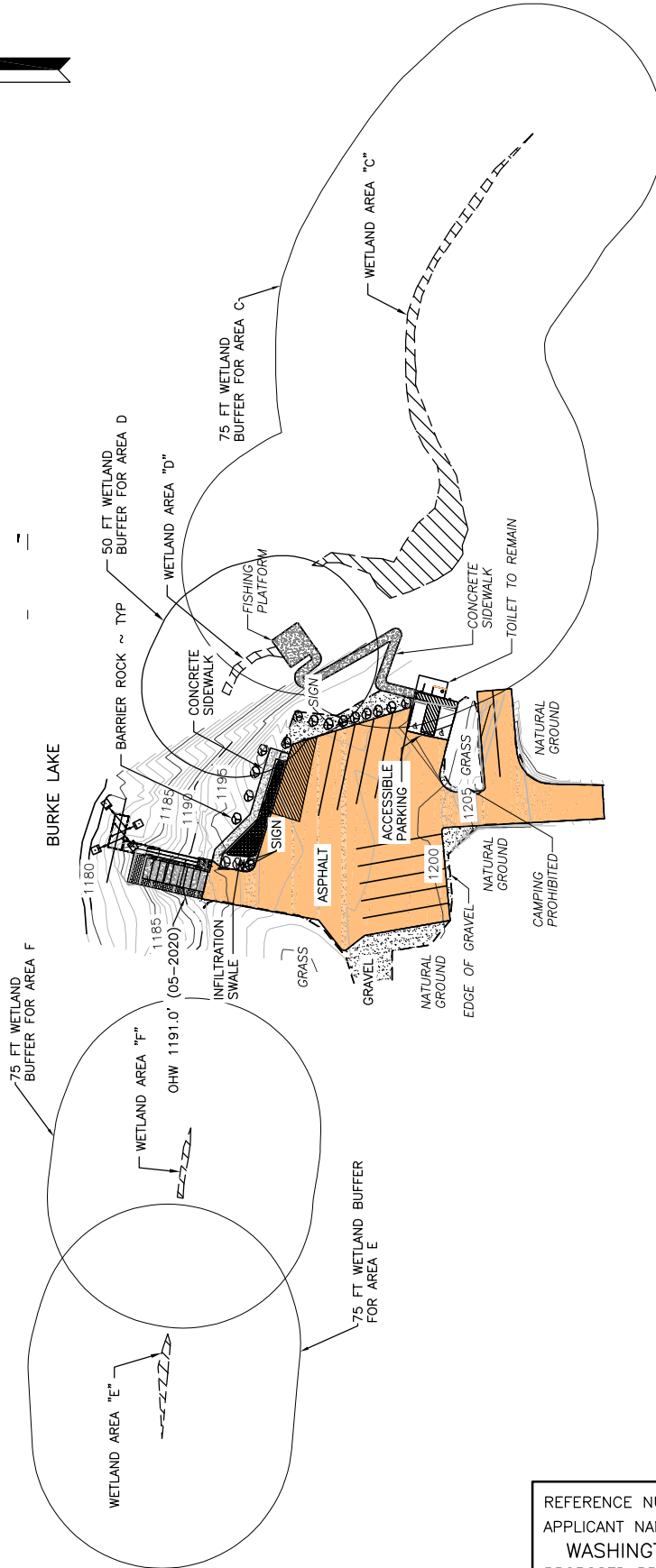

**OVERALL SITE PLAN**

SCALE: 1" = 100'



SCALE: 1" = 100'

REFERENCE NUMBER:  
 APPLICANT NAME:  
 WASHINGTON DEPT. of FISH & WILDLIFE  
 PROPOSED PROJECT:  
 BURKE LAKE SOUTH ACCESS REDEVELOPMENT  
 LOCATION: BURKE LAKE  
 SHEET 5 OF 15 DATE: 12/30/2020

**NOTE:**

1. SEE PAGE 10 FOR CUT AND FILL TABLE AND S.F.
2. SEE PAGE 14 FOR MITIGATION PLAN

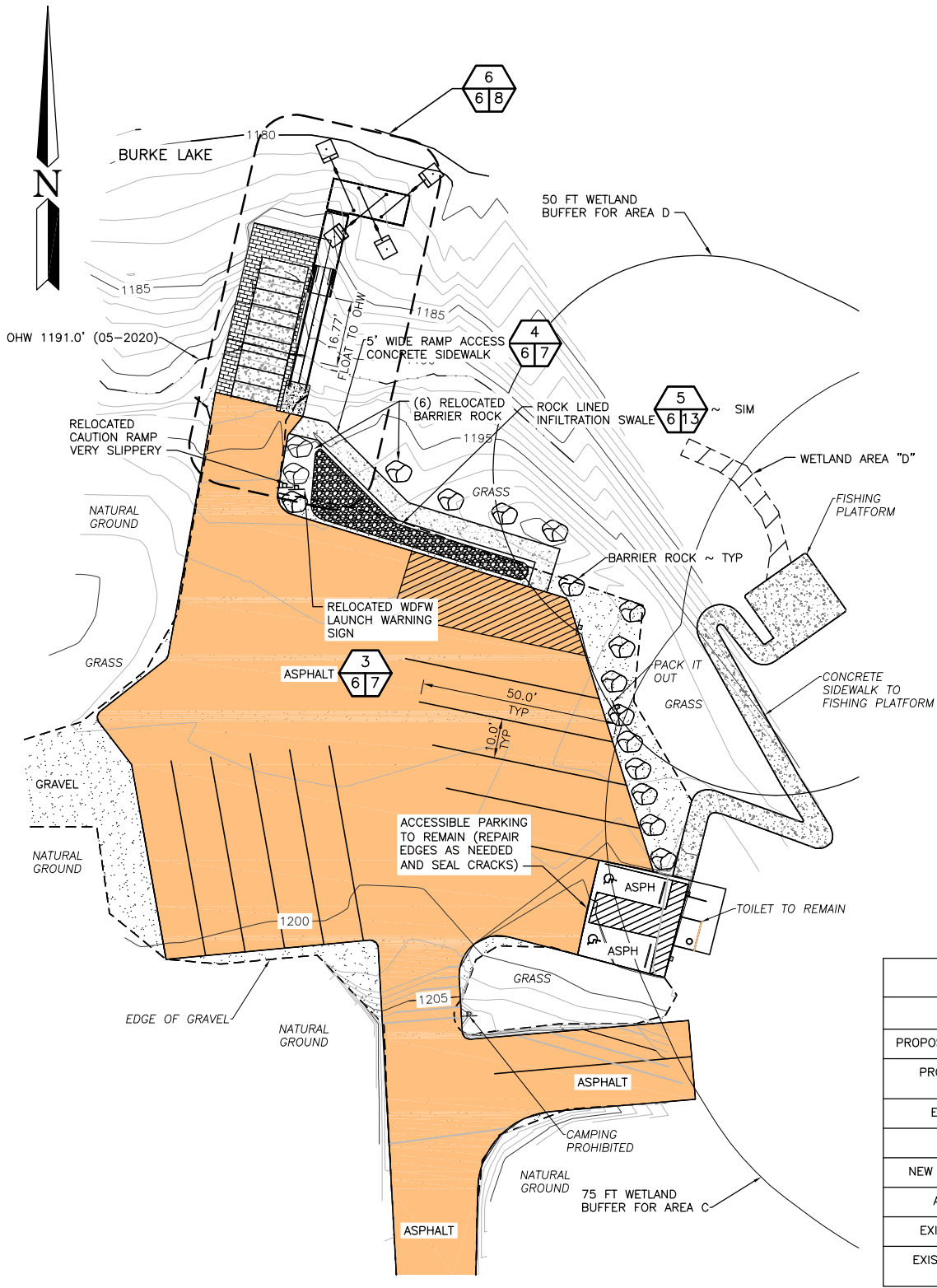

IMPERVIOUS AREAS	
AREA	TOTAL
PROPOSED PARKING ASPHALT	15,295 SF
PROPOSED CONCRETE SIDEWALK	414 SF
EXISTING ASPHALT	702 SF
EXISTING RAMP	328 SF
NEW REPLACEMENT RAMP	437 SF
ARTICULATED MAT	430 SF
EXISTING GRAVEL LOT	17,883 SF
EXISTING SIDEWALK AND PLATFORM	1,037 SF

NOTE: REFERENCE SHEET 10

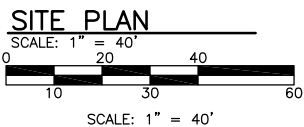

REFERENCE NUMBER:  
 APPLICANT NAME:  
 WASHINGTON DEPT. of FISH & WILDLIFE  
 PROPOSED PROJECT:  
 BURKE LAKE SOUTH ACCESS REDEVELOPMENT  
 LOCATION: BURKE LAKE  
 SHEET 6 OF 15 DATE: 12/30/2020

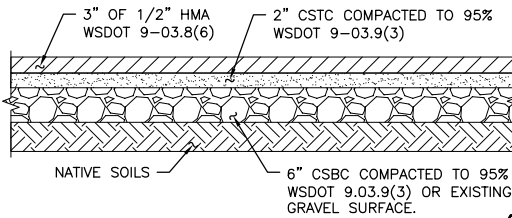

**TYPICAL ASPHALT DETAIL**

NOT TO SCALE

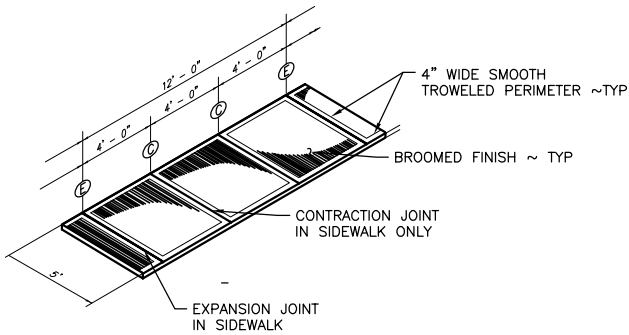

**WALKWAY DETAIL**

NOT TO SCALE

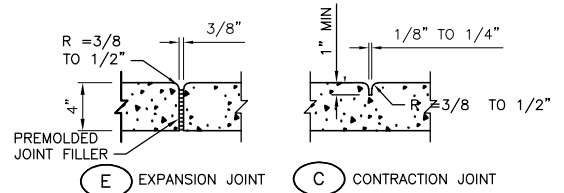

**DETAIL**

NOT TO SCALE

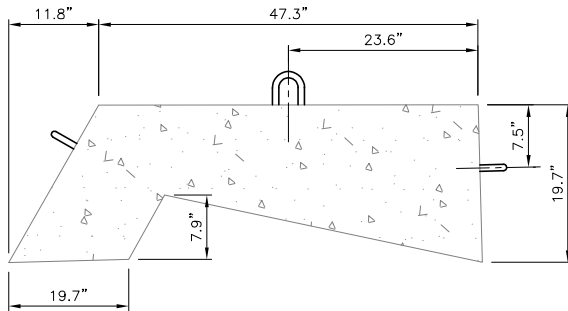

SIDE

**CONCRETE ANCHOR**

NOT TO SCALE

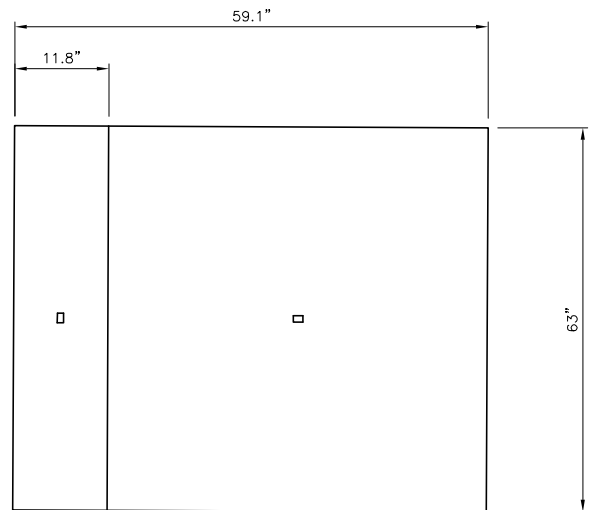

TOP

**CONCRETE ANCHOR**

NOT TO SCALE

REFERENCE NUMBER:  
 APPLICANT NAME:  
 WASHINGTON DEPT. of FISH & WILDLIFE  
 PROPOSED PROJECT:  
 BURKE LAKE SOUTH ACCESS REDEVELOPMENT  
 LOCATION: BURKE LAKE  
 SHEET 7 OF 15 DATE: 12/30/2020

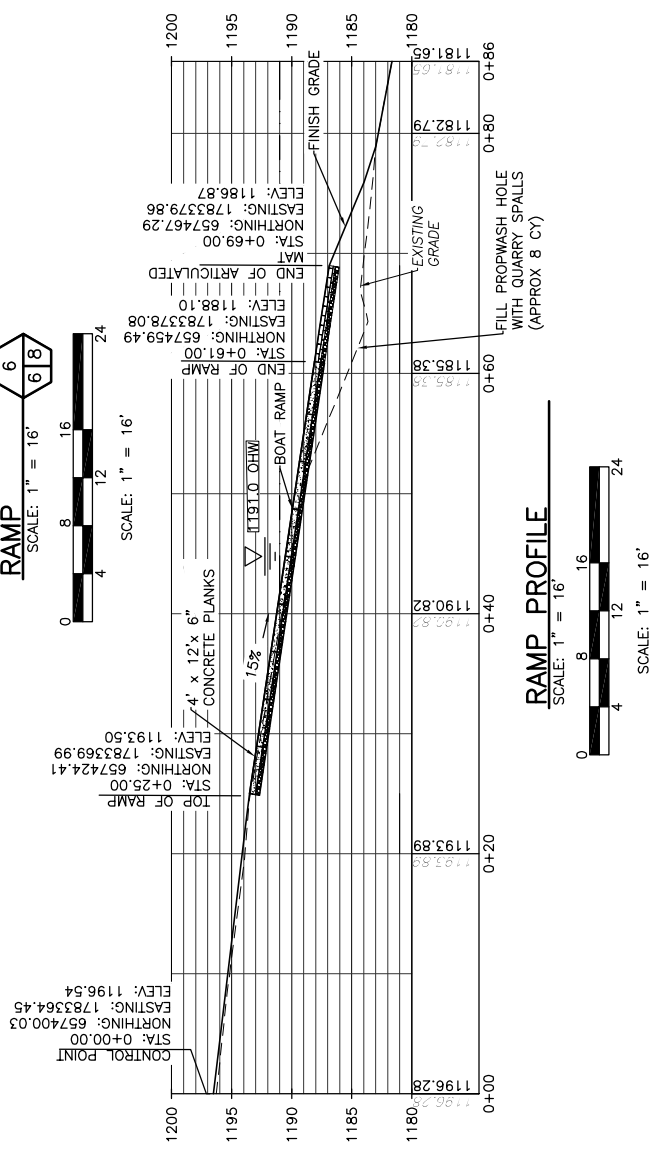
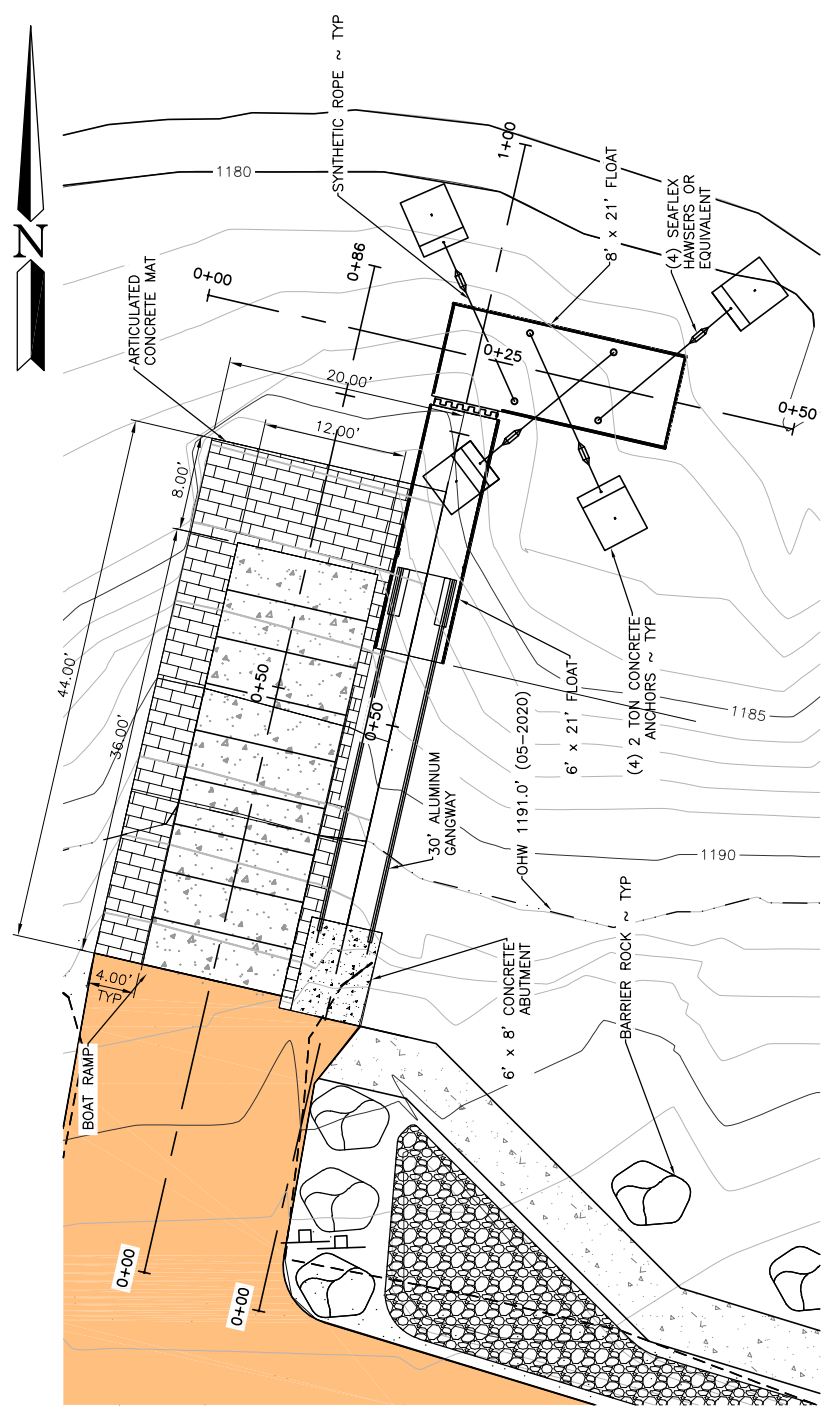



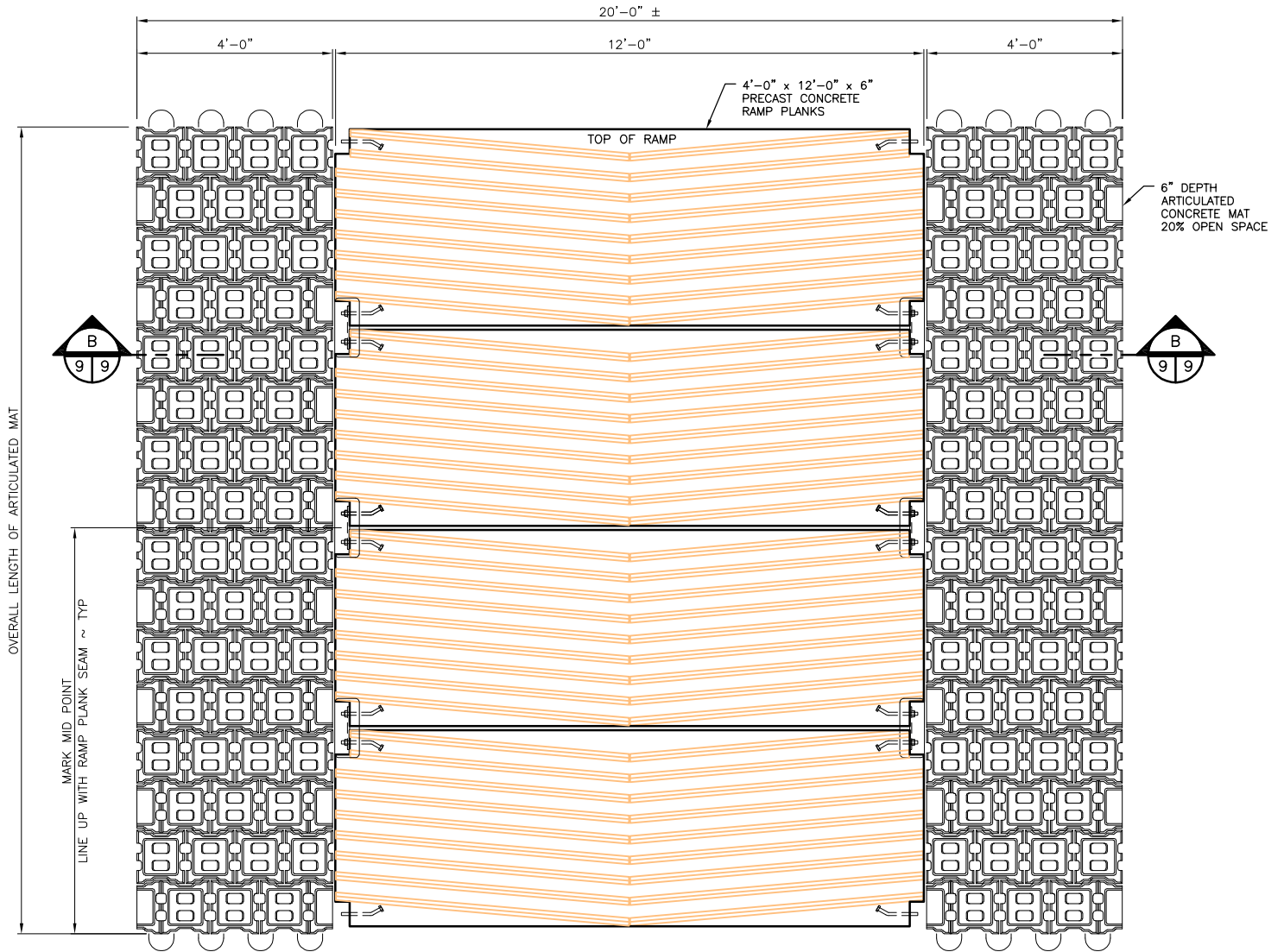

**TYPICAL RAMP PLANK PLAN**  
SCALE: 1" = 1'-0"

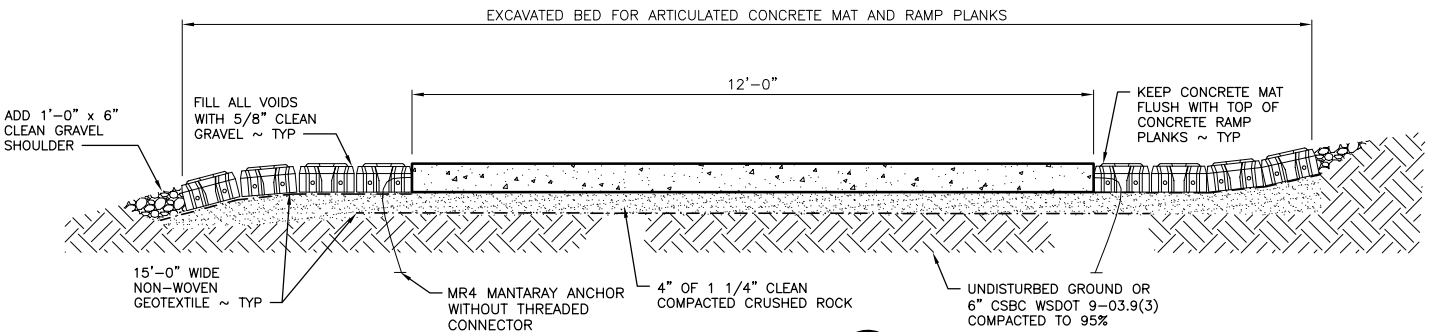

**RAMP PLANK**  
NOT TO SCALE



**NOTE:**

SEE SITE PLAN FOR SIZE AND LAYOUT OF ARTICULATED CONCRETE MATS

REFERENCE NUMBER:  
 APPLICANT NAME:  
 WASHINGTON DEPT. of FISH & WILDLIFE  
 PROPOSED PROJECT:  
 BURKE LAKE SOUTH ACCESS REDEVELOPMENT  
 LOCATION: BURKE LAKE  
 SHEET 9 OF 15 DATE: 12/30/2020

**OVERALL CUT AND FILL**

MATERIAL	ABOVE OHW		BELOW OHW		SQ FT OF IMPACT	
	CUT (CY)	FILL (CY)	CUT (CY)	FILL (CY)	ABOVE OHWM	BELOW OHWM
MIXED GRAVEL AND NATIVE MATERIAL	-535 CY	--	-7.0 CY	--	15,616 SF	603 SF
CSTC	--	95 CY	--	--	15,295 SF	--
CSBC	--	283.0 CY	--	--	15,295 SF	--
1-1/4" MINUS	--	3.12 CY	--	7.60 CY	253 SF	616 SF
HMA	--	142 CY	--	--	15,295 SF	--
EXISTING RAMP PLANKS	-3.2 CY	--	-2.9 CY	--	171 SF	157 SF
PROPOSED RAMP PLANKS	--	3.2 CY	--	4.9 CY	171 SF	266 SF
ARTICULATED MAT	--	1.5 CY	--	6.4 CY	83.2 SF	347 SF
QUARRY SPALLS	--	4.9 CY	--	8 CY	398 SF	144 SF
CONCRETE ABUTMENT	--	5 CY	--	--	48 SF	--
CONCRETE SIDEWALK	--	5.1 CY	--	--	414 SF	--
2 TON ANCHOR	--	--	--	6 CY	--	103 SF
TOTAL CUT/FILL CY/SF	-538.2 CY	542.82 CY	-9.9 CY	32.9 CY	63039.2 SF	2236 SF
NET	4.62 CY (FILL)		23 CY (FILL)			

IMPERVIOUS SURFACE	
AREA	TOTAL
EXISTING IMPERVIOUS SURFACE TOTAL:	19,542 SF
PROPOSED IMPERVIOUS SURFACE TOTAL	20,340 SF

REFERENCE NUMBER:  
 APPLICANT NAME:  
 WASHINGTON DEPT. of FISH & WILDLIFE  
 PROPOSED PROJECT:  
 BURKE LAKE SOUTH ACCESS REDEVELOPMENT  
 LOCATION: BURKE LAKE  
 SHEET 10 OF 15 DATE: 1//30/2020

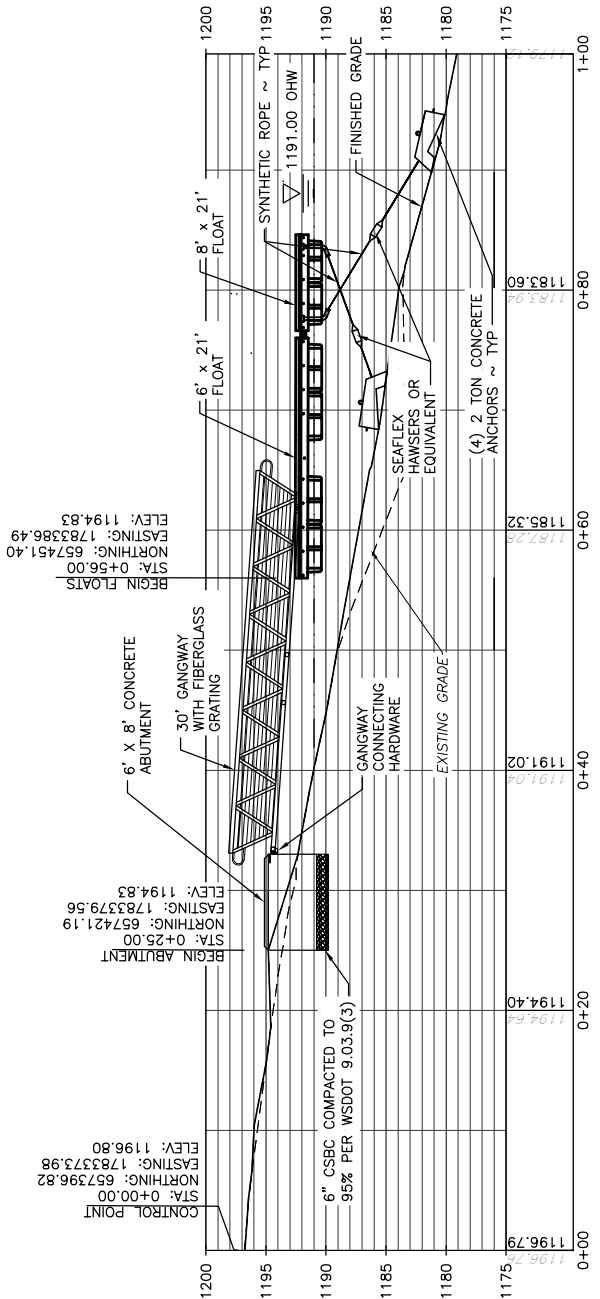

**FLOAT PROFILE**  
SCALE: 1" = 16'

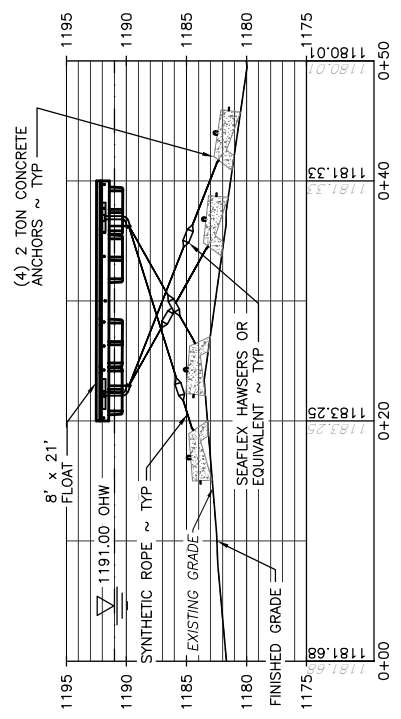

**SIDE FLOAT PROFILE**  
SCALE: 1" = 16'

REFERENCE NUMBER:  
 APPLICANT NAME:  
 WASHINGTON DEPT. of FISH & WILDLIFE  
 PROPOSED PROJECT:  
 BURKE LAKE SOUTH ACCESS REDEVELOPMENT  
 LOCATION: BURKE LAKE  
 SHEET 11 OF 15 DATE: 12/30/2020

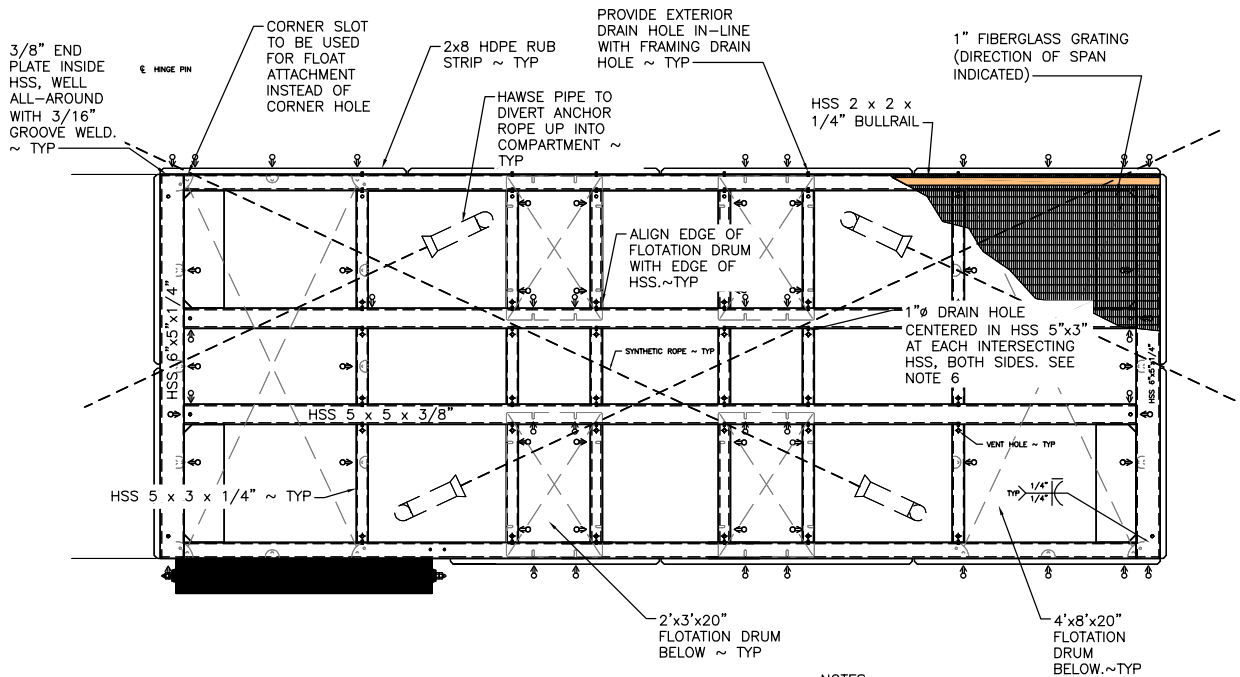

**8' WIDE END FLOAT**

SCALE: 1/4" = 1'

**NOTES:**

A. BULLRAIL, SCUPPER BLOCKS, WEEP HOLES, GROUNDING LEGS NOT SHOWN FOR CLARITY.

\* DIMENSION BASED ON FLOAT DRUM MANUFACTURER-PROVIDED INFORMATION CONTRACTOR TO VERIFY AS-BUILT FLOAT DRUM DIMENSIONS

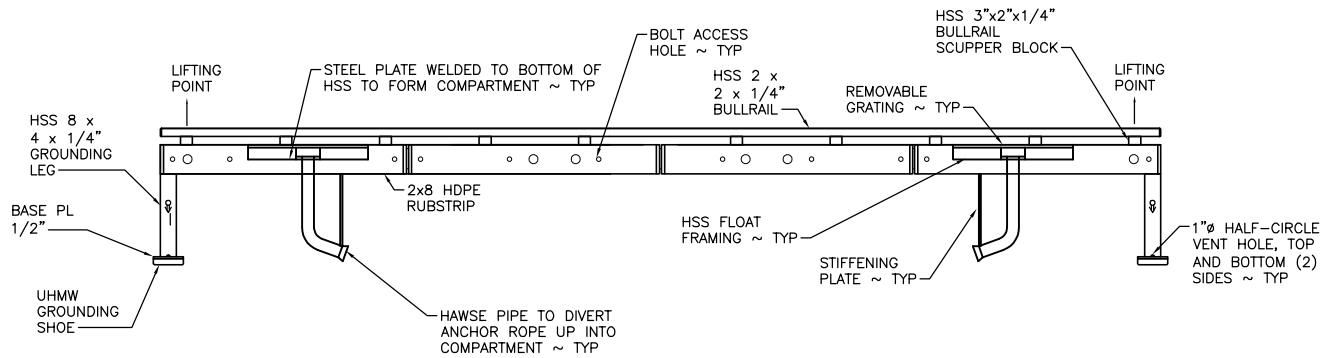

**8' WIDE END FLOAT ELEVATION**

SCALE: 1/4" = 1'

REFERENCE NUMBER:  
 APPLICANT NAME:  
 WASHINGTON DEPT. of FISH & WILDLIFE  
 PROPOSED PROJECT:  
 BURKE LAKE SOUTH ACCESS REDEVELOPMENT  
 LOCATION: BURKE LAKE  
 SHEET 12 OF 15 DATE: 12/30/2020

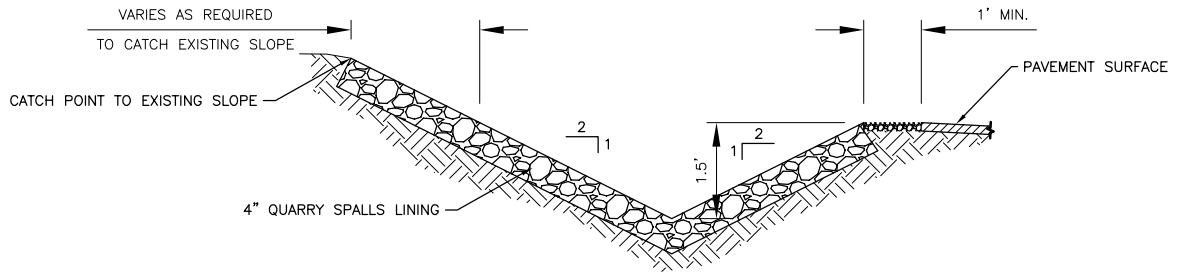





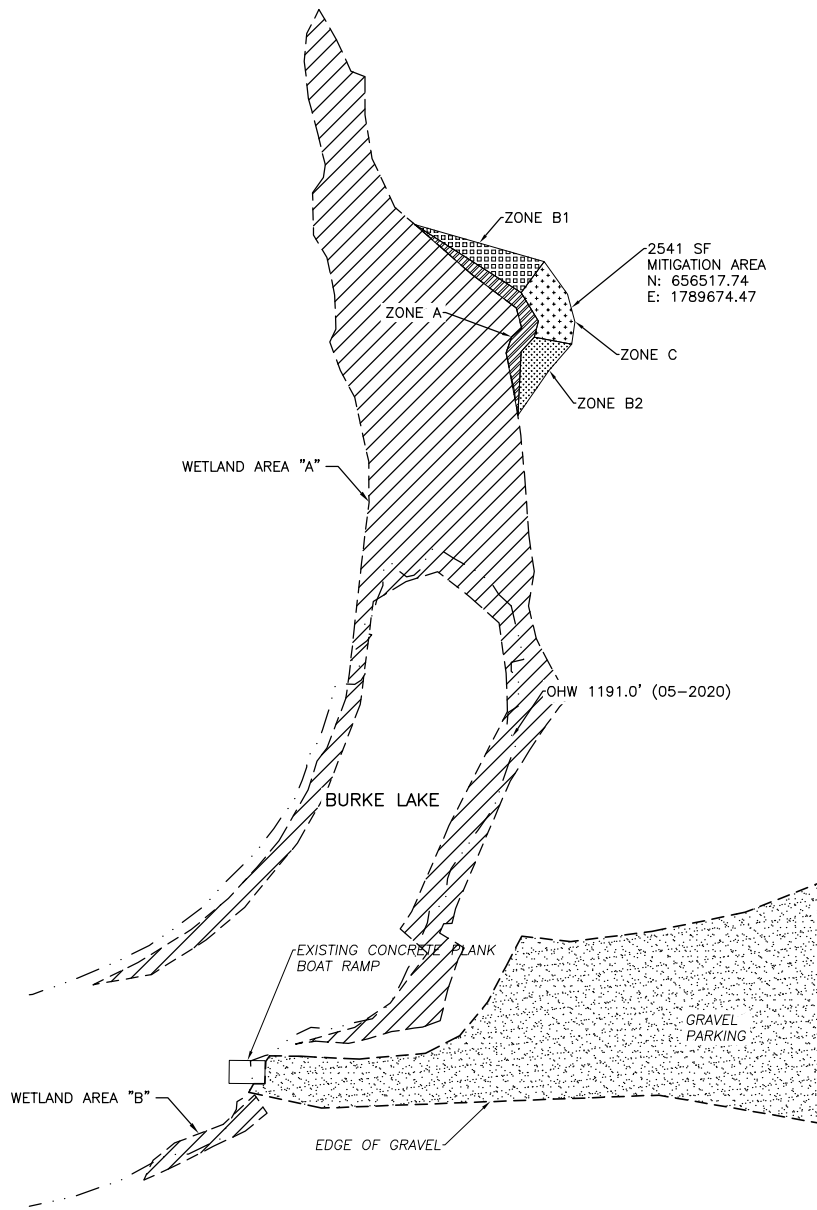

**ROCK LINED SWALE DETAIL** 5  
 NOT TO SCALE 6 | 13

REFERENCE NUMBER:  
 APPLICANT NAME:  
 WASHINGTON DEPT. of FISH & WILDLIFE  
 PROPOSED PROJECT:  
 BURKE LAKE SOUTH ACCESS REDEVELOPMENT  
 LOCATION: BURKE LAKE  
 SHEET 13 OF 15 DATE: 12/30/2020

NOTE: SEE PAGE 15 FOR PLANTING SCHEDULE



**LEGEND**

-  WETLAND
-  ZONE A (684 SF)
-  ZONE B1 (657 SF)
-  ZONE B2 (492 SF)
-  ZONE C (708 SF)
-  GRAVEL

**MITIGATION PLAN AT BURKE LAKE EAST RAMP**

SCALE: 1" = 100'

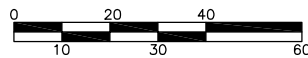

SCALE: 1" = 40'

REFERENCE NUMBER:  
 APPLICANT NAME:  
 WASHINGTON DEPT. of FISH & WILDLIFE  
 PROPOSED PROJECT:  
 BURKE LAKE SOUTH ACCESS REDEVELOPMENT  
 LOCATION: BURKE LAKE  
 SHEET 14 OF 15 DATE: 12/30/2020

**CONSTRUCTION NOTES:**

1. ORDER SPECIES WITH A PROVENANCE OR SEED SOURCE FROM COLUMBIA PLATEAU, EAST CASCADE SLOPE/FOOTHILLS, OR YAKIMA WHEN POSSIBLE. AVOID PLANTS WITH A SEED SOURCE FROM PUGET LOWLAND. OBTAIN TREES IN ONE GALLON CONTAINERS WHEN POSSIBLE.
2. SCARIFY GROUND SURFACE PRIOR TO PLANTING.
3. PLANT SPECIES IN APPROPRIATE ZONES. PLANT REMAINING HERBACEOUS AND SHRUB SPECIES EVENLY THROUGHOUT ZONE C.
4. MULCH GROUND SURFACE WITH FINE MULCH WHEN PLANTING IS COMPLETE.
5. INSTALL WOVEN WIRE TREE CAGES AROUND EACH COTTONWOOD. USE REBAR TO SECURE THE CAGE TO THE GROUND.

BURKE LAKE ACCESS MITIGATION PLANTING SCHEDULE					
ZONE	AREA (SF)	SPECIES	SIZE	QUANTITY	SPACING
ZONE A	684 SF	TINY-BLOOM PENSTEMON (PENSTEMON PROCERUS)	BR	50	1 FT OC
		SHOWY MILKWEED (ASCLEPIAS SPECIOSA)	BR	50	1 FT OC
ZONE B1	657 SF	GOLDEN CURRANT (RIBES AUREUM)	BR	50	4 FT OC
ZONE B2	492 SF	GOLDEN CURRANT (RIBES AUREUM)	BR	50	4 FT OC
ZONE C	708 SF	BLACK COTTONWOOD (POPULUS BALSAMIFERA SPP. TRICHOCARPA)	1 GALLON	8	10 FT OC
TOTAL	2541 SF				

REFERENCE NUMBER:  
 APPLICANT NAME:  
 WASHINGTON DEPT. of FISH & WILDLIFE  
 PROPOSED PROJECT:  
 BURKE LAKE SOUTH ACCESS REDEVELOPMENT  
 LOCATION: BURKE LAKE  
 SHEET 15 OF 15 DATE: 12/30/2020