

PROJECT LOCATION

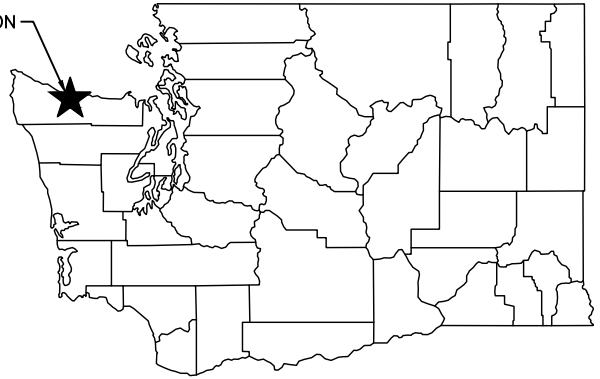

STATE MAP
NOT TO SCALE

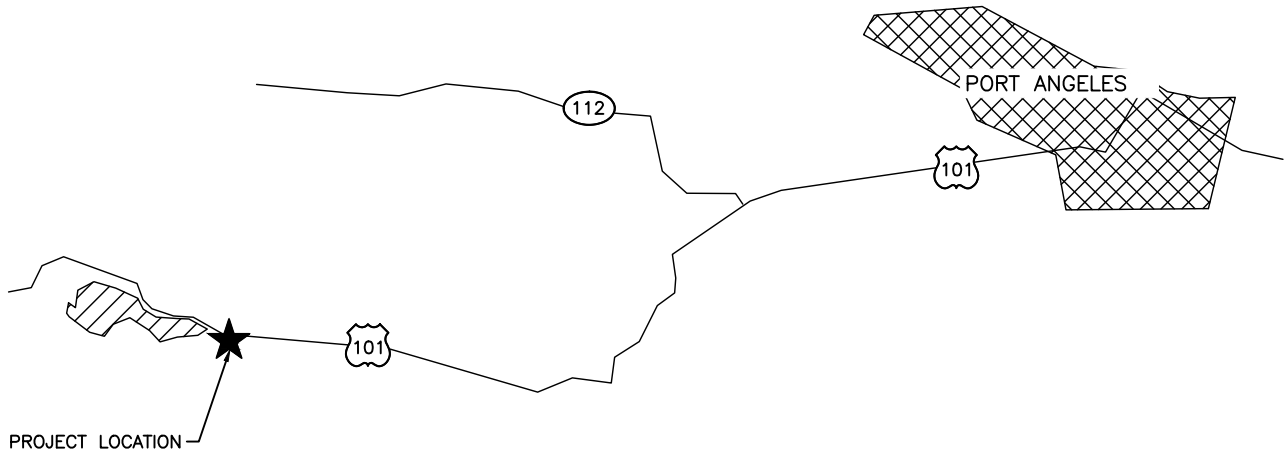

VICINITY MAP
NOT TO SCALE

ENG. PROJECT NO. CM:M05:2022-1 PORTION OF: T30N,R08W,S22 DRAWN BY: N. WHITE

REFERENCE NUMBER: -----

PROJECT LOCATION (ADDRESS):

PROPOSED PROJECT:
**UPPER INDIAN CREEK
SCREEN REMOVAL**

APPLICANT:
**WASHINGTON DEPT. of FISH & WILDLIFE
600 CAPITOL WAY N.
OLYMPIA, WA 98501-1091**

IN: LAKE SUTHERLAND
NEAR/AT: PORT ANGELES
COUNTY: CLALLAM
STATE: WA

ADJACENT PROPERTY OWNER:

LAT/LONG:
DATUM: NAVD 88

- 1. XX
- 2. XX

SHEET 1 OF 8 DATE: 4-14-2023

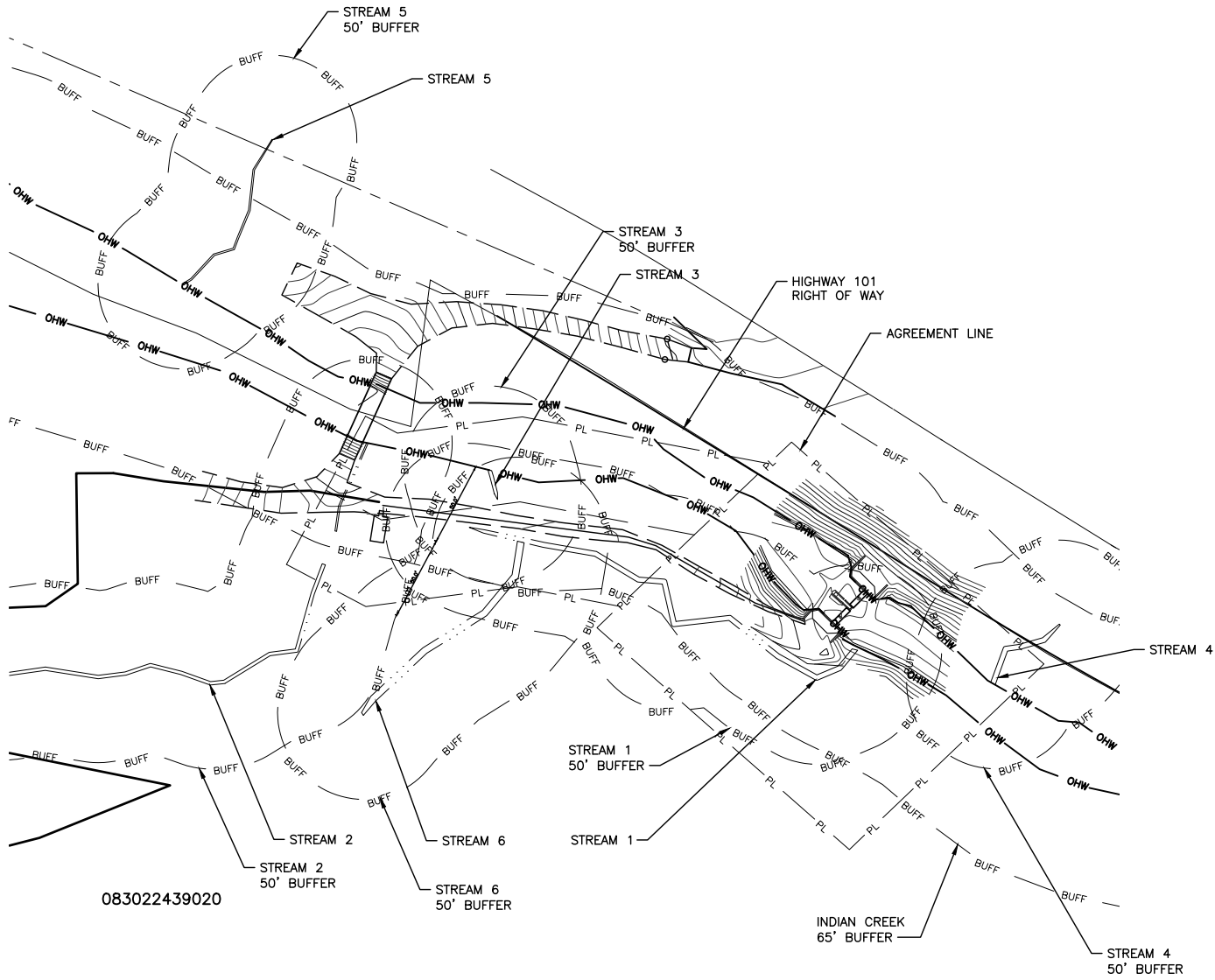

EXISTING SITE PLAN

SCALE: 1" = 100'

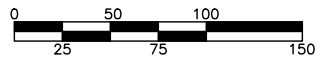

REFERENCE NUMBER: -----
 APPLICANT NAME:
 WASHINGTON DEPT. of FISH & WILDLIFE
 PROPOSED PROJECT:
 SCREEN REMOVAL
 LOCATION: UPPER INDIAN CREEK
 SHEET 2 OF 8 DATE: 4-14-2023

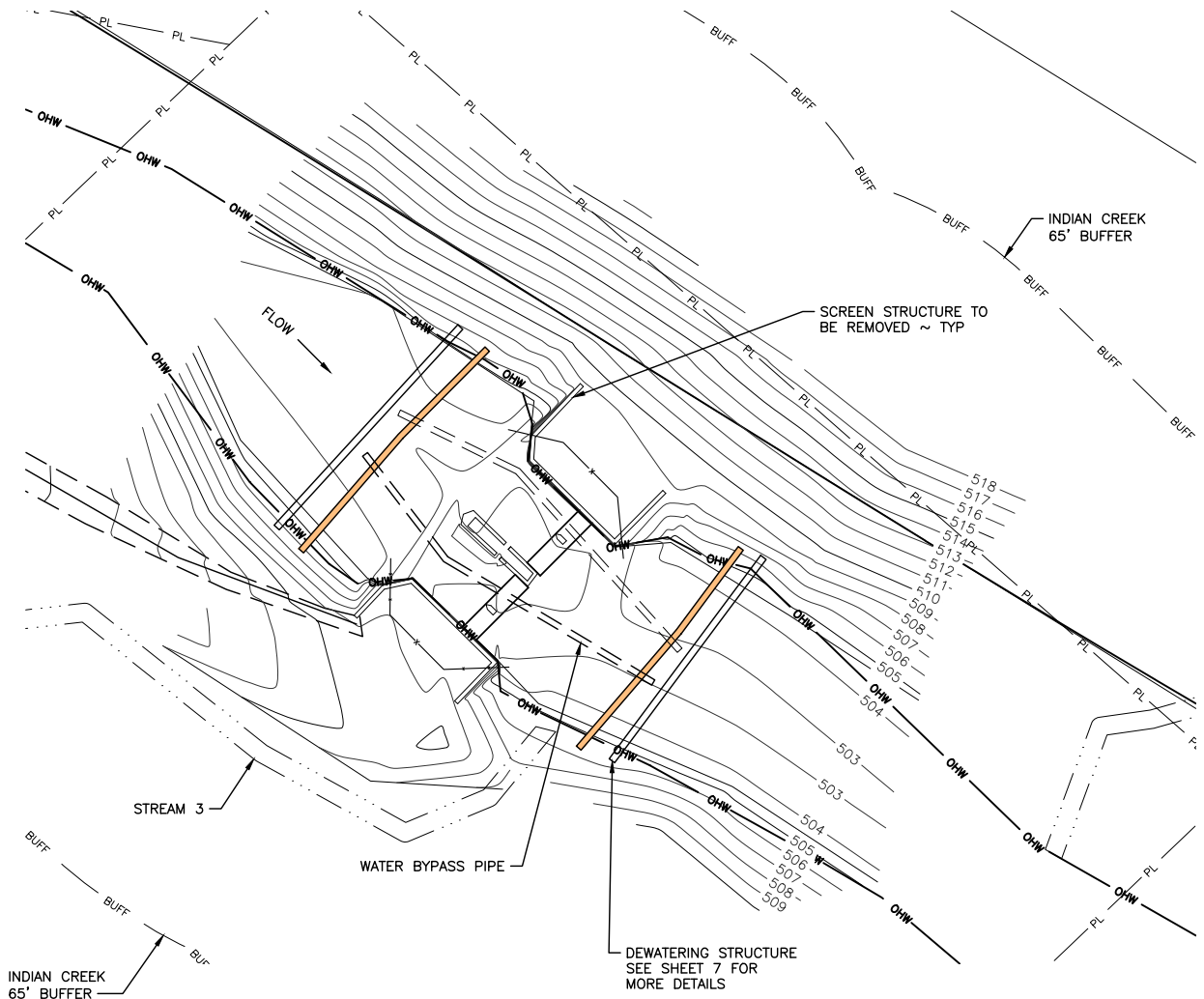

DEMOLITION PLAN

SCALE: 1" = 30'

NOTE:
APPROXIMATELY 2,300 SQ FT OF IMPACT
AREA FOR SCREEN STRUCTURE REMOVAL.



SCALE: 1" = 30'

REFERENCE NUMBER: -----
 APPLICANT NAME:
 WASHINGTON DEPT. of FISH & WILDLIFE
 PROPOSED PROJECT:
 SCREEN REMOVAL
 LOCATION: UPPER INDIAN CREEK
 SHEET 3 OF 8 DATE: 4-14-2023



CUT AND FILL DATA				
SITE	CUT ABOVE OHW	CUT BELOW OHW	FILL ABOVE OHW	FILL BELOW OHW
	28 CY	55 CY	0	56 CY

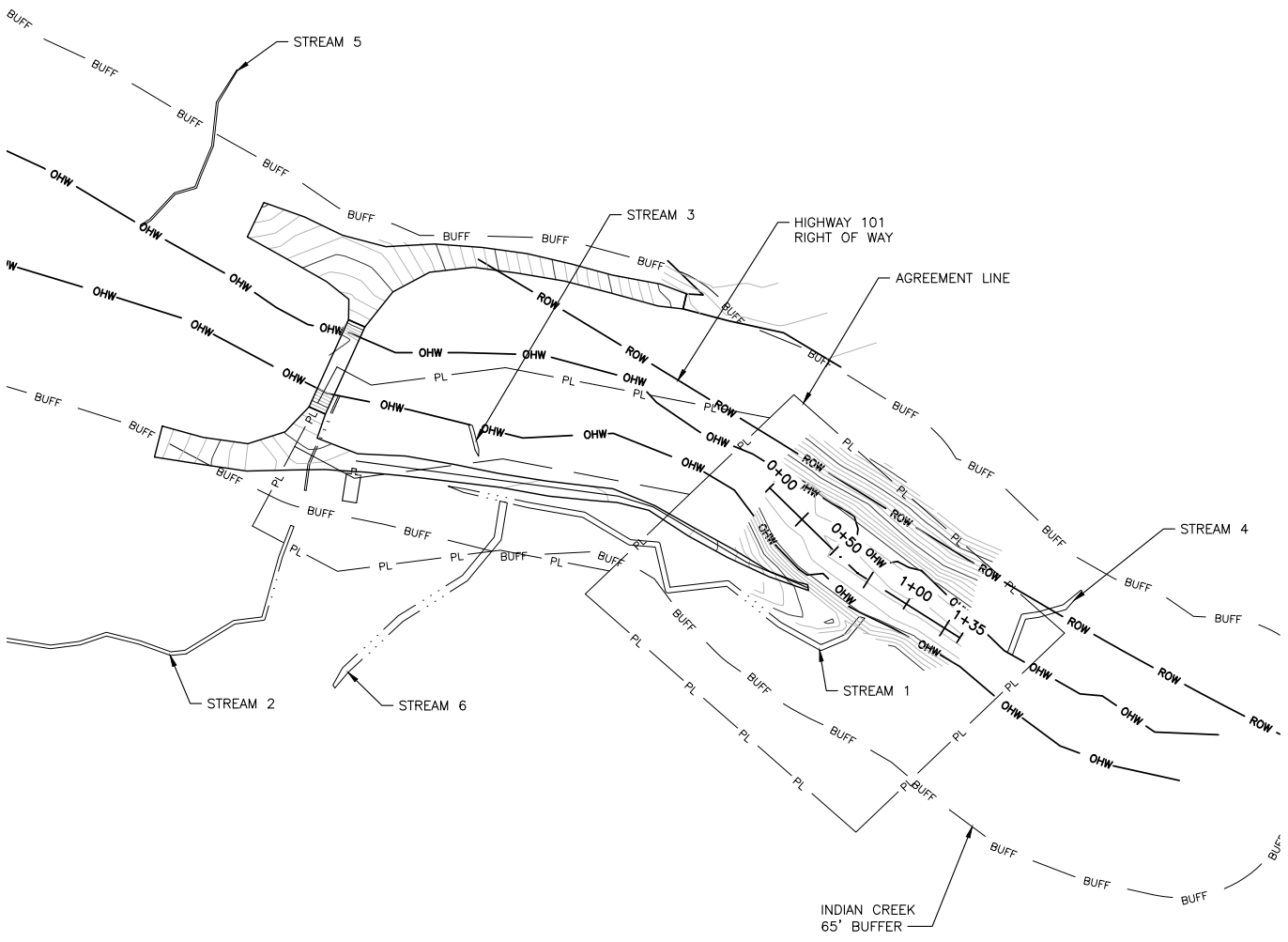

PROPOSED SITE PLAN
SCALE: 1" = 100'

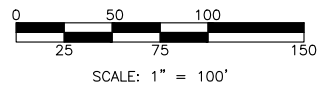

REFERENCE NUMBER: -----
 APPLICANT NAME:
 WASHINGTON DEPT. of FISH & WILDLIFE
 PROPOSED PROJECT:
 SCREEN REMOVAL
 LOCATION: UPPER INDIAN CREEK
 SHEET 4 OF 8 DATE: 4-14-2023

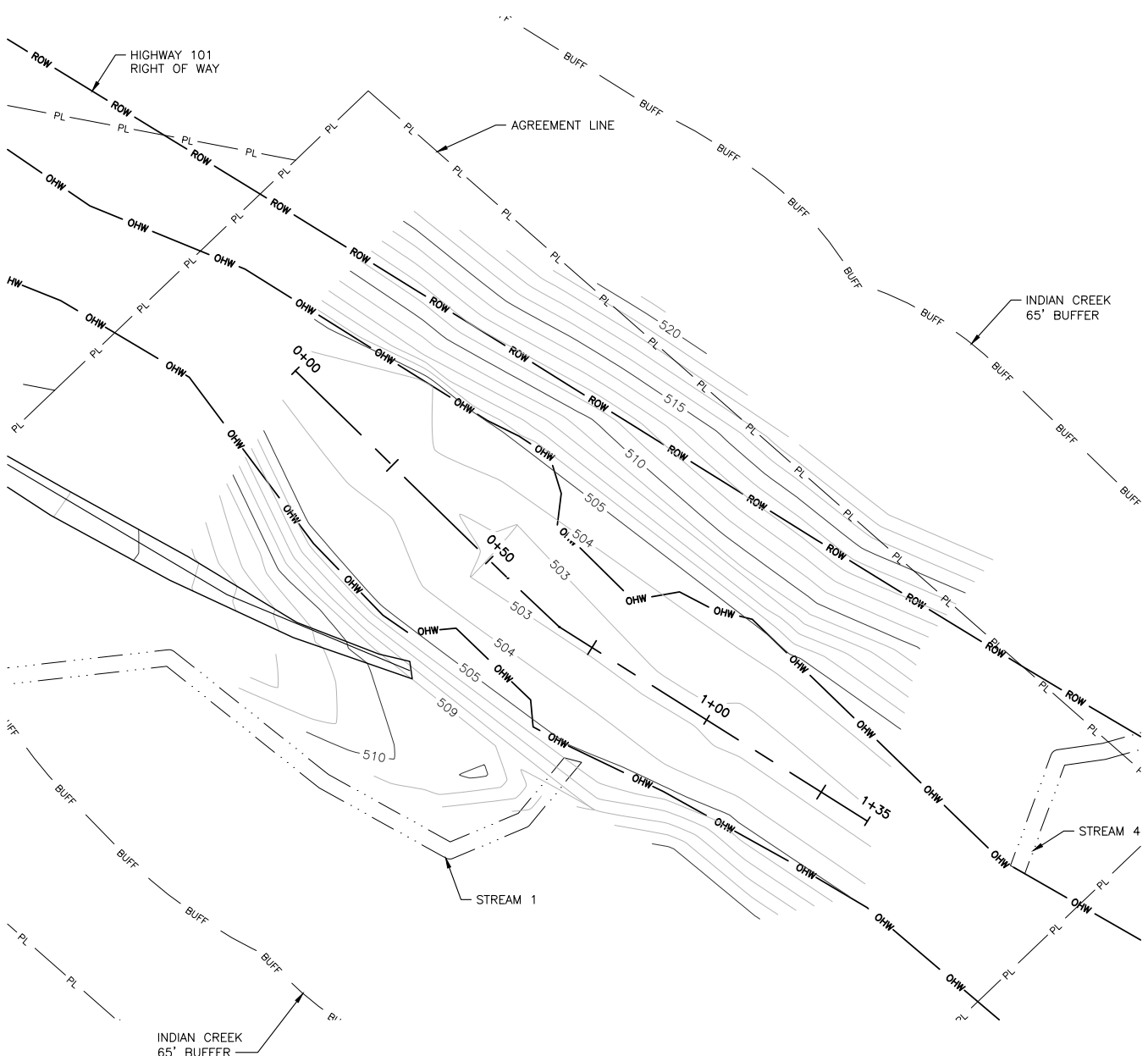

PROPOSED GRADING SITE PLAN

SCALE: 1" = 100'

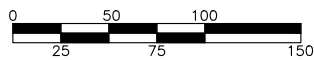

SCALE: 1" = 100'

REFERENCE NUMBER: -----
 APPLICANT NAME:
 WASHINGTON DEPT. of FISH & WILDLIFE
 PROPOSED PROJECT:
 SCREEN REMOVAL
 LOCATION: UPPER INDIAN CREEK
 SHEET 5 OF 8 DATE: 4-14-2023

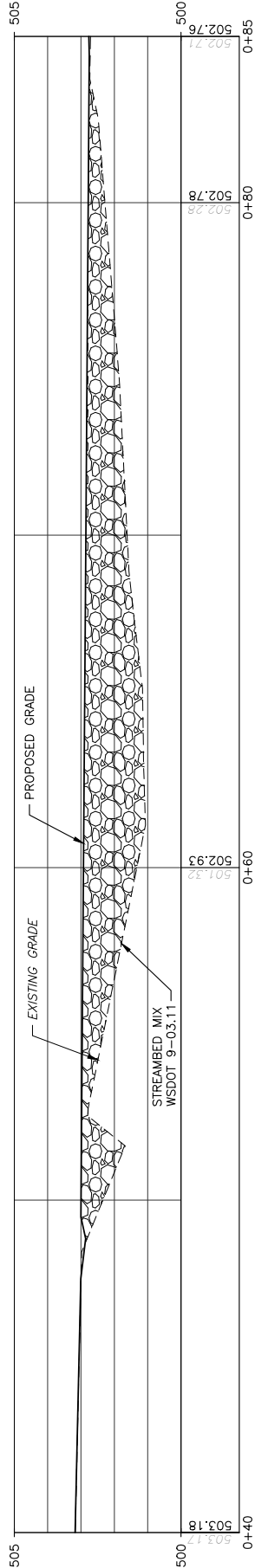

STREAM PROFILE
SCALE: 1" = 5'

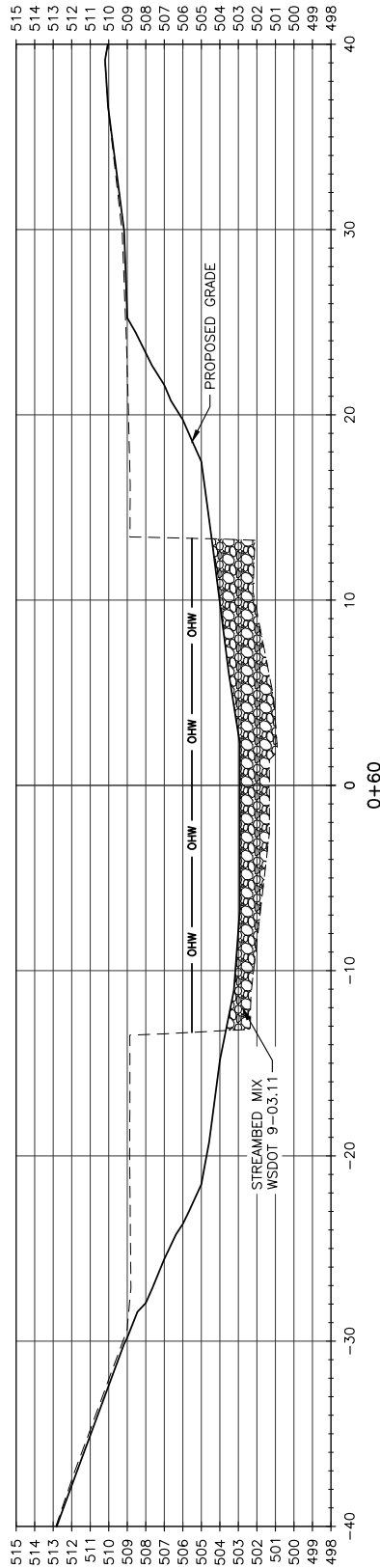

STREAM SECTION
SCALE: 1" = 10'

REFERENCE NUMBER: -----
 APPLICANT NAME:
 WASHINGTON DEPT. of FISH & WILDLIFE
 PROPOSED PROJECT:
 SCREEN REMOVAL
 LOCATION: UPPER INDIAN CREEK
 SHEET 6 OF 8 DATE: 4-14-2023

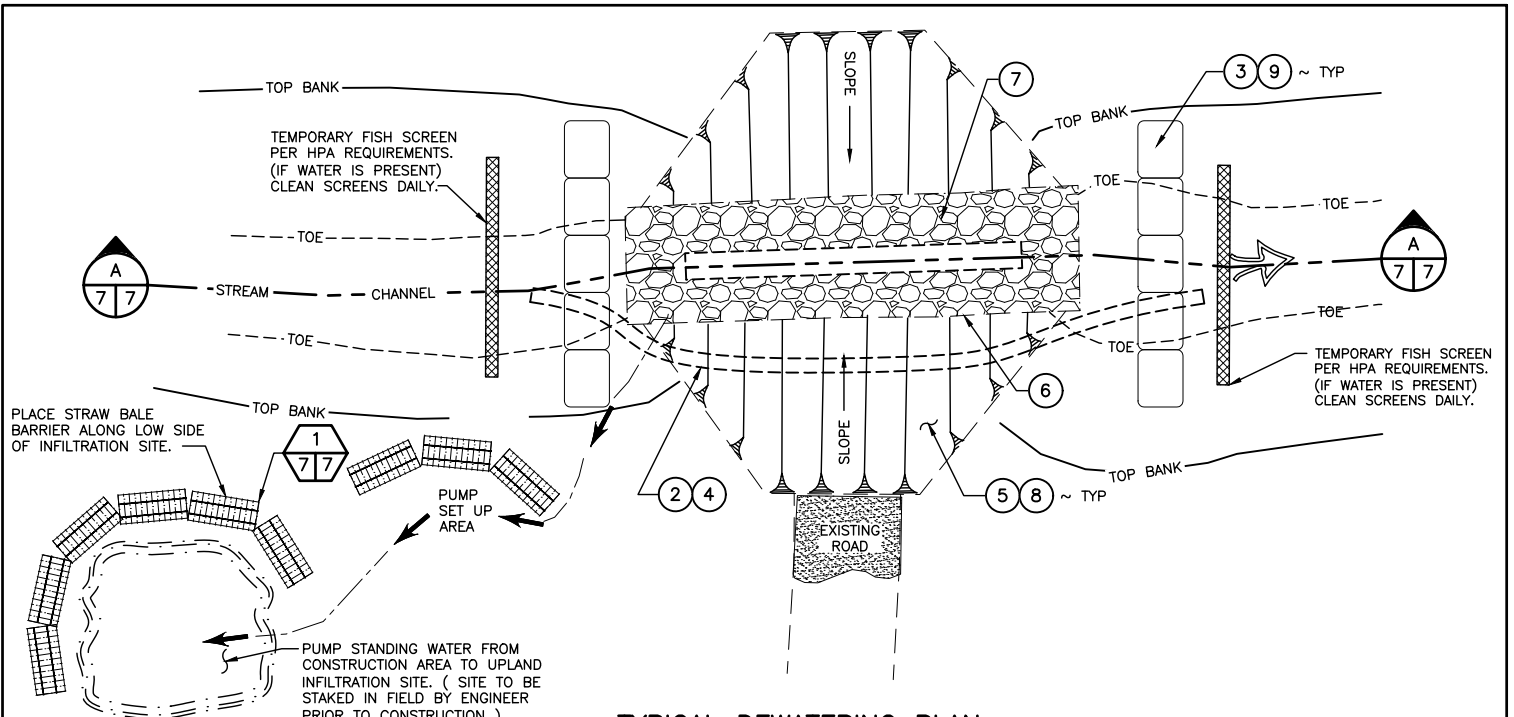

TYPICAL DEWATERING PLAN
NOT TO SCALE

DEWATERING NOTES:

1. ALL WORK SHALL BE IN ACCORDANCE WITH HPA.
2. DURING CONSTRUCTION (IF WATER IS PRESENT) STREAM LOW SHALL BE DIVERTED THROUGH BYPASS OR EXISTING PIPE. IF HIGH FLOW, (2) DIVERSION PIPES MAY BE NEEDED.
3. PLACE SUPER SACKS FILLED WITH PEA GRAVEL TO SEAL BYPASS INLET AND OUTLET.
4. DIVERSION SHALL BE APPROVED BY INSPECTOR PRIOR TO EXCAVATION.
5. FISH REMOVAL SHALL BE COMPLETED BY PERMITTING STAFF.
6. EXCAVATE EXISTING FILL.
7. REMOVE EXISTING CULVERT AND DISPOSE OF OFF SITE.
8. PLACE NEW BED MATERIAL MIX AND REMOVE BYPASS PIPE.
9. COVER ALL EXPOSED SOIL WITH STRAW MULCH AND GRASS SEED.
10. REMOVE DIVERSION BAGS AND FISH SCREENS BY HAND.

SOIL STABILIZATION NOTES:

1. ALL EXPOSED SURFACES SHALL BE REVEGETATED WITHIN 30 DAYS OF AREA COMPLETION. COMPLETION INCLUDES ALL SLOPES TO FINISH CONTOUR AND ALL CLEARED AREAS, NOT GRAVELED, SMOOTH AND CLEAR OF DEBRIS TO THE SATISFACTION OF THE ENGINEER.
2. REVEGETATION SHALL MEAN BROADCAST SEEDING OR HYDRO-SEEDING..
3. MULCHING AND MATTING SHALL BE UTILIZED DURING PERIODS OF CONSTRUCTION DELAYS OR WINTER DOWNTIME FOR TEMPORARILY PROTECTING EXPOSED SOILS.

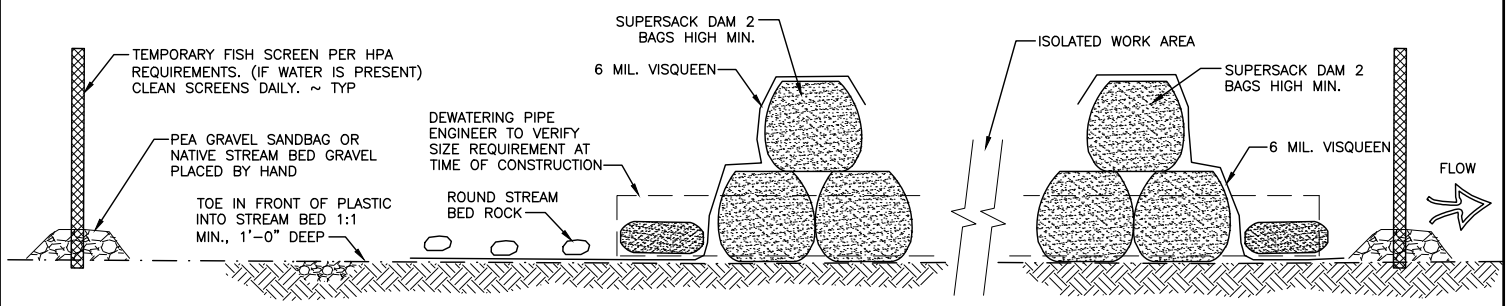

SECTION A
NOT TO SCALE

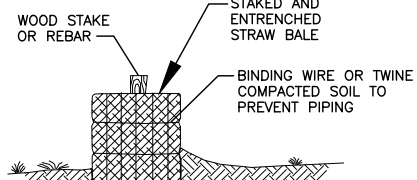

NOTE:

BALES SHALL BE PLACED IN A SINGLE ROW, LENGTHWISE ON THE CONTOUR, WITH ENDS OF ADJACENT BALES TIGHTLY ABUTTING ONE ANOTHER. THE BARRIER SHALL BE ENTRENCHED AND BACKFILLED. A TRENCH SHALL BE A MINIMUM OF 4 INCHES. BACKFILL SOIL SHALL CONFORM TO THE GROUND LEVEL ON THE DOWNHILL SIDE AND SHALL BE BUILT UP 4 INCHES AGAINST THE UPHILL SIDE OF THE BARRIER. EACH BALE SHALL BE SECURELY ANCHORED BY AT LEAST 2 STAKES OR REBAR DRIVEN THROUGH THE BALE. THE GAP BETWEEN THE BALES SHALL BE CHINKED (FILLED BY WEDGING) WITH STRAW TO PREVENT WATER FROM ESCAPING BETWEEN THE BALES.

STRAW BALE
NOT TO SCALE

REFERENCE NUMBER: -----
 APPLICANT NAME:
 WASHINGTON DEPT. of FISH & WILDLIFE
 PROPOSED PROJECT:
 SCREEN REMOVAL
 LOCATION: UPPER INDIAN CREEK
 SHEET 7 OF 8 DATE: 4-14-2023

PLANTINGS		
SPECIES	QUANTITY	SPACING
RED ALDER (ALNUS RUBA)	5	10 FT ON CENTER
BIGLEAD MAPLE (ACER MACROPHYLLUM)	5	10 FT ON CENTER
SALMONBERRY (RUBUS SPECTABILIS)	55	4 FT ON CENTER
SPIRAEA	390	1.5 FT ON CENTER

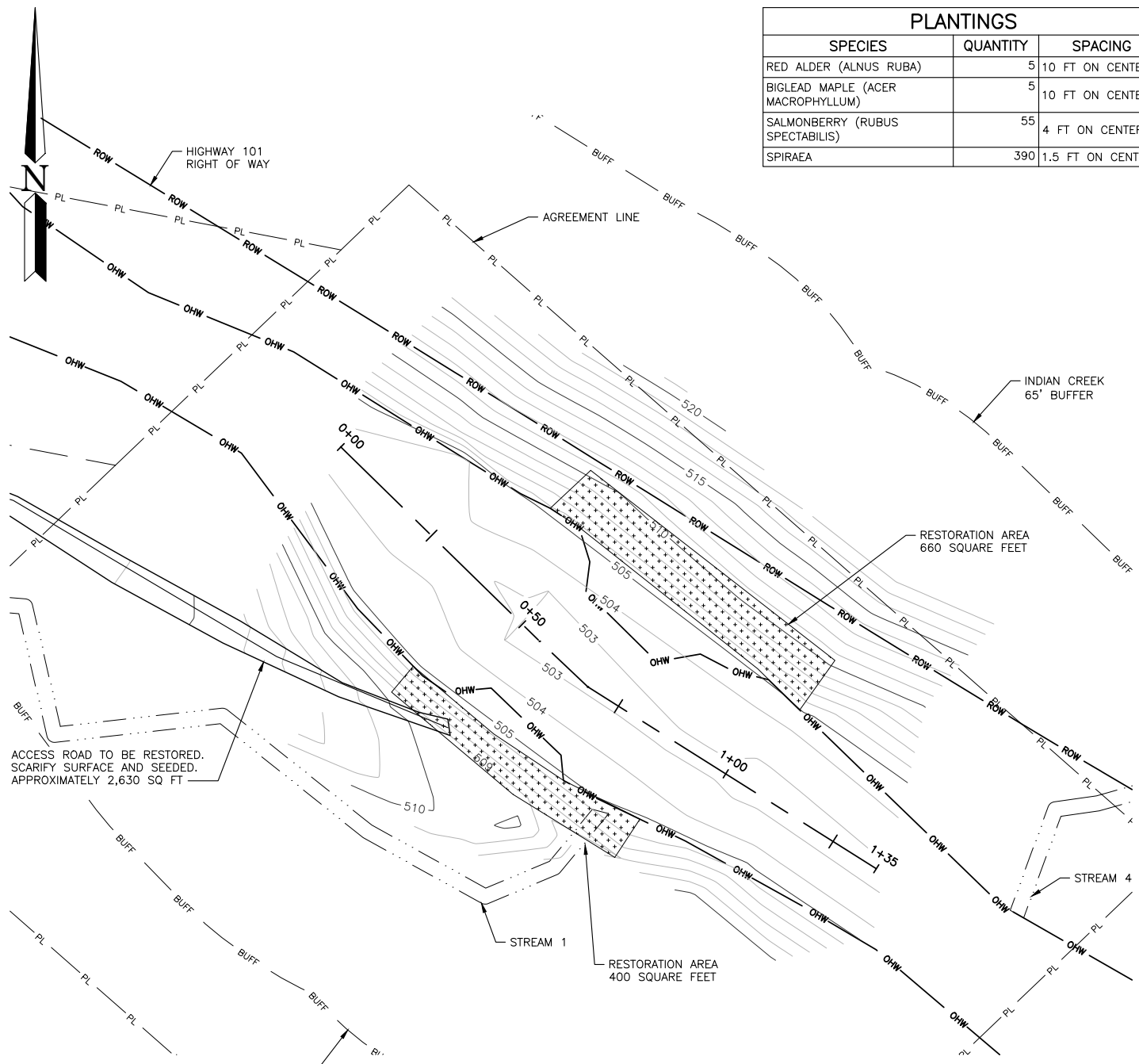

ACCESS ROAD TO BE RESTORED. SCARIFY SURFACE AND SEEDED. APPROXIMATELY 2,630 SQ FT

RESTORATION SITE PLAN

SCALE: 1" = 100'

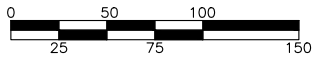

SCALE: 1" = 100'

REFERENCE NUMBER: -----
 APPLICANT NAME:
 WASHINGTON DEPT. of FISH & WILDLIFE
 PROPOSED PROJECT:
 SCREEN REMOVAL
 LOCATION: UPPER INDIAN CREEK
 SHEET 8 OF 8 DATE: 4-14-2023