

STATE MAP
NOT TO SCALE

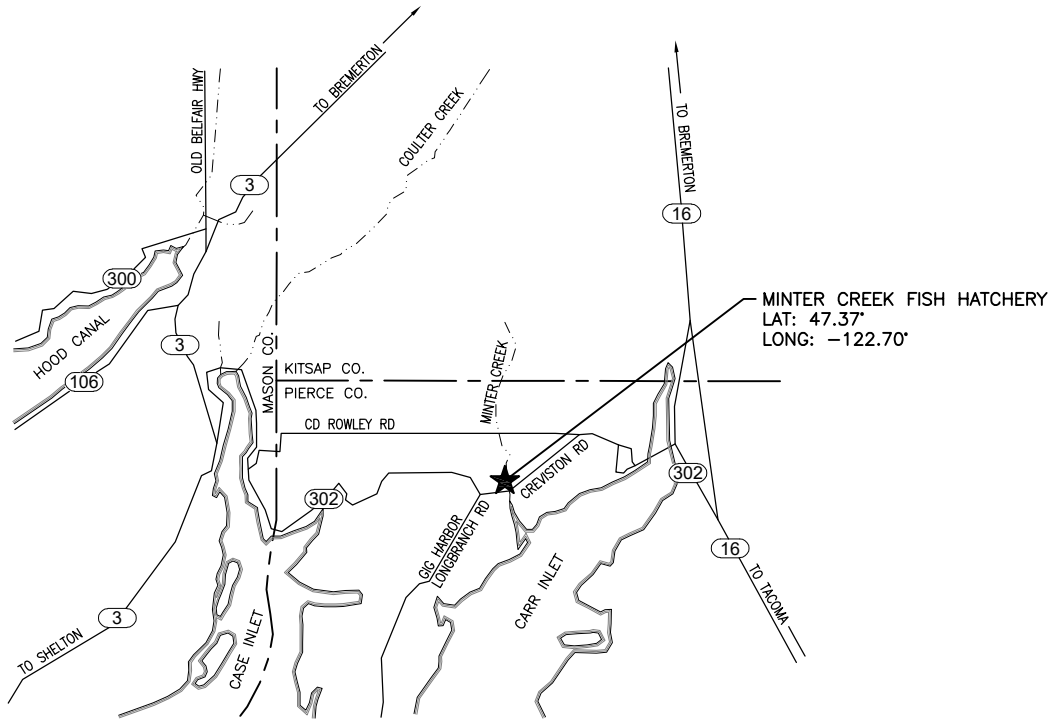

VICINITY MAP
NOT TO SCALE

DIRECTIONS
FROM OLYMPIA, TAKE I-5 NORTH TO EXIT 132 TO HWY 16. TAKE THE PURDY AND SHELTON EXIT OFF OF HWY 16 TO HWY 302, STAY ON HWY 302, TURN LEFT ONTO 118TH AVE. AT STOP SIGN TURN RIGHT, THE HATCHERY WILL BE ON THE RIGHT.

ENG. PROJECT NO. PE:H1319-1

PORTION OF: T22N,R1E,S29

DRAWN BY: N. WHITE

REFERENCE NUMBER:

APPLICANT:
WASHINGTON DEPT. of FISH & WILDLIFE
600 CAPITOL WAY N.
OLYMPIA, WA 98501-1091

ADJACENT PROPERTY OWNER:

1. MAYER
2. NELSON, 4 OTHERS

PROJECT LOCATION (ADDRESS):

MINTER CREEK HATCHERY
12710 124TH AVE CT NW
GIG HARBOR, WA 98329

LAT/LONG: 47.37' / -122.70'

DATUM: NAVD 88

SHEET 1 OF 22 DATE: 08/29/2019

PROPOSED PROJECT:

MINTER CREEK HATCHERY
SURFACE WATER INTAKE REPLACEMENT

IN: HENDERSON BAY

NEAR/AT: GIG HARBOR

COUNTY: PIERCE

STATE: WA

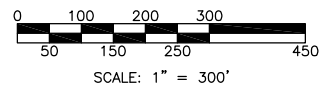
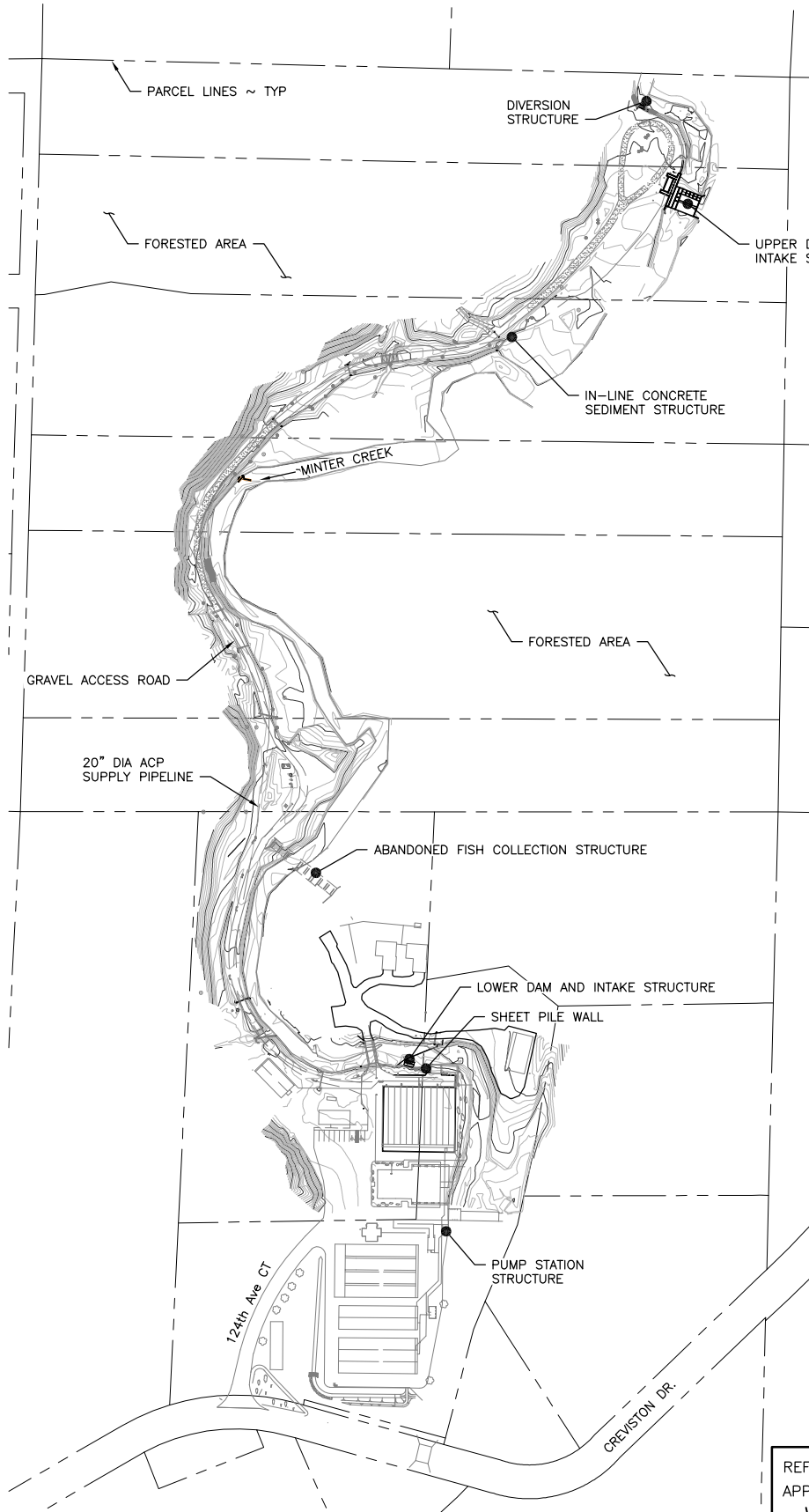

EXISTING SITE PLAN
SCALE: 1" = 300'

REFERENCE NUMBER:
APPLICANT NAME:
WASHINGTON DEPT. of FISH & WILDLIFE
PROPOSED PROJECT:
SURFACE WATER INTAKE REPLACEMENT
LOCATION: **MINTER CREEK HATCHERY**
SHEET **2** OF **22** DATE: **08/29/2019**

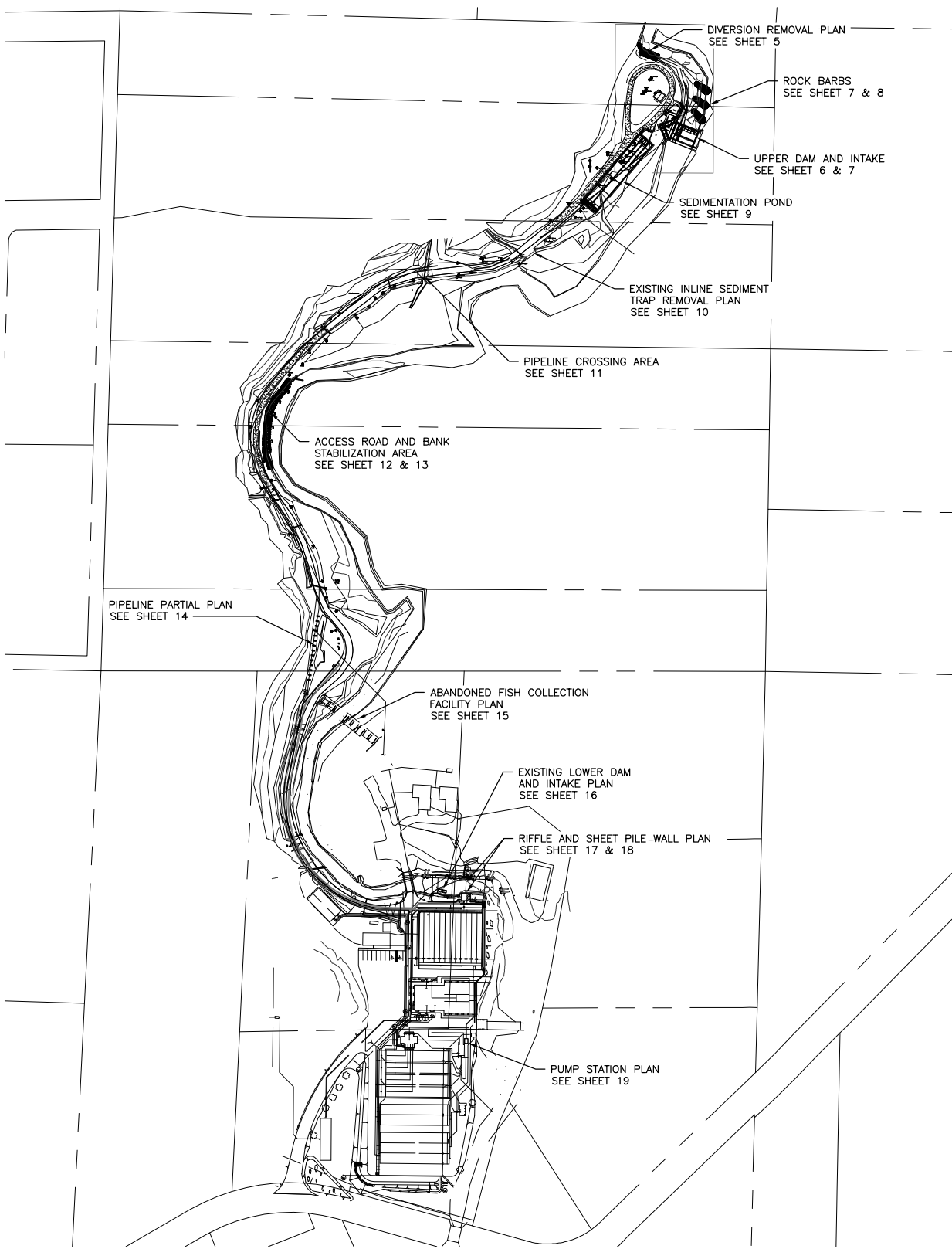

DIVERSION REMOVAL PLAN
SEE SHEET 5

ROCK BARBS
SEE SHEET 7 & 8

UPPER DAM AND INTAKE
SEE SHEET 6 & 7

SEDIMENTATION POND
SEE SHEET 9

EXISTING INLINE SEDIMENT
TRAP REMOVAL PLAN
SEE SHEET 10

PIPELINE CROSSING AREA
SEE SHEET 11

ACCESS ROAD AND BANK
STABILIZATION AREA
SEE SHEET 12 & 13

PIPELINE PARTIAL PLAN
SEE SHEET 14

ABANDONED FISH COLLECTION
FACILITY PLAN
SEE SHEET 15

EXISTING LOWER DAM
AND INTAKE PLAN
SEE SHEET 16

RIFFLE AND SHEET PILE WALL PLAN
SEE SHEET 17 & 18

PUMP STATION PLAN
SEE SHEET 19



OVERALL PROJECT SITE PLAN

SCALE: 1" = 300'

REFERENCE NUMBER:
 APPLICANT NAME:
 WASHINGTON DEPT. of FISH & WILDLIFE
 PROPOSED PROJECT:
 SURFACE WATER INTAKE REPLACEMENT
 LOCATION: MINTER CREEK HATCHERY
 SHEET 3 OF 22 DATE: 08/29/2019