

**EXISTING HATCHERY SITE PLAN**

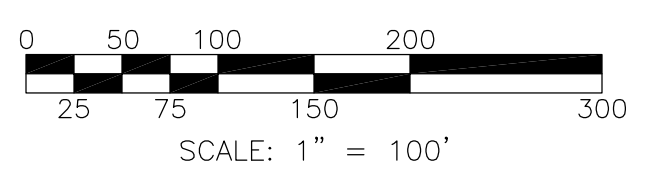

**VERTICAL DATUM**

NAVD 29  
 USGS BENCHMARK "2 KSM" 1948  
 STANDARD 4" BRASS DISK IN TOP OF  
 18"x36"x30" HIGH BOULDER S 80° W,  
 18 FEET FROM SW CORNER HWY 542  
 BRIDGE OVER COAL CREEK  
 ELEV. = 401.04 FEET  
 REF: WSDOT DATA SHEET, DESIGNATION: "2  
 KSM 1948 401", MONUMENT ID: 1658  
 NOTE: TO CONVERT NGVD 29 ELEVATIONS TO  
 NAVD 88 ELEVATIONS ADD 3.92 FEET.  
 REF: VERTCON APPLICATION AT JOB  
 SITE LATITUDE AND LONGITUDE.

**BASIS OF BEARINGS**

WASHINGTON COORDINATE SYSTEM NAD 83,  
 NORTH ZONE, USING SPC'S SHOWN ON DNR  
 SURVEY AFN 200100938, DATED 9/1999.  
 ALSO USED DOF SURVEY DATED 1978.

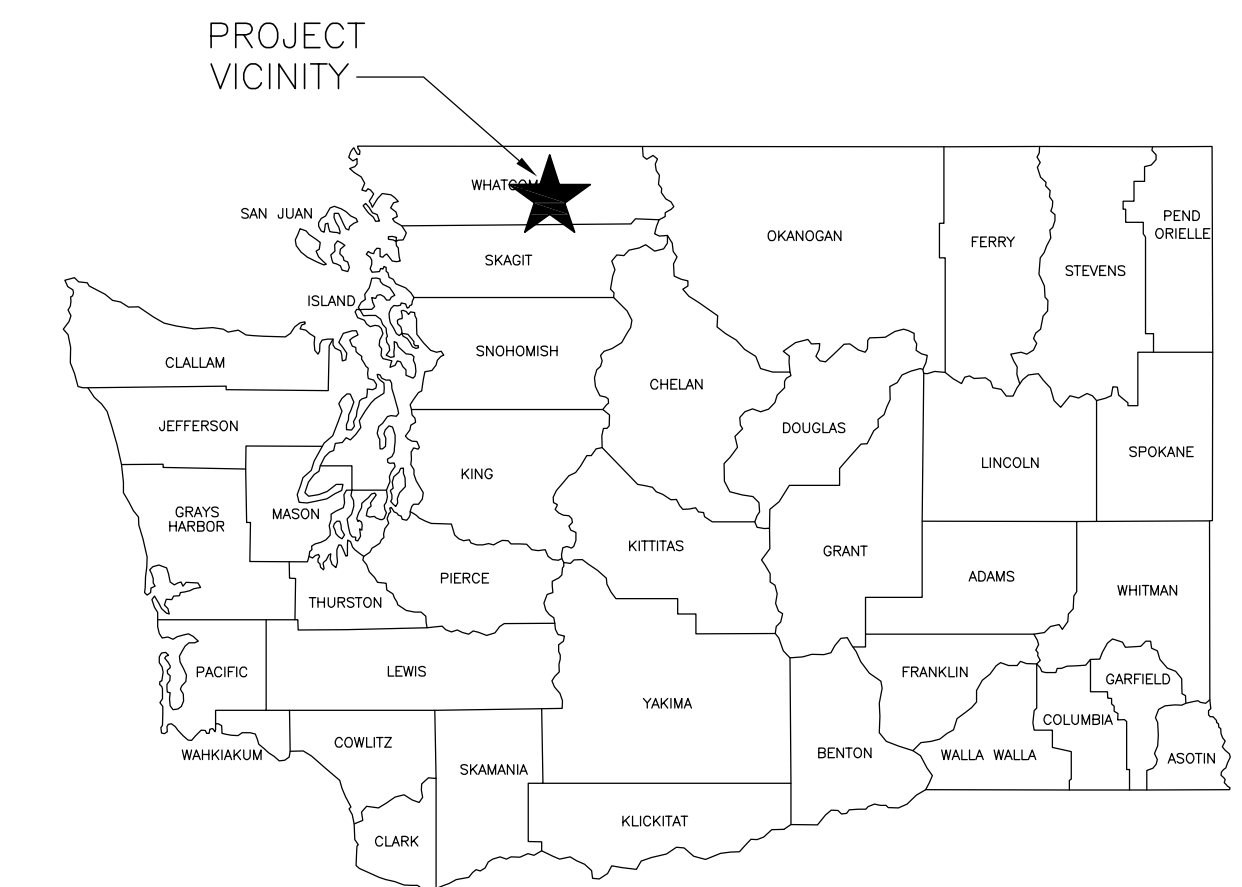

**STATE MAP**  
NOT TO SCALE

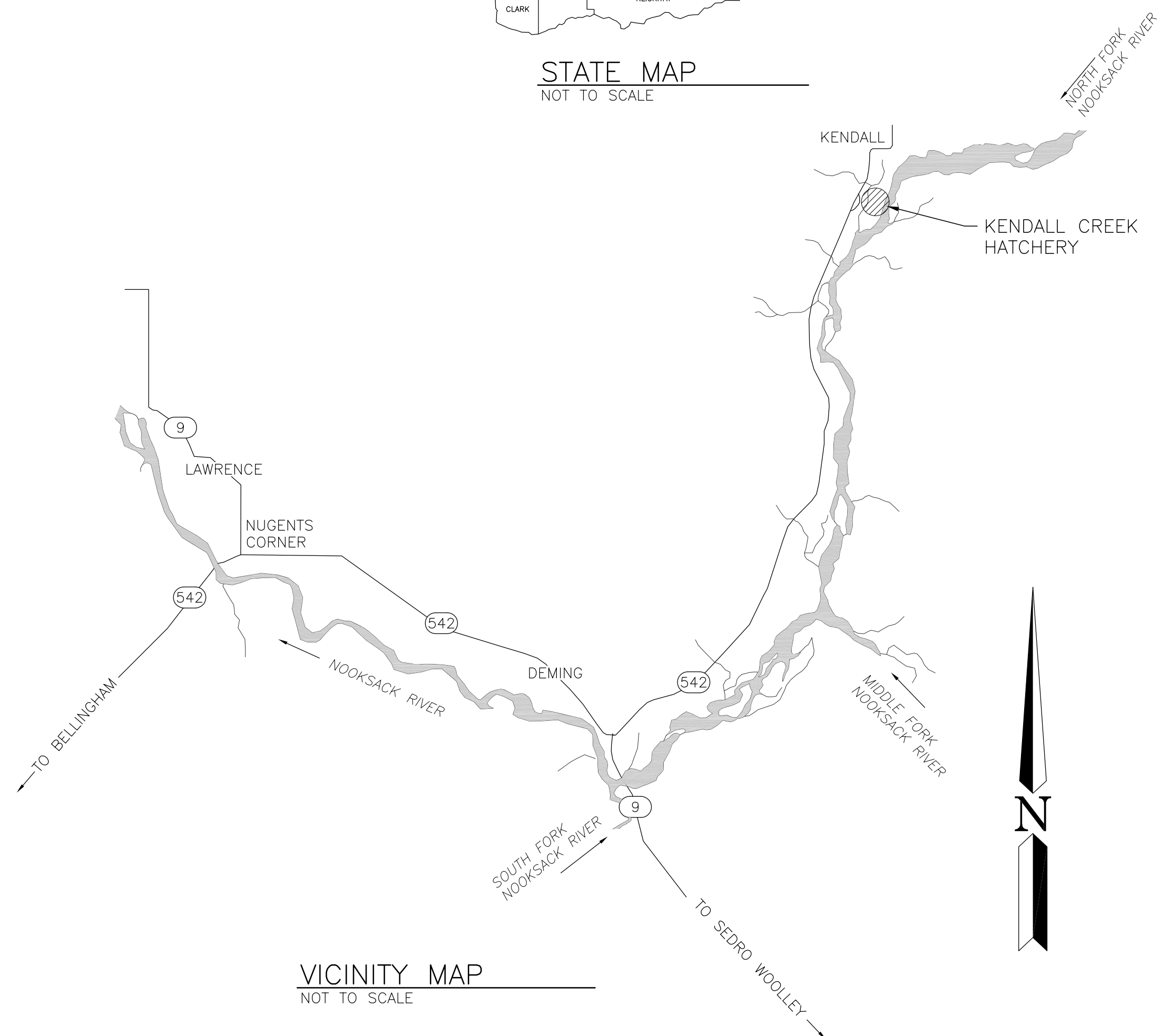

**VICINITY MAP**  
NOT TO SCALE

PROPERTY INFORMATION	
ADDRESS:	710 HATCHERY ROAD DEMING, WA 98244
COUNTY:	WHATCOM
PARCEL NUMBER:	390503355295
SECTION:	3
TOWNSHIP:	39 N
RANGE:	5 E

WASHINGTON DEPARTMENT OF  
*FISH & WILDLIFE*

SYM	DATE	REVISION DESCRIPTION	BY
APPROVED AND RELEASED FOR CONSTRUCTION			
CHIEF ENGINEER	DATE:	DESIGNED BY E. ORTON	
PROGRAM	DATE:	CHECKED BY	
		DRAWN BY A. BLAKE	
		DATE September 6, 2022	

KENDALL CREEK HATCHERY  
 CHINOOK REARING FACILITY  
 EXISTING SITE PLAN,  
 STATE MAP AND VICINITY MAP

PROJECT NO. WM:H21:2022-1	
SHEET 1	OF 4

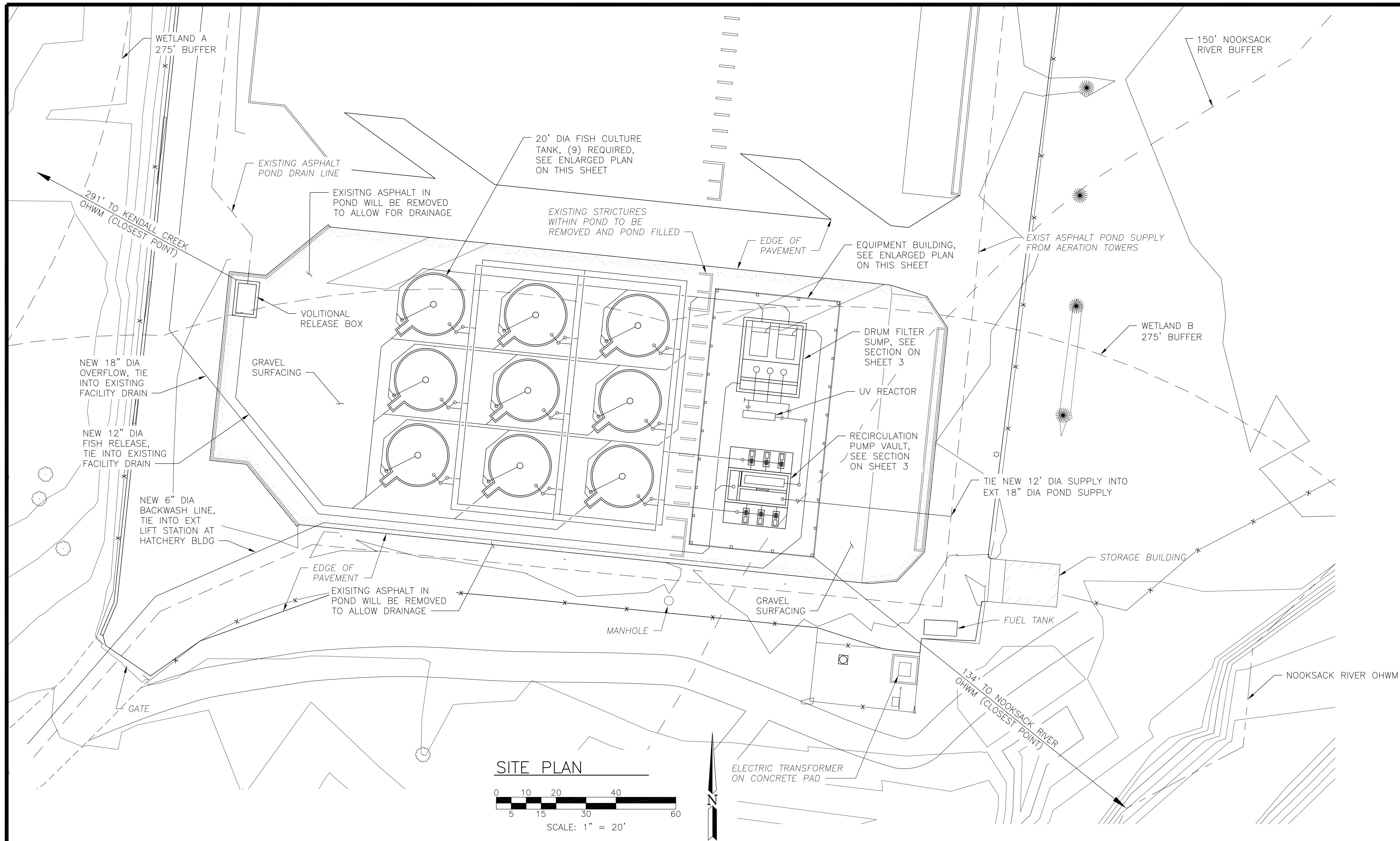

SITE PLAN

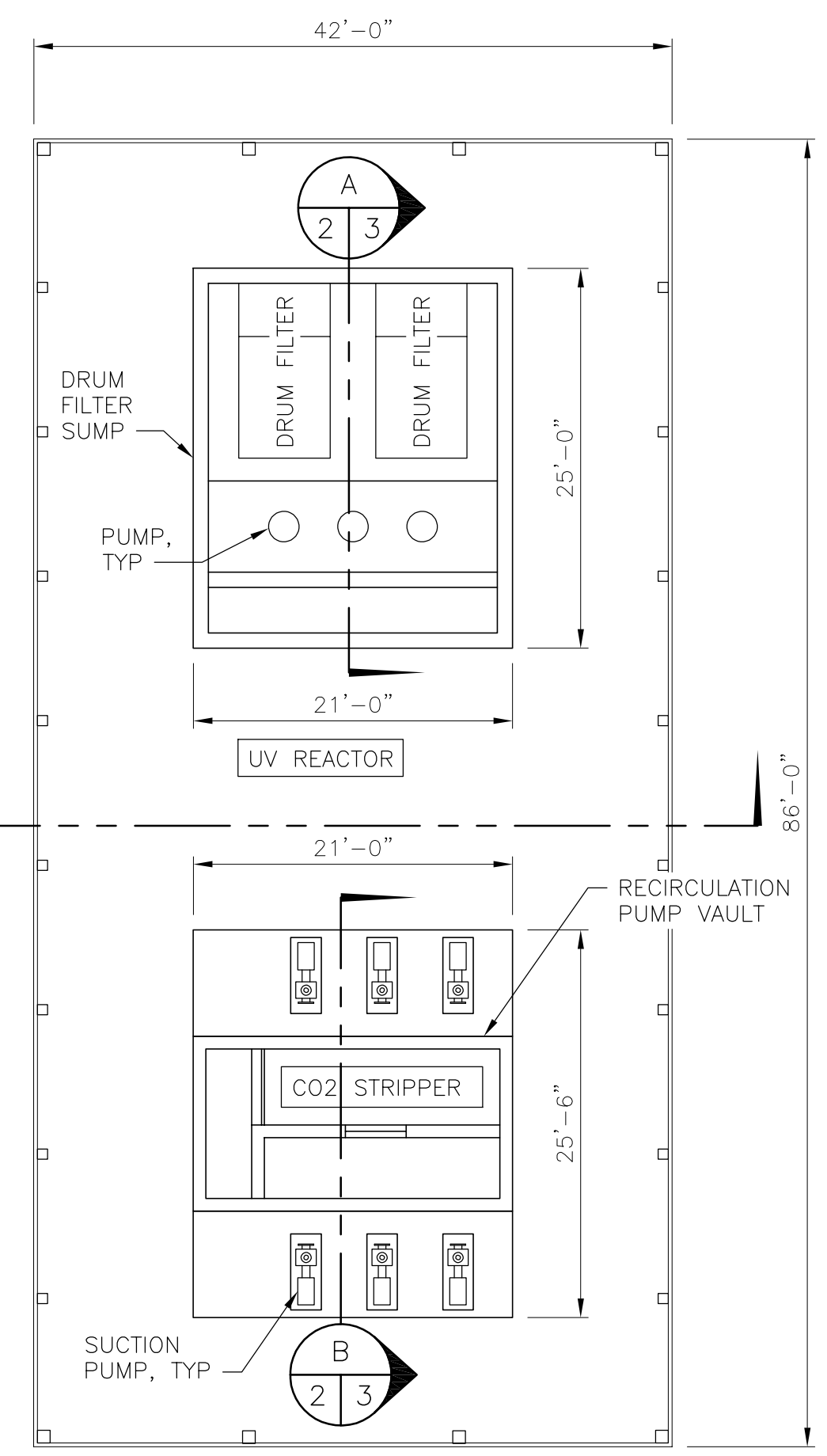
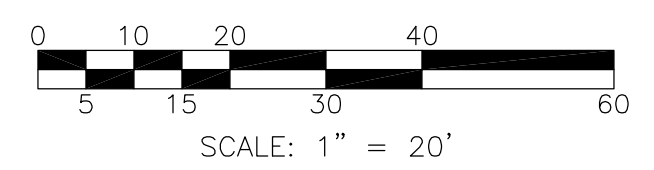

EQUIPMENT BUILDING PLAN

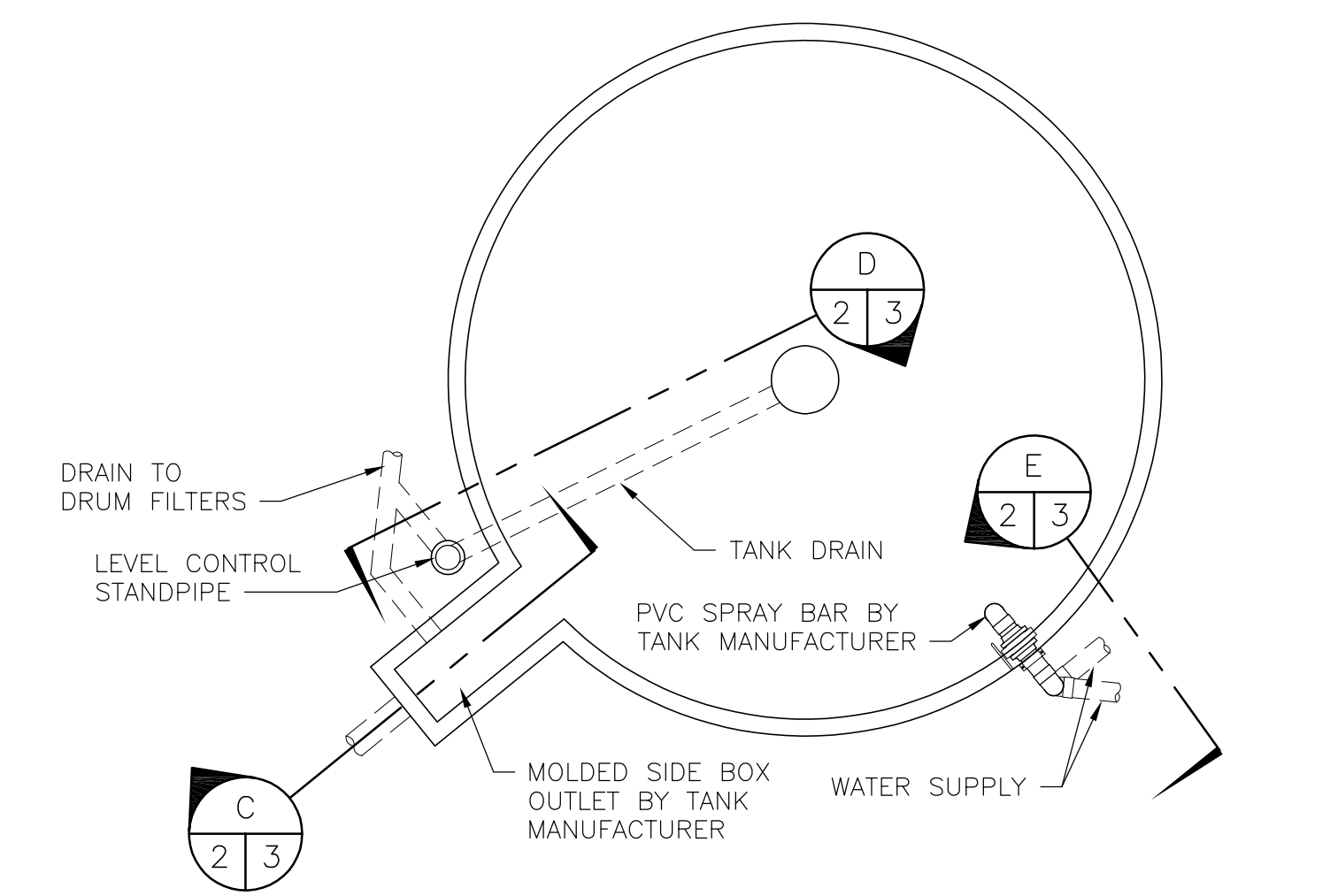
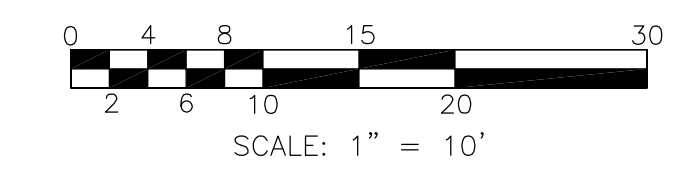

TYPICAL CULTURE TANK PLAN

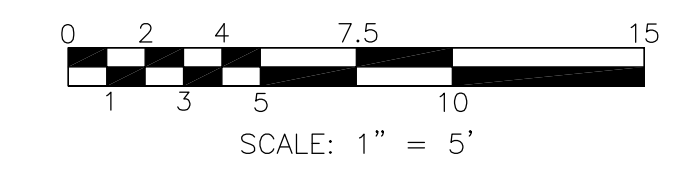

	BELOW	OUTSIDE
	OHW	OHW
	SF	SF
ASPHALT	0	21946.2
GRAVEL	0	0
STRUCT/CONCRETE	0	1083.7
<b>TOTAL REMOVED</b>	<b>0</b>	<b>23029.9</b>
ASPHALT	0	0
GRAVEL	0	16591.9
STRUCT/CONCRETE	0	6438.0
<b>TOTAL NEW</b>	<b>0</b>	<b>23029.9</b>
<b>TOTAL DISTURBED AREA</b>		<b>23029.9</b>

IMPERVIOUS AREA QUANTITIES

	BELOW OHW		OUTSIDE OHW		TOTAL
	SF	CY	SF	CY	CY
SOIL EXCAVATION	0	0	21946.2	813.8	813.8
RIPRAP EXCAVATION	0	0	0	0	0
CONCRETE DEMOLITION	0	0	1083.7	52.4	52.4
<b>TOTAL REMOVED</b>	<b>0</b>	<b>0</b>	<b>23029.9</b>	<b>866.2</b>	<b>866.2</b>
SOIL BACKFILL	0	0	23029.9	4691.3	4691.3
RIPRAP BACKFILL	0	0	0	0	0
CONCRETE FILL	0	0	0	0	0
<b>TOTAL FILL</b>	<b>0</b>	<b>0</b>	<b>23029.9</b>	<b>4691.3</b>	<b>4691.3</b>
<b>TOTAL DISTURBED AREA</b>	<b>0</b>	<b>0</b>	<b>23029.9</b>		

CUT AND FILL QUANTITIES

WASHINGTON DEPARTMENT OF  
*FISH & WILDLIFE*

SYM	DATE	REVISION DESCRIPTION	BY
APPROVED AND RELEASED FOR CONSTRUCTION			
CHIEF ENGINEER	DATE:	DESIGNED BY E. ORTON	
PROGRAM	DATE:	CHECKED BY	
		DRAWN BY A. BLAKE	
		DATE September 6, 2022	

KENDALL CREEK HATCHERY  
CHINOOK REARING FACILITY  
PROJECT SITE PLAN

PROJECT NO.  
WM:H21:2022-1

SHEET OF  
2 4

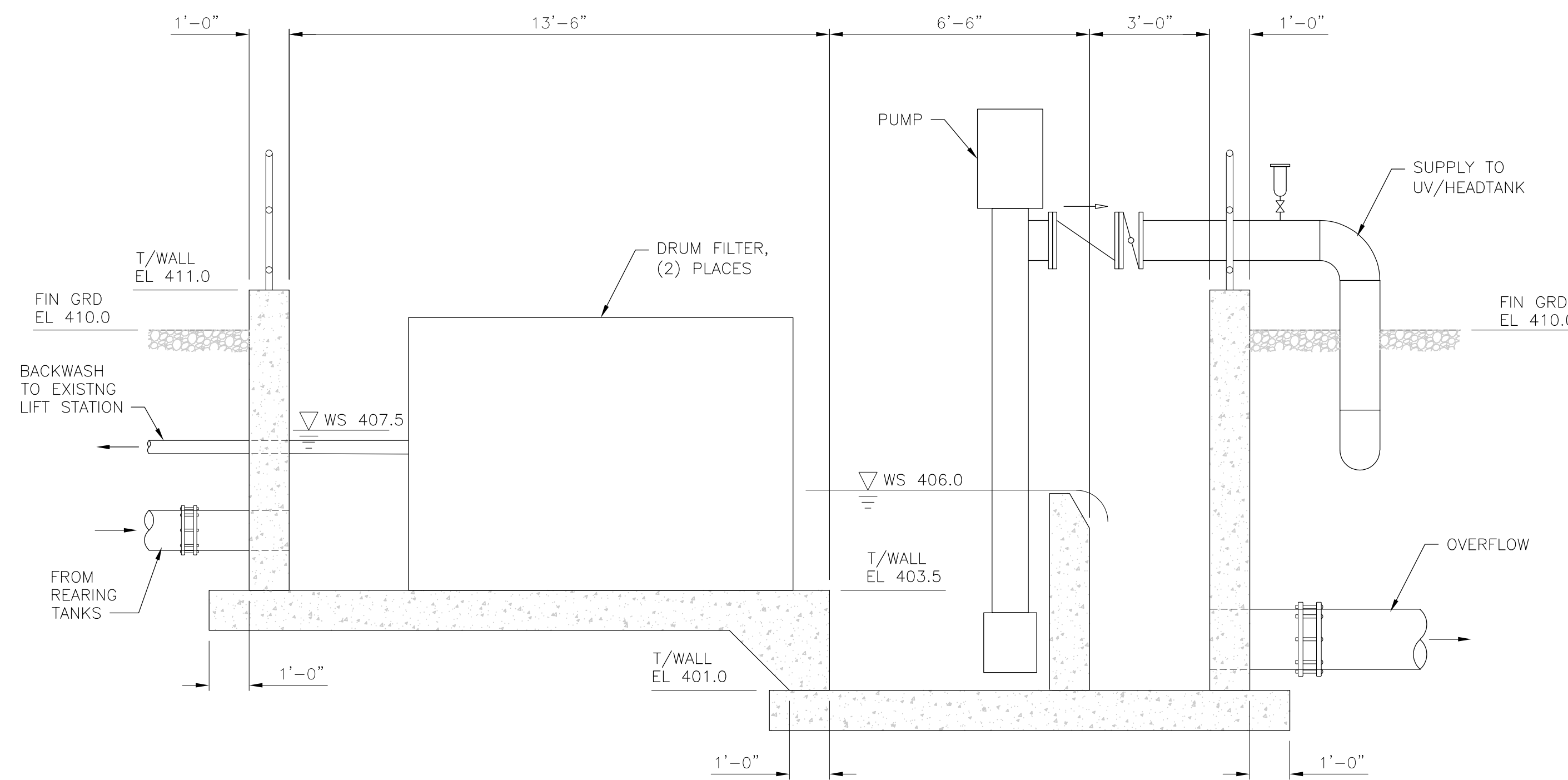

DRUM FILTER SUMP SECTION  
SCALE: 3/8" = 1'-0"  
A  
2 | 3

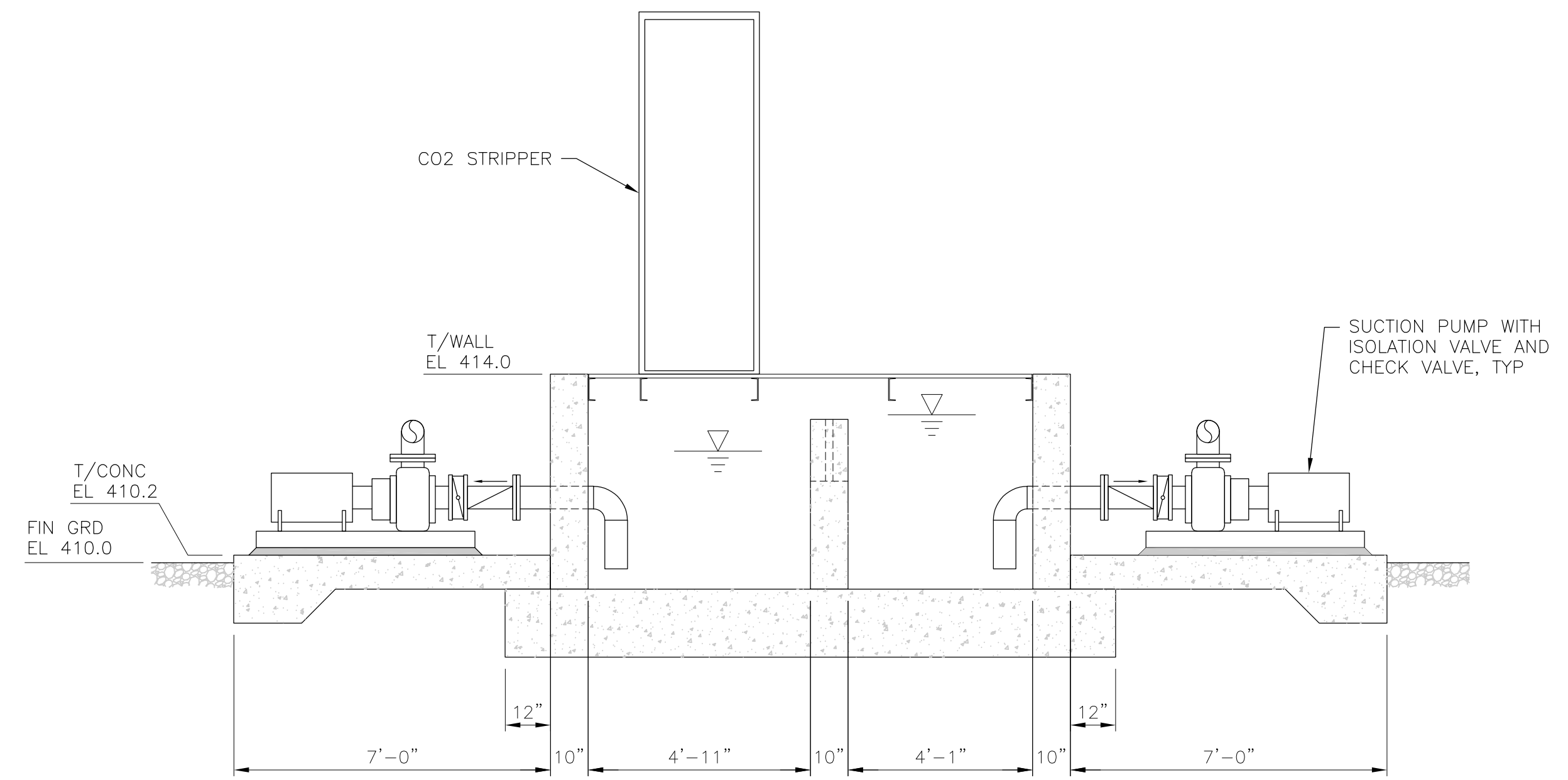

RECIRCULATION PUMP VAULT SECTION  
SCALE: 3/8" = 1'-0"  
B  
2 | 3

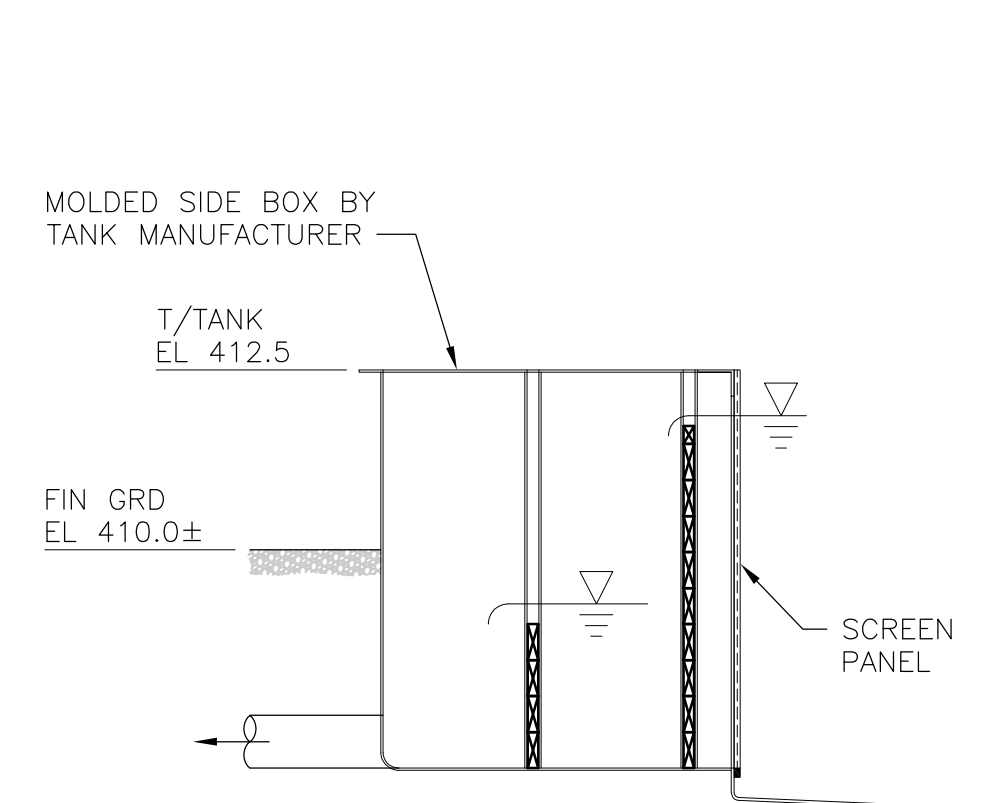

SIDE BOX SECTION  
SCALE: 1/2" = 1'-0"  
C  
2 | 3

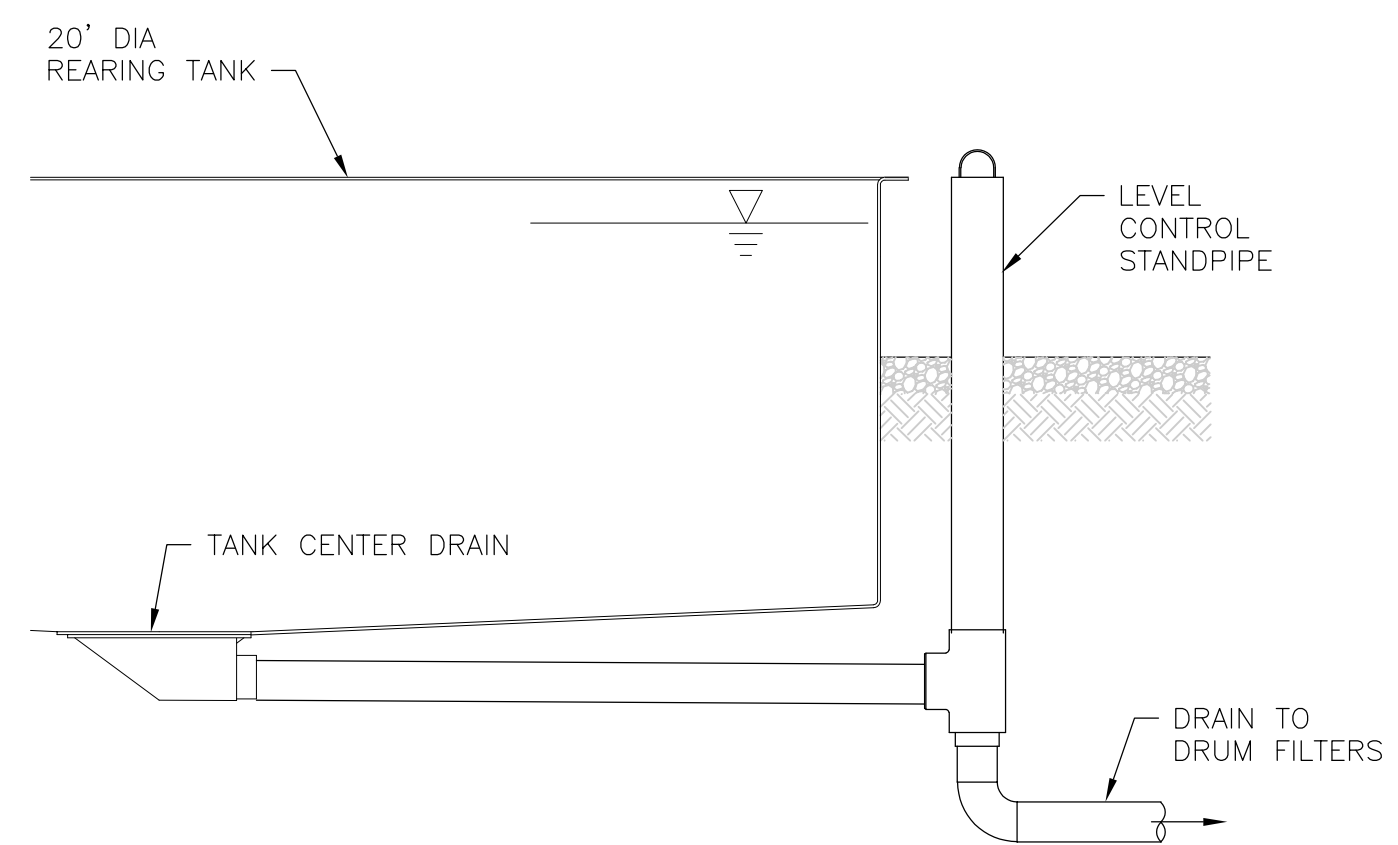

OVERFLOW / DRAIN SECTION  
SCALE: 1/2" = 1'-0"  
D  
2 | 3

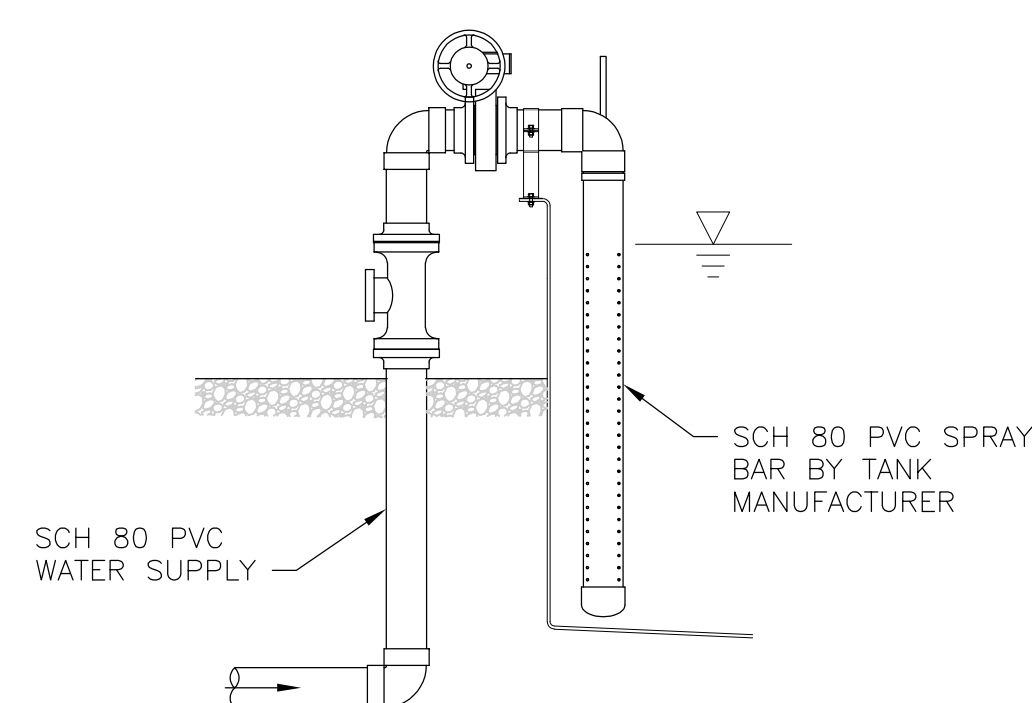

WATER SUPPLY SECTION  
SCALE: 1/2" = 1'-0"  
E  
2 | 3

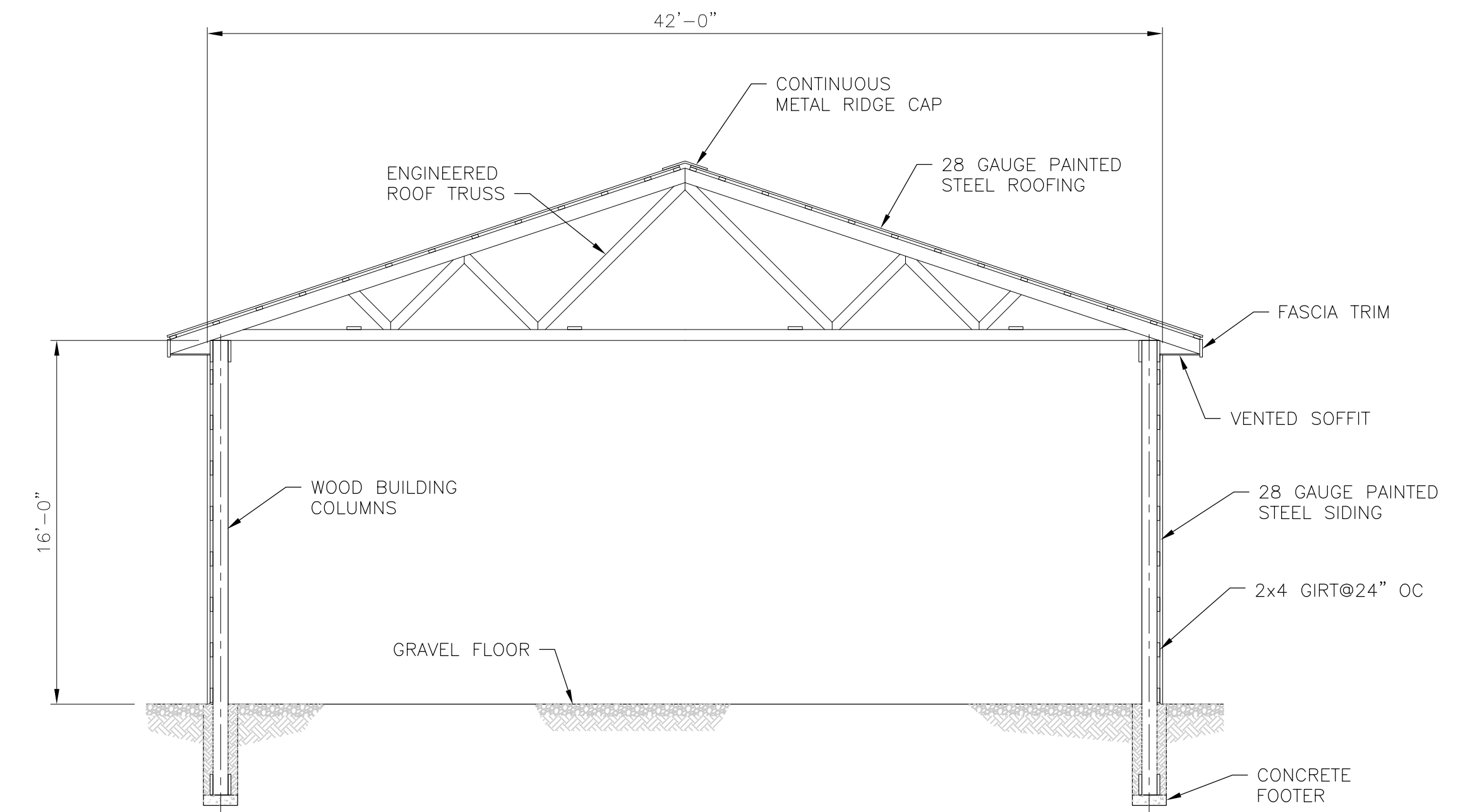

EQUIPMENT BUILDING SECTION  
SCALE: 3/16" = 1'-0"  
F  
2 | 3

WASHINGTON DEPARTMENT OF  
*FISH & WILDLIFE*

SYM	DATE	REVISION DESCRIPTION	BY
		DESIGNED BY E. ORTON	
		CHECKED BY	
		DRAWN BY A. BLAKE	
		DATE September 2, 2022	
APPROVED AND RELEASED FOR CONSTRUCTION			
CHIEF ENGINEER		DATE:	
PROGRAM		DATE:	

KENDALL CREEK HATCHERY  
CHINOOK REARING FACILITY  
SECTIONS

PROJECT NO.  
WM:H21:2022-1

SHEET OF  
3 4



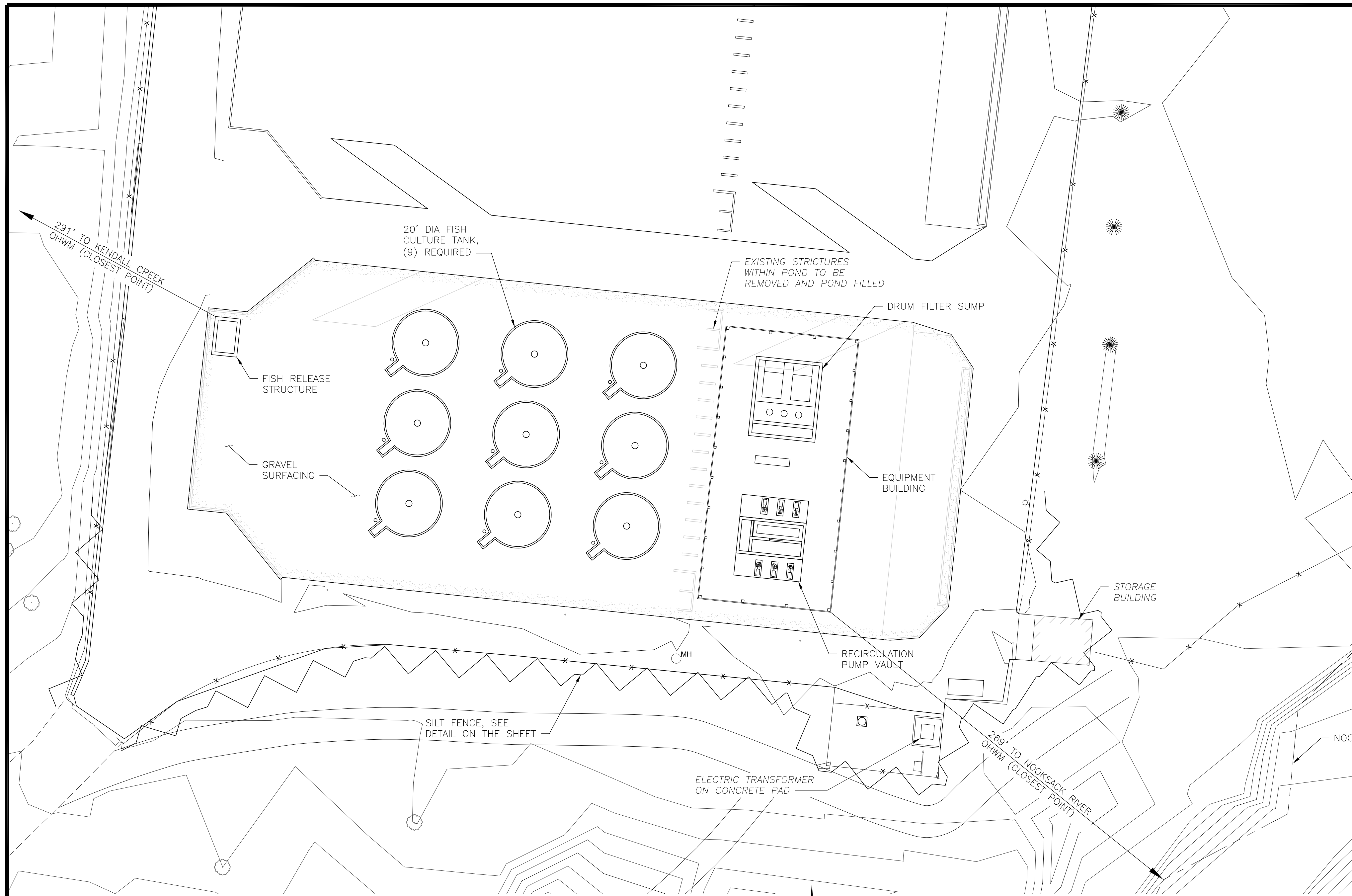

SITE PLAN

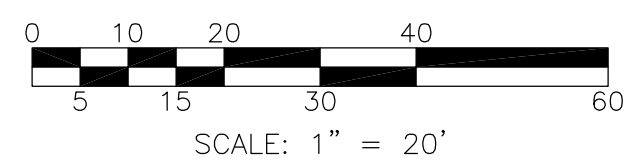

WHEN SPECIFIED IN THE CONTRACT, INSTALL BACKUP SUPPORT FOR THE GEOTEXTILE, SEE STD SPEC 8.01.3(9)A

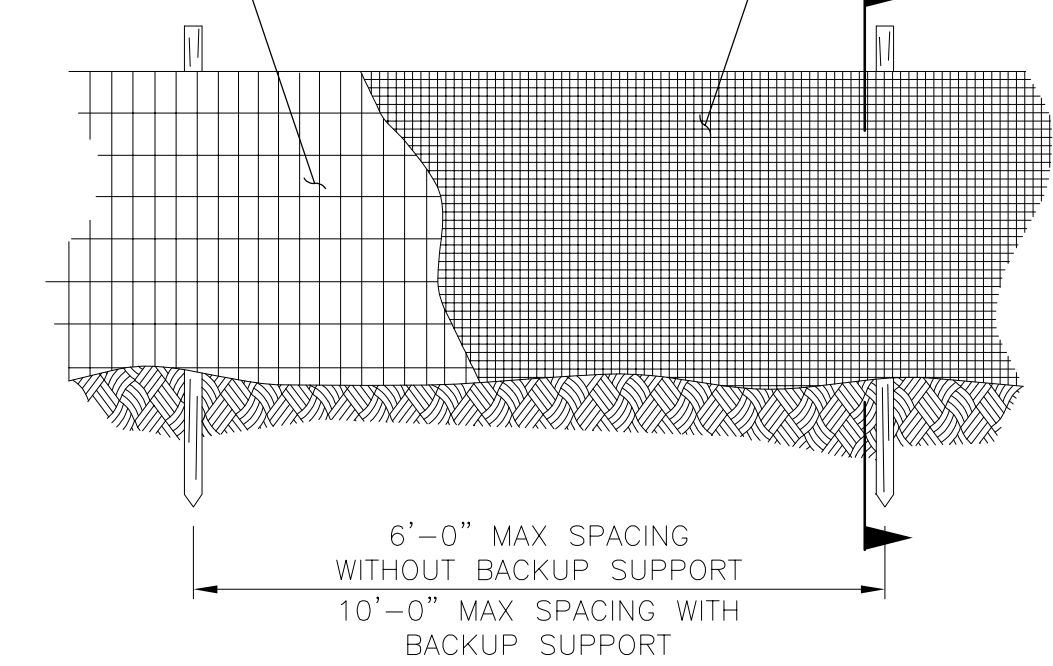

ELEVATION

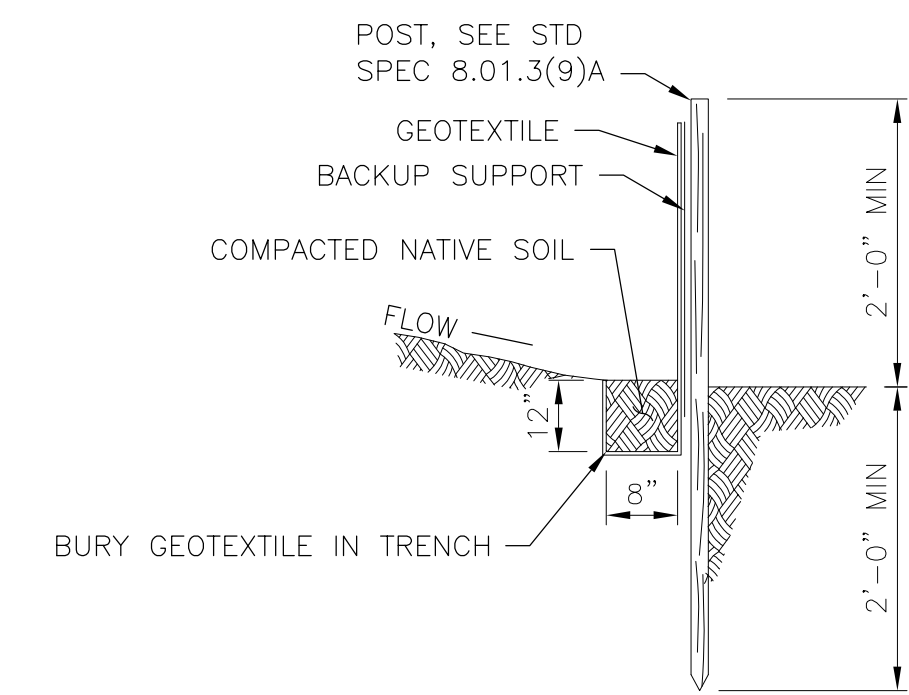

SECTION

NOTES:

1. MAXIMIZE DETENTION OF STORMWATER BY PLACING FENCE AS FAR AWAY FROM TOE OF SLOPE AS POSSIBLE WITHOUT ENCRANCHING ON SENSITIVE AREAS OR OUTSIDE OF THE CLEARING BOUNDARIES.
2. INSTALL SILT FENCING ALONG CONTOURS WHENEVER POSSIBLE.
3. INSTALL THE ENDS OF THE SILT FENCE TO POINT SLIGHTLY UP SLOPE TO PREVENT SEDIMENT FROM FLOWING AROUND THE ENDS OF THE FENCE.
4. PERFORM MAINTENANCE IN ACCORDANCE WITH PROJECT SPECIFICATIONS.

SILT FENCE  
NOT TO SCALE

WASHINGTON DEPARTMENT OF  
*FISH & WILDLIFE*

SYM	DATE	REVISION DESCRIPTION	BY
APPROVED AND RELEASED FOR CONSTRUCTION			
CHIEF ENGINEER	DATE:		CHECKED BY
PROGRAM	DATE:		DRAWN BY <u>A. BLAKE</u>
			DATE <u>September 2, 2022</u>

KENDALL CREEK HATCHERY  
CHINOOK REARING FACILITY  
STORMWATER  
BEST MANAGEMENT PRACTICES (BMPs)

PROJECT NO.  
WM:H21:2022-1

SHEET OF  
4 4