An aerial photograph of a desert landscape. A light-colored road or path runs vertically through the center of the image. At the bottom of the road, there is a small, rectangular, light-colored area. A green pin is placed on this area, and a yellow pin is placed slightly to the right and below it. The surrounding terrain is arid and brownish, with some sparse green vegetation. The text "Swakane Gun Range" is overlaid on the image, positioned above the green pin.

Swakane Gun Range

47.55449, -120.30895

STORMWATER POINT DATA				
POINT #	EASTING	NORTHING	ELEVATION	DESCRIPTION
102	1770052.69	202780.20	1188.42	SWALE START
103	1769928.19	202806.21	1179.50	SWALE END
104	1769896.53	202818.62	1179.15	SWALE START
105	1769858.94	202833.35	1179.00	SWALE END
106	1769833.35	202843.37	1178.84	SWALE START
107	1769793.29	202883.22	1173.74	SWALE END

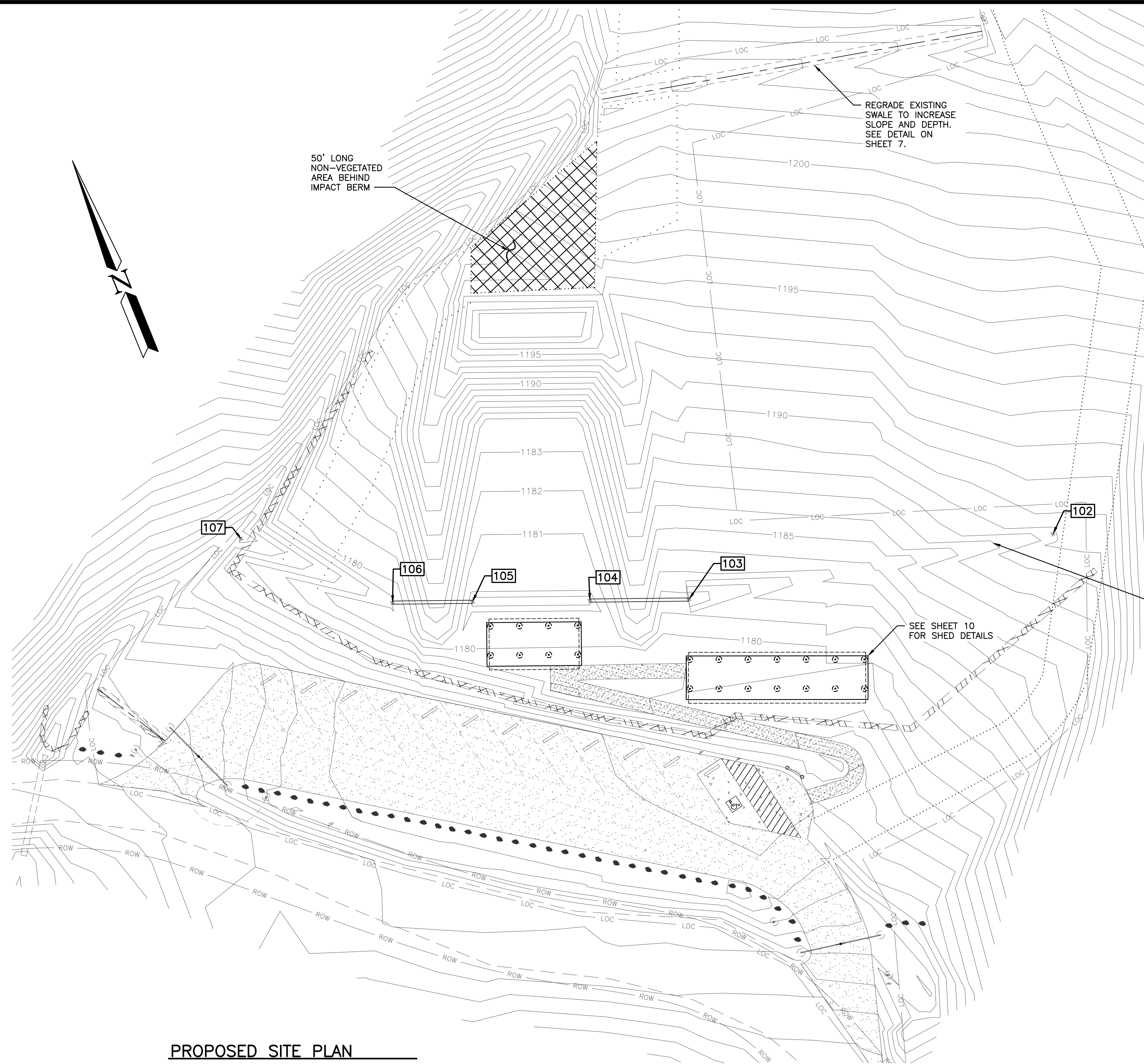

REGRADE EXISTING SWALE TO INCREASE SLOPE AND DEPTH. SEE DETAIL ON SHEET 7.

SEE SHEET 10 FOR SHED DETAILS

50' LONG NON-VEGETATED AREA BEHIND IMPACT BERM

REGRADE EXISTING SWALE TO INCREASE SLOPE AND DEPTH. SEE DETAIL ON SHEET 7.

LEGEND

- GRVEL ROAD
- ROW --- RIGHT OF WAY
- ▣ TELECOM PEDESTAL
- MINOR CONTOURS
- MAJOR CONTOURS
- FIRE BREAK
- LOC --- LIMITS OF CONSTRUCTION
- ▨ CONCRETE
- ▩ GRAVEL

PROPOSED SITE PLAN
 SCALE: 1" = 20' - 22 x 34 SHEET
 SCALE: 1" = 40' - 11 x 17 SHEET

WASHINGTON DEPARTMENT OF
FISH & WILDLIFE

NOT APPROVED FOR CONSTRUCTION. REVIEW ONLY

CHELAN WLA - SWAKANE UNIT
 SWAKANE CANYON RIFLE/PISTOL RANGE PHASE 2
 PROPOSED SITE PLAN

PROJECT NO.
CN:R21:2022-1
 SHEET 6 OF 12

DESIGNED BY J. HANSEN
 CHECKED BY
 DRAWN BY N. WHITE
 DATE 12-15-2022

REVISION DESCRIPTION
 APPROVED AND RELEASED FOR CONSTRUCTION
 DATE: DATE: DATE: