

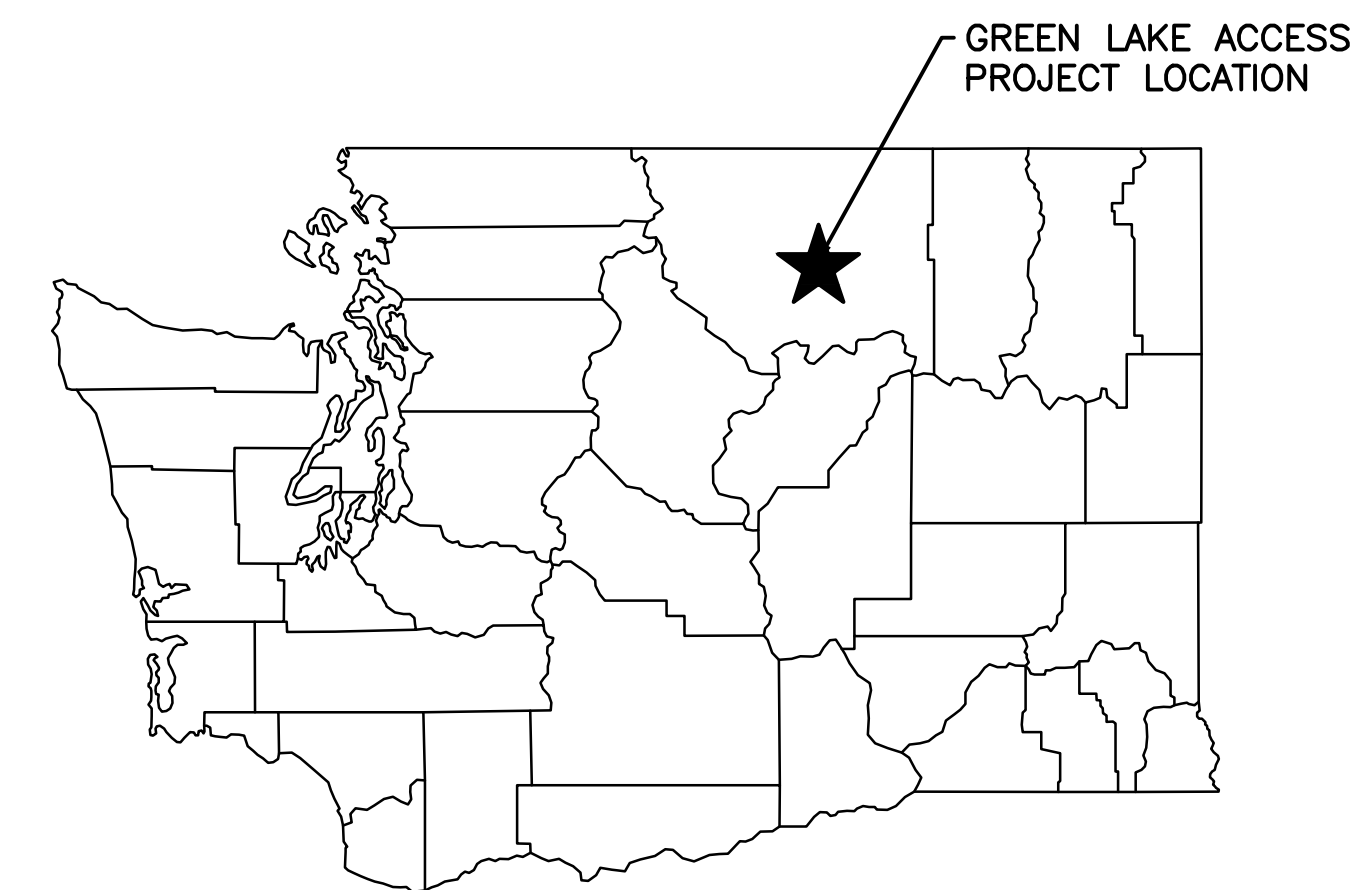

# WASHINGTON DEPARTMENT OF FISH AND WILDLIFE

## GREEN LAKE ACCESS AREA CAMPGROUND IMPROVEMENTS ON:A345:2024-1



STATE MAP  
NOT TO SCALE

### PROJECT INFORMATION

**ADDRESS:**  
GREEN LAKE RD  
OKANOGAN, WA 98840

**LOCATION:**  
LAT: 48.45119 N  
LONG -119.62713  
SECTION: S13  
TOWNSHIP: T34N  
RANGE: R25E W.M.  
PARCELS: 3425131005  
AREA: 21.17 ACRES

**OWNER:**  
WASHINGTON STATE DEPARTMENT OF FISH AND WILDLIFE  
600 CAPITAL WAY N.  
OLYMPIA, WA 98501  
(360-902-8300)  
DONALD C. PONDER, PE CHIEF ENGINEER  
KELLY SMITH, PROJECT MANAGER

### SHEET INDEX

- | #  | SHEET TITLE                                 |
|----|---|
| 1  | COVER, STATE & VICINITY MAPS                |
| 2  | PARCEL AND EXISTING SITE PLANS              |
| 3  | CRITICAL AREA AND PROPOSED SITE PLAN        |
| 4  | CAMPING AREA AND BANK STABILIZATION         |
| 5  | ENLARGED BANK STABILIZATION                 |
| 6  | GRAVEL DRIVE, CAMPING AREA B PLAN & PROFILE |
| 7  | ENLARGED CAMPING AREA                       |
| 8  | PARKING LOT, GEOGRID PATH PLAN & PROFILE    |
| 9  | BANK STABILIZATION DETAIL                   |
| 10 | GEOWEB PATH AND ROUND RAIL FENCE DETAILS    |
| 11 | KIOSK AND SIGN PLAN                         |

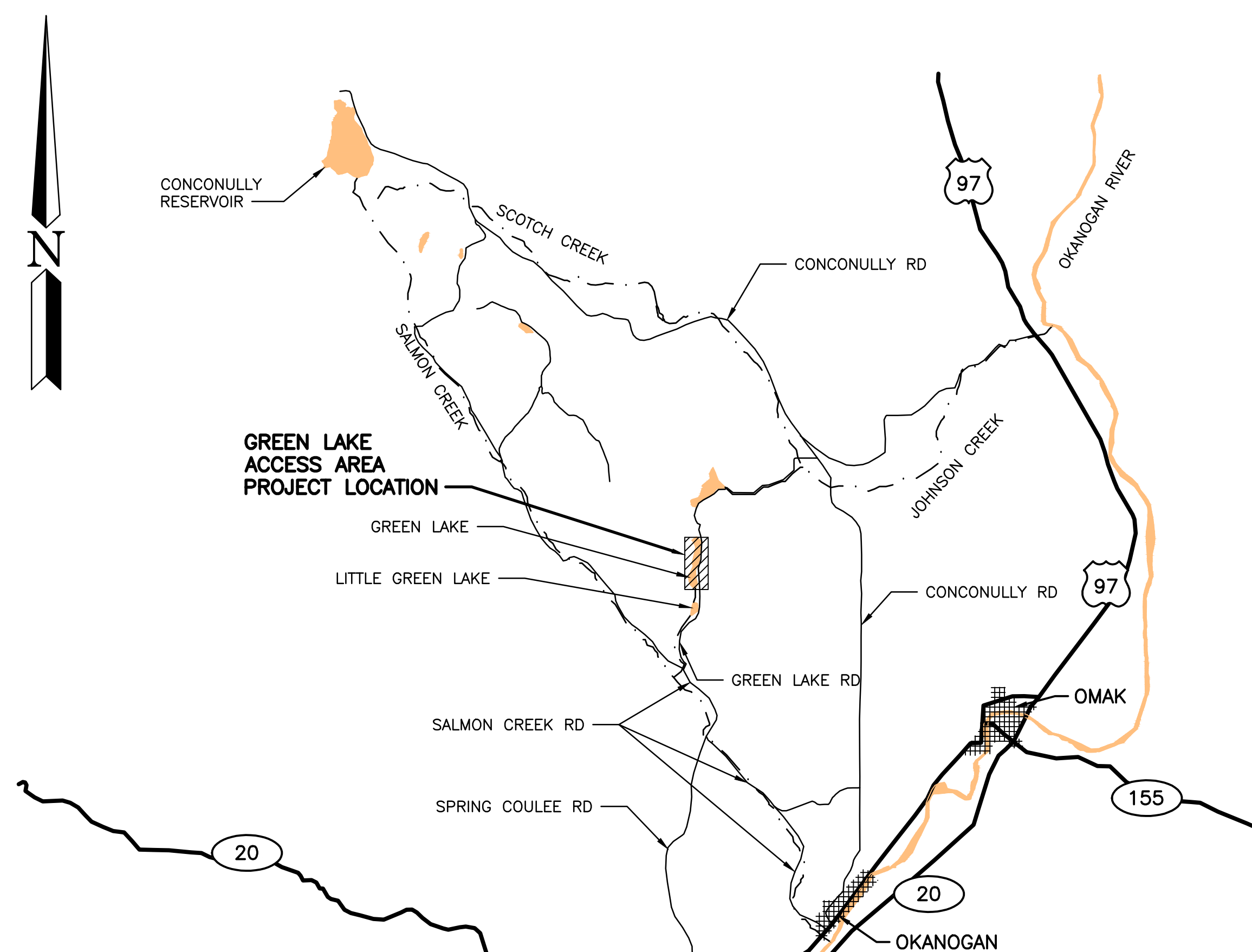

VICINITY MAP  
NOT TO SCALE

- DIRECTIONS**
- FROM THE CITY OF OKANOGAN HEAD NW ON TYEE ST FROM 2ND AVE
  - TURN LEFT ONTO 5TH AVE S
  - TURN RIGHT ONTO MILL ST.
  - AFTER .5 MILES CONTINUE ONTO SALMON CREEK RD FOR 3.5 MILES
  - TURN RIGHT TO STAY ON SALMON CREEK FOR 1.4 MILES
  - TURN RIGHT ON GREEN LAKE RD.
  - CONTINUE FOR 1.1 MILES. DESTINATION IS ON THE LEFT.

### ABBREVIATIONS

ALUM	-	ALUMINUM
L	-	ANGLE
APPROX	-	APPROXIMATELY
BM	-	BENCH MARK
CL	-	CENTERLINE
CMP	-	CORRUGATED METAL PIPE
CLR	-	CLEARANCE
CONC	-	CONCRETE
CSBC	-	CRUSHED SURFACE BASE COURSE
CSTC	-	CRUSHED SURFACE TOP COURSE
DIA	-	DIAMETER
ELEV	-	ELEVATION
FB	-	FLAT BAR
FTG	-	FOOTING
GALV	-	GALVANIZED
ID	-	INSIDE DIAMETER
IE	-	INVERT ELEVATION
MFG	-	MANUFACTURER'S
MISC	-	MISCELLANEOUS
OC	-	ON CENTER
OD	-	OUTSIDE DIAMETER
PL	-	PLATE
REQ'D	-	REQUIRED
SEC	-	SECTION
SPEC'S	-	PROJECT SPECIFICATIONS
SS	-	STAINLESS STEEL
TYP	-	TYPICAL
WS	-	WATER SURFACE

### SHEET SYMBOLS

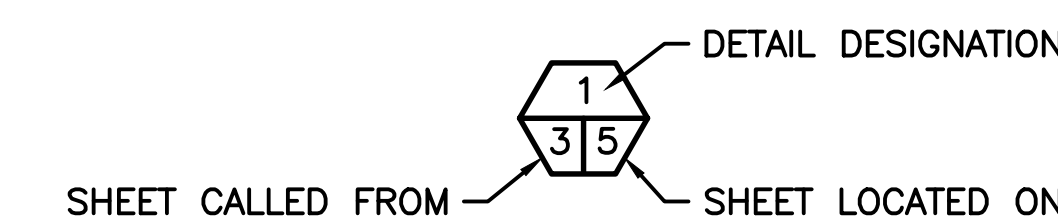

#### DETAIL

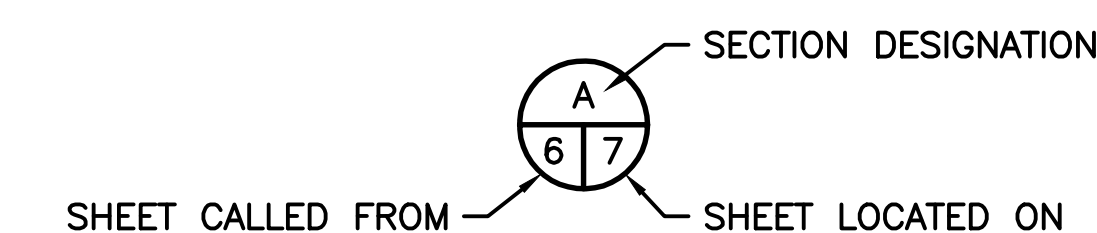

#### SECTION

NOT APPROVED  
FOR  
CONSTRUCTION

PROJECT NO. ON:A345:2024-1	
SHEET 1	OF 11



PARCEL #:3425123005  
OWNER: HASHKNIFE RANCH INC  
ACRES: 769.9

PARCEL #:3426073005  
OWNER: HASHKNIFE RANCH INC  
ACRES: 156.36

PARCEL #:3426184004  
OWNER: HASHKNIFE RANCH INC  
ACRES: 76.00

PARCEL #:3425134005  
OWNER: HASHKNIFE RANCH INC  
ACRES: 494.25

PARCEL #:3425131005  
OWNER: WA STATE DEPT. OF  
FISH & WILDLIFE  
ACRES: 146.73

PARCEL #:3425131005  
OWNER: WA STATE DEPT. OF  
FISH & WILDLIFE  
ACRES: 146.73

PARCEL #: N/A  
OWNER: BLM  
ACRES: 120.00

PARCEL #:8879050200  
OWNER: TROVELL, TIMOTHY & SUSAN  
ACRES: 46.89

CONTROL POINT 1050  
REBAR AND CAP  
N: 528322.2870'  
E: 1932827.1250'  
ELEV: 1566.647'

CONTROL POINT 1051  
REBAR AND CAP  
N: 531761.2290'  
E: 1933093.7490'  
ELEV: 1571.229'

CONTROL POINT 1051  
REBAR AND CAP  
N: 531761.2290'  
E: 1933093.7490'  
ELEV: 1571.229'

**SURVEY DATUM**  
**VERTICAL DATUM**  
NAVD 88 DERIVED OPUS SOLUTION, ESTABLISHED FROM APRIL 2021 SURVEY.  
**SURVEY REFERENCE**  
RECORD OF SURVEY BY DEPT. OF GAME WDFW TOPOGRAPHIC SURVEY APRIL 2021  
**BASIS OF BEARING**  
WASHINGTON STATE PLANE NORTH ZONE. NAD 83/11 DERIVED FROM OPUS SOLUTION

**PARCEL SITE PLAN**  
1"=300' 22x34  
0 100 300 600 1"=600' 11x17

**EXISTING SITE PLAN**  
1"=100' 22x34  
0 50 100 200 1"=200' 11x17

LEGEND	
	EXISTING GRAVEL ROAD
	NEW GRAVEL ROAD
	EXISTING MAJOR CONTOURS
	FINISHED MAJOR CONTOURS
	EXISTING FENCE
	GRAVEL
	BUFF 50 GREEN LAKE OHWM 50' BUFFER
	OHWM ORDINARY HIGH WATER MARK
	WETLAND AREA
	WET A WETLAND A
	WBA WETLAND A 100' BUFFER
	WET B WETLAND B
	WBB WETLAND B 100' BUFFER
	WET C WETLAND C
	WBC WETLAND C 100' BUFFER

WASHINGTON DEPARTMENT OF  
**FISH & WILDLIFE**

**NOT APPROVED FOR CONSTRUCTION. REVIEW ONLY**

DESIGNED BY K. SMITH  
CHECKED BY S. GOODWIN  
DRAWN BY SS/SG  
DATE 2/3/2025

**GREEN LAKE ACCESS AREA**  
**CAMPGROUND IMPROVEMENTS**  
**PARCEL AND EXISTING SITE PLANS**

PROJECT NO.  
ON:A345:2024-1  
SHEET 2 OF 11

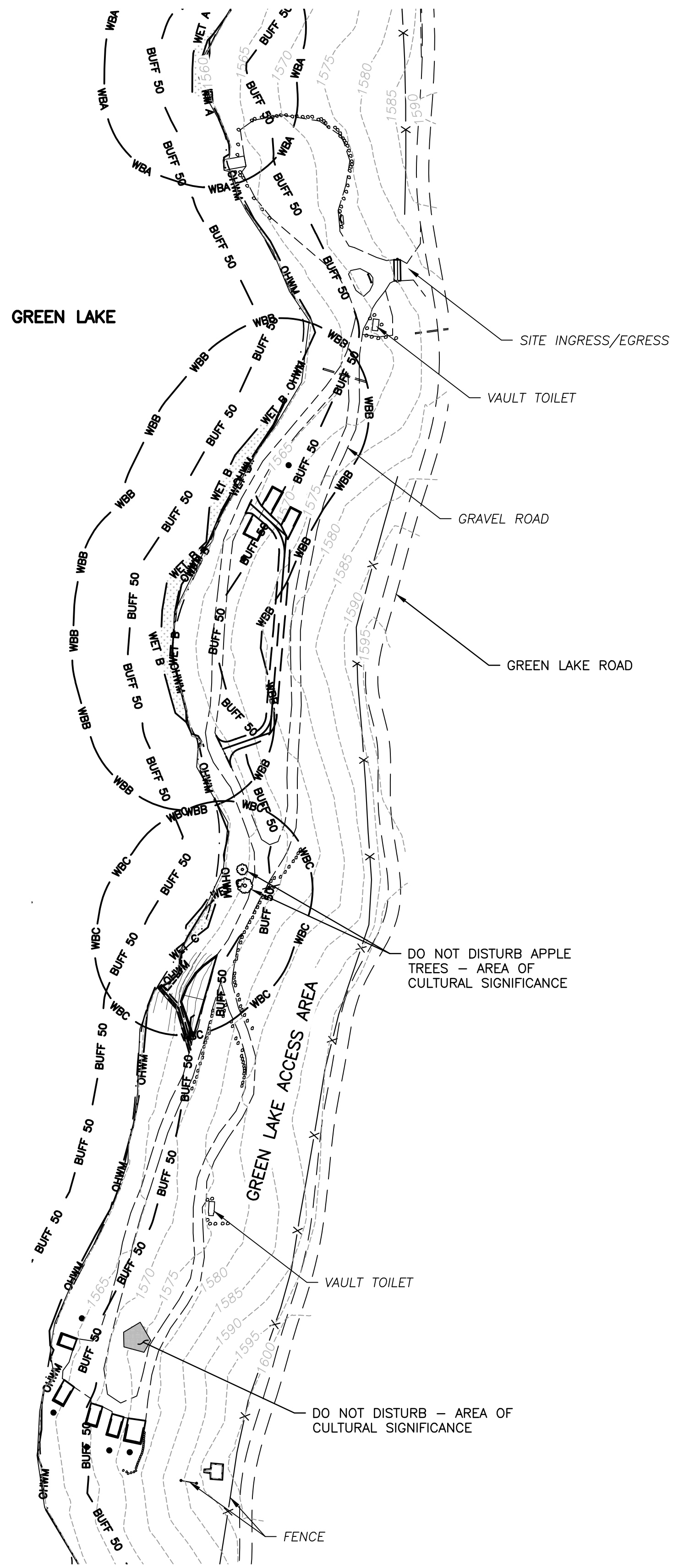
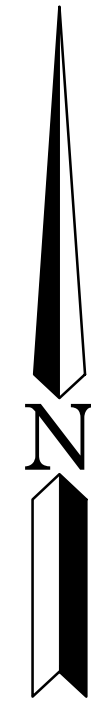
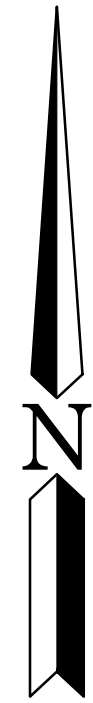

**CRITICAL AREAS PLAN**

0 50 100 200 1"=100' 22x34  
1"=200' 11x17

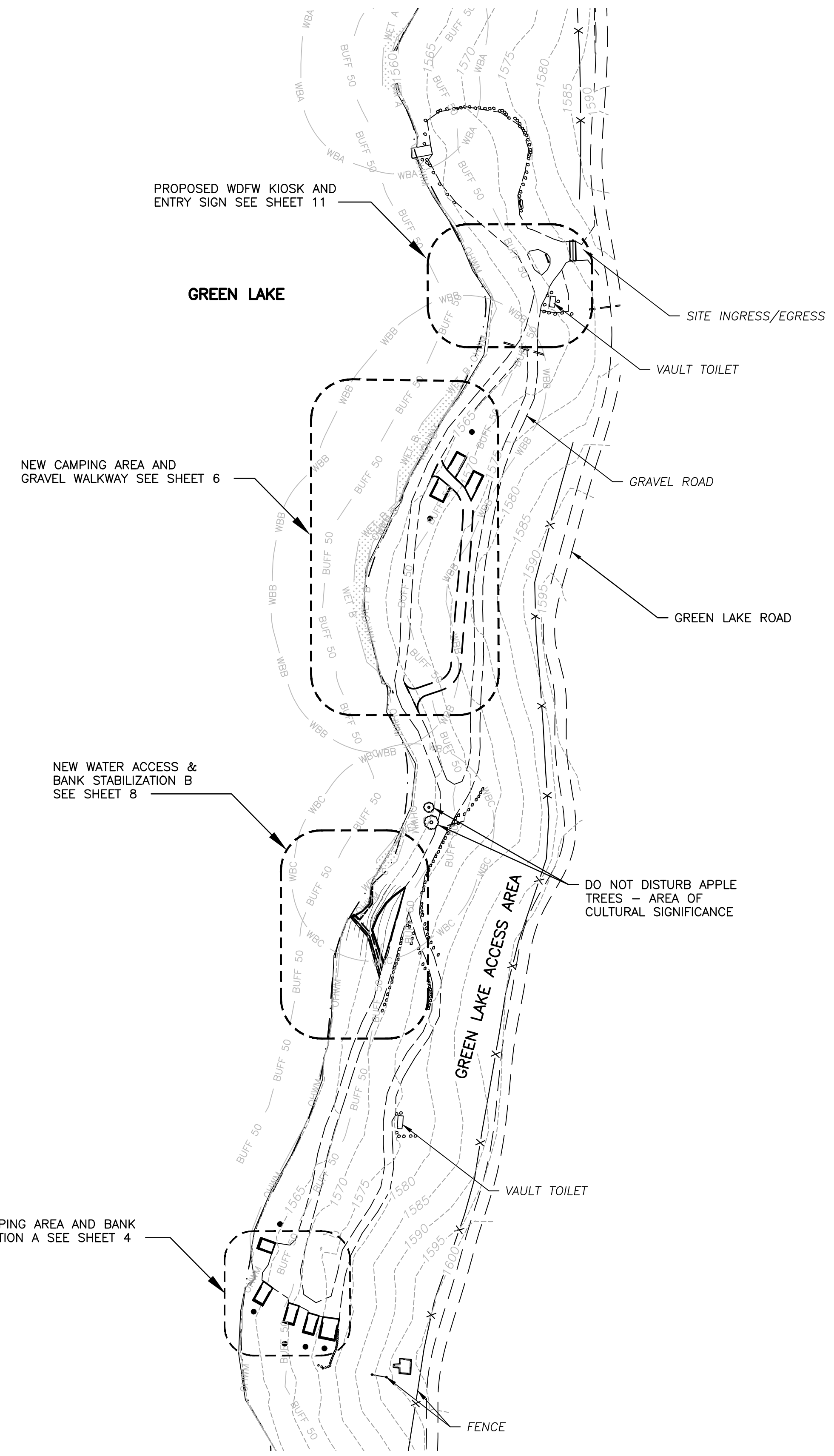

**PROPOSED SITE PLAN**

0 50 100 200 1"=100' 22x34  
1"=200' 11x17

CUT & FILL DATA						
MATERIAL	CUBIC YARDS ABOVE OHW		CUBIC YARDS BELOW OHW		SQ.FT. OF IMPACT	
	CUT	FILL	CUT	FILL	ABOVE OHW	BELOW OHW
GRAVEL	0	148	0	0	8821	0
NATIVE MATERIAL	20	20	0	0	206	0
TOTAL	20	168	0	0	9027	0

NET FILL: 148 CY

LEGEND	
---	EXISTING GRAVEL ROAD
---	NEW GRAVEL ROAD
---	EXISTING MAJOR CONTOURS
---	FINISHED MAJOR CONTOURS
-X-	EXISTING FENCE
▨	GRAVEL
---	GREEN LAKE OHWM 50' BUFFER
---	ORDINARY HIGH WATER MARK
▨	WETLAND AREA
---	WET A WETLAND A
---	WBA WETLAND A 100' BUFFER
---	WET B WETLAND B
---	WBB WETLAND B 100' BUFFER
---	WET C WETLAND C
---	WBC WETLAND C 100' BUFFER

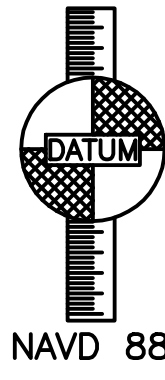

NAVD 88

WASHINGTON DEPARTMENT OF  
**FISH & WILDLIFE**

**NOT APPROVED FOR CONSTRUCTION. REVIEW ONLY**

0 1" BAR MEASURES ONE INCH ON 22x34 DRAWINGS  
DESIGNED BY K. SMITH  
CHECKED BY S. GOODWIN  
DRAWN BY SS/SG  
DATE 2/3/2025

GREEN LAKE ACCESS AREA  
CAMPGROUND IMPROVEMENTS  
CRITICAL AREA AND PROPOSED SITE PLAN

PROJECT NO.  
ON:A345:2024-1  
SHEET 3 OF 11

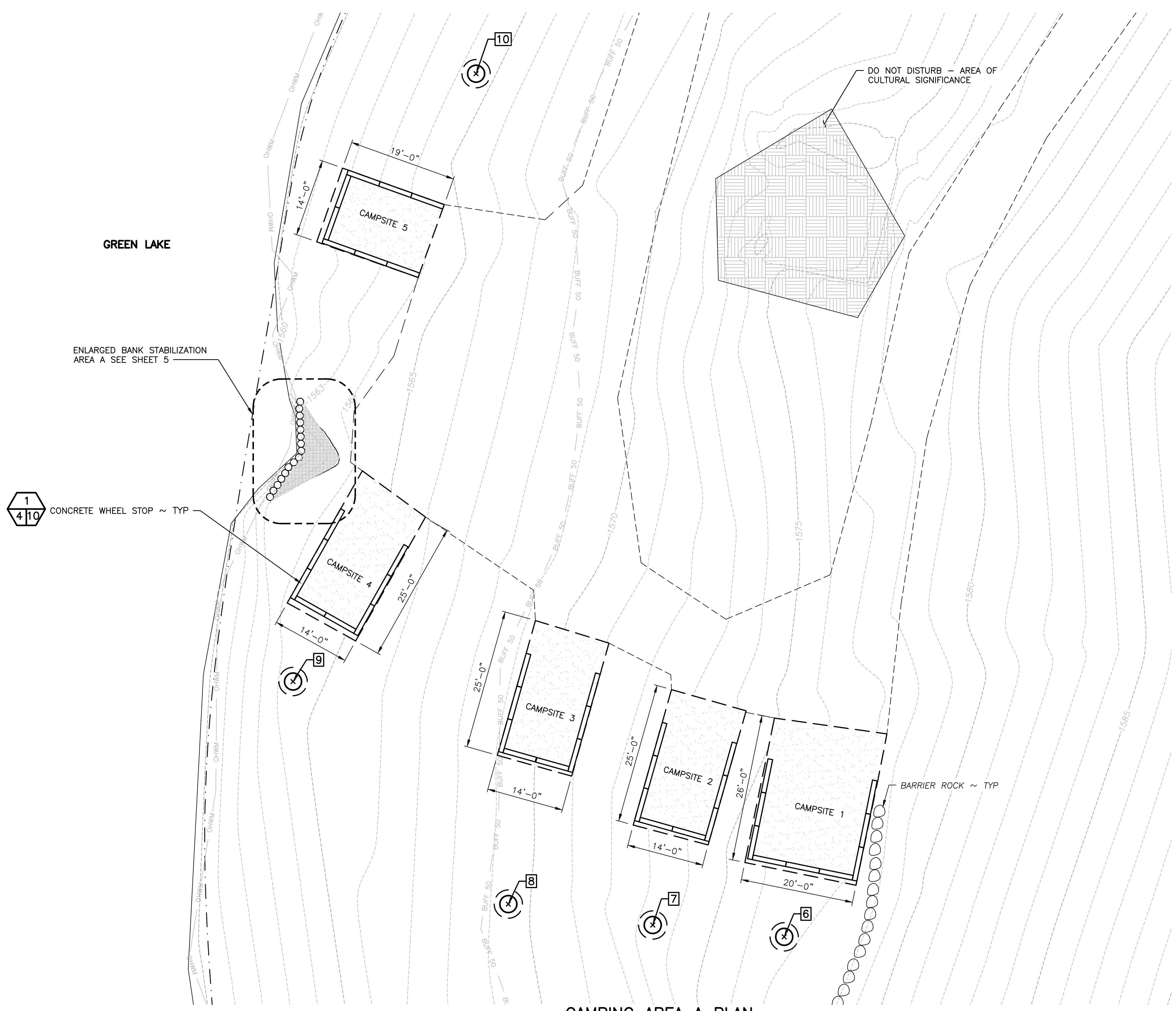

- NOTES:**
- EXISTING CAMPSITE PADS REQUIRE CLEARING AND GRUBBING, SETTING WHEEL STOPS AND LAYING 4" OF GRAVEL. CUTTING INTO THE GROUND WILL MITIGATE THE RISK OF GRAVEL DISPLACEMENT DUE TO WASHING AWAY
  - REMOVE VEGETATION, BRUSH, LARGE ROCKS FROM TENT PAD LOCATIONS
  - GRUB AND GRADE UNDER EACH FIRE PIT. ENSURE THE FIRE PIT IS LEVEL ON A GRAVEL BASE BOTH BENEATH AND SURROUNDING IT. THE FIRE PIT HAS A MINIMUM COOKING SURFACE HEIGHT OF 15" TO 34" MAX WITH AN EXTENSION OF 48" OF GRAVEL FROM THE PERIMETER OF THE PIT
  - BANK STABILIZATION SHOULD SPAN THE WIDTH OF ERODED AREA

POINT DATA				
POINT #	NORTHING	EASTING	ELEVATION	DESCRIPTION
6	530237.96	1932911.21	1576.84	FIRE PIT 1
7	530240.04	1932888.02	1573.23	FIRE PIT 2
8	530243.74	1932862.54	1569.42	FIRE PIT 3
9	530282.98	1932824.57	1564.27	FIRE PIT 4
10	530390.18	1932856.86	1564.47	FIRE PIT 5

LEGEND	
	EXISTING GRAVEL ROAD
	NEW GRAVEL ROAD
	EXISTING MAJOR CONTOURS
	GRAVEL
	GREEN LAKE OHWM 50' BUFFER
	ORDINARY HIGH WATER MARK

WASHINGTON DEPARTMENT OF  
**FISH & WILDLIFE**

**NOT APPROVED FOR CONSTRUCTION. REVIEW ONLY**

DESIGNED BY K. SMITH  
CHECKED BY S. GOODWIN  
DRAWN BY SS/SG  
DATE 2/3/2025

0 1" BAR MEASURES ONE INCH ON 22x34 DRAWINGS

GREEN LAKE ACCESS AREA  
CAMPGROUND IMPROVEMENTS  
CAMPING AREA AND BANK STABILIZATION

PROJECT NO.  
ON:A345:2024-1

SHEET 4 OF 11

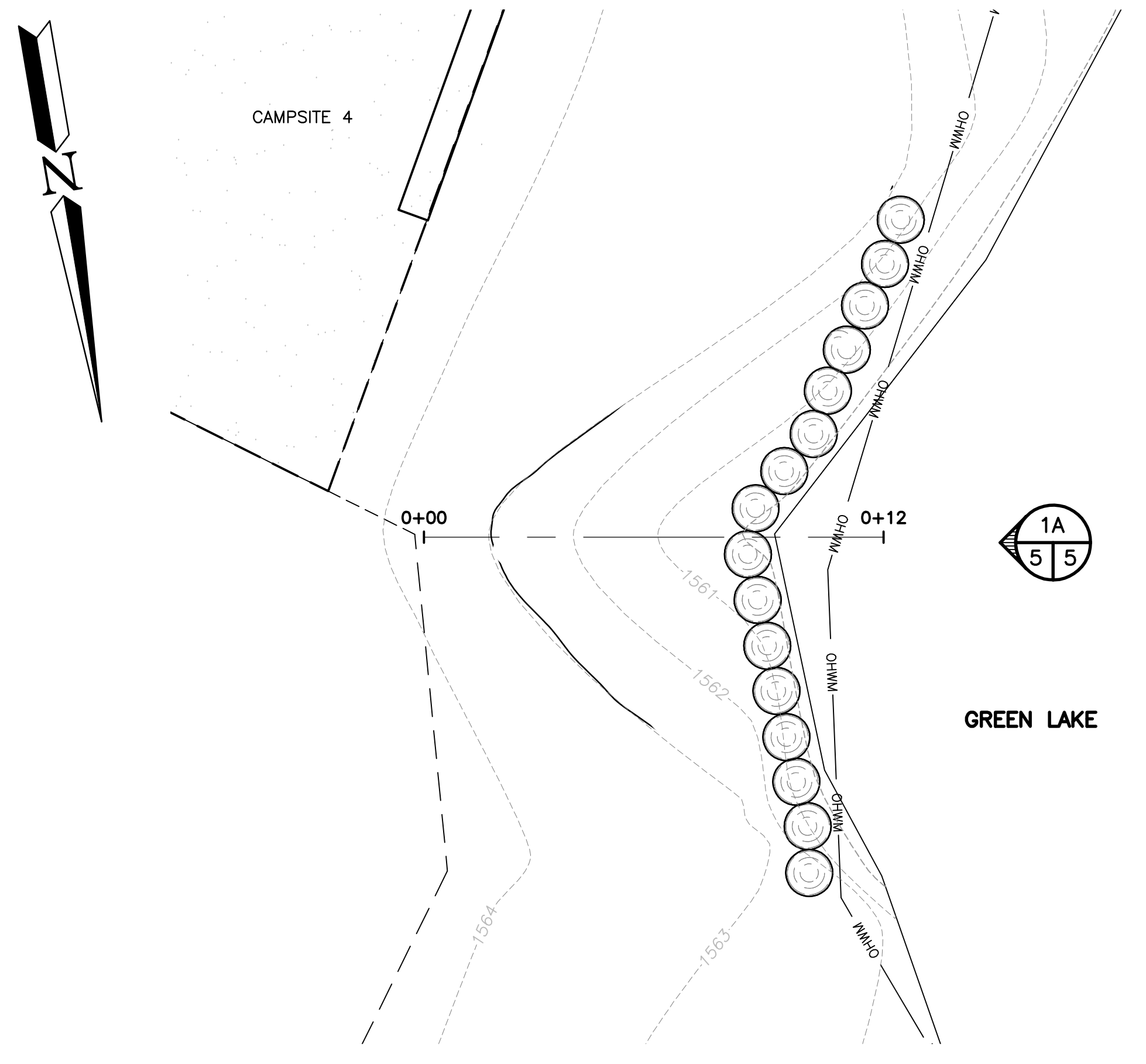

**ENLARGED BANK STABILIZATION A PLAN**

0 1 3 6  
 1"=3' 22x34  
 1"=6' 11x17

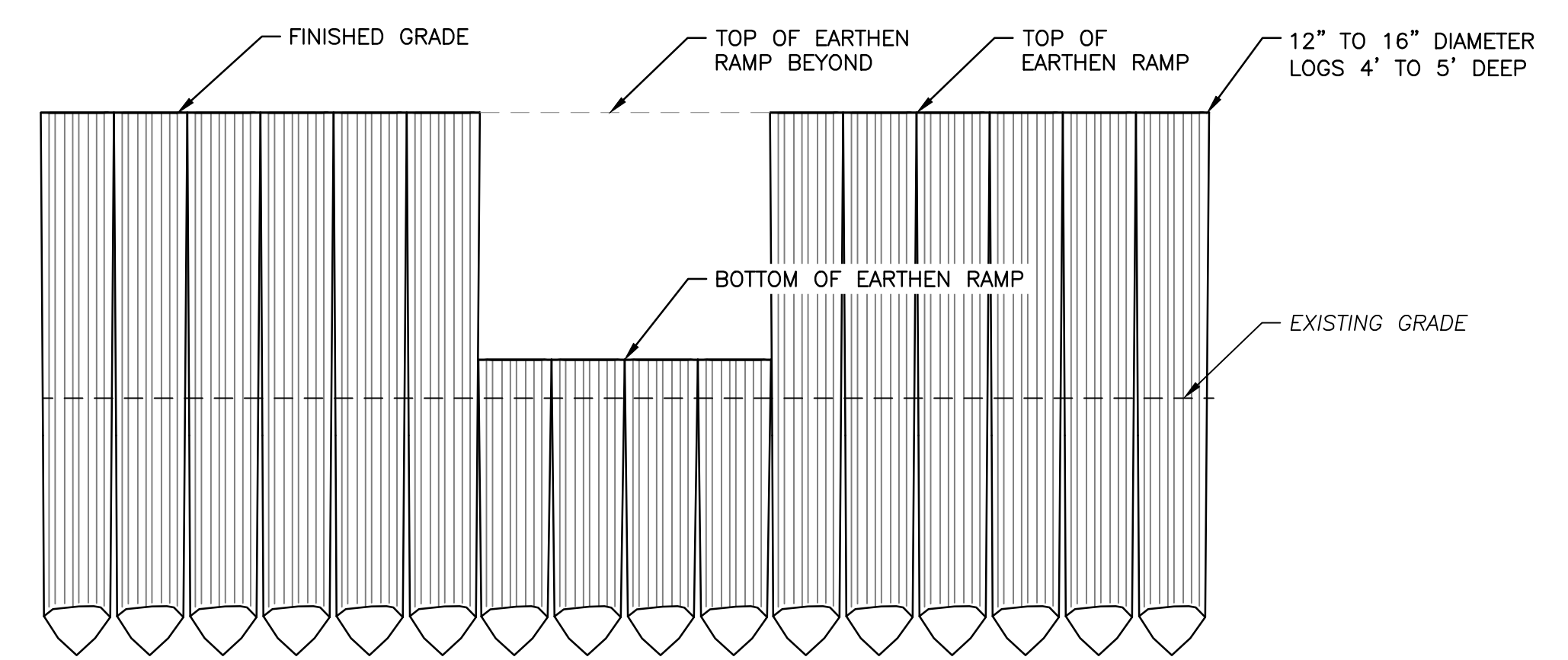

**BANK STABILIZATION A ELEVATION** 1A  
 NOT TO SCALE 5 5

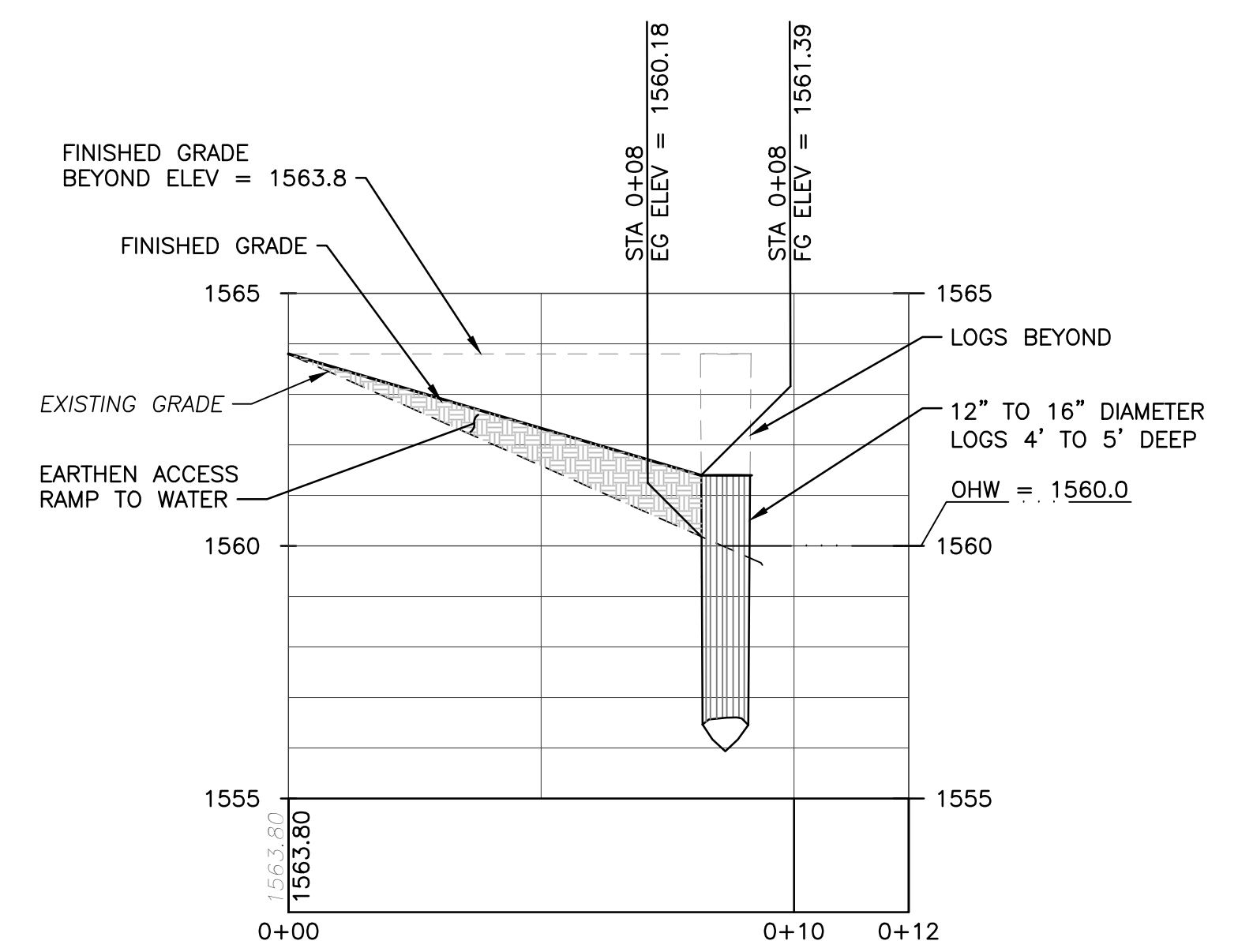

**ENLARGED BANK STABILIZATION A PROFILE**

0 1 3 6  
 1"=3' 22x34  
 1"=6' 11x17

WASHINGTON DEPARTMENT OF  
**FISH & WILDLIFE**

**NOT APPROVED FOR CONSTRUCTION. REVIEW ONLY**

DESIGNED BY K. SMITH  
 CHECKED BY S. GOODWIN  
 DRAWN BY SS/SG  
 DATE 2/3/2025

GREEN LAKE ACCESS AREA  
 CAMPGROUND IMPROVEMENTS  
 ENLARGED BANK STABILIZATION

PROJECT NO.  
 ON:A345:2024-1

SHEET OF  
 5 11

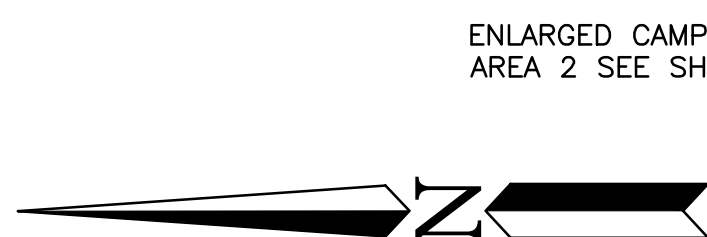

ENLARGED CAMPING AREA 2 SEE SHEET 7

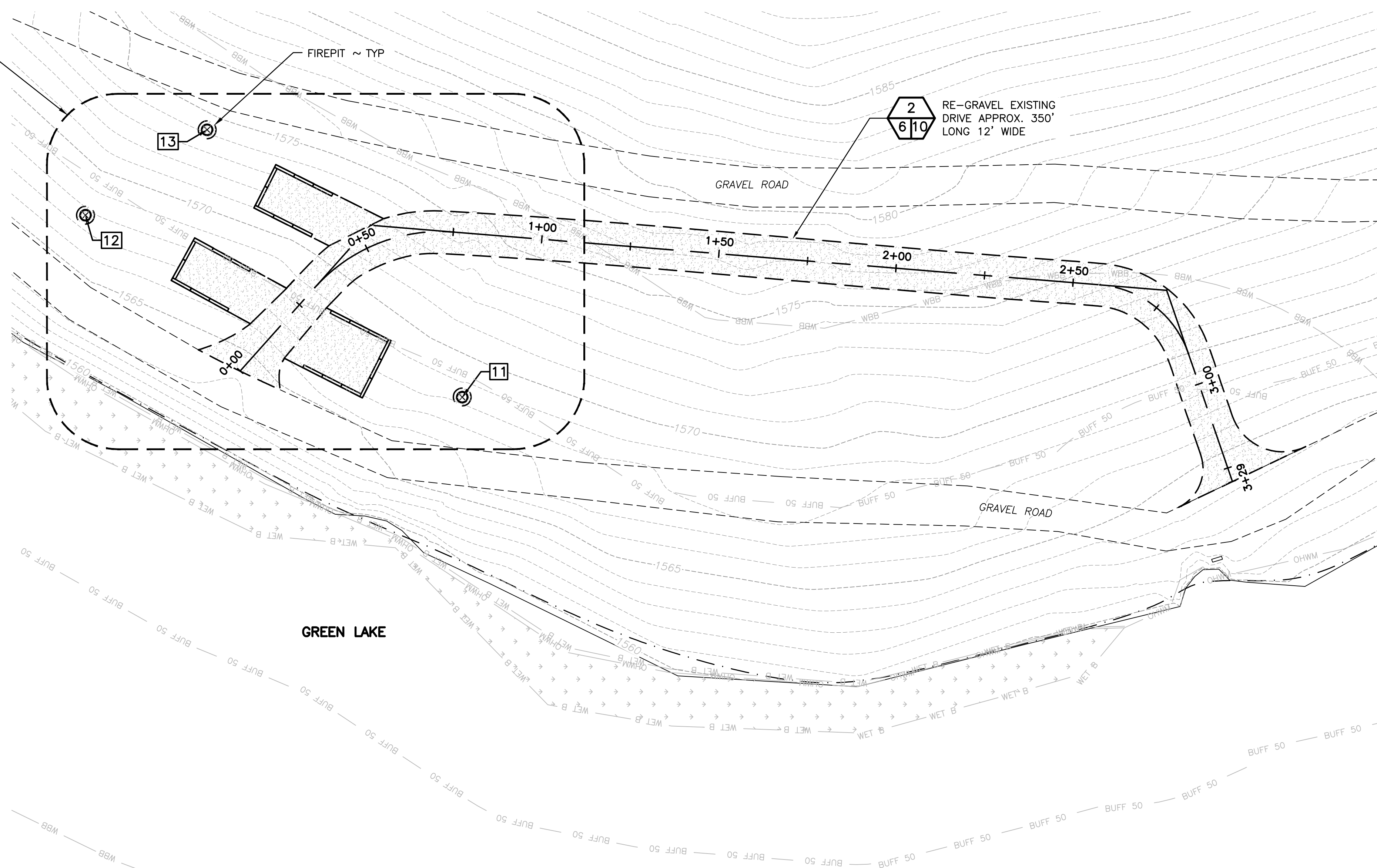

- NOTES:**
1. REMOVE VEGETATION, BRUSH, LARGE ROCKS FROM TENT PAD LOCATIONS
  2. GRUB AND GRADE UNDER EACH FIRE PIT. ENSURE FIRE PIT IS LEVEL ON A GRAVEL BASE BOTH BENEATH AND SURROUNDING IT. THE FIRE PIT HAS A MINIMUM COOKING SURFACE HEIGHT OF 15" TO 34" MAX, WITH AN EXTENSION OF 48" OF GRAVEL FROM THE PERIMETER OF THE PIT
  3. EXISTING CAMPSITE PADS REQUIRE CLEARING AND GRUBBING, SETTING WHEEL STOPS, AND LAYING 4" OF GRAVEL. CUTTING INTO THE GROUND WILL MITIGATE THE RISK OF GRAVEL DISPLACEMENT DUE TO WASHING AWAY

POINT DATA				
POINT #	NORTHING	EASTING	ELEVATION	DESCRIPTION
11	531254.12	1933040.61	3994.65	FIRE PIT 6
12	531360.15	1933091.83	1565.00	FIRE PIT 7
13	531325.91	1933115.88	1574.14	FIRE PIT 8

**GRAVEL DRIVE & CAMPING AREA B PLAN**

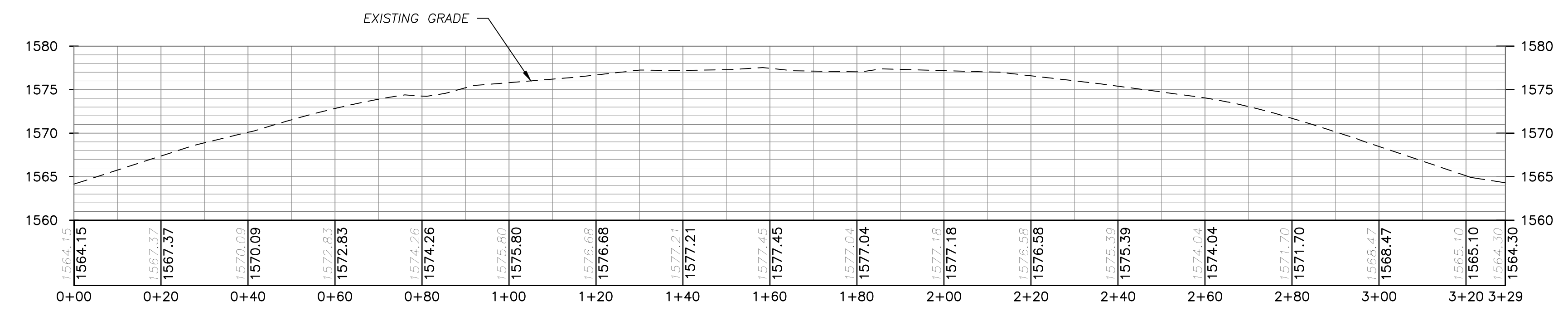
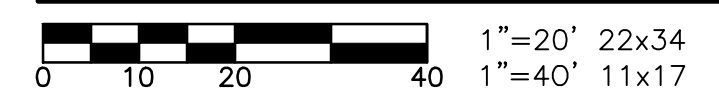

**GRAVEL DRIVE & CAMPING AREA B PROFILE**



**LEGEND**

- EXISTING GRAVEL ROAD
- NEW GRAVEL ROAD
- - - - EXISTING MAJOR CONTOURS
- ▨ GRAVEL
- BUFF 50 --- GREEN LAKE OHWM 50' BUFFER
- OHWM --- ORDINARY HIGH WATER MARK
- ▨ WETLAND AREA
- WET B --- WETLAND B
- WBB --- WETLAND B 100' BUFFER

WASHINGTON DEPARTMENT OF  
**FISH & WILDLIFE**

**NOT APPROVED FOR CONSTRUCTION. REVIEW ONLY**

DESIGNED BY K. SMITH  
CHECKED BY S. GOODWIN  
DRAWN BY SS/SG  
DATE 2/3/2025

GREEN LAKE ACCESS AREA  
CAMPGROUND IMPROVEMENTS  
GRAVEL DRIVE, CAMPING AREA B PLAN & PROFILE

PROJECT NO.  
ON:A345:2024-1  
SHEET 6 OF 11

POINT DATA				
POINT #	NORTHING	EASTING	ELEVATION	DESCRIPTION
11	531254.12	1933040.61	3994.65	FIRE PIT 6
12	531360.15	1933091.83	1565.00	FIRE PIT 7
13	531325.91	1933115.88	1574.14	FIRE PIT 8

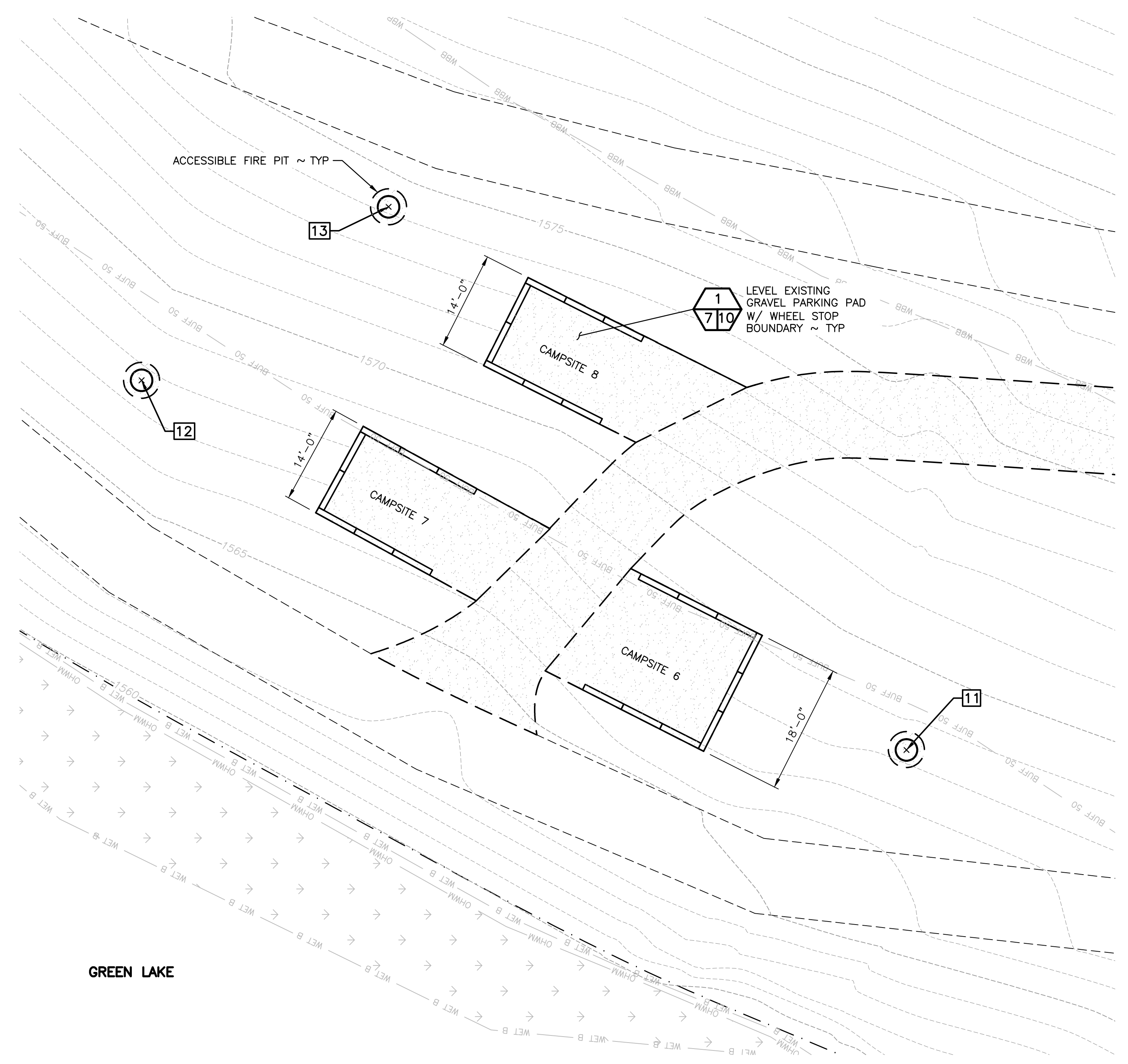

GREEN LAKE

**ENLARGED CAMP AREA B PLAN**  
 0 2 6 10 20  
 1"=10' 22x34  
 1"=20' 11x17

LEGEND	
---	EXISTING GRAVEL ROAD
---	NEW GRAVEL ROAD
---	EXISTING MAJOR CONTOURS
▨	GRAVEL
---	GREEN LAKE OHWM 50' BUFFER
---	ORDINARY HIGH WATER MARK
▨	WETLAND AREA
---	WETLAND B
---	WETLAND B 100' BUFFER

WASHINGTON DEPARTMENT OF  
**FISH & WILDLIFE**

**NOT APPROVED FOR CONSTRUCTION. REVIEW ONLY**

DESIGNED BY K. SMITH  
 CHECKED BY S. GOODWIN  
 DRAWN BY SS/SG  
 DATE 2/3/2025

0 1"  
 BAR MEASURES ONE INCH ON 22x34 DRAWINGS

GREEN LAKE ACCESS AREA  
 CAMPGROUND IMPROVEMENTS  
 ENLARGED CAMPING AREA

PROJECT NO.  
 ON:A345:2024-1

SHEET 7 OF 11

**NOTE:** BANK STABILIZATION SHOULD SPAN THE WIDTH OF ERODED AREA

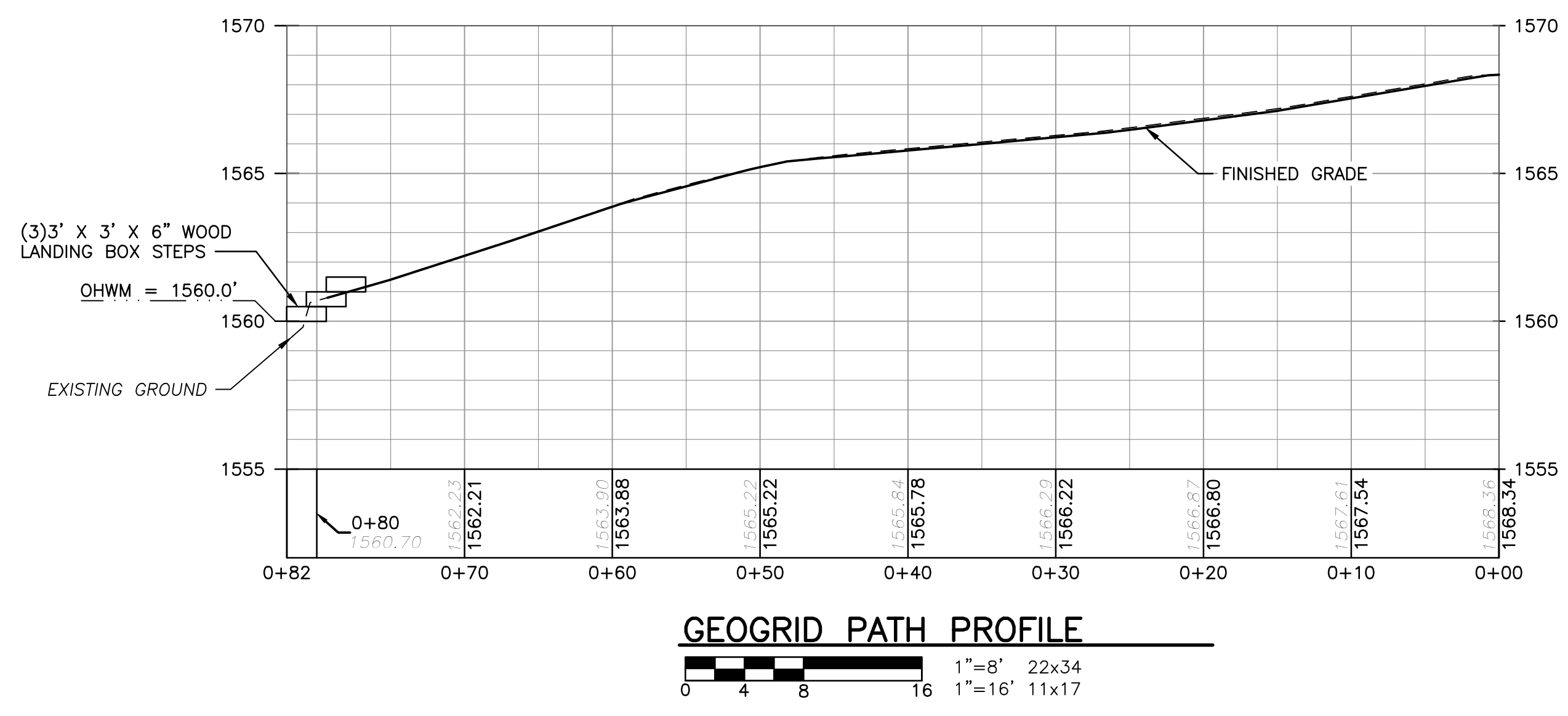
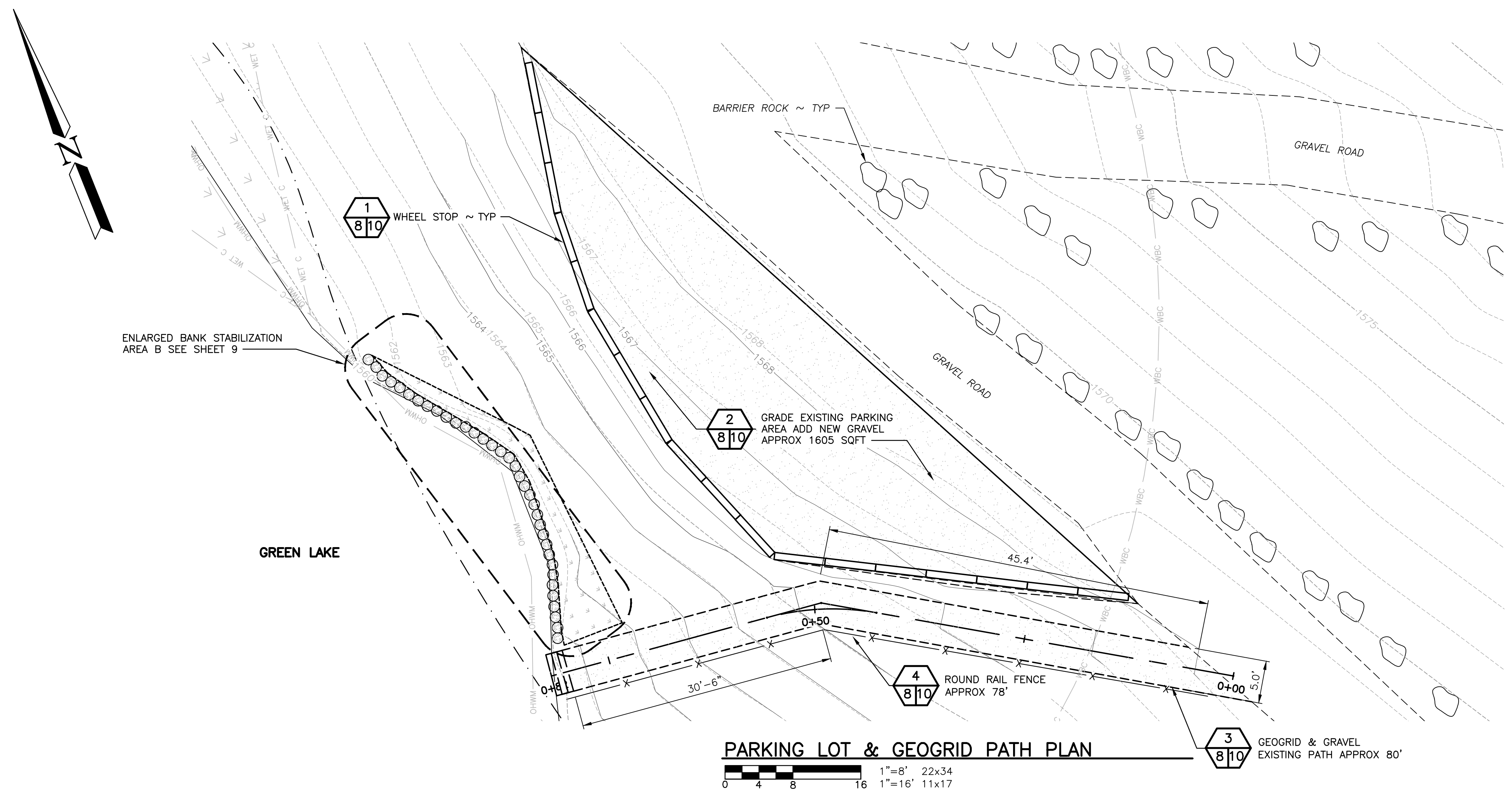

**LEGEND**

- EXISTING GRAVEL ROAD
- - - NEW GRAVEL ROAD
- - - EXISTING MAJOR CONTOURS
- ▨ GRAVEL
- BUFF 50' GREEN LAKE OHWM 50' BUFFER
- OHWM ORDINARY HIGH WATER MARK
- ▨ WETLAND AREA
- WET C WETLAND C
- WBC WETLAND C 100' BUFFER

WASHINGTON DEPARTMENT OF  
**FISH & WILDLIFE**

**NOT APPROVED FOR CONSTRUCTION. REVIEW ONLY**

DESIGNED BY K. SMITH  
CHECKED BY S. GOODWIN  
DRAWN BY SS/SG  
DATE 2/3/2025

**GREEN LAKE ACCESS AREA**  
**CAMPGROUND IMPROVEMENTS**  
PARKING LOT, GEOGRID PATH PLAN & PROFILE

PROJECT NO.  
ON:A345:2024-1

SHEET 8 OF 11



- NOTES:**
1. EXPOSED HEIGHT OF LOGS SHOULD NOT EXCEED 3'
  2. UPON CONSTRUCTION COMPLETION, RESEED AREAS WITH NATIVE SEED MIX WITH NO NOXIOUS WEED SEEDS
  3. BANK STABILIZATION SHOULD SPAN THE WIDTH OF ERODED AREA

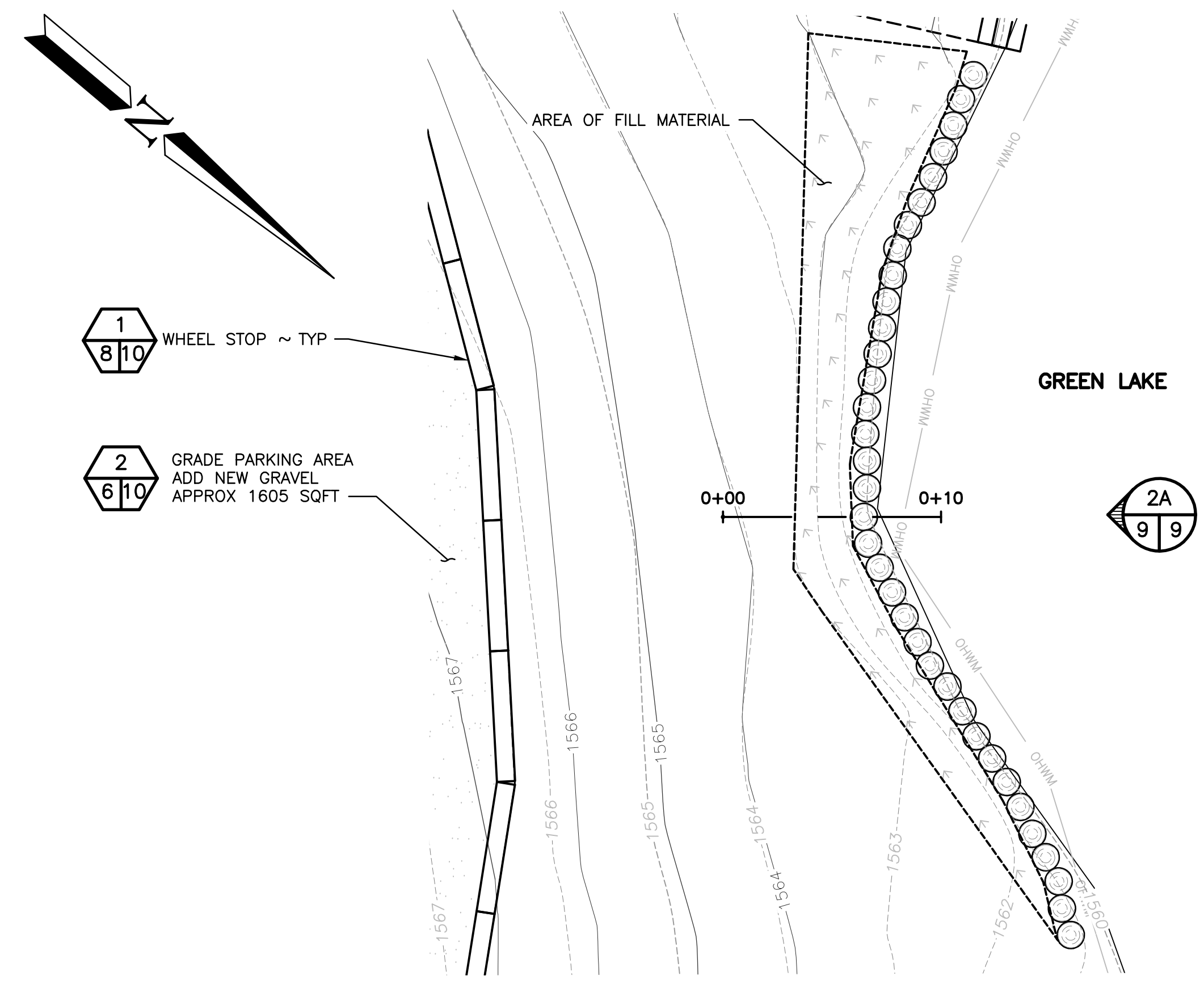

**BANK STABILIZATION AREA B PLAN**  
 1"=5' 22x34  
 1"=10' 11x17

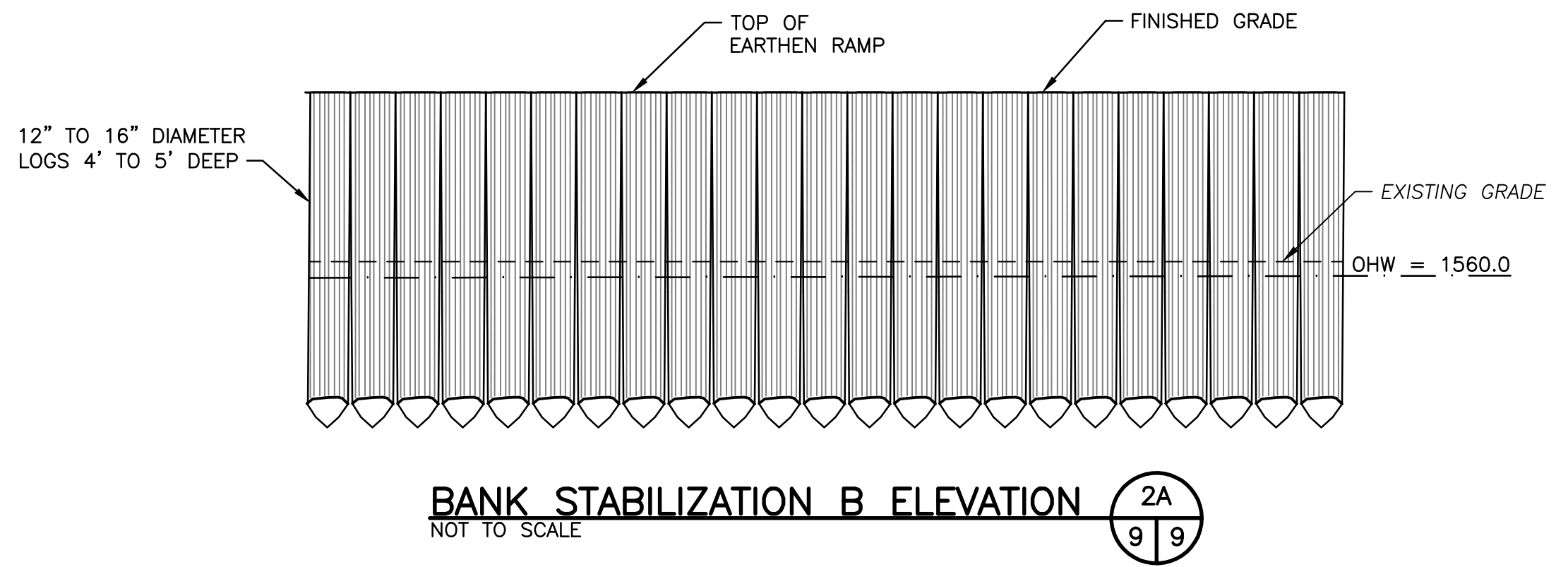

**BANK STABILIZATION B ELEVATION**  
 NOT TO SCALE

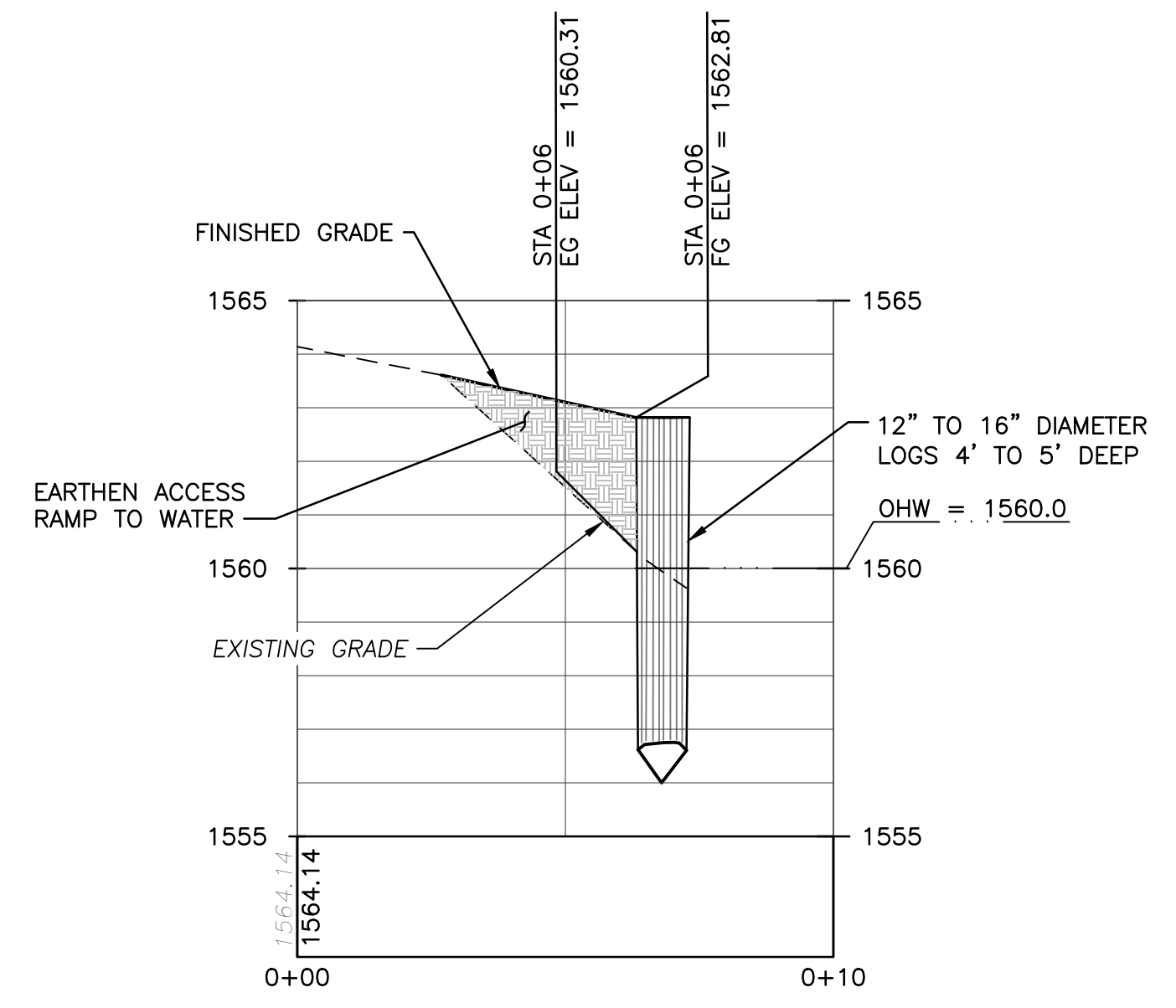

**BANK STABILIZATION AREA B PROFILE**  
 1"=3' 22x34  
 1"=6' 11x17

**LEGEND**

	EXISTING GRAVEL ROAD
	NEW GRAVEL ROAD
	EXISTING MAJOR CONTOURS
	FINISHED MAJOR CONTOURS
	GRAVEL
	WETLAND

WASHINGTON DEPARTMENT OF  
**FISH & WILDLIFE**

**NOT APPROVED FOR CONSTRUCTION. REVIEW ONLY**

DESIGNED BY K. SMITH  
 CHECKED BY S. GOODWIN  
 DRAWN BY SS/SG  
 DATE 2/3/2025

GREEN LAKE ACCESS AREA  
 CAMPGROUND IMPROVEMENTS  
 BANK STABILIZATION DETAIL

PROJECT NO.  
 ON:A345:2024-1  
 SHEET 9 OF 11

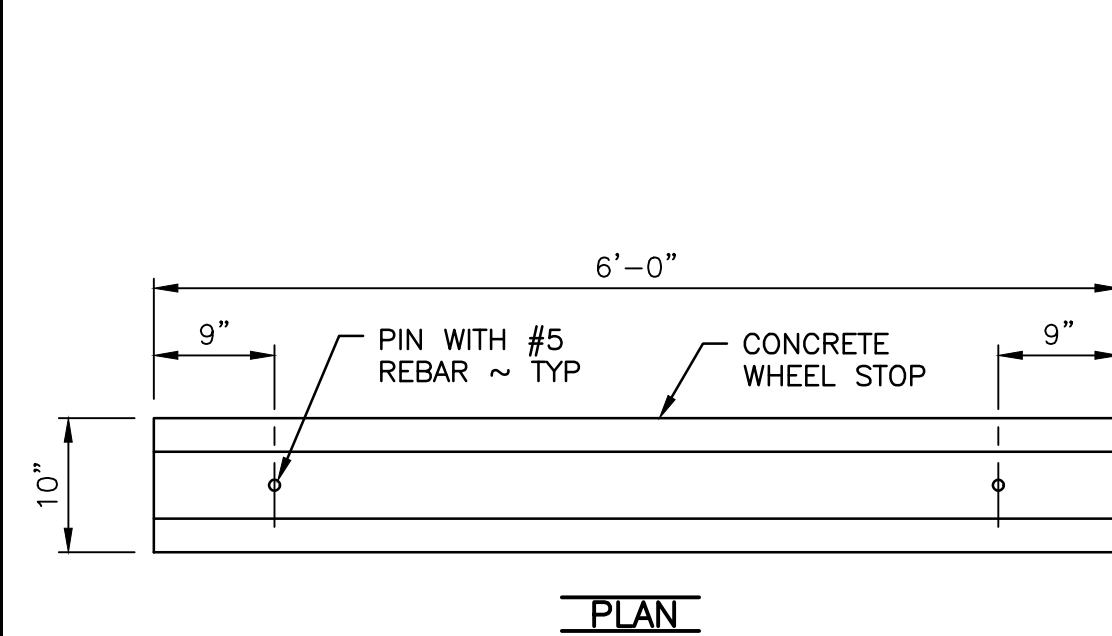

PLAN

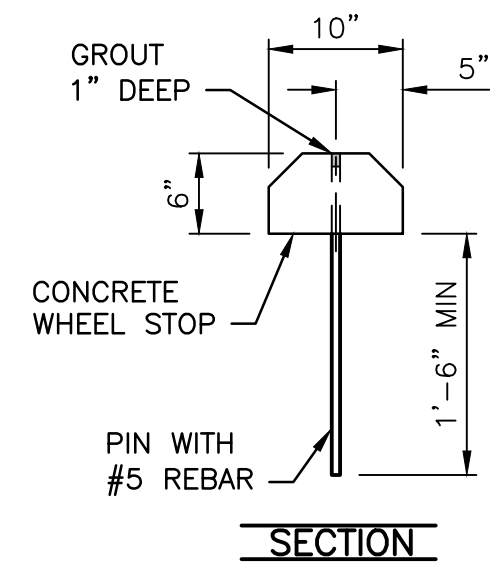

SECTION

CONCRETE WHEEL STOP  
NOT TO SCALE

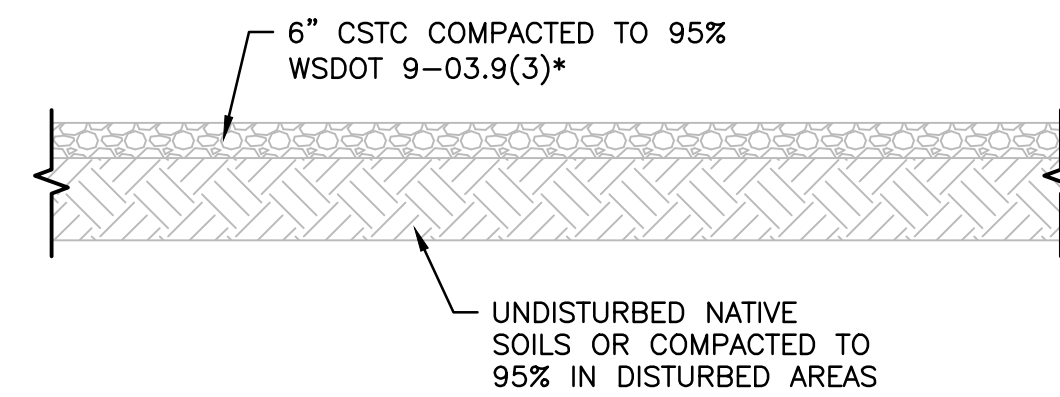
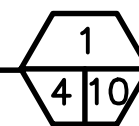

GRAVEL DETAIL  
NOT TO SCALE

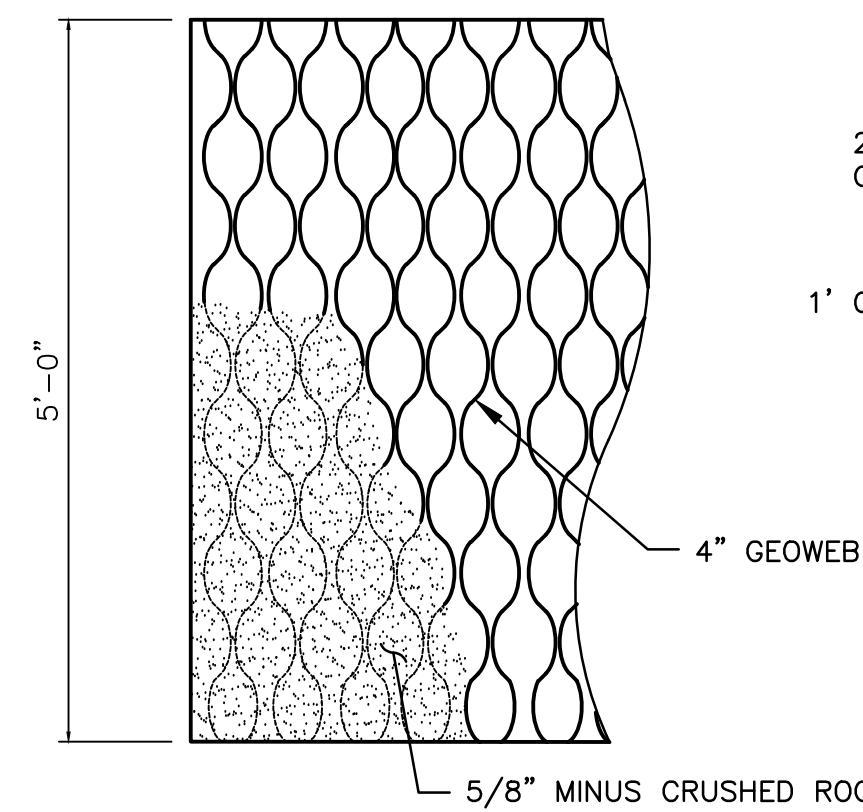
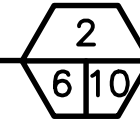

PLAN

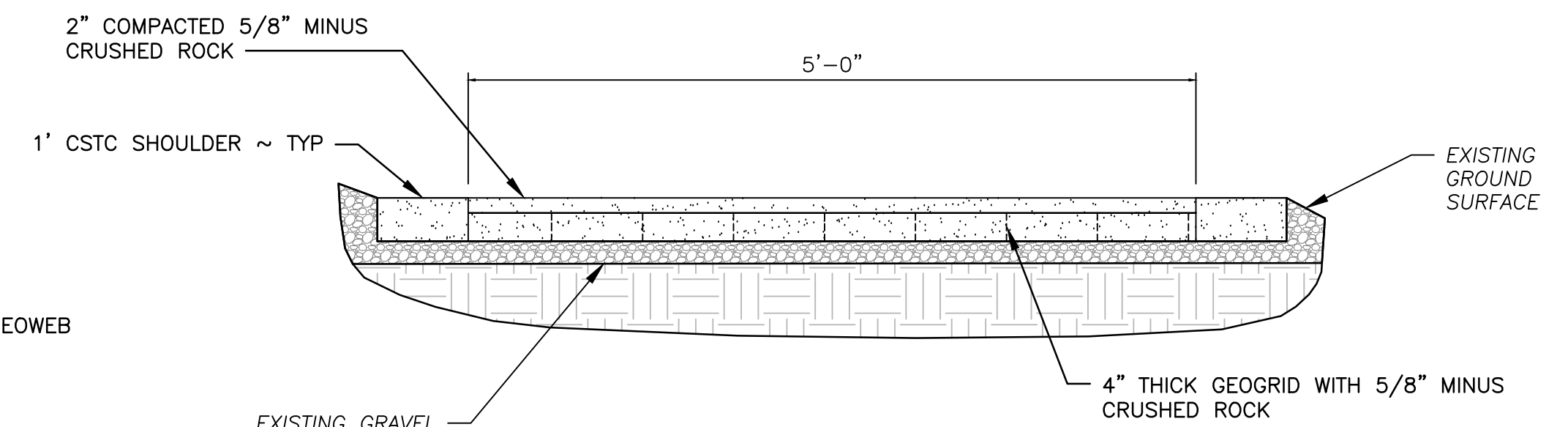

SECTION

GEOGRID & GRAVEL PATH  
NOT TO SCALE

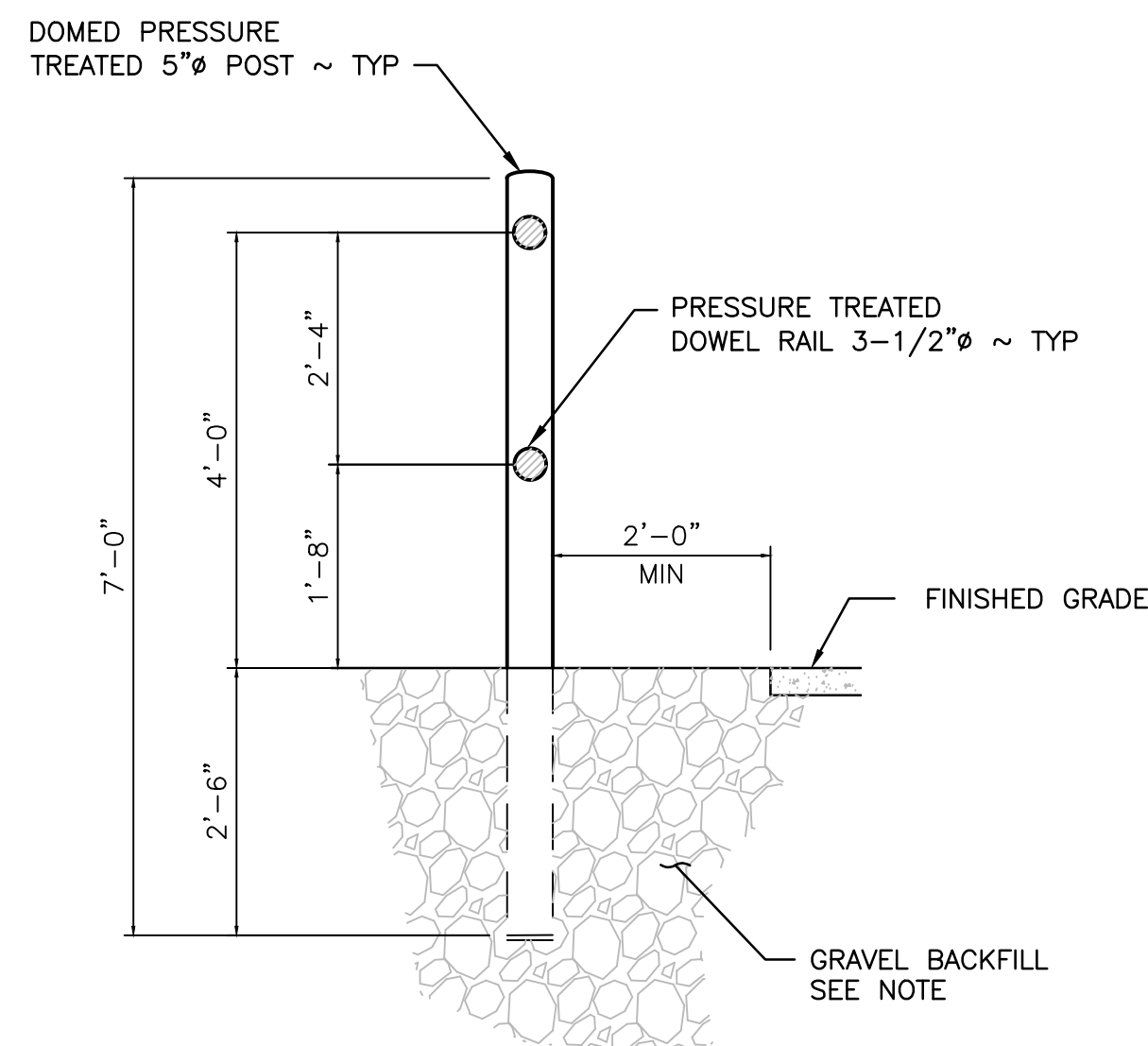
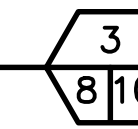

SECTION

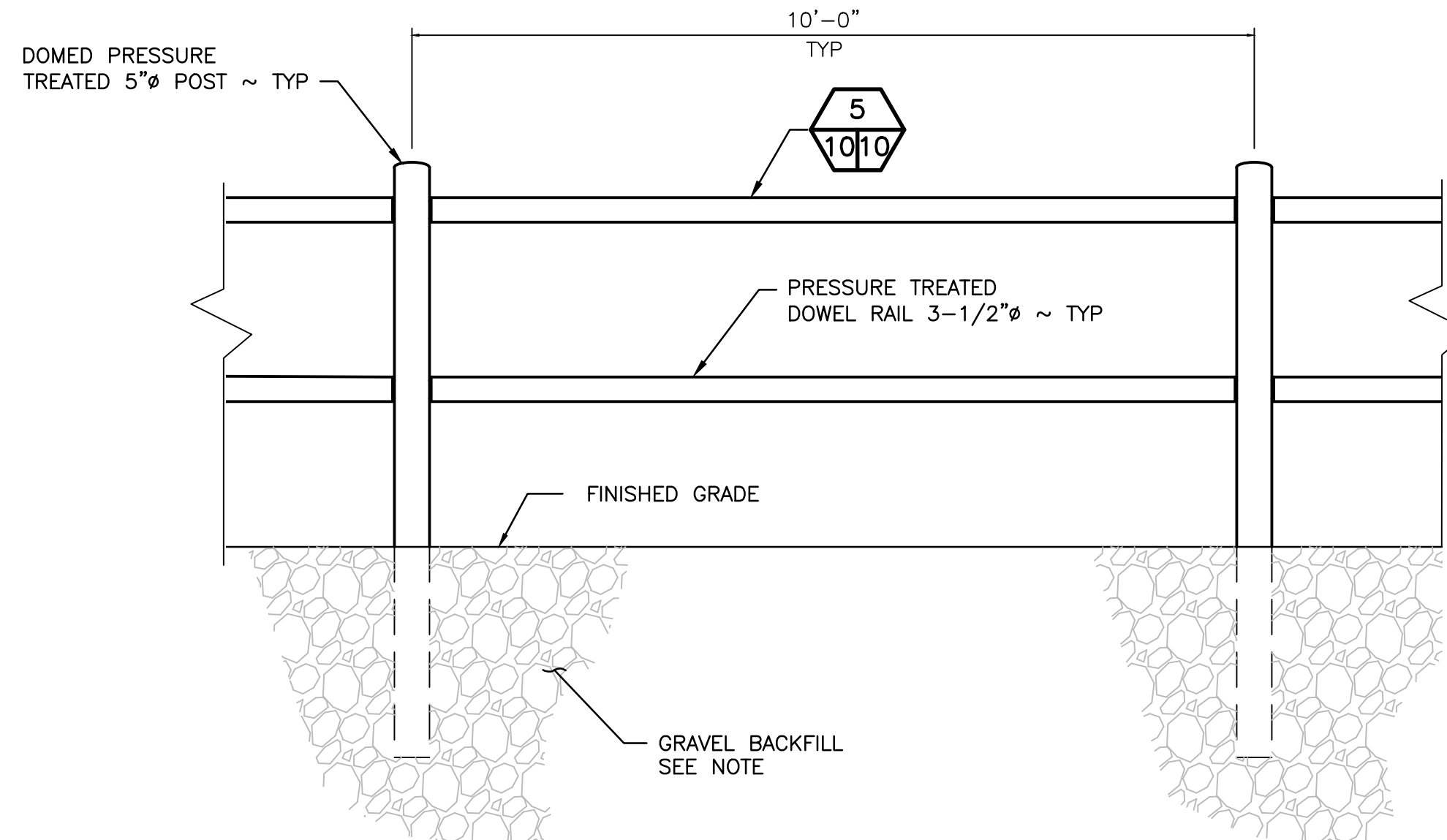

ELEVATION

ROUND RAIL FENCE  
NOT TO SCALE

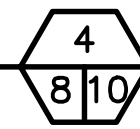

NOTE: BACKFILL FENCE POSTS WITH GRAVEL TO ALLOW TO DRAIN IF NATIVE SOIL IS CLAY

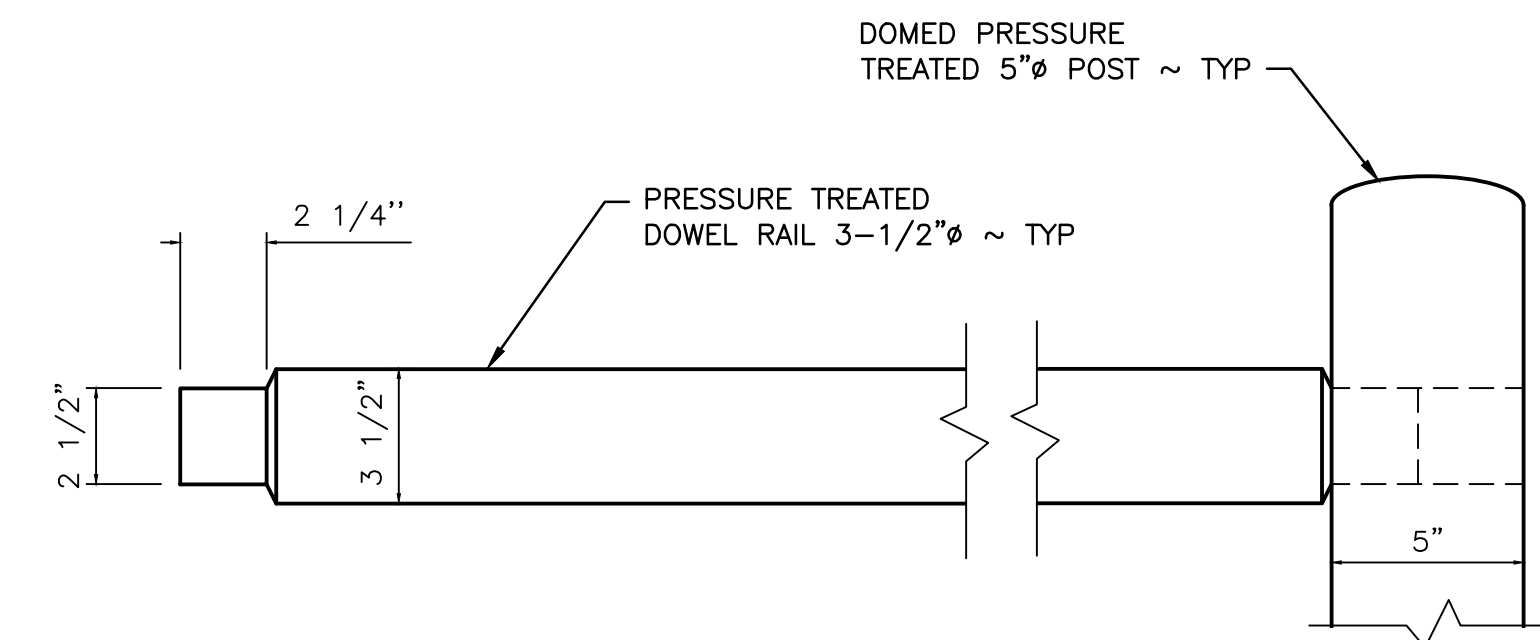

ROUND RAIL CONNECTION  
NOT TO SCALE

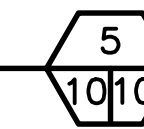

WASHINGTON DEPARTMENT OF  
**FISH & WILDLIFE**

**NOT APPROVED FOR CONSTRUCTION. REVIEW ONLY**

0 — 1"  
BAR MEASURES  
ONE INCH ON  
22x34 DRAWINGS

DESIGNED BY K. SMITH  
CHECKED BY S. GOODWIN  
DRAWN BY SS/SG  
DATE 2/3/2025

GREEN LAKE ACCESS AREA  
CAMPGROUND IMPROVEMENTS  
GEOGRID PATH AND ROUND RAIL FENCE DETAILS

PROJECT NO.  
ON:A345:2024-1

SHEET OF  
10 11

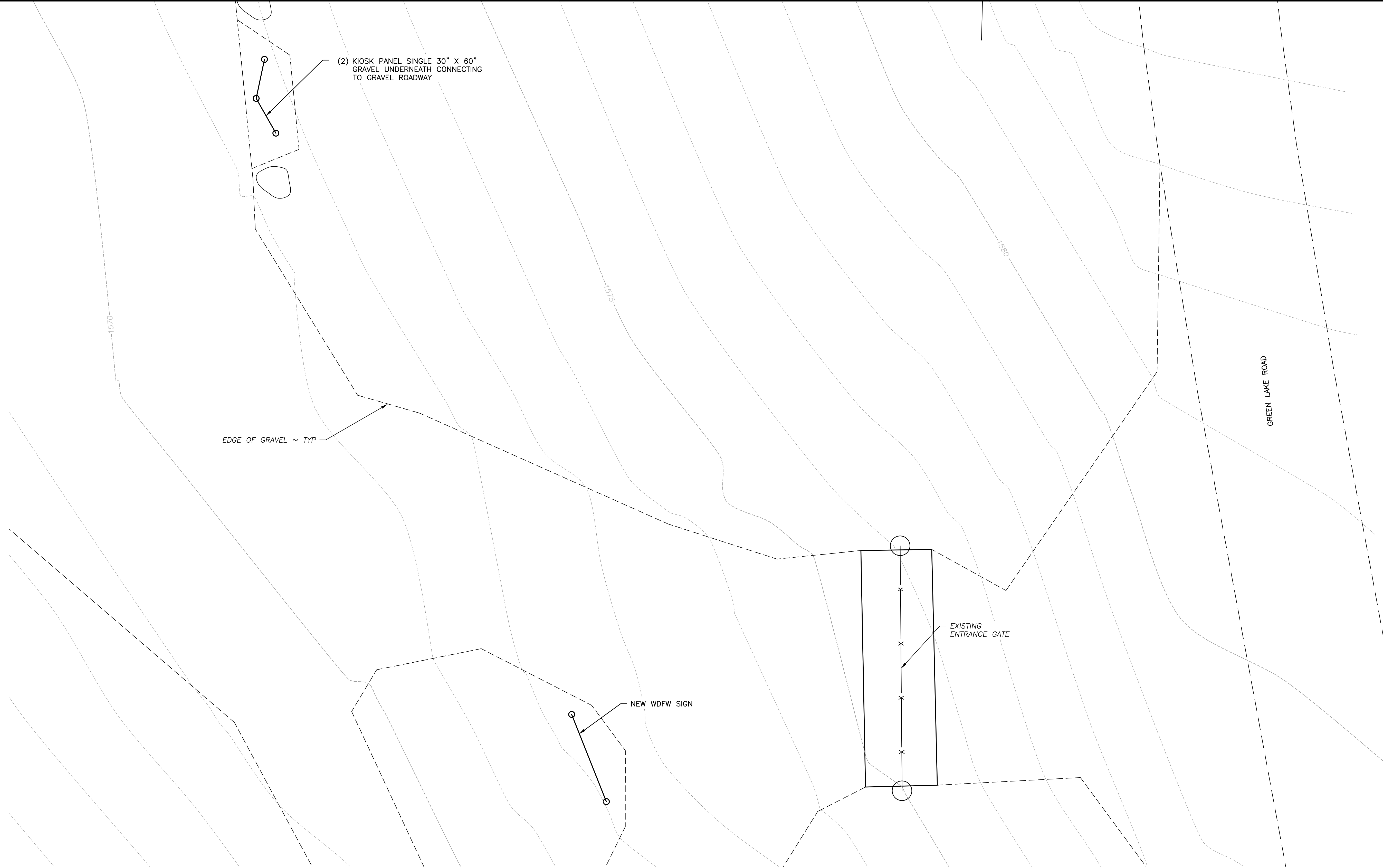

**KIOSK & SIGN PLAN**  
 0 1 3 5 10  
 1"=5' 22x34  
 1"=10' 11x17

WASHINGTON DEPARTMENT OF  
**FISH & WILDLIFE**

**NOT APPROVED FOR  
 CONSTRUCTION. REVIEW ONLY**

REVISION	DATE	DESCRIPTION

DESIGNED BY K. SMITH
CHECKED BY S. GOODWIN
DRAWN BY SS/SG
DATE 2/3/2025

GREEN LAKE ACCESS AREA  
 CAMPGROUND IMPROVEMENTS  
 KIOSK AND SIGN PLAN

PROJECT NO.  
 ON:A345:2024-1

SHEET OF  
 11 11