

STATE MAP
NOT TO SCALE

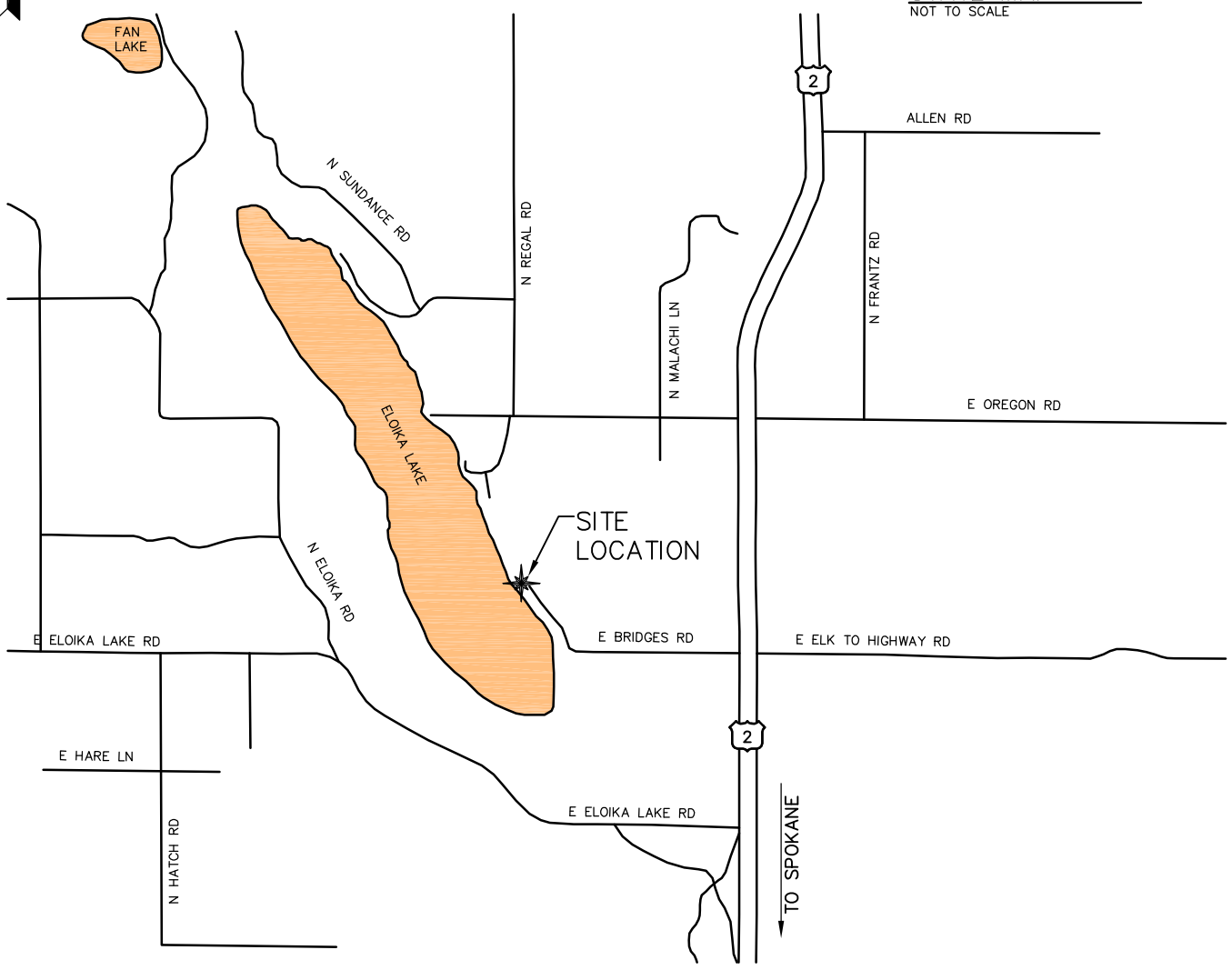

VICINITY MAP
NOT TO SCALE

PURPOSE: ACCESS SITE RENOVATION	WASHINGTON DEPT. of FISH & WILDLIFE 600 CAPITOL WAY N. OLYMPIA, WA 98501-1091	PROPOSED: REPLACE BOAT RAMP INSTALL BOARDING FLOATS, PARKING REPLACE VAULT TOILET
DATUM: ASSUMED	REFERENCE NO. _____	IN: LITTLE SPOKANE RIVER
ADJACENT PROPERTY OWNER: 1. PARCEL # 39103.0122	SITE: ELOIKA LAKE	NEAR: SPOKANE
2 _____ ENG. PROJECT NO. SE: A429:08-1	ADDRESS: E BRIDGES ROAD ELOIKA	COUNTY OF: SPOKANE STATE: WA PORTION OF: T29N, R43E, SEC 10 DATE: 10/28/2008 SHEET 1 OF 7

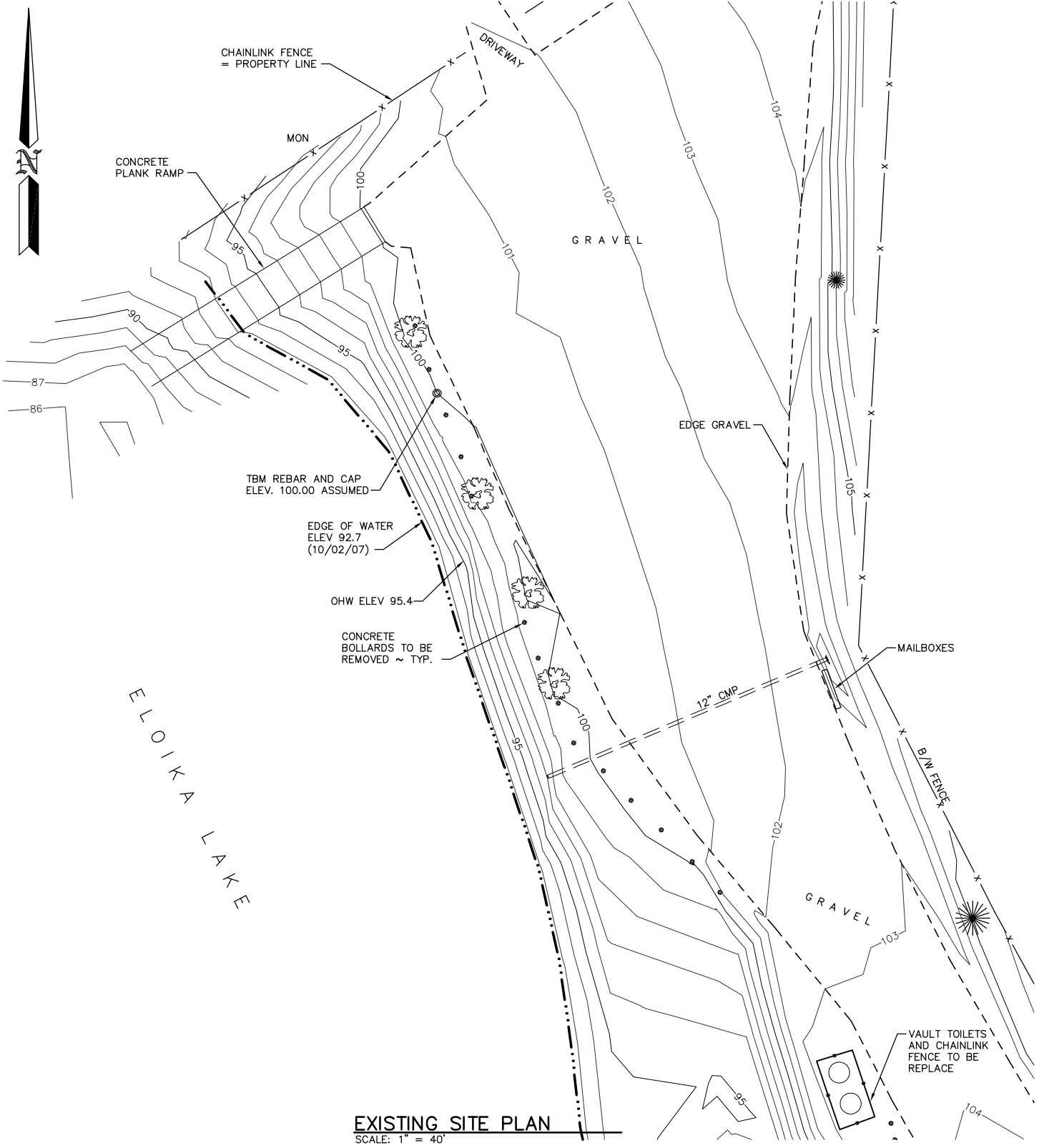

ELOIKA LAKE

EXISTING SITE PLAN
SCALE: 1" = 40'

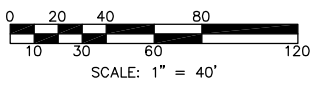

REFERENCE NO. _____
APPLICANT: WASHINGTON DEPT. of FISH & WILDLIFE
ELOIKA LAKE ACCESS SITE IMPROVEMENTS EXISTING SITE PLAN
AT: <u>ELOIKA LAKE</u> , WASHINGTON
DATE: <u>10/28/2008</u> SHEET <u>2</u> OF <u>7</u>

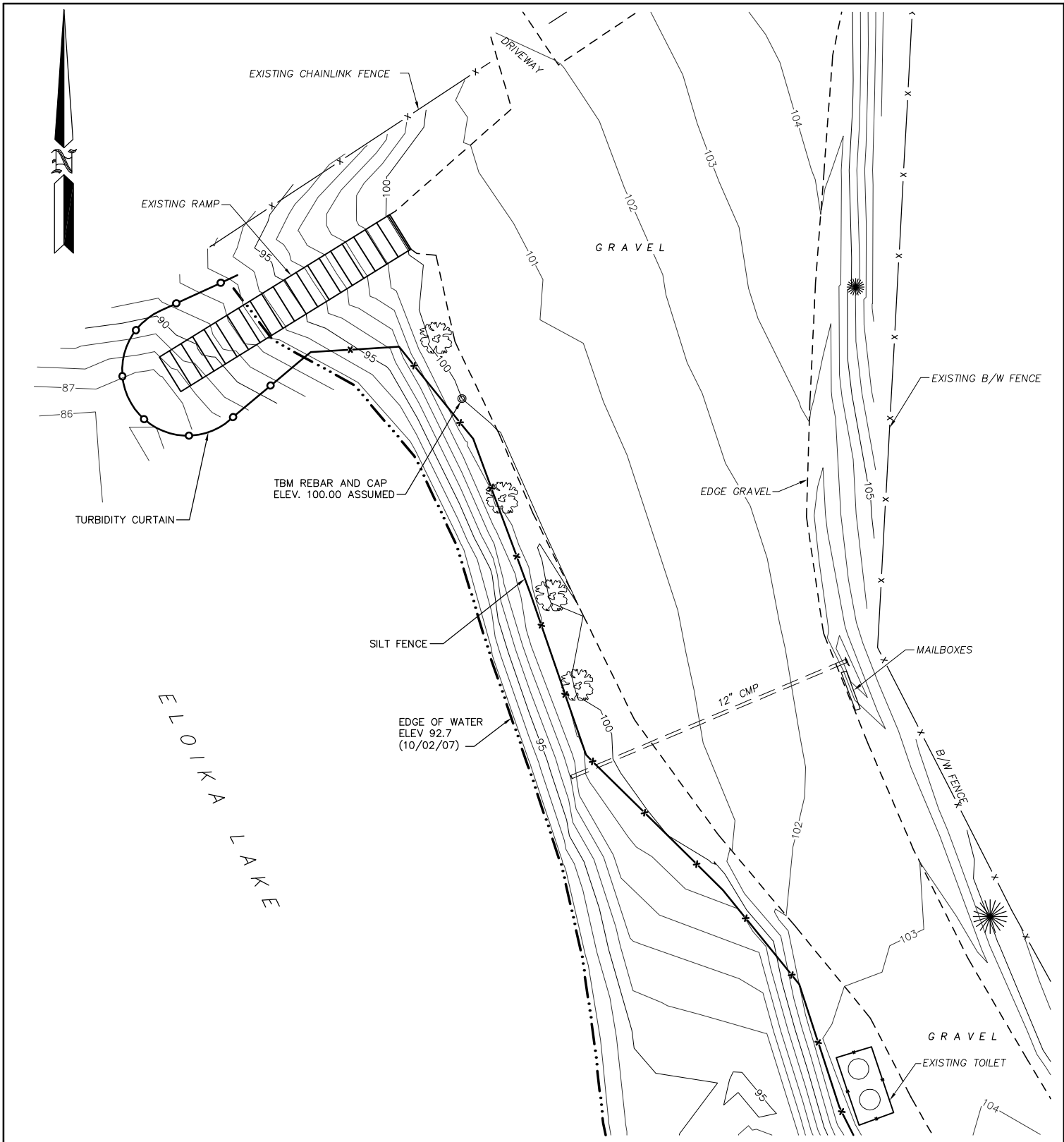

EROSION CONTROL PLAN

SCALE: 1" = 40'

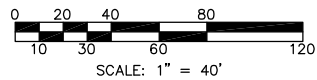

REFERENCE NO. _____
APPLICANT: WASHINGTON DEPT. of FISH & WILDLIFE
ELOIKA LAKE ACCESS SITE IMPROVEMENTS EROSION CONTROL PLAN
AT: <u>ELOIKA LAKE</u> _____, WASHINGTON
DATE: <u>10/28/2008</u> SHEET <u>3</u> OF <u>7</u>

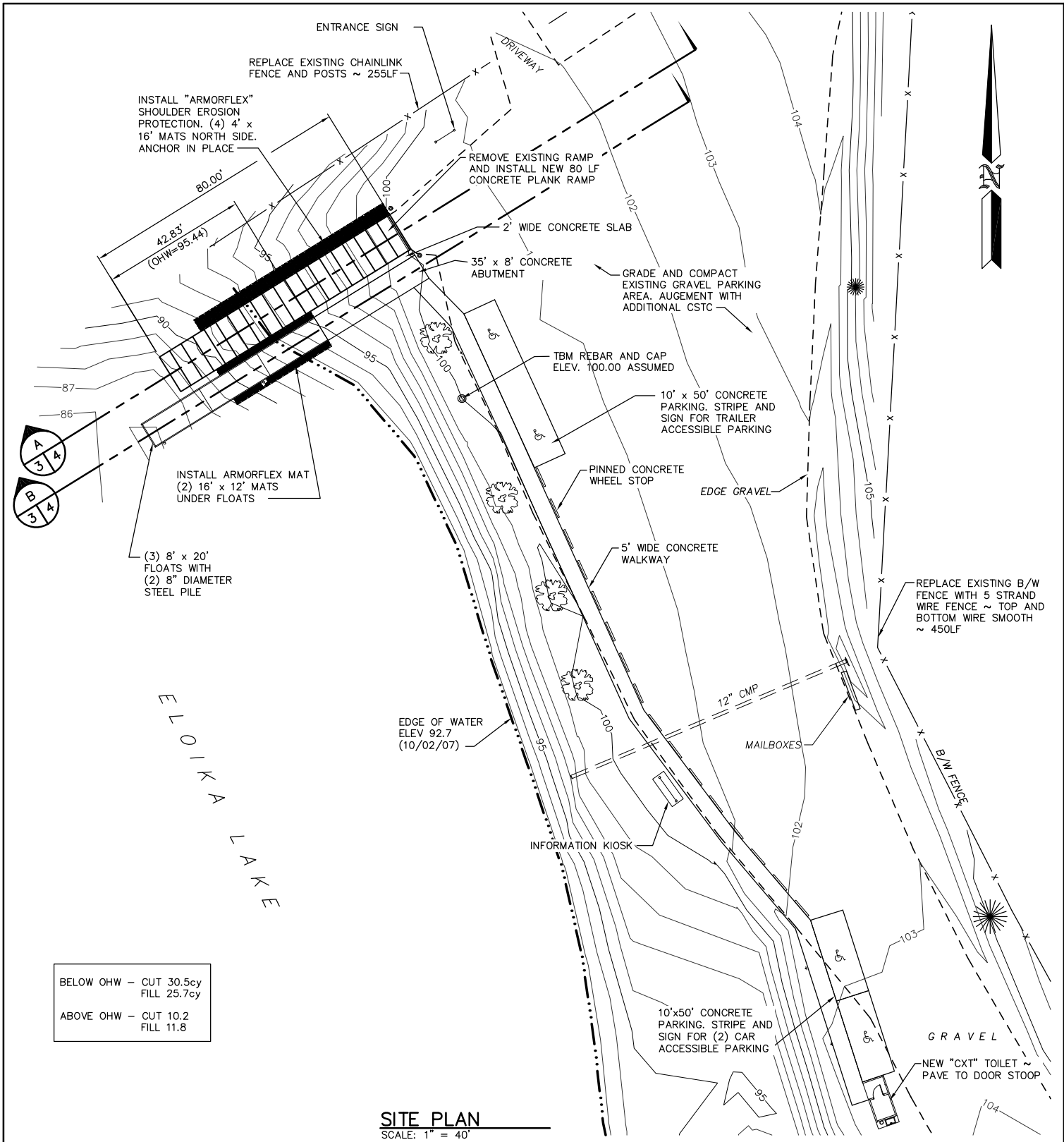

BELOW OHW - CUT 30.5cy
FILL 25.7cy
ABOVE OHW - CUT 10.2
FILL 11.8

SITE PLAN
SCALE: 1" = 40'

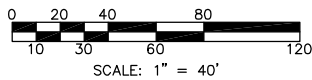

REFERENCE NO. _____
APPLICANT: WASHINGTON DEPT. of FISH & WILDLIFE
ELOIKA LAKE ACCESS SITE IMPROVEMENTS SITE PLAN
AT: <u>ELOIKA LAKE</u> , WASHINGTON
DATE: <u>10/28/2008</u> SHEET <u>4</u> OF <u>7</u>

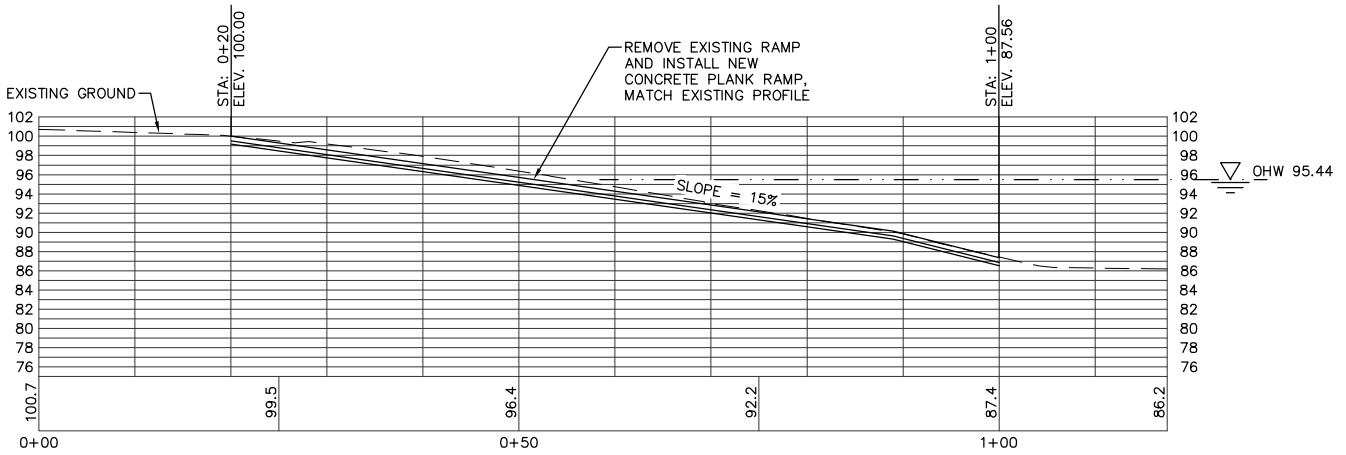

SECTION A
SCALE: 1" = 20'

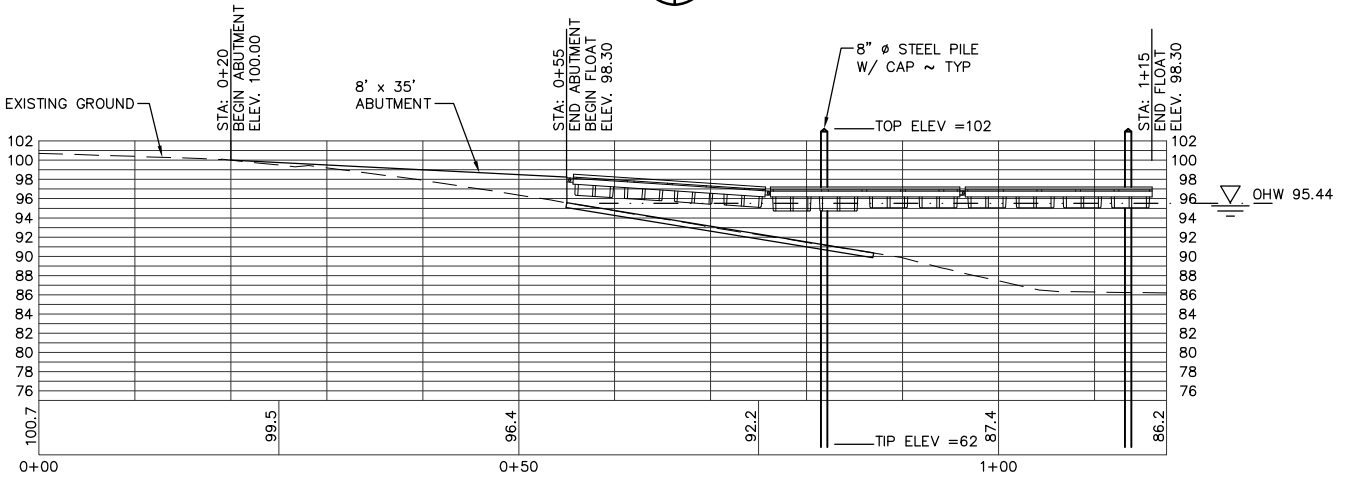

SECTION B HIGH WATER
SCALE: 1" = 20'

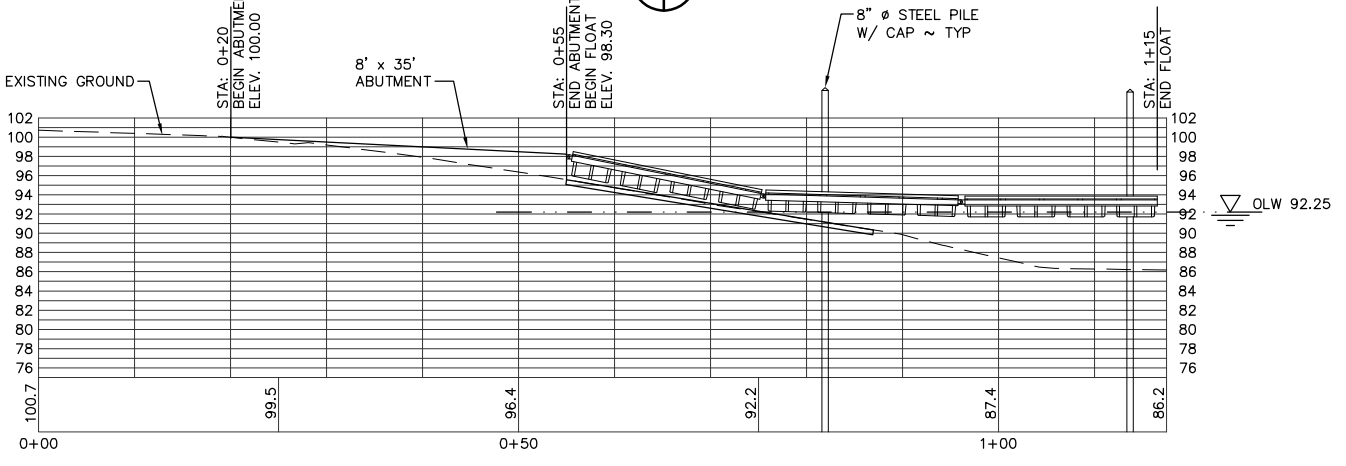

SECTION B LOW WATER
SCALE: 1" = 20'

REFERENCE NO.	_____
APPLICANT:	WASHINGTON DEPT. of FISH & WILDLIFE
ELOIKA LAKE ACCESS SITE IMPROVEMENTS PROFILES	
AT:	ELOIKA LAKE _____, WASHINGTON
DATE:	10/28/2008 SHEET 5 OF 7

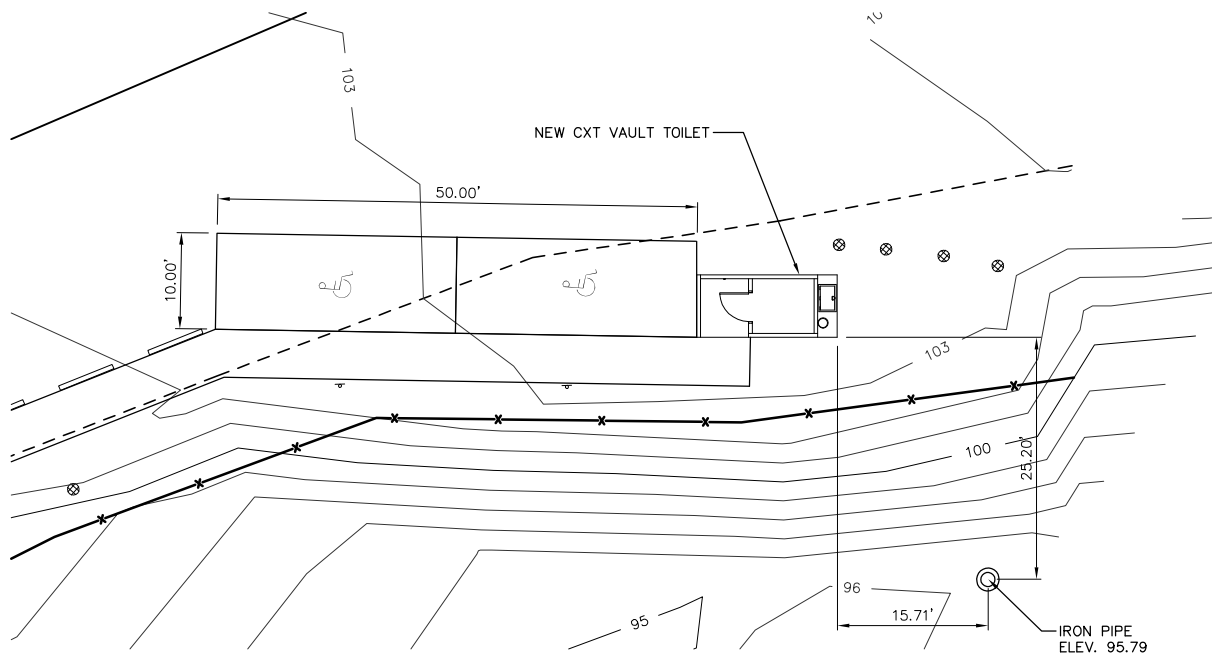

ACCESSIBLE SIGN 
SCALE: 1" = 20'

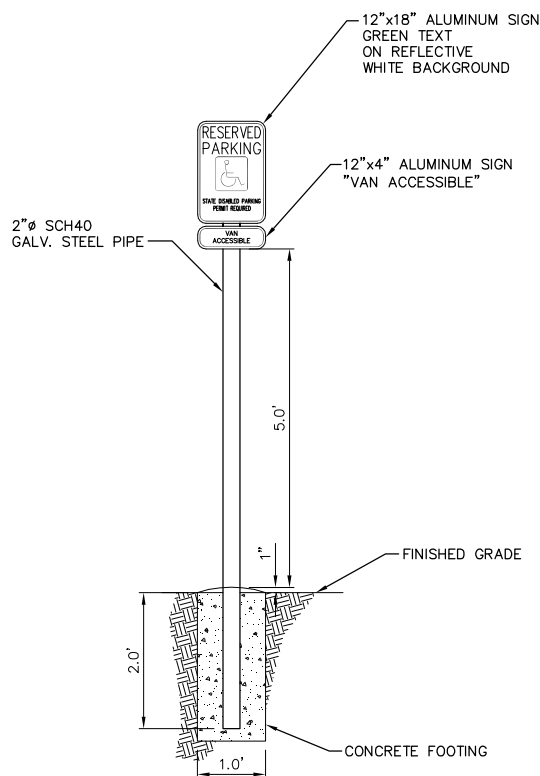

ACCESSIBLE SIGN 
SCALE: 1" = 20'

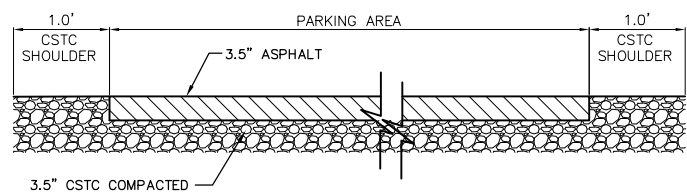

REFERENCE NO.	_____
APPLICANT:	WASHINGTON DEPT. of FISH & WILDLIFE
ELOIKA LAKE ACCESS SITE IMPROVEMENTS DETAILS	
AT:	ELOIKA LAKE _____, WASHINGTON
DATE:	10/28/2008 SHEET 6 OF 7

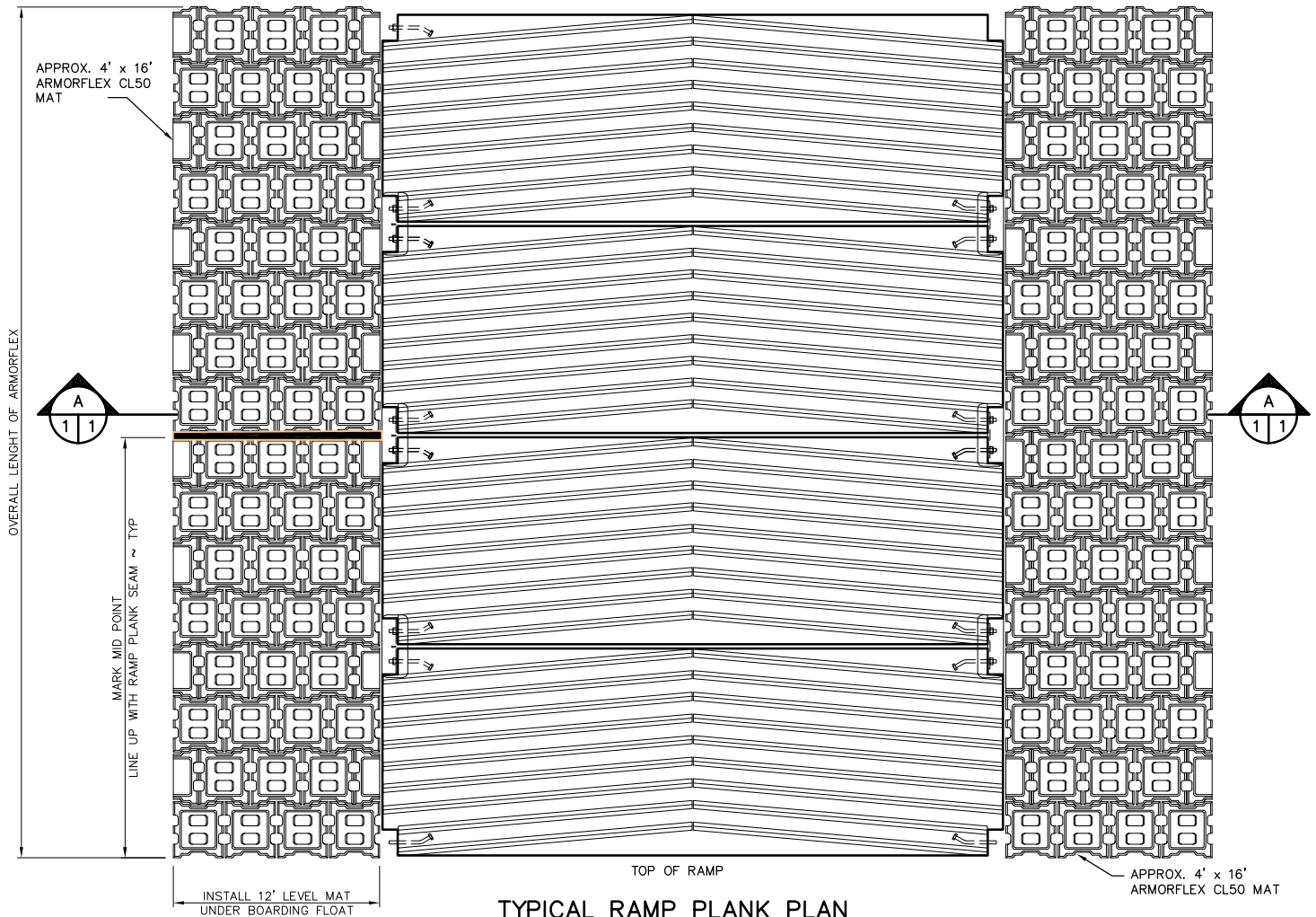

TYPICAL RAMP PLANK PLAN
NOT TO SCALE

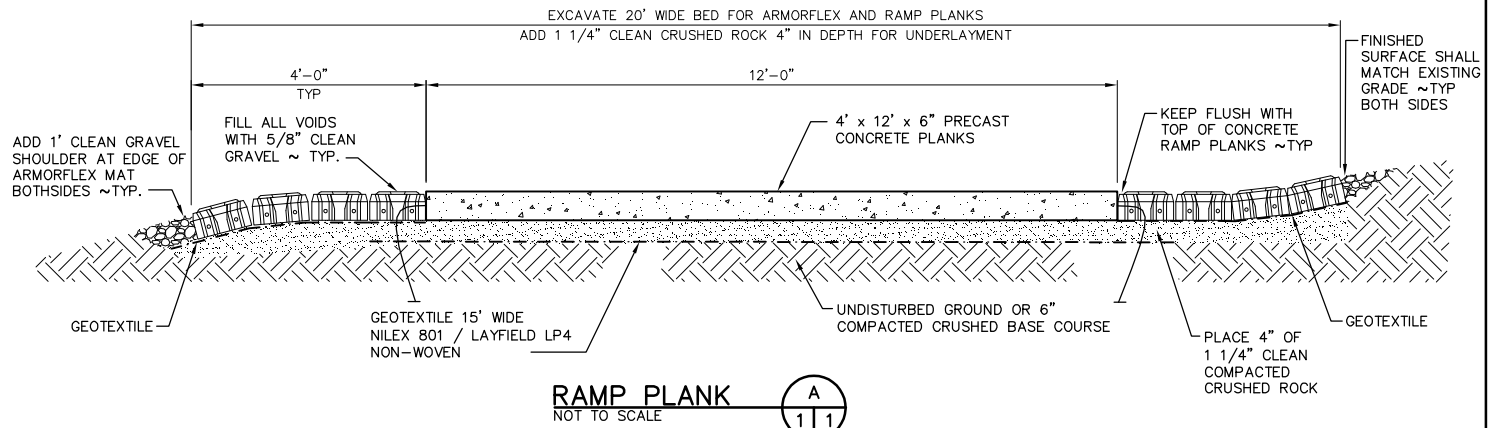

REFERENCE NO. _____
APPLICANT: WASHINGTON DEPT. OF FISH & WILDLIFE
ELOIKA LAKE ACCESS SITE IMPROVEMENTS
RAMP AND ARMORFLEX PLAN AND SECTION
AT: ELOIKA LAKE _____, WASHINGTON
DATE: 10/28/2008 SHEET 7 OF 7