

# Beebe Springs Natural Area Phase 4A

## List of Sheets:

- 1 Site Vicinity Maps
- 2 Existing Critical Areas
- 3 Existing Critical Areas - Beebe Creek and Chinook Spring
- 4 Site Plan - Beebe Creek and Chinook Spring
- 5 Detailed Area Plan - Beebe Creek
- 6 Detailed Area Plan - Chinook Spring
- 7 Existing Critical Areas - Toad Creek
- 8 Site Plan - Toad Creek
- 9 Site Plan - Beebe Bridge
- 10 Section - Bridge at Beebe Creek
- 11 Section - Beebe Creek Restoration
- 12 Section - Trail at Chinook Spring
- 13 Section - Chinook Spring Restoration
- 14 Section - Bridge at Toad Creek

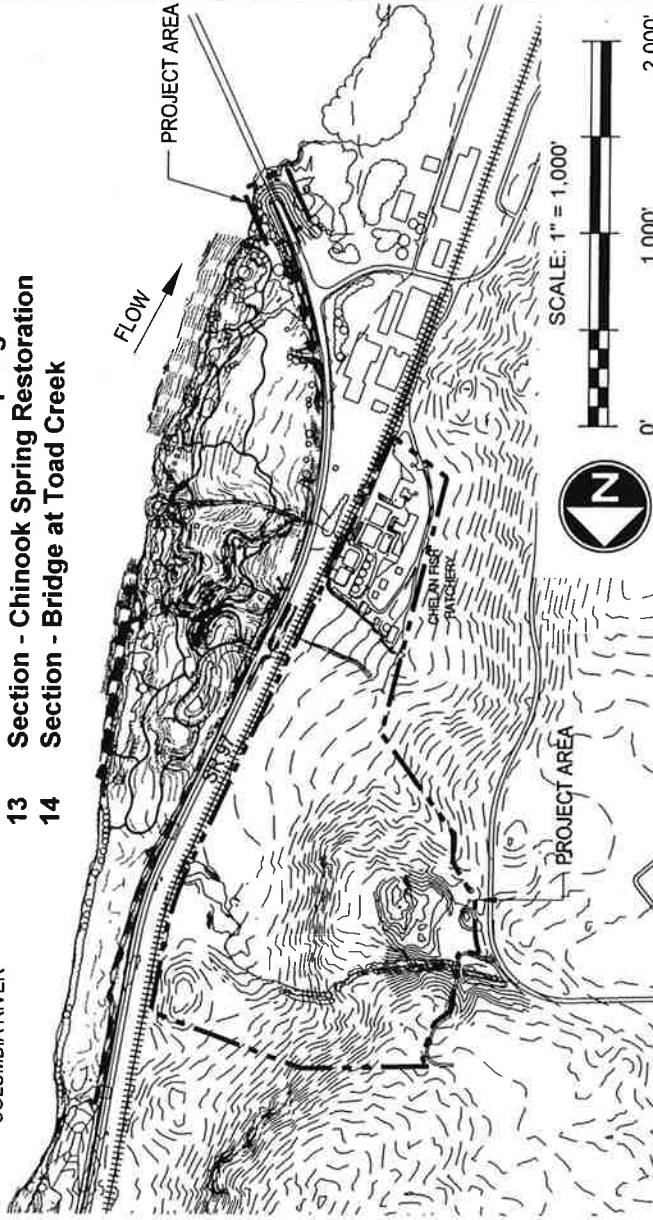
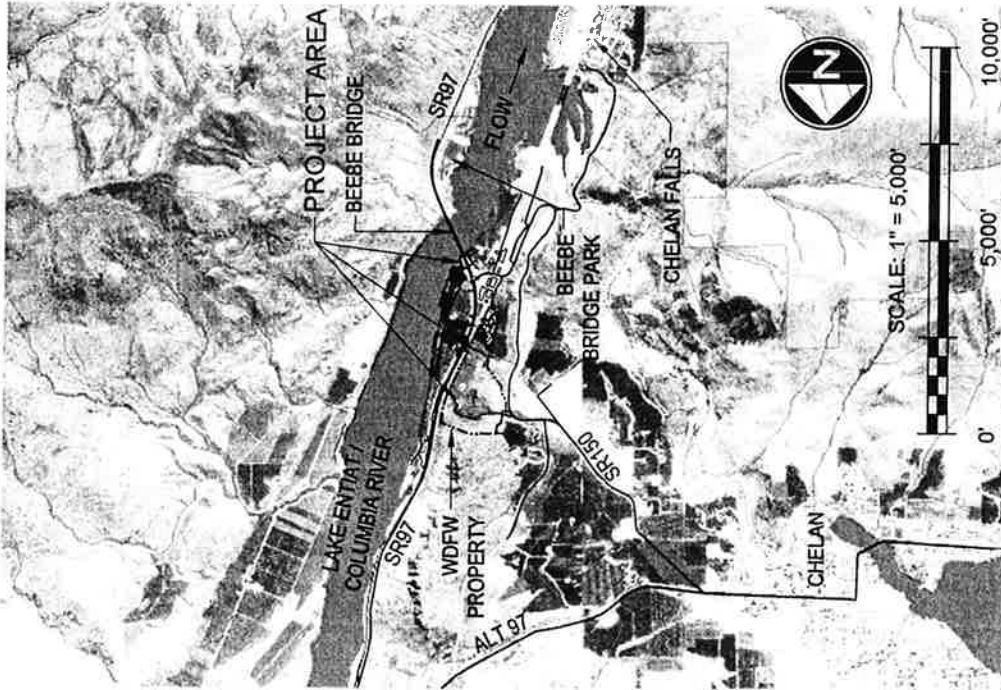

**PURPOSE:** TO RESTORE RIPARIAN ENVIRONMENTS, IMPROVE HABITAT, AND INSTALL A HIKING TRAIL SYSTEM

**DATUM:** NGVD 29

**ADJACENT PROPERTY OWNERS:** WSDOT, Chelan County PUD, COLUMBIA CASCADE RAILROAD

**LATITUDE:** 47° 49' 14" N  
**LONGITUDE:** 119° 58' 34" W

**WASHINGTON DEPARTMENT OF FISH AND WILDLIFE**

**BEEBE SPRINGS NATURAL AREA PHASE 4A**

REFERENCE #:  
ADDRESS: SR 97  
Chelan, WA 98816

**SHEET 1 OF 14: SITE VICINITY MAPS**

**PROPOSED:** BEEBE SPRINGS NATURAL AREA PHASE 4A  
**IN:** CHELAN COUNTY  
**AT:** CHELAN FISH HATCHERY  
**COUNTY OF:** CHELAN **STATE:** WA  
**APPL BY:** WASHINGTON DEPARTMENT OF FISH AND WILDLIFE  
**DATE:** FEBRUARY 2012  
**REVISED:**

**PREPARED BY:**  
J.A. BRENNAN ASSOCIATES, PLLC

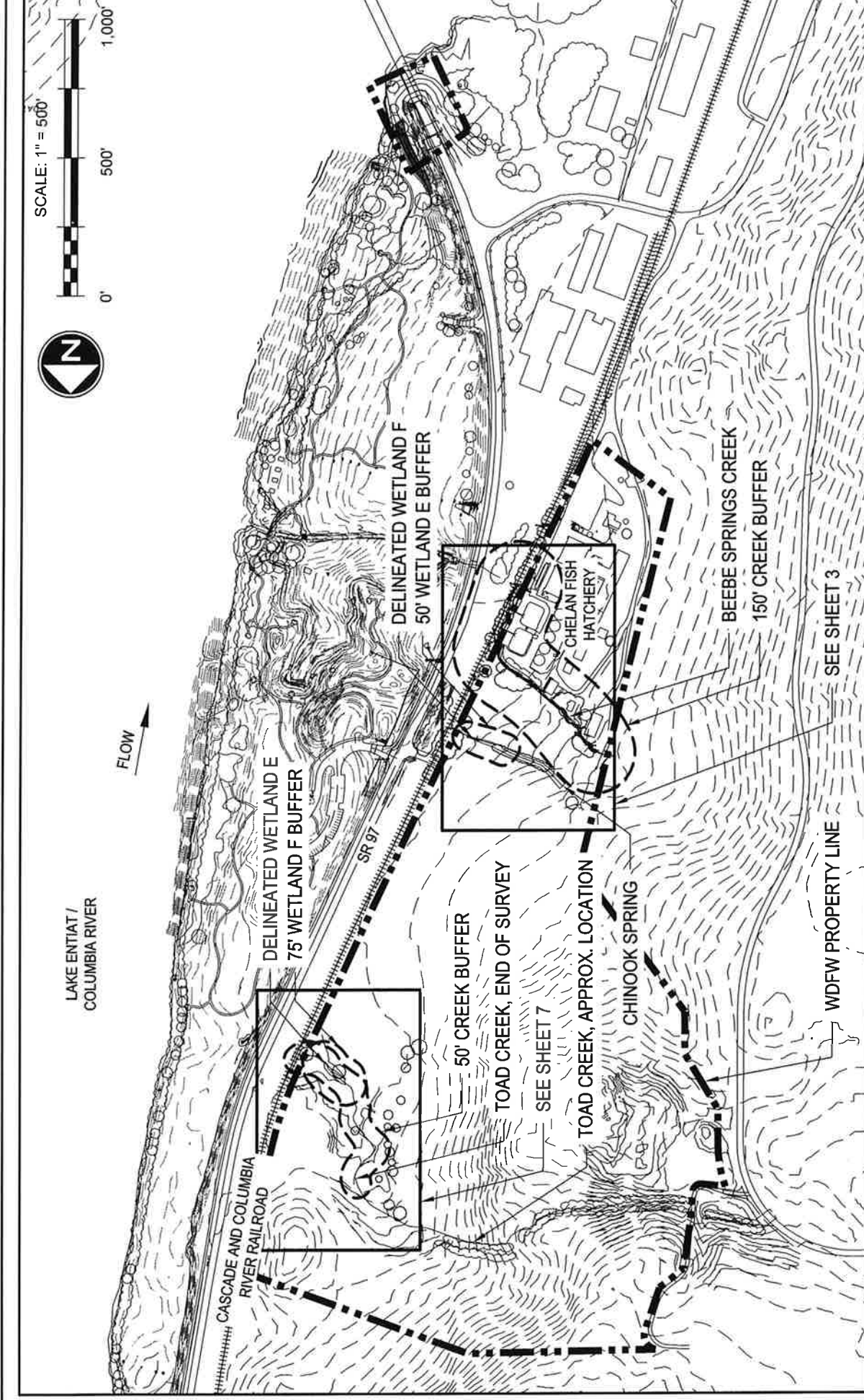

**PROPOSED:** BEEBE SPRINGS NATURAL AREA PHASE 4A  
**IN:** CHELAN COUNTY  
**AT:** CHELAN FISH HATCHERY  
**COUNTY OF:** CHELAN **STATE:** WA  
**APPL. BY:** WASHINGTON DEPARTMENT OF FISH AND WILDLIFE  
**DATE:** FEBRUARY 2012  
**REVISED:**

**WASHINGTON DEPARTMENT OF FISH AND WILDLIFE**

**BEEBE SPRINGS NATURAL AREA PHASE 4A**

**REFERENCE #:** ADDRESS: SR 97  
 Chelan, WA 98816

**SHEET 2 OF 14: EXISTING CRITICAL AREAS**

**PURPOSE:** TO RESTORE RIPARIAN ENVIRONMENTS, IMPROVE HABITAT, AND INSTALL A HIKING TRAIL SYSTEM

**DATUM:** NGVD 29

**ADJACENT PROPERTY OWNERS:** WSDOT, Chelan County PUD, COLUMBIA CASCADE RAILROAD

**LATITUDE:** 47° 49' 14" N  
**LONGITUDE:** 119° 58' 34" W

**PREPARED BY:**  
 J.A. BRENNAN ASSOCIATES, PLLC

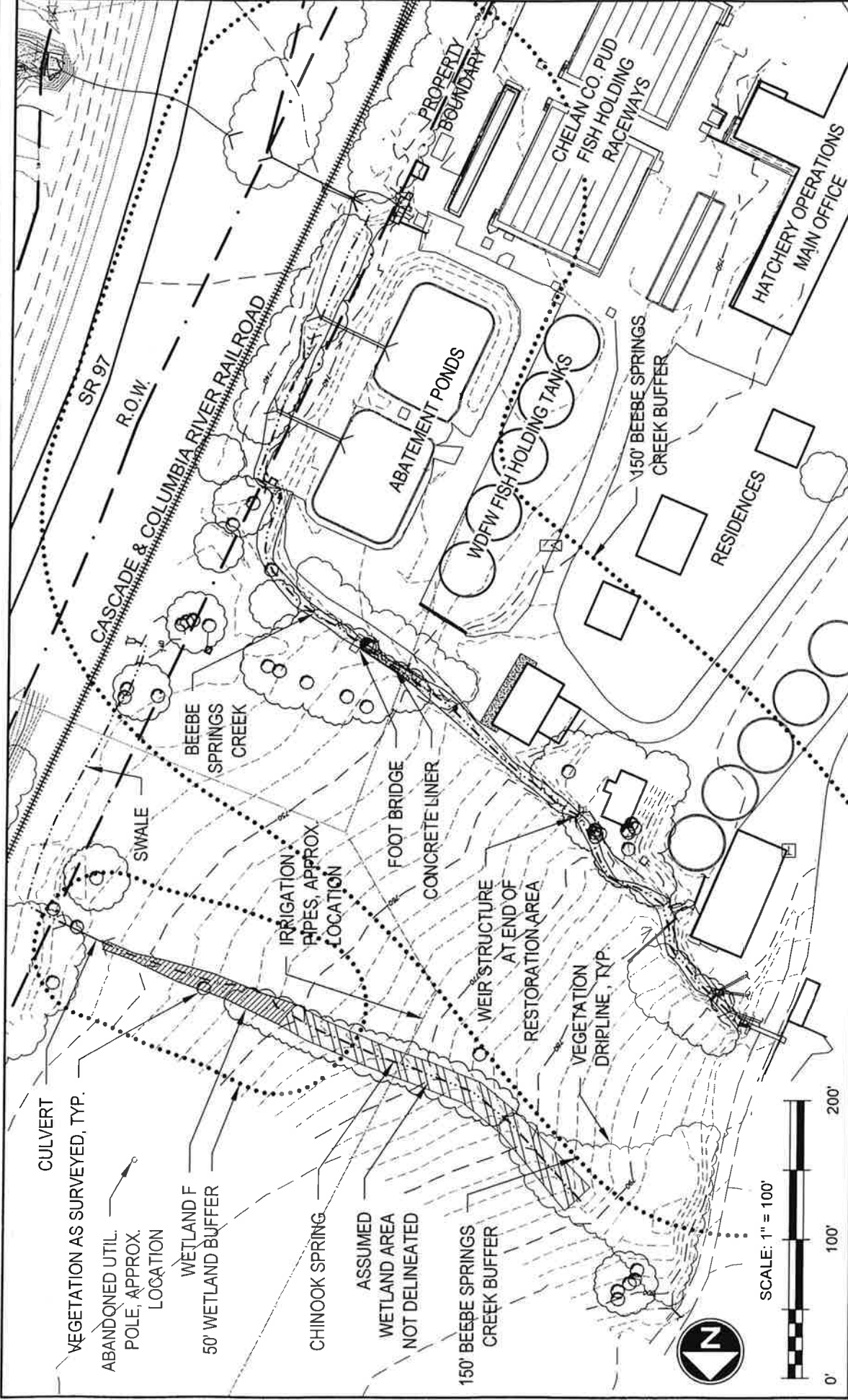

PROPOSED: BEEBE SPRINGS NATURAL AREA PHASE 4A  
 IN: CHELAN COUNTY  
 AT: CHELAN FISH HATCHERY  
 COUNTY OF: CHELAN STATE: WA  
 APPL. BY: WASHINGTON DEPARTMENT OF FISH AND WILDLIFE  
 DATE: FEBRUARY 2012  
 REVISED:

PREPARED BY:  
 J.A. BRENNAN ASSOCIATES, PLLC

**WASHINGTON DEPARTMENT OF FISH AND WILDLIFE**

BEEBE SPRINGS NATURAL AREA PHASE 4A

REFERENCE #

ADDRESS: SR 97  
 Chelan, WA 98816

SHEET 3 OF 14: EXISTING CRITICAL AREAS - BEEBE CREEK AND CHINOOK SPRING

PURPOSE: TO RESTORE RIPARIAN ENVIRONMENTS, IMPROVE HABITAT, AND INSTALL A HIKING TRAIL SYSTEM

DATUM: NGVD 29

ADJACENT PROPERTY OWNERS: WSDOT, Chelan County PUD, COLUMBIA CASCADE RAILROAD

LATITUDE: 47° 49' 14" N  
 LONGITUDE: 119° 58' 34" W



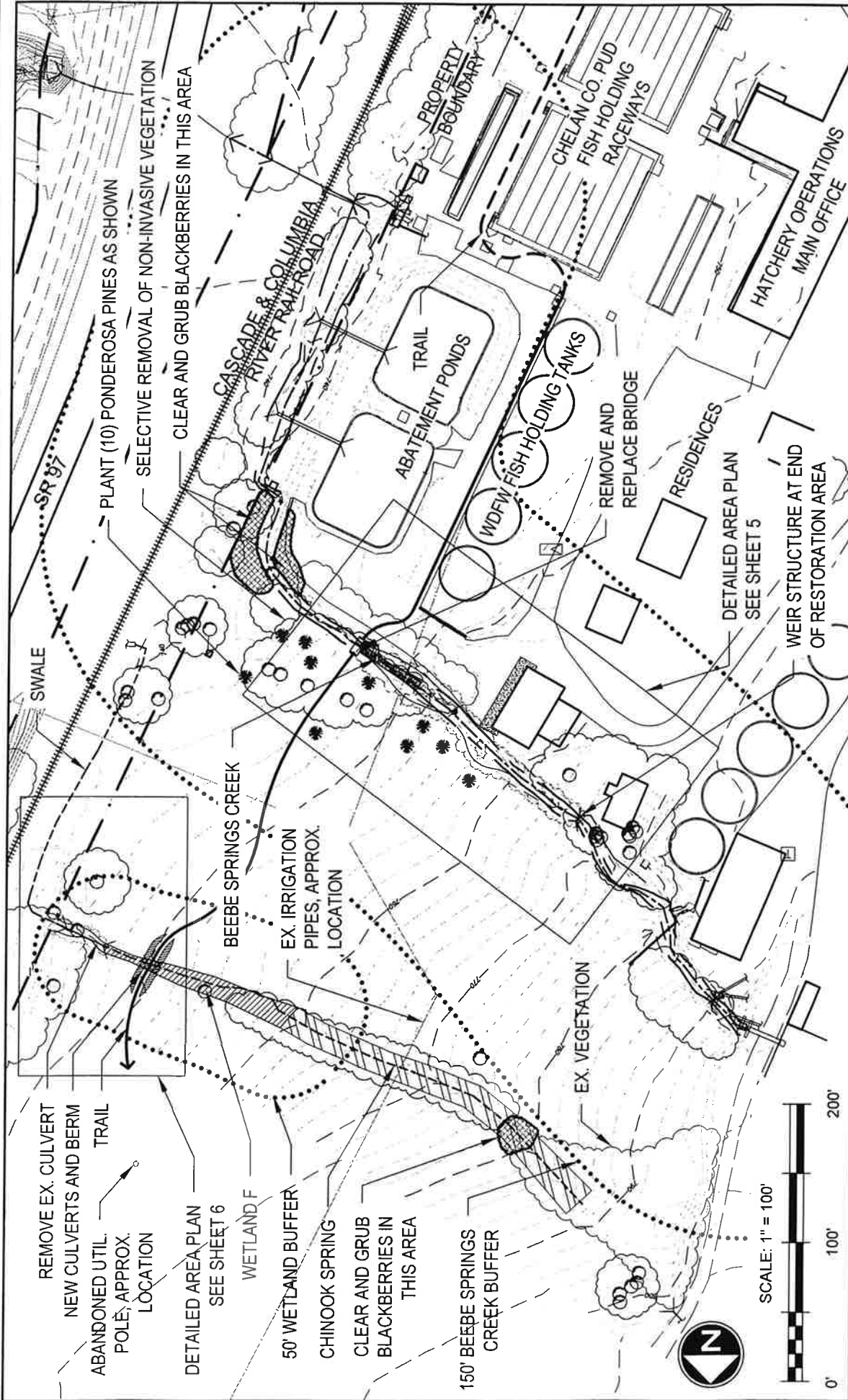

PROPOSED: BEEBE SPRINGS NATURAL AREA PHASE 4A  
 IN: CHELAN COUNTY  
 AT: CHELAN FISH HATCHERY  
 COUNTY OF: CHELAN STATE: WA  
 APPL. BY: WASHINGTON DEPARTMENT OF FISH AND WILDLIFE  
 DATE: FEBRUARY 2012  
 REVISED:

PREPARED BY:  
 J.A. BRENNAN ASSOCIATES, PLLC

**WASHINGTON DEPARTMENT OF FISH AND WILDLIFE**

BEEBE SPRINGS NATURAL AREA PHASE 4A

REFERENCE #:  
 ADDRESS: SR 97  
 Chelan, WA 98816

SHEET 4 OF 14: SITE PLAN - BEEBE CREEK AND CHINOOK SPRING

PURPOSE: TO RESTORE RIPARIAN ENVIRONMENTS, IMPROVE HABITAT, AND INSTALL A HIKING TRAIL SYSTEM

DATUM: NGVD 29

ADJACENT PROPERTY OWNERS: WSDOT, Chelan County PUD, COLUMBIA CASCADE RAILROAD

LATITUDE: 47° 49' 14" N  
 LONGITUDE: 119° 58' 34" W

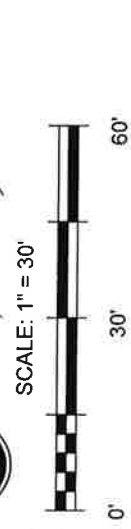
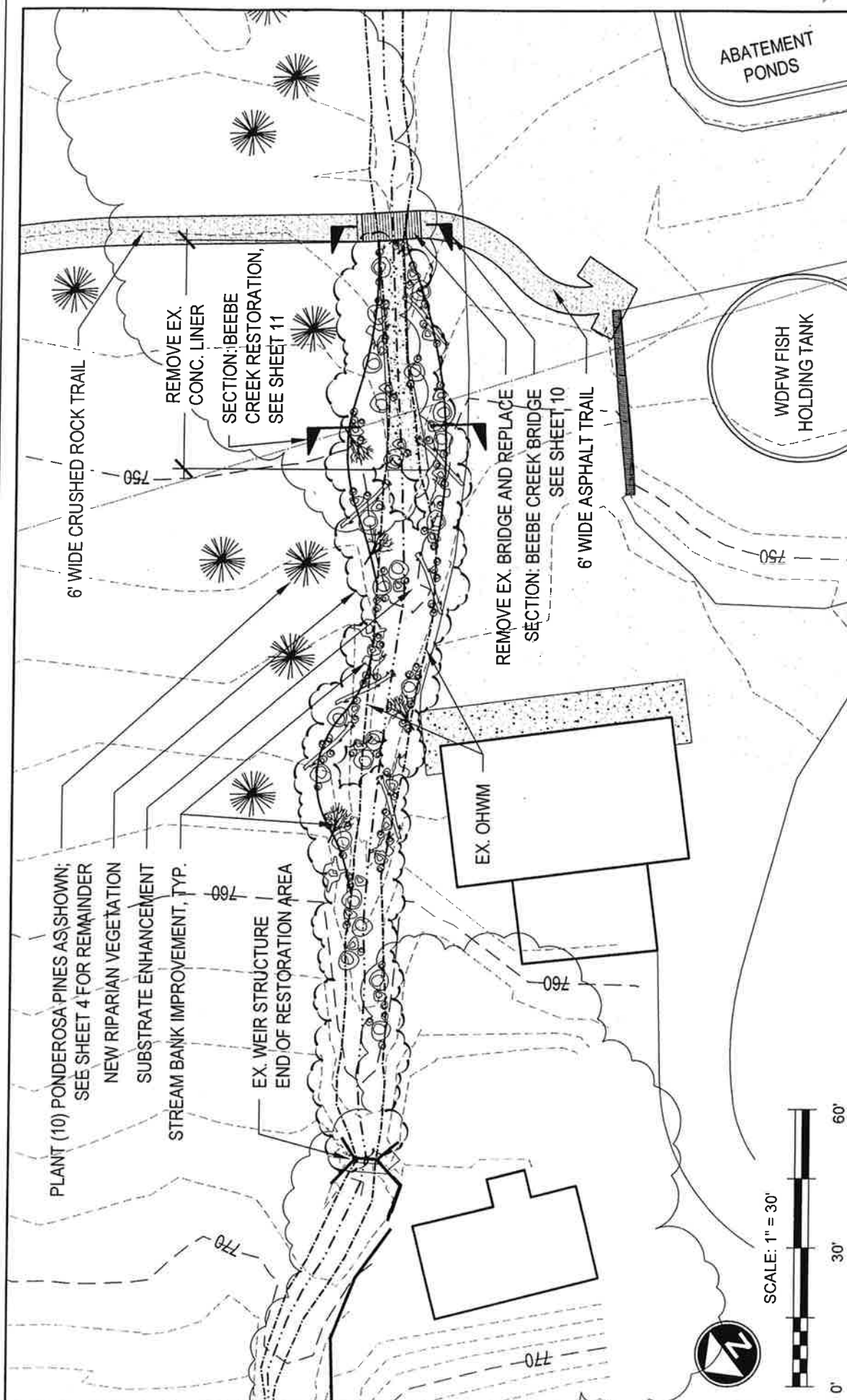

**WASHINGTON DEPARTMENT OF FISH AND WILDLIFE**

PROPOSED: BEEBE SPRINGS NATURAL AREA PHASE 4A  
 IN: CHELAN COUNTY  
 AT: CHELAN FISH HATCHERY  
 COUNTY OF: CHELAN STATE: WA  
 APPL. BY: WASHINGTON DEPARTMENT OF FISH AND WILDLIFE  
 DATE: FEBRUARY 2012  
 REVISED:

PREPARED BY:  
 J.A. BRENNAN ASSOCIATES, PLLC

**WASHINGTON DEPARTMENT OF FISH AND WILDLIFE**

BEEBE SPRINGS NATURAL AREA PHASE 4A

REFERENCE #:

ADDRESS: SR 97  
 Chelan, WA 98816

SHEET 5 OF 14: DETAILED AREA PLAN - BEEBE CREEK

PURPOSE: TO RESTORE RIPARIAN ENVIRONMENTS, IMPROVE HABITAT, AND INSTALL A HIKING TRAIL SYSTEM

DATUM: NGVD 29

ADJACENT PROPERTY OWNERS: WSDOT, Chelan County PUD, COLUMBIA CASCADE RAILROAD

LATITUDE: 47° 49' 14" N  
 LONGITUDE: 119° 58' 34" W

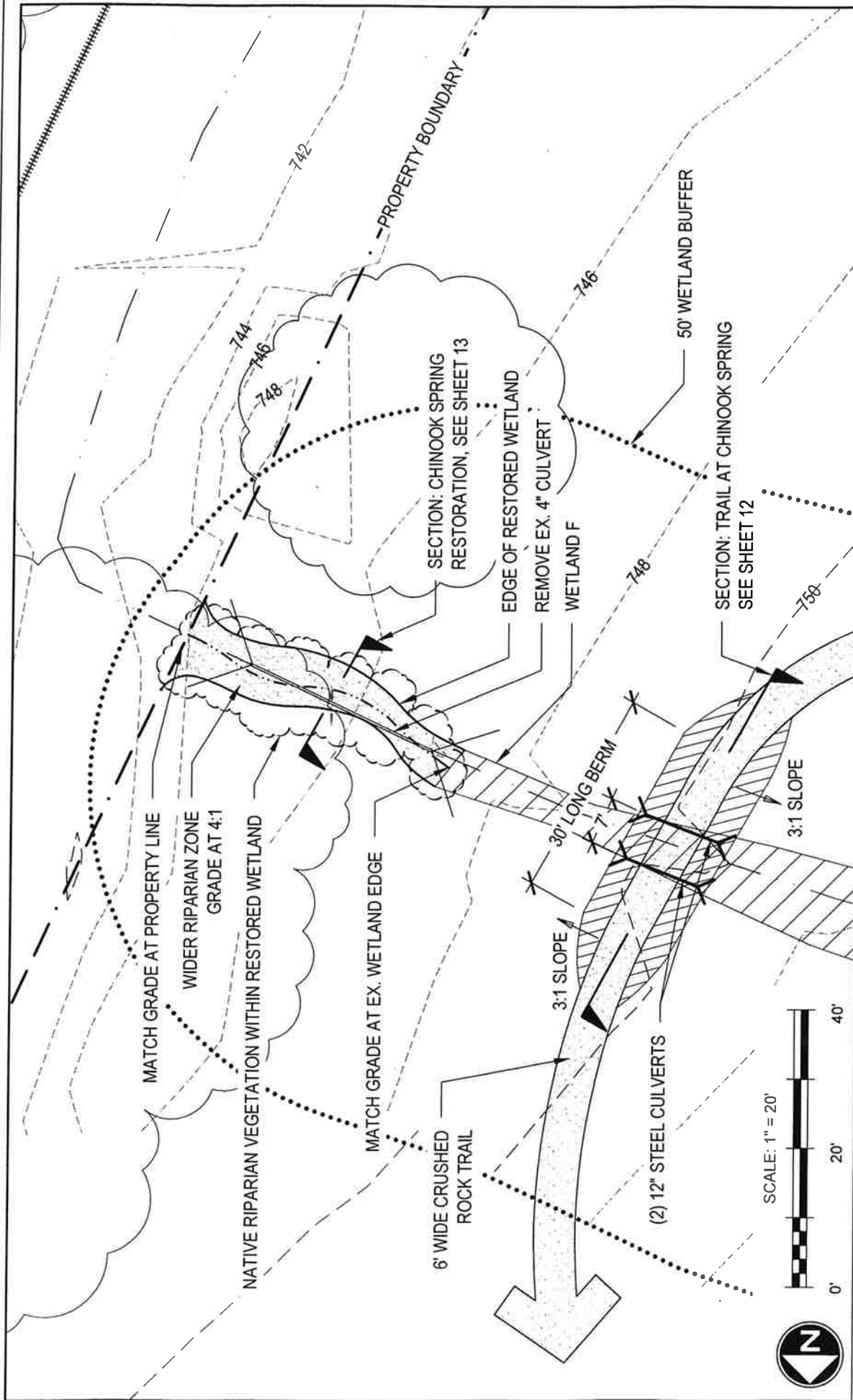

PROPOSED: BEEBE SPRINGS NATURAL AREA PHASE 4A  
 IN: CHELAN COUNTY  
 AT: CHELAN FISH HATCHERY  
 COUNTY OF: CHELAN STATE: WA  
 APPL BY: WASHINGTON DEPARTMENT OF FISH AND WILDLIFE  
 DATE: FEBRUARY 2012  
 REVISED:

**WASHINGTON DEPARTMENT OF FISH AND WILDLIFE**

BEEBE SPRINGS NATURAL AREA PHASE 4A

REFERENCE #:

ADDRESS: SR 97  
 Chelan, WA 98816

SHEET 6 OF 14: DETAILED AREA PLAN - CHINOOK SPRING

PURPOSE: TO RESTORE RIPARIAN ENVIRONMENTS, IMPROVE HABITAT, AND INSTALL A HIKING TRAIL SYSTEM

DATUM: NGVD 29

ADJACENT PROPERTY OWNERS: WSDOT, Chelan County PUD, COLUMBIA CASCADE RAILROAD

LATITUDE: 47° 49' 14" N  
 LONGITUDE: 119° 58' 34" W

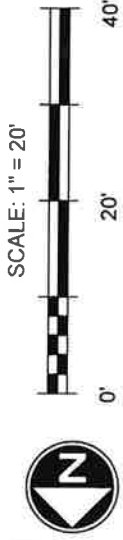

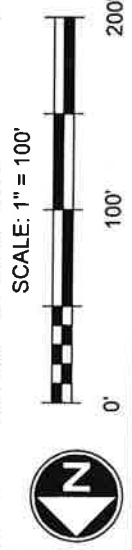
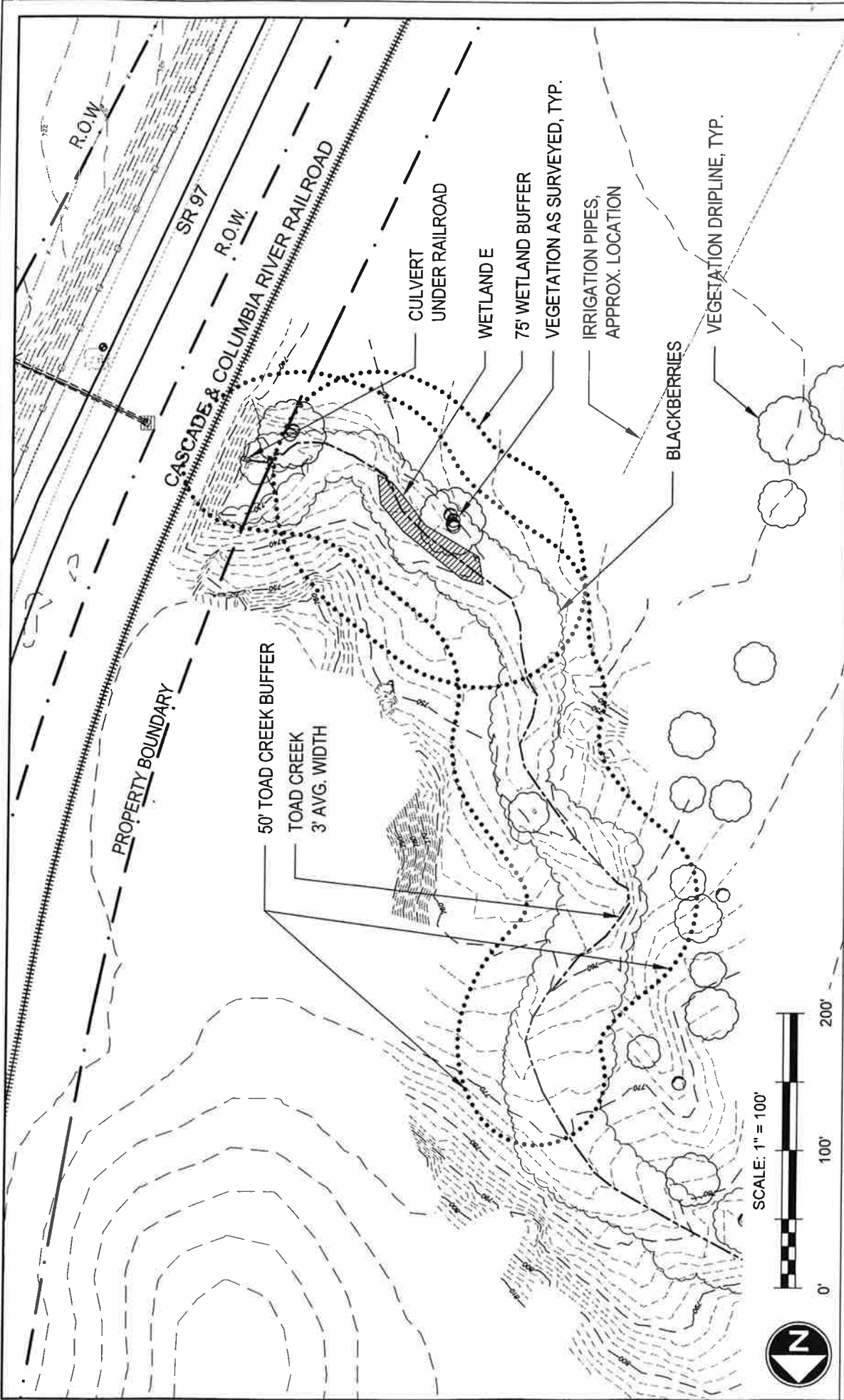

PROPOSED: BEEBE SPRINGS NATURAL AREA PHASE 4A  
 IN: CHELAN COUNTY  
 AT: CHELAN FISH HATCHERY  
 COUNTY OF: CHELAN STATE: WA  
 APPL. BY: WASHINGTON DEPARTMENT OF FISH AND WILDLIFE  
 DATE: FEBRUARY 2012  
 REVISED:

PREPARED BY:  
 J.A. BRENNAN ASSOCIATES, PLLC

**WASHINGTON DEPARTMENT OF FISH AND WILDLIFE**

BEEBE SPRINGS NATURAL AREA PHASE 4A

REFERENCE #:

ADDRESS: SR 97  
 Chelan, WA 98816

SHEET 7 OF 14: EXISTING CRITICAL AREAS - TOAD CREEK

PURPOSE: TO RESTORE RIPARIAN ENVIRONMENTS, IMPROVE HABITAT, AND INSTALL A HIKING TRAIL SYSTEM

DATUM: NGVD 29

ADJACENT PROPERTY OWNERS: WSDOT, Chelan County PUD, COLUMBIA CASCADE RAILROAD

LATITUDE: 47° 49' 14" N  
 LONGITUDE: 119° 58' 34" W

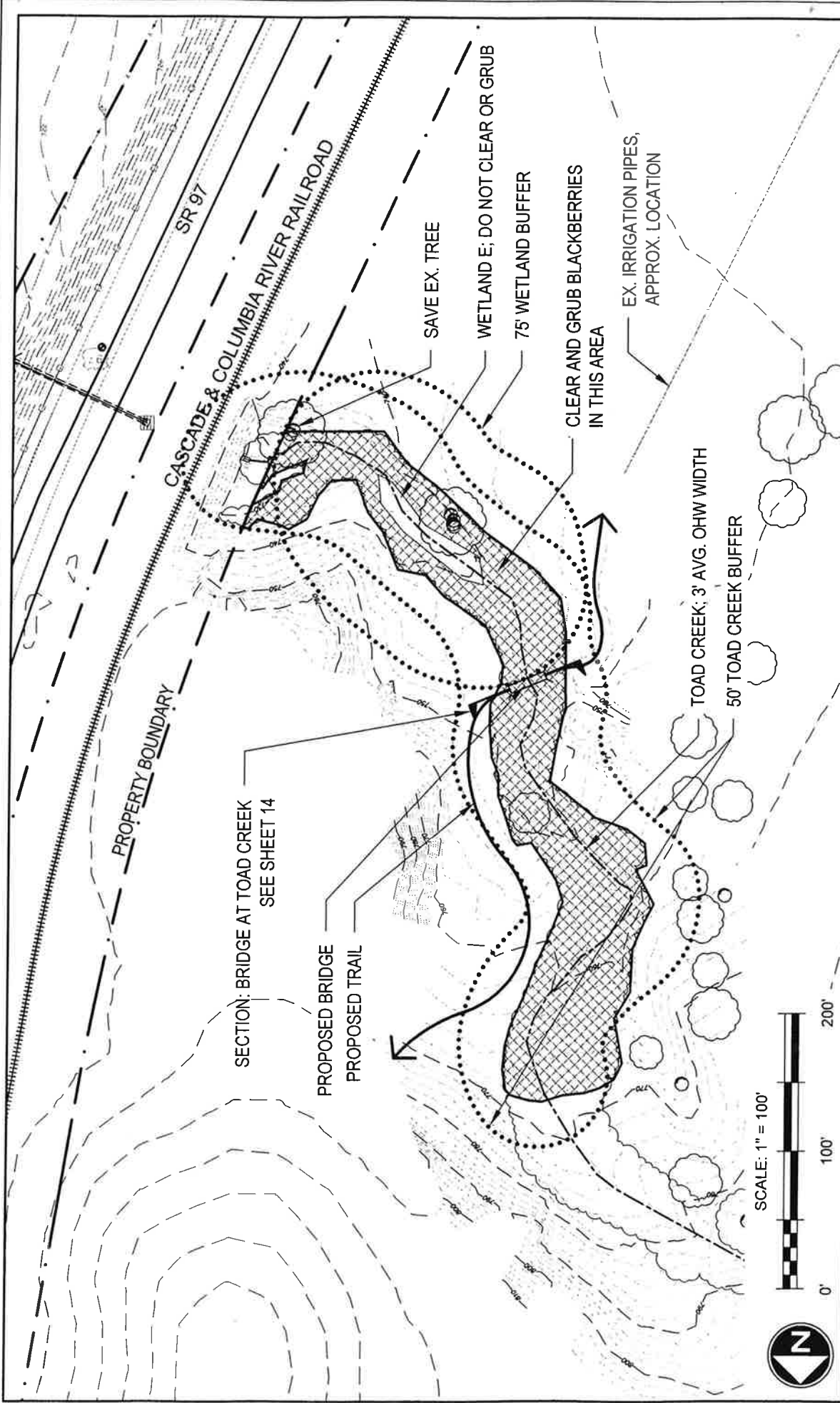

SCALE: 1" = 100'

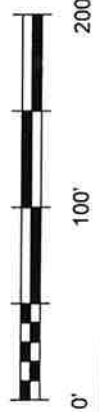

PROPOSED: BEEBE SPRINGS NATURAL AREA PHASE 4A  
 IN: CHELAN COUNTY  
 AT: CHELAN FISH HATCHERY  
 COUNTY OF: CHELAN STATE: WA  
 APPL. BY: WASHINGTON DEPARTMENT OF FISH AND WILDLIFE  
 DATE: FEBRUARY 2012  
 REVISED:

PREPARED BY:  
 J.A. BRENNAN ASSOCIATES, PLLC

<b>WASHINGTON DEPARTMENT OF FISH AND WILDLIFE</b>	
<b>BEEBE SPRINGS NATURAL AREA PHASE 4A</b>	
REFERENCE #:	SR 97 Chelan, WA 98816
SHEET 8 OF 14: SITE PLAN - TOAD CREEK	

PURPOSE: TO RESTORE RIPARIAN ENVIRONMENTS, IMPROVE HABITAT, AND INSTALL A HIKING TRAIL SYSTEM

DATUM: NGVD 29

ADJACENT PROPERTY OWNERS: WSDOT, Chelan County PUD, COLUMBIA CASCADE RAILROAD

LATITUDE: 47° 49' 14" N  
 LONGITUDE: 119° 58' 34" W



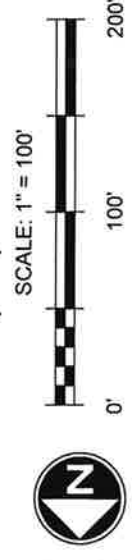
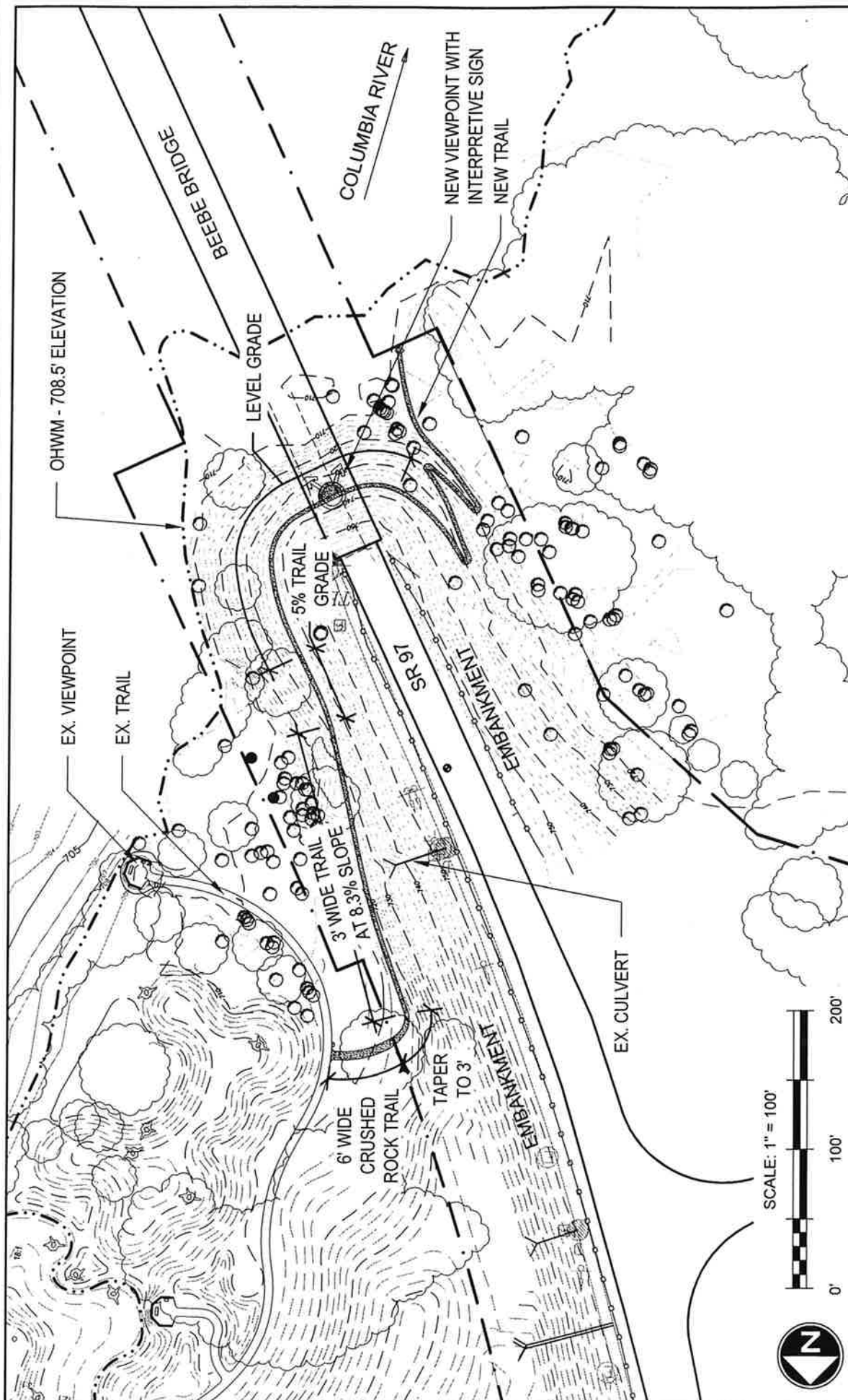

**PURPOSE:** TO RESTORE RIPARIAN ENVIRONMENTS, IMPROVE HABITAT, AND INSTALL A HIKING TRAIL SYSTEM

**DATUM:** NGVD 29

**ADJACENT PROPERTY OWNERS:** WSDOT, Chelan County PUD, COLUMBIA CASCADE RAILROAD

**LATITUDE:** 47° 49' 14" N  
**LONGITUDE:** 119° 58' 34" W

## WASHINGTON DEPARTMENT OF FISH AND WILDLIFE

**BEEBE SPRINGS NATURAL AREA PHASE 4A**

REFERENCE #:  
 ADDRESS: SR 97  
 Chelan, WA 98816

**SHEET 9 OF 14: SITE PLAN - BEEBE BRIDGE**

**PROPOSED:** BEEBE SPRINGS NATURAL AREA PHASE 4A  
**IN:** CHELAN COUNTY  
**AT:** CHELAN FISH HATCHERY  
**COUNTY OF:** CHELAN STATE: WA  
**APPL. BY:** WASHINGTON DEPARTMENT OF FISH AND WILDLIFE  
**DATE:** FEBRUARY 2012  
**REVISED:**

**PREPARED BY:**  
 J.A. BRENNAN ASSOCIATES, PLLC

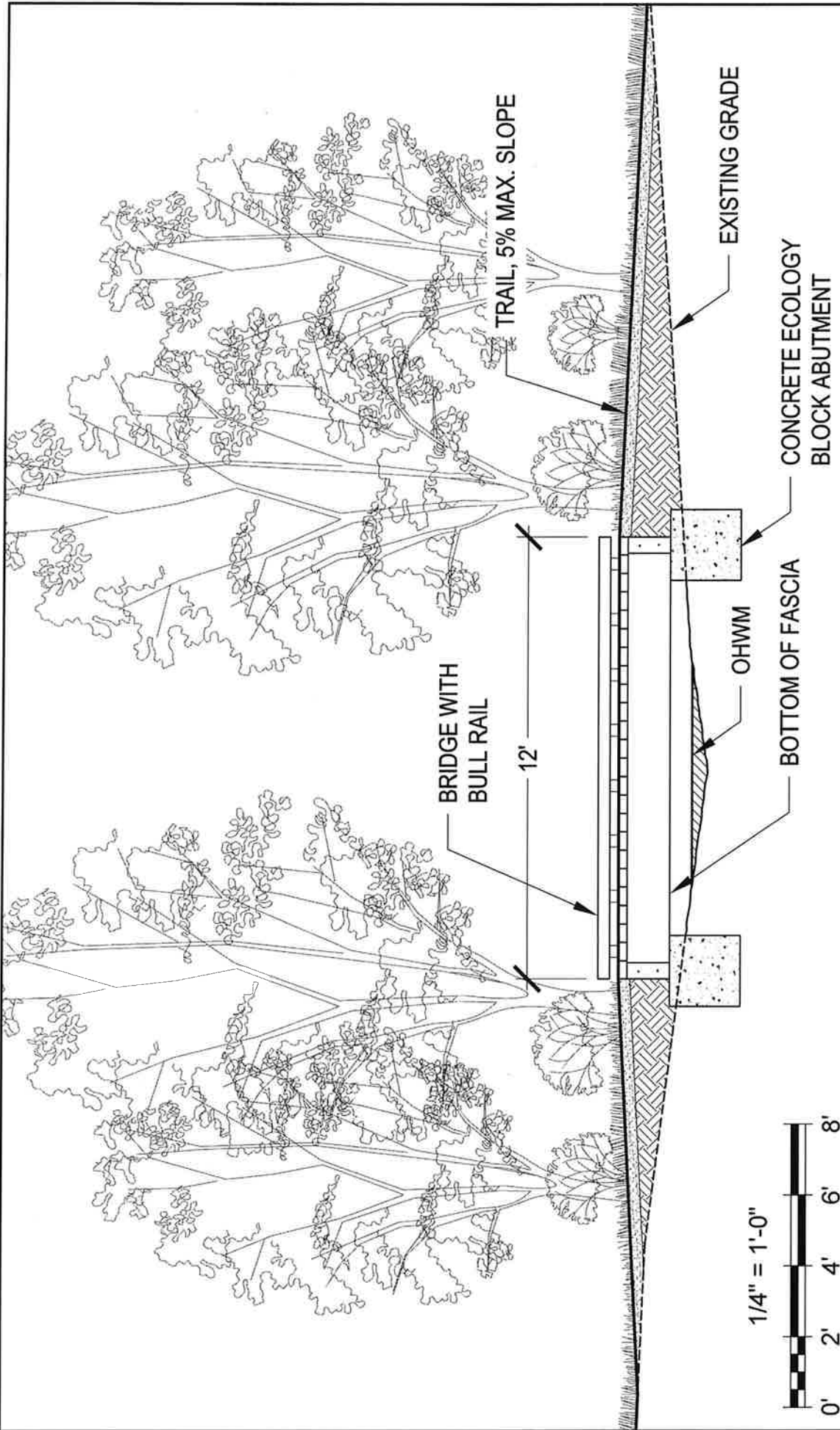

PROPOSED: BEEBE SPRINGS NATURAL AREA PHASE 4A  
 IN: CHELAN COUNTY  
 AT: CHELAN FISH HATCHERY  
 COUNTY OF: CHELAN STATE: WA  
 APPL. BY: WASHINGTON DEPARTMENT OF FISH AND WILDLIFE  
 DATE: FEBRUARY 2012  
 REVISED:

**WASHINGTON DEPARTMENT OF FISH AND WILDLIFE**

BEEBE SPRINGS NATURAL AREA PHASE 4A

REFERENCE #:  
 ADDRESS: SR 97  
 Chelan, WA 98816

SHEET 10 OF 14: SECTION - BRIDGE AT BEEBE CREEK

PREPARED BY:  
 J.A. BRENNAN ASSOCIATES, PLLC

PURPOSE: TO RESTORE RIPARIAN ENVIRONMENTS,  
 IMPROVE HABITAT, AND INSTALL A HIKING  
 TRAIL SYSTEM

DATUM: NGVD 29

ADJACENT PROPERTY OWNERS: WSDOT, Chelan County  
 PUD, COLUMBIA CASCADE RAILROAD

LATITUDE: 47° 49' 14" N  
 LONGITUDE: 119° 58' 34" W

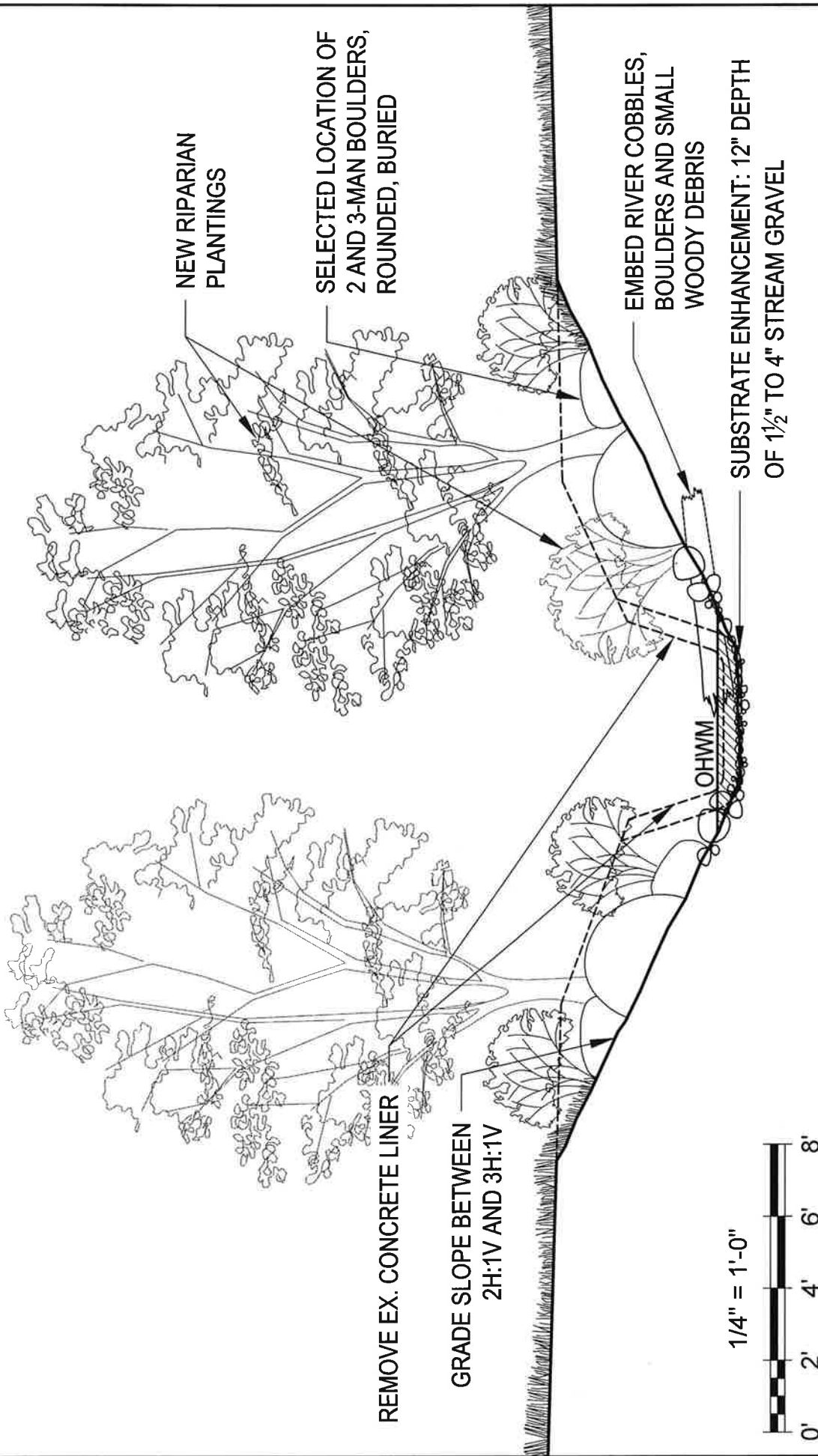

NEW RIPARIAN PLANTINGS

SELECTED LOCATION OF 2 AND 3-MAN BOULDERS, ROUNDED, BURIED

EMBED RIVER COBBLES, BOULDERS AND SMALL WOODY DEBRIS

SUBSTRATE ENHANCEMENT: 12" DEPTH OF 1 1/2" TO 4" STREAM GRAVEL

REMOVE EX. CONCRETE LINER

GRADE SLOPE BETWEEN 2H:1V AND 3H:1V

1/4" = 1'-0"

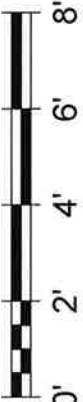

<b>PURPOSE:</b> TO RESTORE RIPARIAN ENVIRONMENTS, IMPROVE HABITAT, AND INSTALL A HIKING TRAIL SYSTEM  <b>DATUM:</b> NGVD 29  <b>ADJACENT PROPERTY OWNERS:</b> WSDOT, Chelan County PUD, COLUMBIA CASCADE RAILROAD  <b>LATITUDE:</b> 47° 49' 14" N <b>LONGITUDE:</b> 119° 58' 34" W	<b>WASHINGTON DEPARTMENT OF FISH AND WILDLIFE</b>		<b>PROPOSED:</b> BEEBE SPRINGS NATURAL AREA PHASE 4A <b>IN:</b> CHELAN COUNTY <b>AT:</b> CHELAN FISH HATCHERY <b>COUNTY OF:</b> CHELAN <b>STATE:</b> WA <b>APPL. BY:</b> WASHINGTON DEPARTMENT OF FISH AND WILDLIFE <b>DATE:</b> FEBRUARY 2012 <b>REVISED:</b>
	<b>BEEBE SPRINGS NATURAL AREA PHASE 4A</b>		<b>PREPARED BY:</b> J.A. BRENNAN ASSOCIATES, PLLC
<b>REFERENCE #:</b> SR 97 Chelan, WA 98816	<b>SHEET 11 OF 14: SECTION - BEEBE CREEK RESTORATION</b>		

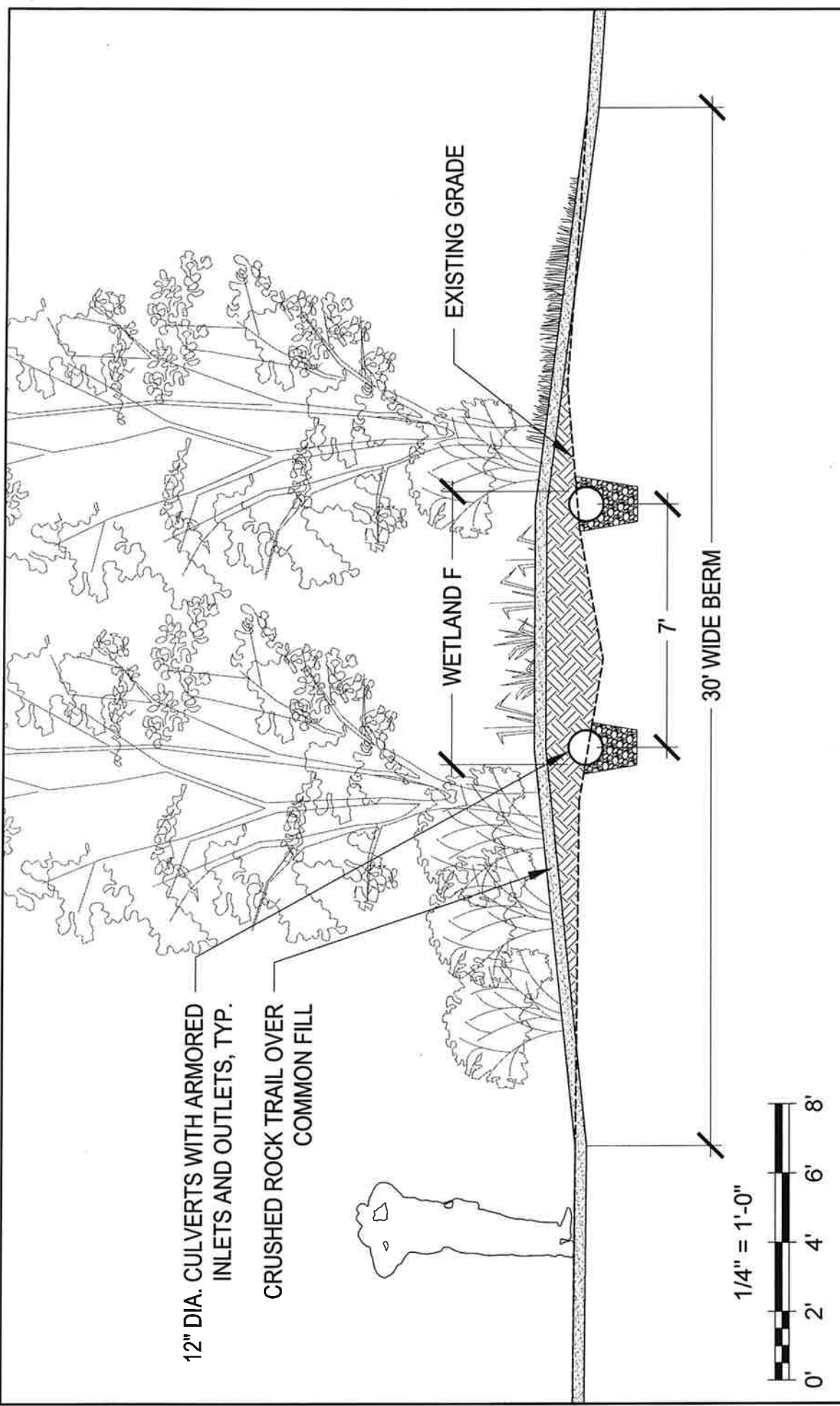

12" DIA. CULVERTS WITH ARMORED  
INLETS AND OUTLETS, TYP.  
CRUSHED ROCK TRAIL OVER  
COMMON FILL

EXISTING GRADE

WETLAND F

30' WIDE BERM

1/4" = 1'-0"

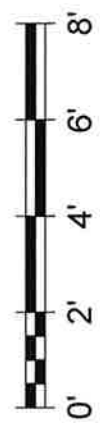

PURPOSE: TO RESTORE RIPARIAN ENVIRONMENTS,  
IMPROVE HABITAT, AND INSTALL A HIKING  
TRAIL SYSTEM

DATUM: NGVD 29

ADJACENT PROPERTY OWNERS: WSDOT, Chelan County  
PUD, COLUMBIA CASCADE RAILROAD

LATITUDE: 47° 49' 14" N  
LONGITUDE: 119° 58' 34" W

**WASHINGTON DEPARTMENT OF  
FISH AND WILDLIFE**

BEEBE SPRINGS NATURAL AREA PHASE 4A

REFERENCE # ADDRESS: SR 97  
Chelan, WA 98816

SHEET 12 OF 14: SECTION - TRAIL AT CHINOOK SPRING

PROPOSED: BEEBE SPRINGS NATURAL AREA PHASE 4A  
IN: CHELAN COUNTY  
AT: CHELAN FISH HATCHERY  
COUNTY OF: CHELAN STATE: WA  
APPL. BY: WASHINGTON DEPARTMENT OF FISH AND WILDLIFE  
DATE: FEBRUARY 2012  
REVISED:

PREPARED BY:  
J.A. BRENNAN ASSOCIATES, PLLC



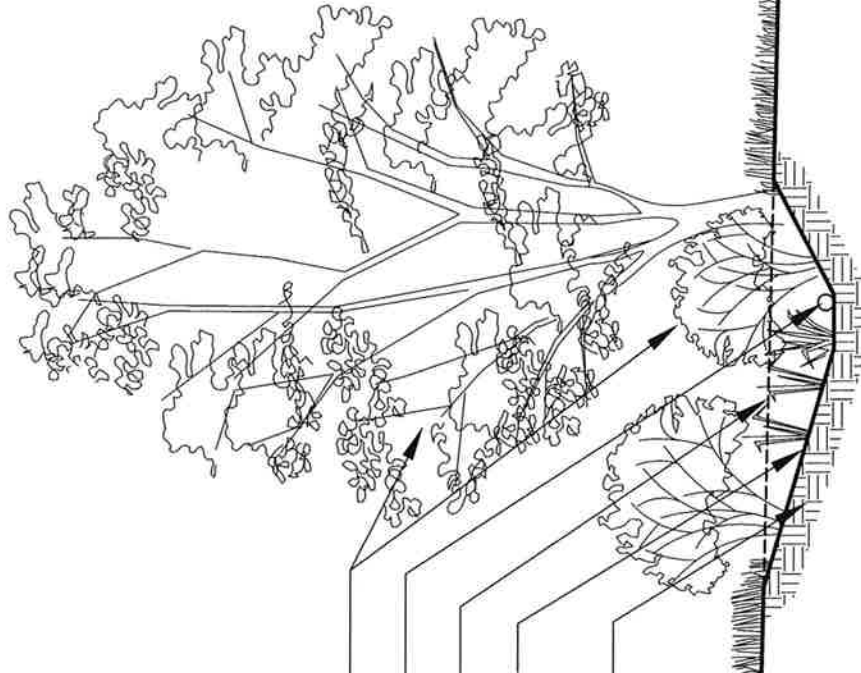

1/4" = 1'-0"



PURPOSE: TO RESTORE RIPARIAN ENVIRONMENTS,  
IMPROVE HABITAT, AND INSTALL A HIKING  
TRAIL SYSTEM

DATUM: NGVD 29

ADJACENT PROPERTY OWNERS: WSDOT, Chelan County  
PUD, COLUMBIA CASCADE RAILROAD

LATITUDE: 47° 49' 14" N  
LONGITUDE: 119° 58' 34" W

**WASHINGTON DEPARTMENT OF  
FISH AND WILDLIFE**

BEEBE SPRINGS NATURAL AREA PHASE 4A

REFERENCE #:  
ADDRESS: SR 97  
Chelan, WA 98816

SHEET 13 OF 14: SECTION - CHINOOK SPRING RESTORATION

PROPOSED: BEEBE SPRINGS NATURAL AREA PHASE 4A  
IN: CHELAN COUNTY  
AT: CHELAN FISH HATCHERY  
COUNTY OF: CHELAN STATE: WA  
APPL. BY: WASHINGTON DEPARTMENT OF FISH AND WILDLIFE  
DATE: FEBRUARY 2012  
REVISED:

PREPARED BY:  
J.A. BRENNAN ASSOCIATES, PLLC

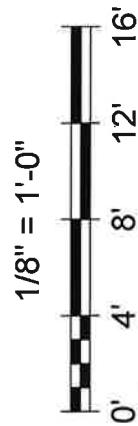
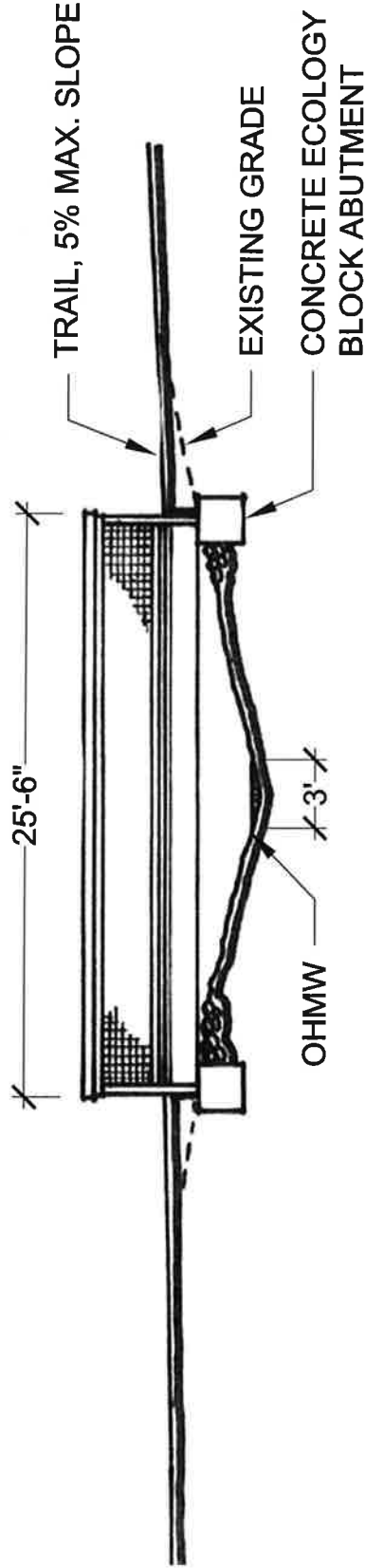

**PURPOSE:** TO RESTORE RIPARIAN ENVIRONMENTS,  
IMPROVE HABITAT, AND INSTALL A HIKING  
TRAIL SYSTEM

**DATUM:** NGVD 29

**ADJACENT PROPERTY OWNERS:** WSDOT, Chelan County  
PUD, COLUMBIA CASCADE RAILROAD

**LATITUDE:** 47° 49' 14" N  
**LONGITUDE:** 119° 58' 34" W

**WASHINGTON DEPARTMENT OF  
FISH AND WILDLIFE**

**BEEBE SPRINGS NATURAL AREA PHASE 4A**

**REFERENCE #:** ADDRESS: SR 97  
Chelan, WA 98816

**SHEET 14 OF 14: SECTION - BRIDGE AT TOAD CREEK**

**PROPOSED:** BEEBE SPRINGS NATURAL AREA PHASE 4A  
**IN:** CHELAN COUNTY  
**AT:** CHELAN FISH HATCHERY  
**COUNTY OF:** CHELAN **STATE:** WA  
**APPL. BY:** WASHINGTON DEPARTMENT OF FISH AND WILDLIFE  
**DATE:** FEBRUARY 2012  
**REVISED:**

**PREPARED BY:**  
J.A. BRENNAN ASSOCIATES, PLLC