

WASHINGTON DEPARTMENT OF FISH AND WILDLIFE
Application for Planting Triploid Grass Carp

1. Name of Applicant or Organization Kevin Litton - Zillah Lake Property Owners Assoc.
2. Address 709 Merwin Ct Day Phone: 509-952-1521
3. Name of Lake or Pond to be Planted: Zillah Lakes
4. County: Yakima Township: 11 Range: 20 Section: 22

Note: A photocopy of a county map showing rivers and streams at the proposed planting location MUST be provided with this application.

5. Size of lake or pond (1 acre= 208 X 208 ft.) 16 acres Max Depth (ft) 10ft
6. Does this pond or lake have public access provided by the city, county, state or federal government or other publicly owned municipality? YES ___ NO X
(Answer "NO" for golf course, sewage treatment or fish culture ponds and power or irrigation canals).
If you answered "NO", go to #8

7. If you answered "YES" to number 6, are the results of a Lake Restoration Feasibility Study included?
YES ___ NO ___

If you answered "YES" go to # 10 and skip #11.

If you answered "NO", a permit cannot be issued until the standards for a lake restoration study have been met. Please contact your local WDFW regional office to proceed with this study.

8. Total number of waterfront property owners: 18
9. Number of waterfront property owners that support 18 or oppose 0
Proposed planting of triploid grass carp.

Note: The names, addresses and phone numbers of all waterfront property owners and whether or not they support the proposed grass carp introduction MUST be provided with this application.

10. Have all outlets and/or inlets been screened? YES N/A NO ___ No out/in lets on Man Made Lake
If you answered "NO" you must apply for a Hydraulic Project Approval (HPA) before installing screens. **The Department of Fish and Wildlife will not issue a permit to plant triploid grass carp into waters with unscreened outlets.** If the proposed lake or pond is greater than 20 acres, other permits from the county of jurisdiction may be required to install screens. Please contact your Department of Fish and Wildlife Regional Office for additional direction on this requirement.

11. Please draw a map of the lake or pond as close to scale as possible on the attached sheet. Draw in vegetation types that are present. This map will assist our biologists in determining how many fish to plant into your pond or lake.

Signature of Applicant Kevin Litton Date 5/21/12

MAP OF LAKE OR POND

Please include distribution of each vegetation type. Irrigation and power canal applicants need only provide estimated acres of each plant type.

Please use the space below to draw a map of your water as close to scale as possible. Also draw in the approximate areas that are covered by each type of plant and properly label each. **Plant coverage estimates should be made in July or August or from your best recollection of that time period.**

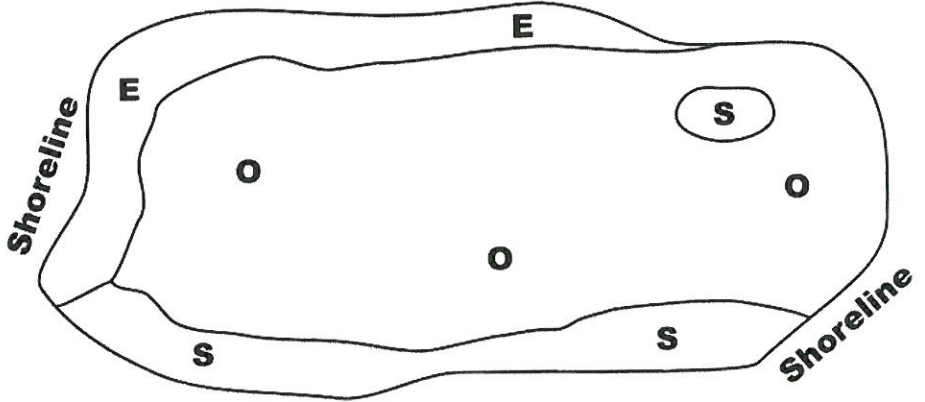

E- Emergent Plants
S- Submerged Plants
O- Open Water

E - Emergent Plants
completely surround
Lake & appear in
spots in middle of
Lakes. Milfoil &
Curly leaf Pondweed.

Name of Applicant ZLPOA / Kevin Lotton

Name of Lake or Pond Zillah Lakes



State of Washington
DEPARTMENT OF FISH AND WILDLIFE

Mailing Address: 600 Capitol Way N - Olympia, Washington 98501-1091 - (360) 902-2200, TDD (360) 902-2207
Main Office location: Natural Resources Building - 1111 Washington Street SE - Olympia, WA

Triploid grass carp may be planted in the State of Washington after the required permits and documents are approved. These permits and documents include:

1. Approval to plant triploid grass carp from the Washington Department of Fish and Wildlife (WDFW)
2. A State Environmental Policy Act (SEPA) determination.
3. Lake Restoration Study (ONLY if lake or pond is public)
4. Hydraulic Project Approval (ONLY if screening is required) (This is an approval that comes only after SEPA is satisfied)
5. Documentation from the United States Fish and Wildlife Service verifying the fish being planted are certified disease free triploid grass carp. (You will receive this from the vendor distributing the fish)

The following documents are needed to apply for a permit to plant triploid grass carp. Please follow the instructions below to ensure your application will be processed quickly.

1. The Washington Department of Fish and Wildlife Application for Planting Triploid Grass Carp. (Attached) Follow all instructions and provide accurate answers for each question.
2. A completed Environmental Checklist (attached). We have provided you with information for several of the questions on that list. You must provide the section, township and range of the water body, a daytime phone number where you can be reached, in the event we have questions and sign and date the checklist.
3. The Washington Department of Fish and Wildlife Fish Transport Application/Permit (Attached) After WDFW staff has completed their on-site evaluation and you have satisfied the State Environmental Policy Act (SEPA) process, you will need to complete this application and mail it to the regional Fish and Wildlife office in your area. **There is a \$24 fee that needs to accompany this application.**
4. If your lake or pond is public, the results of a lake restoration study must be provided to the WDFW. Please consult with your local WDFW regional office for additional direction on how to proceed with this requirement.
5. If the body of water to be planted with grass carp flows into another body of water, it will have to be screened. If the waterbody has to be screened you will need a Hydraulic Project Approval (HPA), to obtain said approval you will need to complete a JARPA form. Please consult with your local WDFW regional office prior to installing a screen for additional direction on this requirement.

***Please send all documents to the Department's regional office, which has jurisdiction in the county of your lake or pond. Your application may take approximately six to eight weeks to process. If you have any questions, please contact the same regional office where you submitted your application.**

FISH PROGRAM
Grass Carp Stocking Recommendation

RECEIVED

JUN 08 2012

HABITAT PROGRAM

Name of Applicant Kevin Litton – Zillah Lake Property Owners Association
Name of Water Zilla Lakes (private lakes near Zilla, WA)

Area Fish Biologist Recommendation

Approve X Deny _____

Comments: Recon surveyed on Thursday, May 24th with Kevin Litton. This is a closed system, 16 acre pond oriented in the uplands near Zilla between Yakima Valley Highway and Interstate 82. The pond is a maximum of 10 feet deep, has no inlet or outlet and is fed by groundwater seepage. There is a small stream/drain nearby, but it is not connected to the pond in any way and there does not appear to be any flood concerns. The pond had an abundance of curly leaved pondweed and northern milfoil, both preferred foods of grass carp. I recommend approval for stocking sterile grass carp in the Zilla Ponds at the rate of 9 fish per surface acre (total 144 fish). The fish must be purchased from an approved vendor, be certified disease free and be a minimum of 8 inches in length.



Signature

May 25, 2012
Date

Regional Fish Program Manager Recommendation

Approve ✓ Deny _____

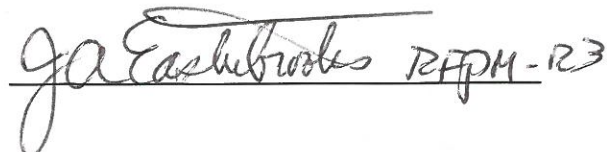
Comments: *approved for the reasons highlighted above.*

Signature

6/4/2012
Date

Send copy to Habitat Program, SEPA/NEPA Coordinator

WILDLIFE PROGRAM
Grass Carp Stocking Recommendation

Name of Applicant Kevin Litton Name of Water Zilla Lakes

Area Wildlife Biologist Recommendation

Approve Deny

Comments:

John Rony
Signature

5/29/12
Date

Regional Wildlife Program Manager Recommendation

Approve Deny

Comments:

Ted A Clausen
Signature

6/4/12
Date

Send copy to SEPA/NEPA Coordinator

HABITAT PROGRAM
Grass Carp Stocking Recommendation

Name of Applicant LITTON-ZILLAH LKS. Name of Water Zilla Lakes

Area Habitat Biologist Recommendation

Approve X Deny _____

Comments:

Eric Paul
Signature

6/04/2012
Date

Regional Habitat Program Manager Recommendation

Approve X Deny _____

Comments:

*Okay - no surface water
connectivity/ isolated.*

Randy J. Harter
Signature

6/04/2012
Date

Send copy to SEPA/NEPA Coordinator

= Lakefront Property Owners

ZILLAH LAKES POA OWNERS LIST as of 5/2/12

42 Lots Owned. 35 Houses, 5 Undeveloped Lots, the Sheriff & the ZLPOA Pool

<u>LOT</u>	<u>NAME</u>	<u>ADDRESS</u>	<u>EMAIL</u>	<u>PHONE</u>
1	UNITED BUILDERS	808 Fountain Blvd		
2	DECKER, Nathan Heather	806 Fountain Blvd	natedecker@hotmail.com heatherdecker2009@hotmail.com	509-945-2271 509-945-7600
3	LEE, Daniel	804 Fountain Blvd	ddshlee83@yahoo.com	425-486-3159
4	ZIMCHEK, Heather	802 Fountain Blvd	subalpineheather@gmail.com	757-663-2233
19	UNITED BUILDERS	703 Fountain Blvd		
20	UNITED BUILDERS	705 Fountain Blvd		
21	UNITED BUILDERS	707 Fountain Blvd		
22	DOUGLAS Investments	709 Fountain Blvd	diwallc@yahoo.com	509-261-1567
23	DOUGLAS Investments	711 Fountain Blvd	diwallc@yahoo.com	509-261-1567
25	SHERIFF	715 Fountain Blvd		
26	HEACOCK, Marty Brenda	8002 Vialago Pkwy	ravensfam@msn.com	509-965-5964
27	SWAN, Andrew	8004 Vialago Pkwy	andy762@live.com	509-969-4506
28	UNITED BUILDERS	8006 Vialago Pkwy		
32	STROSAHL, Ellie	710 Kachess Lane	ellie@theseasonsyakima.com	509-728-1216
33	HAMMILL, Ron Alice	708 Kachess Lane	ronhammill@hotmail.com	206-546-5722
34	GORSKI, Eleanor	706 Kachess Lane		
35	GARDNER, Mark Kathryn		markgardnerfam.@juno.com	425-432-7096
37	MOSLANDER, Clyde Helen	700 Kachess Lane	clyde@moslanders.com helen@moslanders.com	206-819-6837 206-200-8778
39	McLAUGHLIN, Rollie Fran	703 Kachess Lane	kachess1942@gmail.com	509-930-9428
40	STROSAHL, Pat Judy	705 Kachess Lane	pstrosahl@comcast.net jstrosahl@comcast.net	509-314-6307 206-396-7246
41	LEDFOORD, Rick	707 Kachess Lane	rickledford@comcast.net	
42	IBATUAN, Carlisle	709 Kachess Lane	donibatuan@yahoo.com	509-949-5074
44	CONWAY, Terrence Claire	8014 Vialago Pkwy	tpc@tcspanamerica.com cconway91@comcast.net	425-774-3881 206-660-0501
45	CONWAY, Terrence Claire	8016 Vialago Pkwy	tpc@tcspanamerica.com cconway91@comcast.net	425-774-3881 206-660-0501



46	GARDNER, Mark Kathryn		markgardnerfam.@juno.com	425-432-7096
48	RIVERO, Jacobo Marissabel	710 Merwin Court	jacoborivero1@msn.com	509-594-1678
49	HEMPHILL, Luke & Tim			
50	UNITED BUILDERS	706 Merwin Court		
52	GARDNER, Mark Kathryn		markgardnerfam.@juno.com	425-432-7096
56	UNITED BUILDERS	705 Merwin Court		
57	UNITED BUILDERS	707 Merwin Court		
58	LITTON, Kevin Tina	709 Merwin Court	kmamicc@live.com tklitt@embarqmail.com	509-865-3866
59	LITTON, Kevin Tina	711 Merwin Court	kmamicc@live.com tklitt@embarqmail.com	509-865-3866
60	ZLPOA	713 Merwin Court		
61	UNITED BUILDERS	9002 Vialago Pkwy		
62	UNITED BUILDERS	9003 Vialago Pkwy		
63	HOENE, Dave Terry	9001 Vialago Pkwy	terryhoene@embarqmail.com	360-464-5674 360-464-5674
64	WHEELER, Jody ROLL, Adam	8025 Vialago Pkwy	millennium26@aol.com	509-949-7856 509-460-0205
65	PEARSON, Elsie	8023 Vialago Pkwy	EAKT5g@embarqmail.com	509-674-8486
66	BECKMAN, Dee	8021 Vialago Pkwy		509-494-4490
68	FRENCH, Larry Mary Kay	8017 Vialago Pkwy	larry@culinarytoursinternational.com	206-755-3337
72	SCATES, Joe			

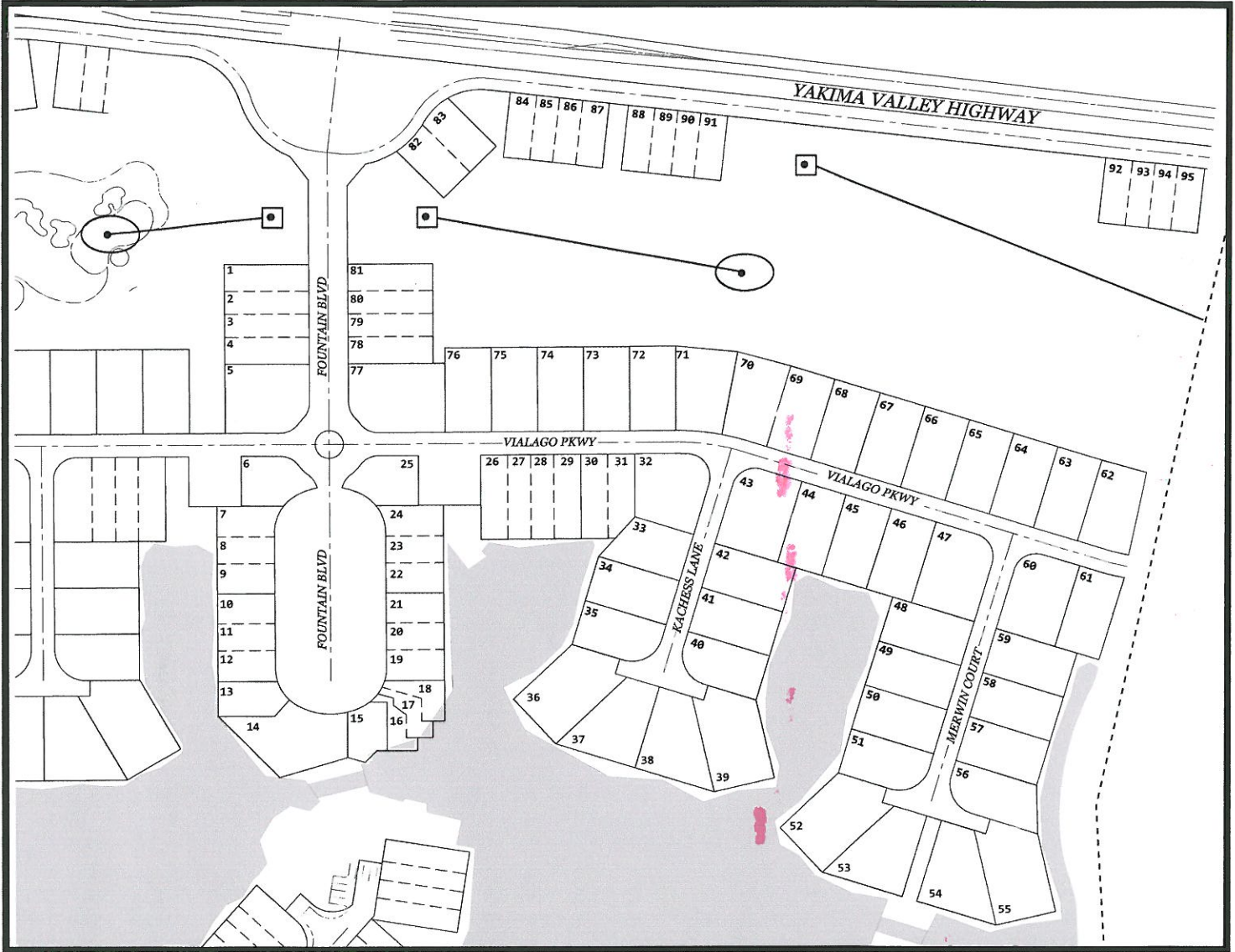

- | | | | |
|----------------------------|------------------------------|-------------------------------|----|
| 1 Howard, James & Lisa | 25 Sheriff | 49 Hemphill, Luke & Tim | 73 |
| 2 Decker, Nathan & Heather | 26 Heacock, Marty & Brenda | 50 Rahim, Aisha & Yusuf | 74 |
| 3 | 27 Swan, Andrew | 51 | 75 |
| 4 Zimcheck, Heather | 28 Bevers, Chris & Crystal | 52 Gardner, Mark & Kathy | 76 |
| 5 | 29 | 53 | 77 |
| 6 | 30 | 54 | 78 |
| 7 | 31 | 55 | 79 |
| 8 | 32 Stroshal, Ellie | 56 Steve Lane & Aaron Sanders | 80 |
| 9 | 33 Greene, Trevor & Melanie | 57 Sanders, Will & Nicole | 81 |
| 10 | 34 Gorski, Eleanor | 58 Litton, Kevin & Tina | 82 |
| 11 | 35 Getaway Program Home | 59 | 83 |
| 12 | 36 | 60 | 84 |
| 13 | 37 Moslander, Clyde & Lenie | 61 Jeong, Won & Ho Jeong | 85 |
| 14 | 38 | 62 Tynan, Chris | 86 |
| 15 | 39 McLaughlin, Rollie & Fran | 63 Hoene, Dave & Terry | 87 |
| 16 | 40 Stroshal, Pat & Judy | 64 Roll, Adam & Jody | 88 |
| 17 | 41 Sundberg, Tom & Kath | 65 Pearson, Elsie | 89 |
| 18 | 42 Ibatuan, Carlisle | 66 Beckman, Dee | 90 |
| 19 Getaway Program Home | 43 | 67 French, Larry & Mary Kay | 91 |
| 20 Bossert, Cherie | 44 | 68 | 92 |
| 21 Lakman, Doug & Pam | 45 Conway, Terry & Claire | 69 | 93 |
| 22 | 46 Gardner, Mark & Kathy | 70 | 94 |