

# Appendix A

## Durr Road Bridge Environmental Review Project Drawings

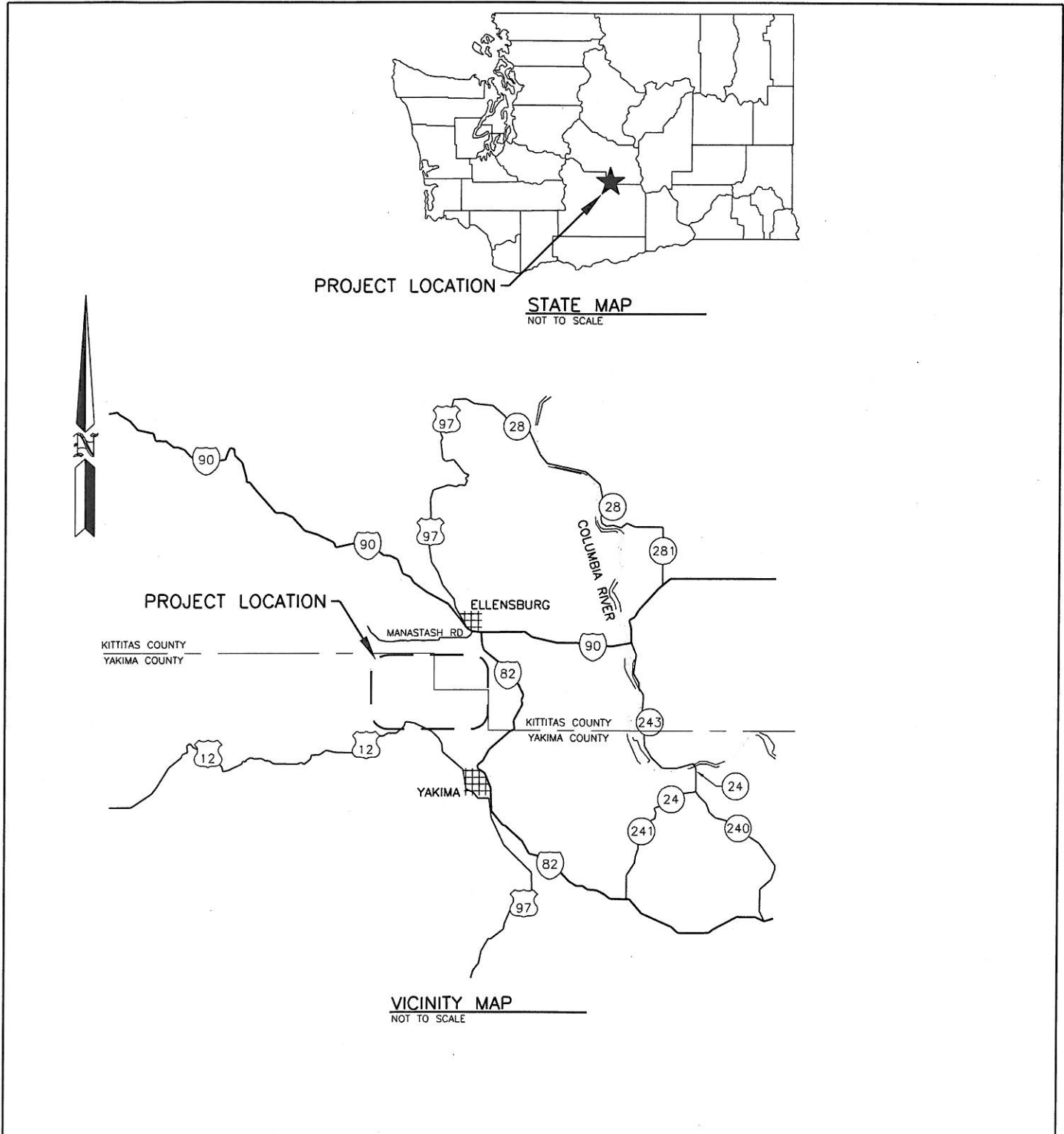

PURPOSE: RESTORE STREAM CROSSING REDUCE IMPACT TO STREAMBED	WASHINGTON DEPT. of FISH & WILDLIFE 600 CAPITOL WAY N. OLYMPIA, WA 98501-1091	PROPOSED: REPLACE EXISTING FORD W/ 60' BRIDGE
DATUM: <u>ASSUMED</u> ADJACENT PROPERTY OWNER: 1. <u>WADNR</u> 2. <u>WDFW</u> ENG. PROJECT NO. <u>YA:R3:12-3</u>	REFERENCE NO. _____ SITE: <u>DURR ROAD, UMTANUM CR</u> ADDRESS: _____	IN: <u>UMTANUM CREEK</u> NEAR: <u>ELLENSBURG</u> COUNTY OF: <u>KITTITAS</u> STATE: <u>WA</u> PORTION OF: <u>T. 16N., S. 16, R. 18E</u> DATE: <u>7-23-2012</u> SHEET 1 OF 9

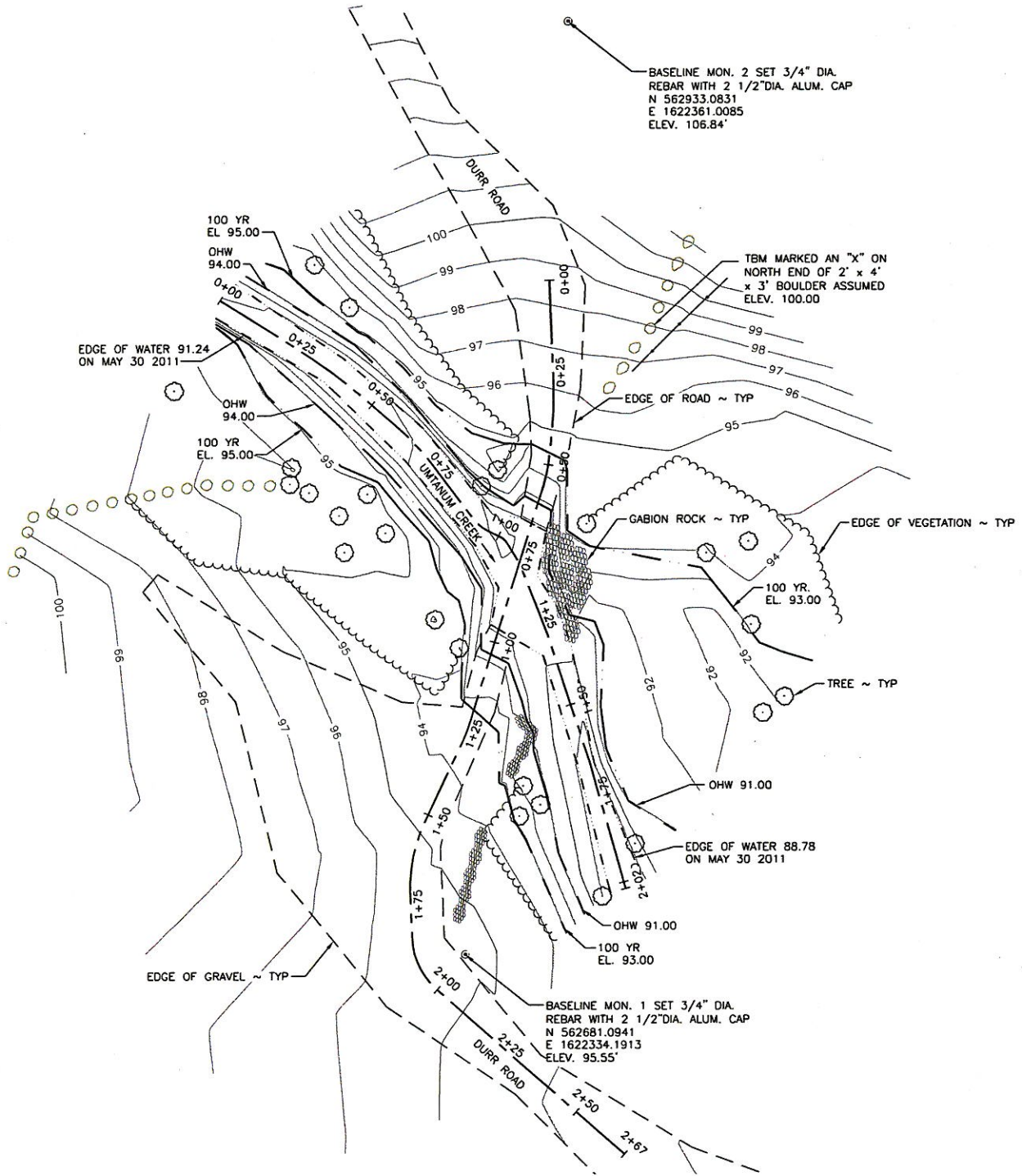

**EXISTING SITE PLAN**  
SCALE: 1" = 40'

REFERENCE NO. _____
APPLICANT: <b>WASHINGTON DEPT. of FISH &amp; WILDLIFE</b>
<b>WENAS WILDLIFE AREA</b> <b>WENAS ROAD RENOVATION DURR ROAD</b> <b>EXISTING SITE PLAN</b>
AT: _____, WASHINGTON
DATE: <b>7-23-2012</b> SHEET <b>2</b> OF <b>9</b>

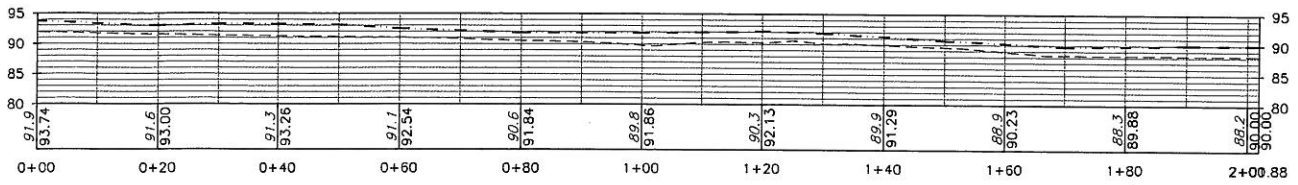

**EXISTING STREAM PROFILE**

SCALE: 1" = 30'

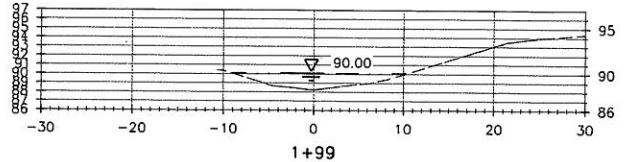
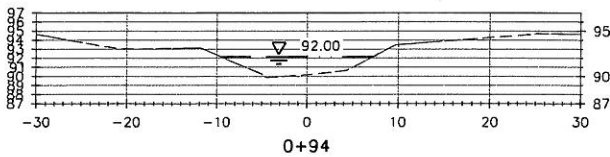
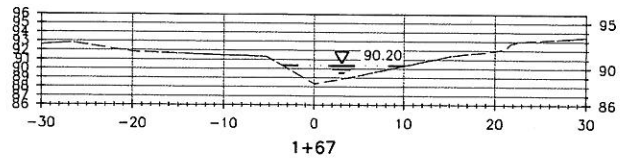
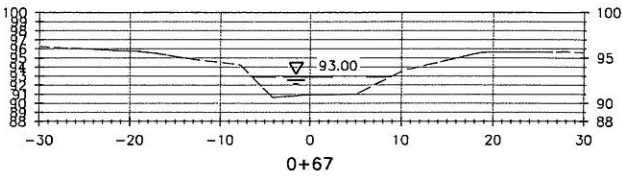
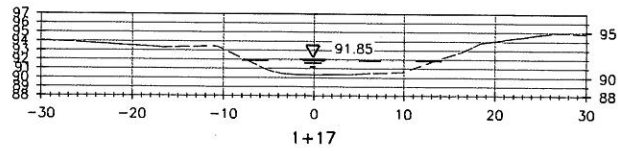
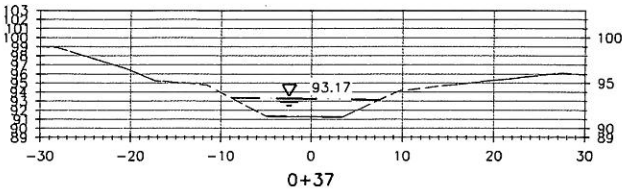

**EXISTING STREAM SECTIONS - OHW**

SCALE: 1" = 20'

REFERENCE NO. _____
APPLICANT: WASHINGTON DEPT. of FISH & WILDLIFE
<b>WENAS WILDLIFE AREA</b> WENAS ROAD RENOVATION, DURR ROAD EXISTING STREAM PROFILE AND SECTIONS
AT: _____, WASHINGTON
DATE: 7-23-2012 SHEET 3 OF 9

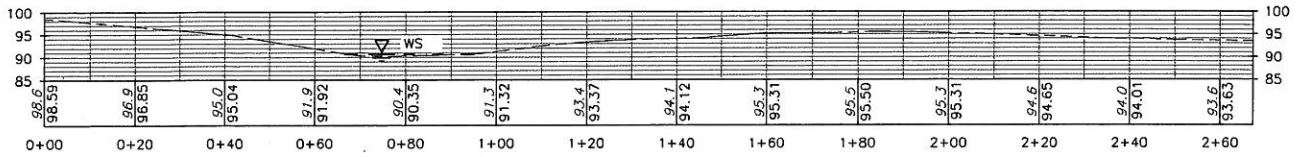

**EXISTING ROAD PROFILE**

SCALE: 1" = 30'

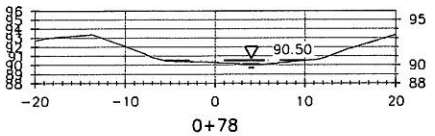
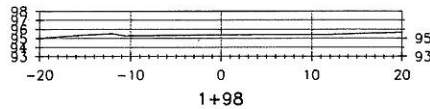
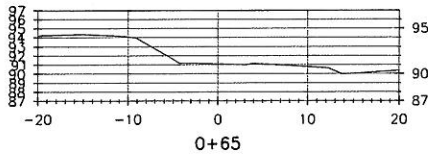
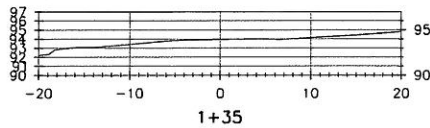
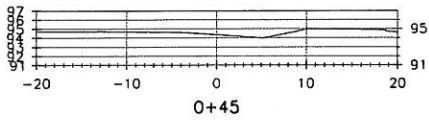
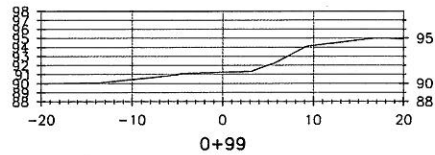
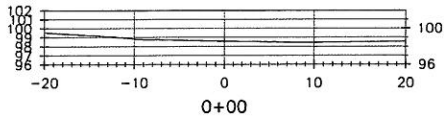

**EXISTING ROAD SECTIONS**

SCALE: 1" = 20'

REFERENCE NO. _____
APPLICANT: WASHINGTON DEPT. of FISH & WILDLIFE
<b>WENAS WILDLIFE AREA</b> WENAS ROAD RENOVATION, DURR ROAD EXISTING ROAD PROFILE AND SECTIONS
AT: _____, WASHINGTON
DATE: 7-23-2012 SHEET 4 OF 9

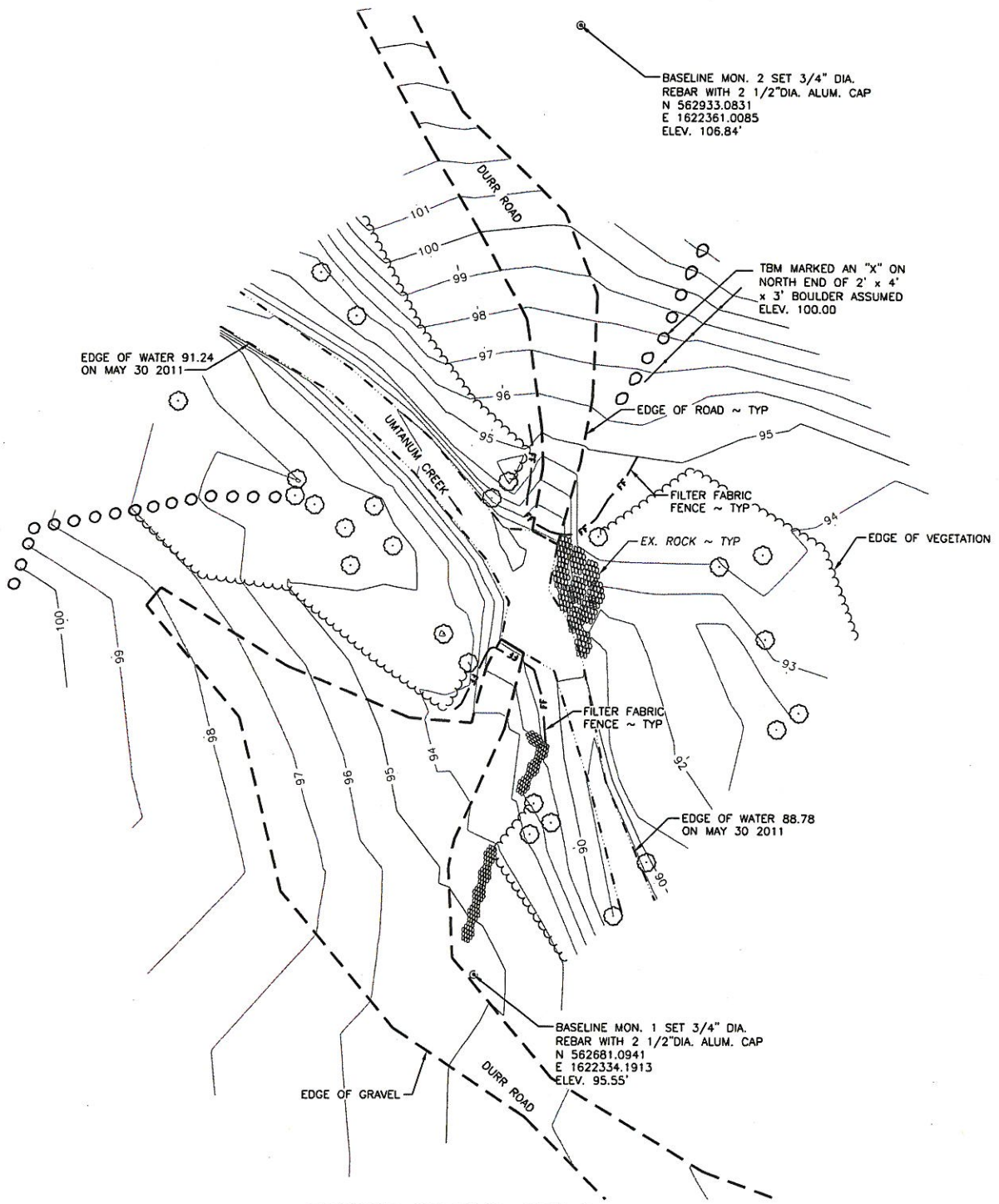

**EROSION CONTROL SITE PLAN**

SCALE: 1" = 40'

REFERENCE NO.
APPLICANT: WASHINGTON DEPT. of FISH & WILDLIFE
WENAS WILDLIFE AREA WENAS ROAD RENOVATION DURR ROAD EROSION CONTROL SITE PLAN
AT: _____, WASHINGTON
DATE: 7-23-2012 SHEET 5 OF 9

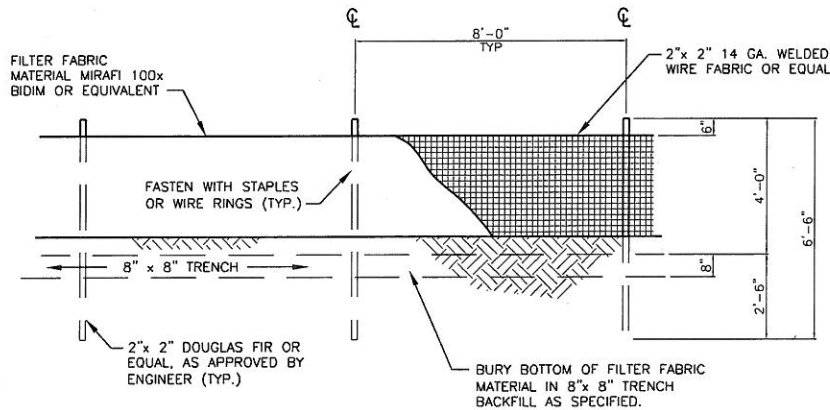

### FILTER FABRIC FENCE

SCALE: NONE

#### FILTER FABRIC NOTES:

1. FILTER FABRIC SHALL BE PURCHASED CONTINUOUS ROLL CUT TO LENGTH OF BARRIER AS NEEDED. IF JOINTS ARE NECESSARY FABRIC SHALL BE SPLICED TOGETHER ONLY AT SUPPORT POSTS WITH A MINIMUM OF (6) INCH OVERLAP. BOTH ENDS SHALL BE SECURED AS REQUIRED.
2. FILTER FABRIC SHALL BE INSTALLED TO FOLLOW CONTOURS. FENCE POSTS SHALL BE SPACED A MAXIMUM OF EIGHT (8) FEET APART UNLESS OTHERWISE SHOWN HEREIN. ALL POSTS SHALL BE DRIVEN INTO THE GROUND A MINIMUM OF 30 INCHES.
3. A TRENCH SHALL BE EXCAVATED, ROUGHLY EIGHT (8) INCHES WIDE BY EIGHT (8) INCHES DEEP UP SLOPE AND ADJACENT TO THE POST TO ALLOW THE FILTER FABRIC TO BE BURIED.
4. WHEN STANDARD STRENGTH FILTER FABRIC IS UTILIZED, A WIRE SINGLE SPACE MESH SUPPORT FENCE SHALL BE FASTENED TO THE UPSLOPE (OR UPSTREAM) SIDE OF THE POSTS USING ONE (1) INCH MINIMUM LENGTH WIRE STAPLES, TIE WIRE OR APPROVED HOG RINGS. ALL WIRE SUPPORT SHALL EXTEND INTO THE TRENCH A MINIMUM OF FOUR (4) INCHES AND SHALL NOT EXTEND MORE THAN 36 INCHES ABOVE ORIGINAL GRADE.
5. ALL FILTER FABRIC SHALL BE STAPLED OR WIRED TO SUPPORT FENCING AND A MINIMUM OF 20 INCHES OF FABRIC SHALL BE EXTENDED INTO THE TRENCH. FILTER FABRIC SHALL NOT BE STAPLED OR FASTENED TO EXISTING TREES OR STRUCTURES UNLESS OTHERWISE APPROVED BY THE ENGINEER.
6. IF HIGH STRENGTH FILTER FABRIC AND CLOSER SPACING ARE USED, THE WIRE SUPPORT FENCING MAY BE ELIMINATED. HIGH STRENGTH FABRIC SHALL BE STAPLED OR WIRED DIRECTLY TO POSTS AS REQUIRED BY THE ENGINEER.
7. CUTOFF TRENCH SHALL BE BACKFILLED WITH 3/4 INCH MINIMUM DIAMETER WASHED GRAVEL OR OTHER SIMILAR SOURCE AS APPROVED BY THE ENGINEER.
8. FILTER FENCING SHALL BE INSTALLED WHERE SHOWN ON THE PLAN, OR AS MARKED IN THE FIELD BY THE ENGINEER, PRIOR TO COMMENCEMENT OF WORK. ALL FENCING SHALL BE INSPECTED DAILY DURING CONSTRUCTION AND AFTER EACH SIGNIFICANT RAINFALL EVENT UNTIL SITE HAS BEEN PERMANENTLY STABILIZED. ANY REQUIRED REPAIRS SHALL BE MADE IMMEDIATELY.
9. REMOVAL OF TRAPPED SEDIMENT SHALL BE PERFORMED WHEN AMOUNTS REACH APPROXIMATELY 1/3 HEIGHT OF THE FENCE.
10. FILTER FENCING SHALL REMAIN IN-PLACE UNTIL SITE HAS BEEN REVEGETATED TO ORIGINAL CONDITION OR DIRECTED BY THE ENGINEER.

REFERENCE NO. \_\_\_\_\_

APPLICANT:

WASHINGTON DEPT. of FISH & WILDLIFE

WENAS WILDLIFE AREA

WENAS ROAD RENOVATION, DURR ROAD

FILTER FABRIC FENCE

AT: \_\_\_\_\_, WASHINGTON

DATE: 7-23-2012 SHEET 6 OF 9

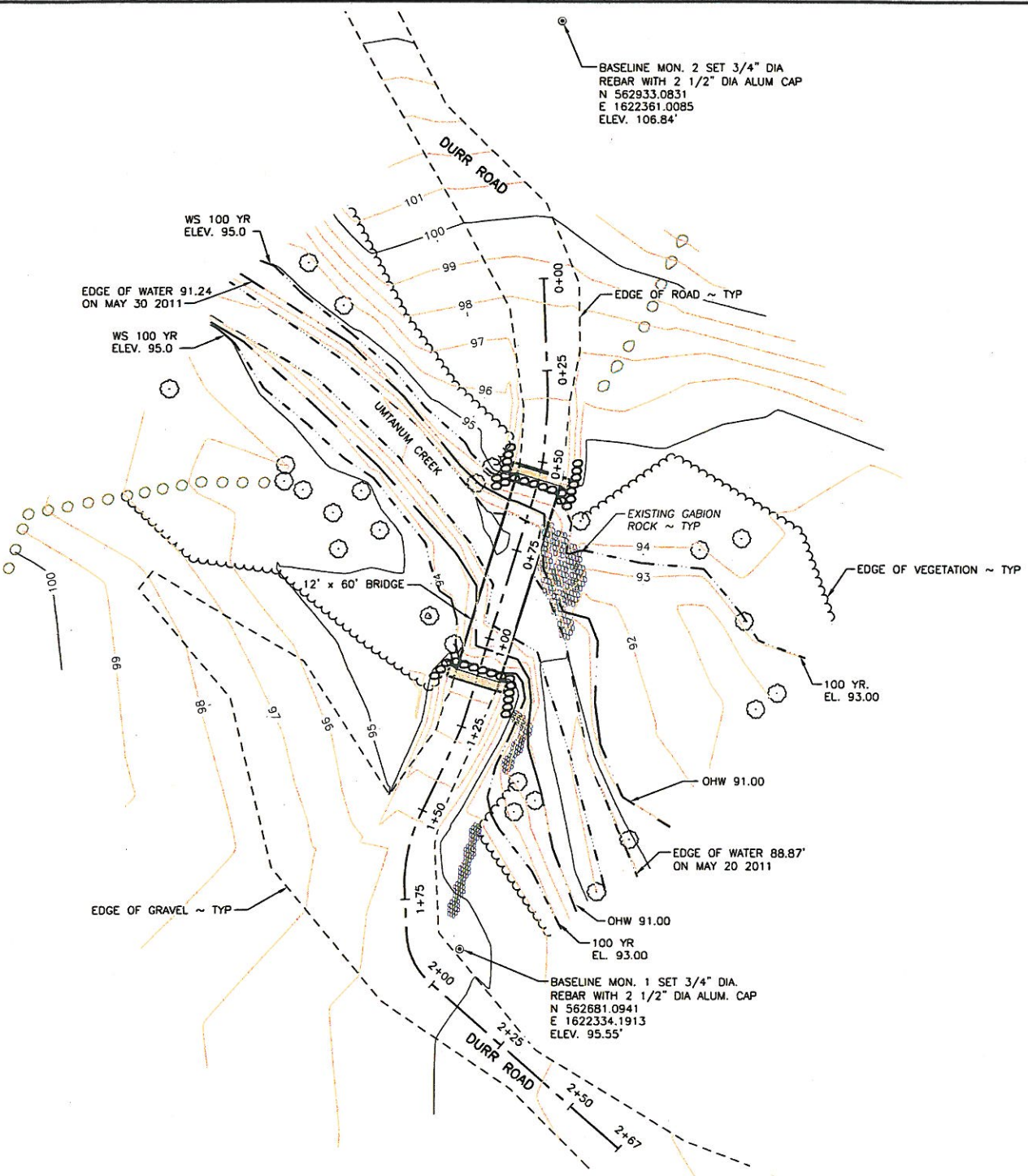

**NEW SITE PLAN**  
SCALE: 1" = 40'

CUT AND FILL DATE	
SITE	TOTALS
CUT ABOVE OHW	2.6cy
FILL ABOVE OHW	213.5cy
NEW ABOVE OHW	210.9cy

**NOTE:**  
ALL DISTURBED SOILS WILL BE MULCHED AND SEEDED WITH WLA APPROVED NATURE GRASS SEED MIX.

REFERENCE NO. \_\_\_\_\_  
 APPLICANT:  
 WASHINGTON DEPT. of FISH & WILDLIFE  
**WENAS WILDLIFE AREA**  
 WENAS ROAD RENOVATION DURR ROAD  
 NEW SITE PLAN

AT: \_\_\_\_\_, WASHINGTON  
 DATE: 7-23-2012 SHEET 7 OF 9

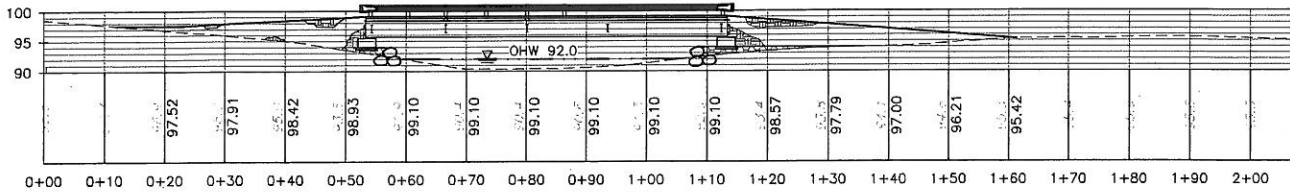

**NEW ROAD PROFILE**  
SCALE: 1" = 30'

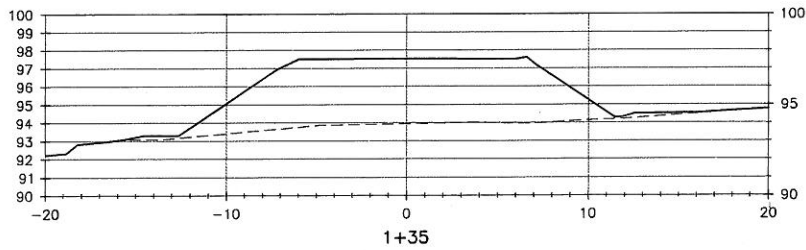
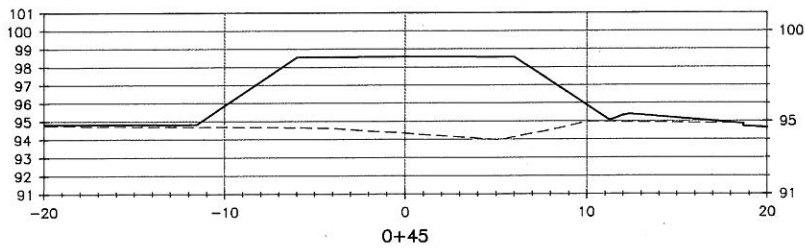

**NEW ROAD SECTIONS**  
SCALE: 1" = 10'

REFERENCE NO. _____
APPLICANT: WASHINGTON DEPT. of FISH & WILDLIFE
<b>WENAS WILDLIFE AREA</b> WENAS ROAD RENOVATION DURR ROAD NEW ROAD PROFILE AND SECTIONS
AT: _____, WASHINGTON
DATE: 7-23-2012 SHEET 8 OF 9



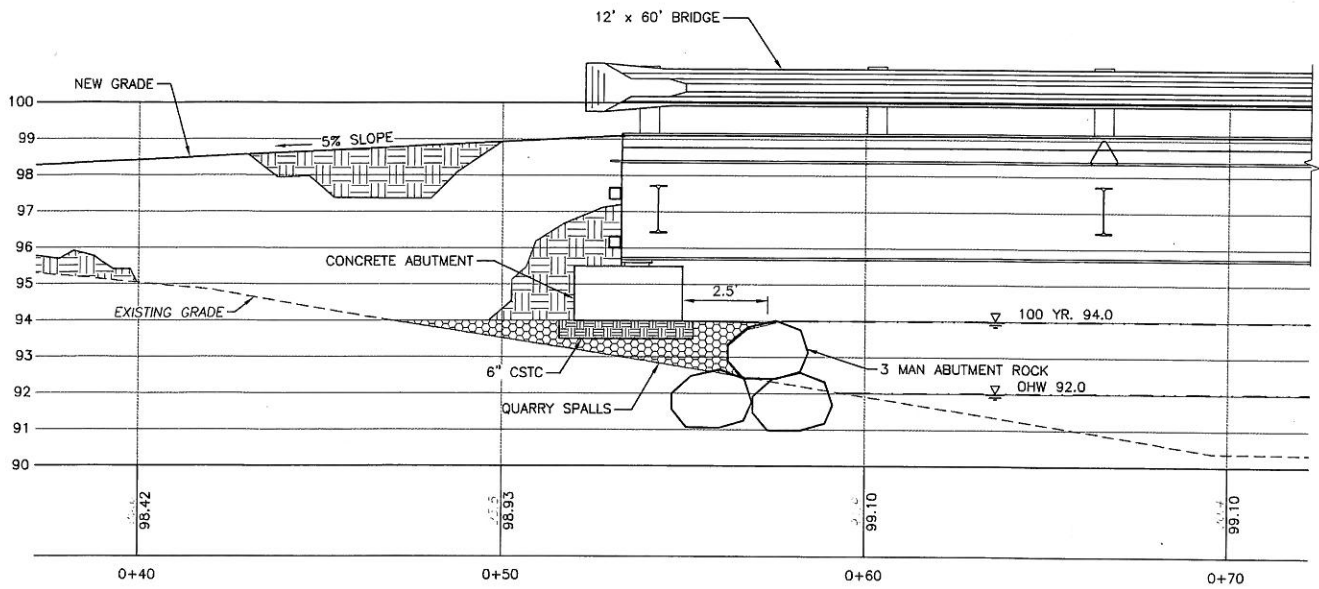

**BRIDGE DETAIL - NORTH ABUTMENT**  
SCALE: 1" = 5'

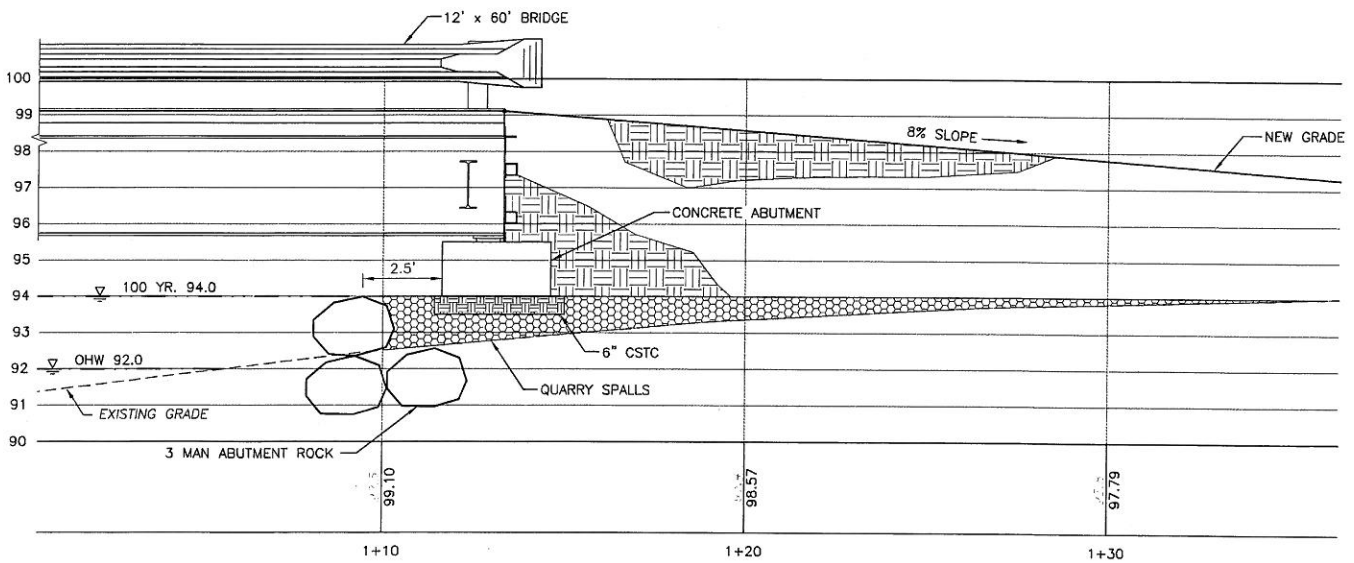

**BRIDGE DETAIL - SOUTH ABUTMENT**  
SCALE: 1" = 5'

REFERENCE NO. _____
APPLICANT: WASHINGTON DEPT. of FISH & WILDLIFE
WENAS WILDLIFE AREA WENAS ROAD RENOVATION DURR ROAD BRIDGE DETAIL
AT: _____, WASHINGTON
DATE: 7-23-2012 SHEET 9 OF 9

