

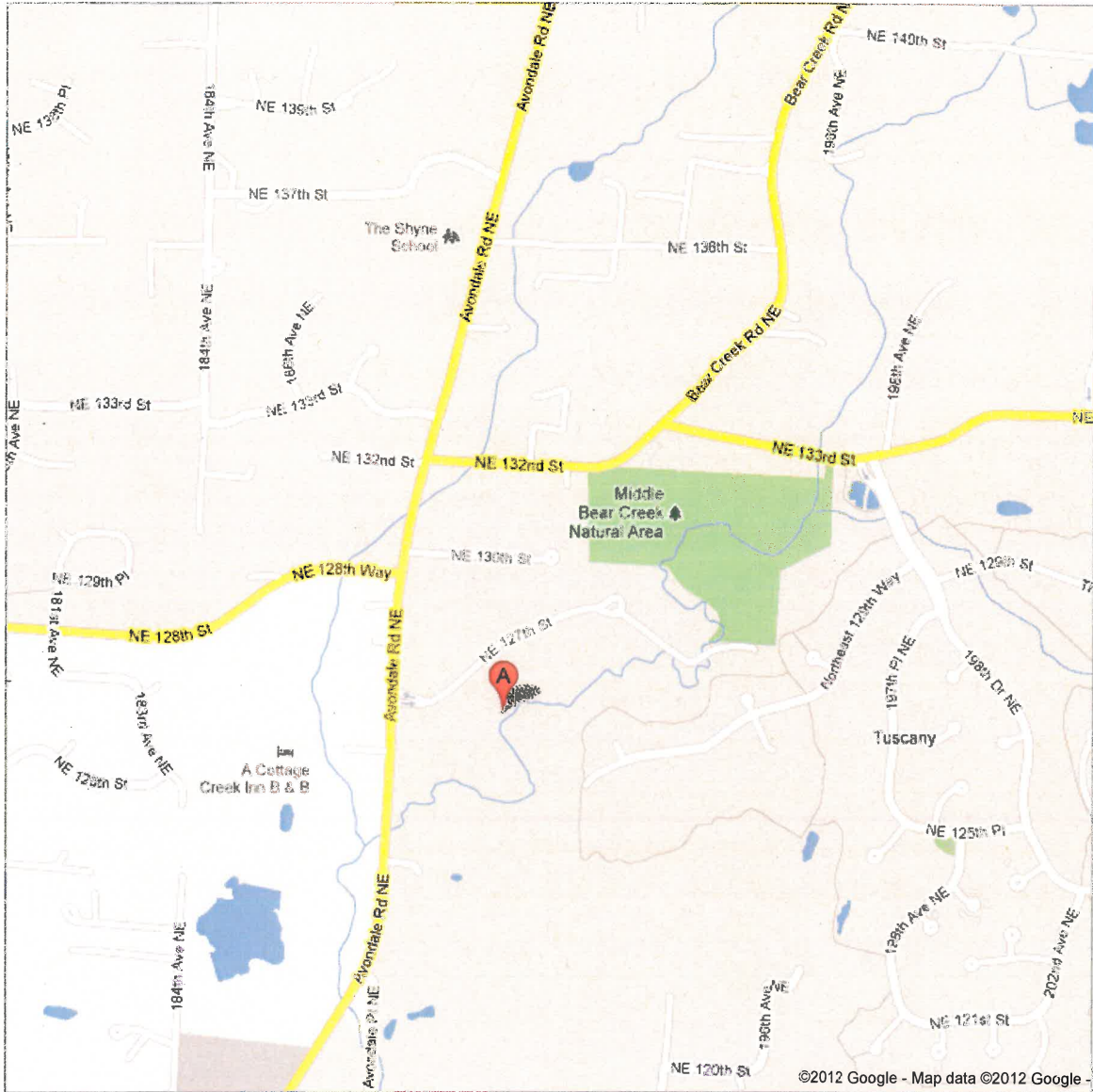

Address **18923 NE 127th St**
Redmond, WA 98052

Get Google Maps on your phone
Text the word "GMAPS" to 466453

iMAP



© 2008 King County

0 162ft

The information included on this map has been compiled by King County staff from a variety of sources and is subject to change without notice. King County makes no representations or warranties, express or implied, as to accuracy, completeness, timeliness, or rights to the use of such information. This document is not intended for use as a survey product. King County shall not be liable for any general, special, indirect, incidental, or consequential damages including, but not limited to, lost revenues or lost profits resulting from the use or misuse of the information contained on this map. Any sale of this map or information on this map is prohibited except by written permission of King County.

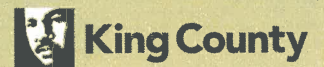

iMAP

Legend

 County Boundary	 Fee simple ownership	 R-24 - Residential, 24 DU per acre
 Mountain Peaks	 Open Space	 R-48 - Residential, 48 DU per acre
 Contours (5ft dark)	 Easement	 NB - Neighborhood Business
 100; 500; 1000	 Right of Way	 CB - Community Business
 Other	 Tax Title	 RB - Regional Business
 Public Land Survey Townships	 Parcels	 O - Office
 Public Land Survey Sections	 Parks	 I - Industrial
 Kroll Map Page	 Unincorporated KC Zoning	 Other
 Highways	 A-10 - Agricultural, one DU per 10 acres	 2007 Color Aerial Photos (6in)
 Forest Production District Boundary	 A-35 - Agricultural, one DU per 35 acres	 2007 Color Aerial Photos (12in)
 Agricultural Production District Boundary	 F - Forest	 Shaded Relief
 Urban Growth Area Line	 M - Mineral	
 Incorporated Area	 RA-2.5 - Rural Area, one DU per 5 acres	
 Streets	 RA-5 - Rural Area, one DU per 5 acres	
 Highway	 RA-10 - Rural Area, one DU per 10 acres	
 Arterials	 UR - Urban Reserve, one DU per 5 acres	
 Local	 R-1 - Residential, one DU per acre	
 Lakes and Large Rivers	 R-4 - Residential, 4 DU per acre	
 Streams	 R-6 - Residential, 6 DU per acre	
 Tribal Lands	 R-8 - Residential, 8 DU per acre	
	 R-12 - Residential, 12 DU per acre	
	 R-18 - Residential, 18 DU per acre	
	(cont)	

The information included on this map has been compiled by King County staff from a variety of sources and is subject to change without notice. King County makes no representations or warranties, express or implied, as to accuracy, completeness, timeliness, or rights to the use of such information. This document is not intended for use as a survey product. King County shall not be liable for any general, special, indirect, incidental, or consequential damages including, but not limited to, lost revenues or lost profits resulting from the use or misuse of the information contained on this map. Any sale of this map or information on this map is prohibited except by written permission of King County.

Date: 9/17/2012 Source: King County iMAP - Property Information (<http://www.metrokc.gov/GIS/iMAP>)

