

PARCEL# 133036410025
 PARCEL SIZE: 47.69 ACRE

PORTION OF: SEC 36 T30N R13W

ENG. PROJECT NO. CM:H32:12-2

REFERENCE NUMBER:
 APPLICANT:
 WASHINGTON DEPT. of FISH & WILDLIFE
 600 CAPITOL WAY N.
 OLYMPIA, WA 98501-1091

PROJECT LOCATION (ADDRESS):
 SOL DUC HATCHERY
 1423 PAVEL ROAD
 BEAVER, WA 98305

PROPOSED PROJECT:
 HATCHERY REDEVELOPEMENT

ADJACENT PROPERTY OWNER:
 1. DNR

LAT/LONG: 48° 03' 17"N/124° 18' 21"W
 DATUM: NAD 83, NAVD 88
 SHEET 1 OF 7 DATE:

IN: SOL DUC RIVER
 NEAR/AT: FORKS, WA
 COUNTY: CALLAM
 STATE: WA

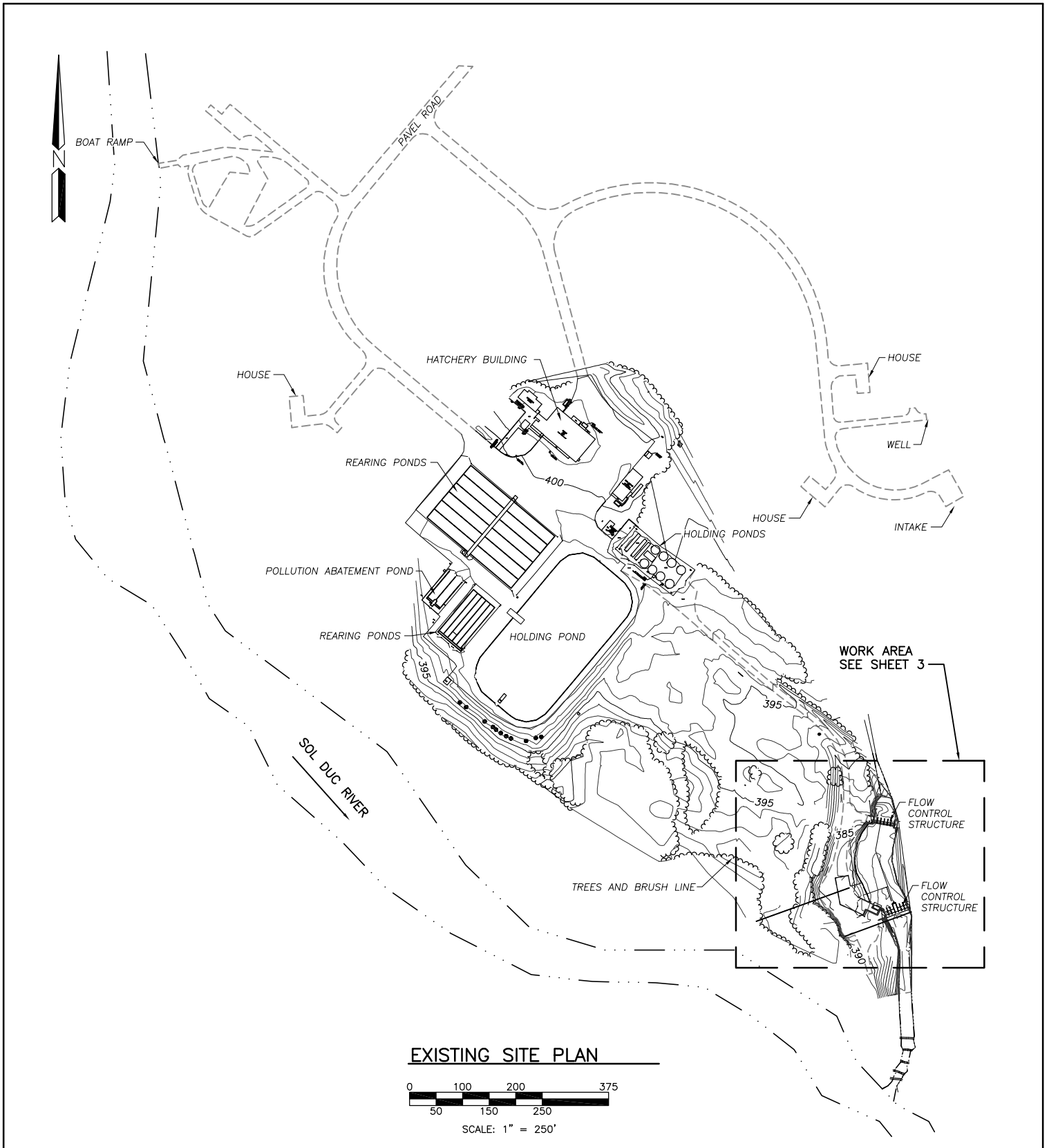

EXISTING SITE PLAN

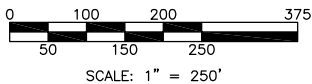

REFERENCE NUMBER:
 APPLICANT NAME:
 WASHINGTON DEPT. of FISH & WILDLIFE
 PROPOSED PROJECT:
 HATCHERY REDEVELOPMENT
 LOCATION: SOL DUC HATCHERY
 SHEET 2 OF 7 DATE:

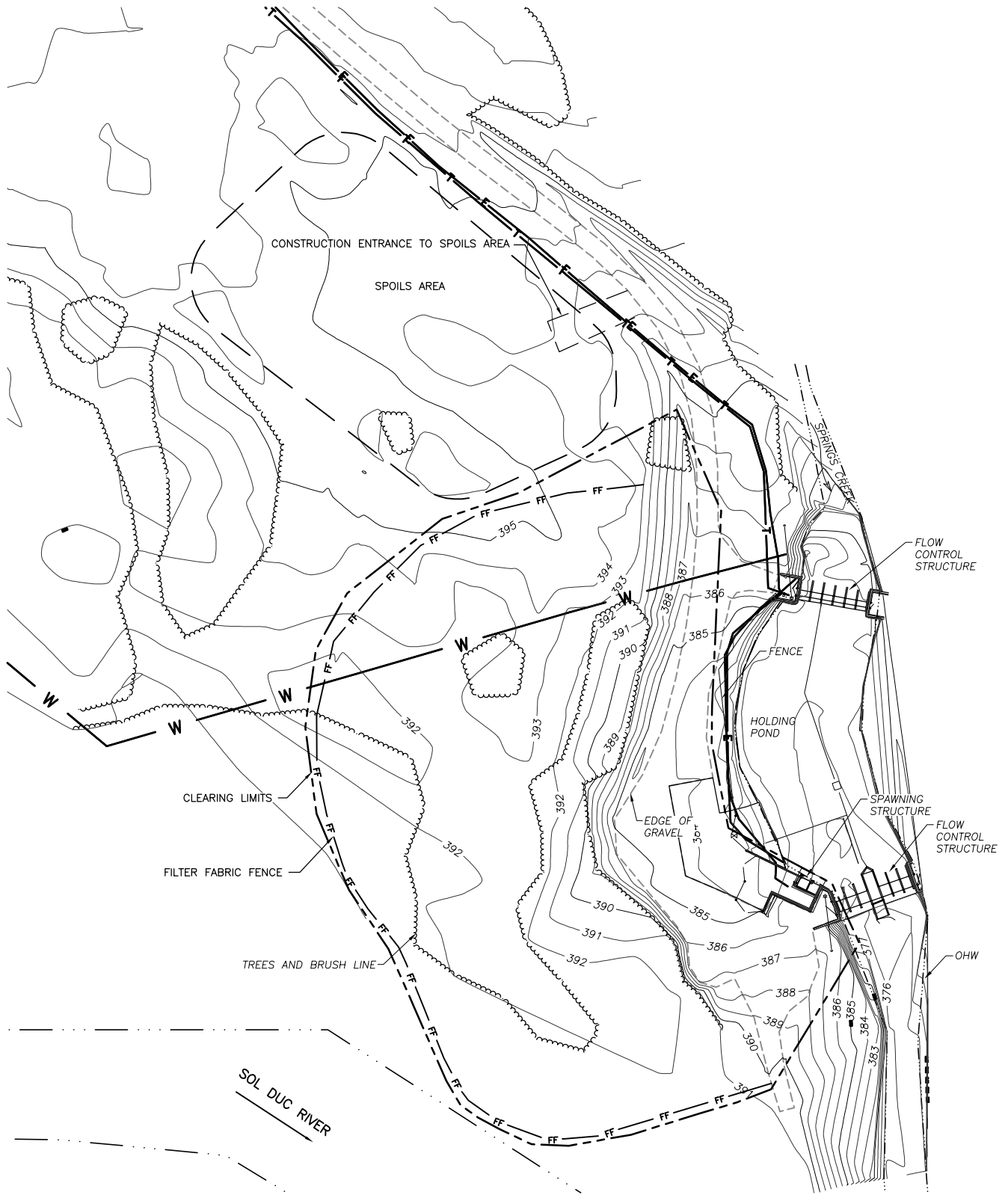

EXISTING WORK SITE

SCALE: 1" = 40'



SCALE: 1" = 40'

NOTE:

GRUB AND CLEAR SPOILS AREA BEFORE DUMPING OCCURS.
GRADE AND SEED SPOILS AREA AFTER HAUL-OFF

REFERENCE NUMBER:

APPLICANT NAME:

WASHINGTON DEPT. of FISH & WILDLIFE

PROPOSED PROJECT:

HATCHERY REDEVELOPMENT

LOCATION: SOL DUC HATCHERY

SHEET 3 OF 7 DATE:

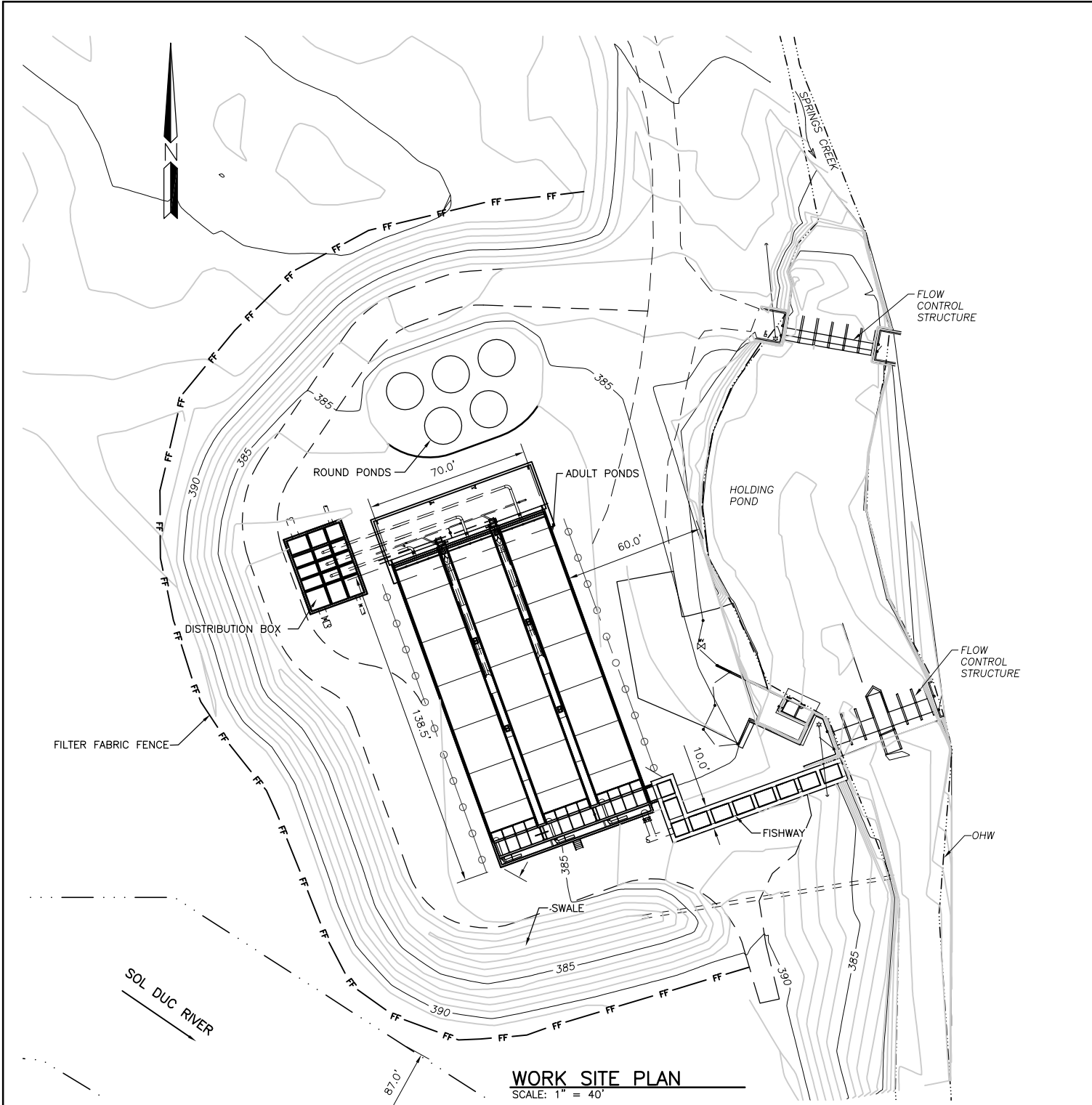

WORK SITE PLAN
SCALE: 1" = 40'

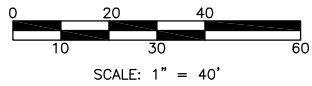

CUT AND FILL DATA	
SITE	TOTALS
CUT ABOVE OHW	14,762cy
CUT BELOW OHW	< 1cy
FILL ABOVE OHW	3,442cy
NET BELOW OHW	< 1cy CUT
NET ABOVE OHW	11,320cy CUT
TOTAL IMPERVIOUS	12,721sf

REFERENCE NUMBER:
 APPLICANT NAME:
 WASHINGTON DEPT. of FISH & WILDLIFE
 PROPOSED PROJECT:
 HATCHERY REDEVELOPMENT
 LOCATION: SOL DUC HATCHERY
 SHEET 4 OF 7 DATE:

EROSION & SEDIMENT CONTROL (TESC) NOTES:

1. THE IMPLEMENTATION OF TESC PLANS AND THE CONSTRUCTION, MAINTENANCE, REPLACEMENT AND UPGRADING OF TESC FACILITIES IS THE RESPONSIBILITY OF THE CONTRACTOR UNTIL ALL CONSTRUCTION IS APPROVED.
2. THE TESC FACILITIES SHOWN ON THIS PLAN MUST BE CONSTRUCTED IN CONJUNCTION WITH ALL CONSTRUCTION ACTIVITIES, AND IN SUCH A MANNER AS TO ENSURE THAT SEDIMENT LADEN WATER DOES NOT ENTER THE SPRINGS CREEK AND SOL DUC RIVER OR ADJACENT PROPERTIES.
3. THE CONTRACTOR SHALL PROVIDE AND MAINTAIN TEMPORARY SEDIMENT COLLECTION FACILITIES TO ENSURE THAT SEDIMENT-LADEN WATER DOES NOT ENTER THE NATURAL OR PUBLIC DRAINAGE SYSTEM. AS CONSTRUCTION PROGRESSES AND UNEXPECTED (SEASONAL) CONDITIONS DICTATE, MORE SILTATION WATER QUALITY FACILITIES MAY BE REQUIRED TO ENSURE COMPLETE SILTATION CONTROL OF THE PROJECT. THEREFORE, DURING THE COURSE OF CONSTRUCTION IT SHALL BE THE OBLIGATION AND RESPONSIBILITY IF THE CONTRACTOR TO ADDRESS ANY NEW CONDITIONS THAT MAY BE CREATED BY ITS ACTIVITIES AND TO PROVIDE ADDITIONAL FACILITIES AND BMP'S THAT MAY BE NEEDED TO PROTECT ADJACENT PROPERTIES.
4. THE TESC FACILITIES SHOWN IN THIS PLAN ARE THE MINIMUM REQUIREMENTS FOR ANTICIPATED SITE CONDITIONS. DURING THE CONSTRUCTION PERIOD, THESE TESC FACILITIES SHALL BE UPGRADED (E.G. ADDITIONAL SUMPS, ADDITION OF DITCHES AND SILT FENCES, ETC.) AS NEEDED FOR UNEXPECTED STORM EVENTS.
5. THE TESC FACILITIES SHALL BE INSPECTED DAILY BY THE CONTRACTOR AND MAINTAINED AS NECESSARY OR AS DIRECTED BY THE OWNER'S REPRESENTATIVE TO ENSURE THEIR CONTINUED FUNCTIONING AND EFFECTIVENESS.
6. IF SEDIMENT IS TRANSPORTED ONTO ANY ROADWAY SURFACE, IT SHALL BE CLEANED THOROUGHLY AT THE END OF THAT DAY. SEDIMENT SHALL BE REMOVED FROM ROADS BY A METHOD AS APPROVED BY THE OWNER'S REPRESENTATIVE AND BE TRANSPORTED TO A CONTROLLED SEDIMENT DISPOSAL AREA. STREET WASHING SHALL BE ALLOWED ONLY AFTER SEDIMENT IS REMOVED, AS REQUIRED BY THE ENGINEER.
7. ANY AREAS OF EXPOSED SOILS THAT WILL NOT BE DISTURBED FOR TWO DAYS DURING THE WET SEASON, OR SEVEN DAYS DURING THE DRY SEASON, SHALL BE IMMEDIATELY STABILIZED WITH A PLASTIC COVERING.
8. THE TESC FACILITIES SHALL BE INSPECTED AND MAINTAINED A MINIMUM OF ONCE A MONTH, OR WITHIN 48 HOURS FOLLOWING A STORM EVENT.
9. REFER TO "BEST MANAGEMENT PRACTICES" IN THE STORM WATER MANAGEMENT MANUAL FOR WESTERN WASHINGTON CONSTRUCTION, VOLUME II, AND ALL OTHER APPLICABLE REGULATIONS TO ACCOMPLISH CONTROL OF POTENTIALLY HAZARDOUS POLLUTANTS AND SEDIMENTS.
10. THE CONTRACTOR SHALL NOT FLUSH CONCRETE BY-PRODUCTS FROM CONCRETE TRUCKS NEAR OR INTO THE STORM DRAINAGE SYSTEM.
11. STABILIZED CONSTRUCTION ENTRANCES AND TIRE WASH PADS SHALL BE DESIGNED AND PROVIDED BY THE CONTRACTOR AS REQUIRED AND INSTALLED AT THE BEGINNING OF CONSTRUCTION AND MAINTAINED TO MEET ALL APPLICABLE STANDARDS FOR THE DURATION OF THE PROJECT. ADDITIONAL MEASURES MAY BE REQUIRED TO INSURE THAT ALL OFFSITE AREAS ARE KEPT CLEAN FOR THE DURATION OF THE PROJECT.
12. WHERE STRAW MULCH FOR TEMPORARY EROSION CONTROL IS REQUIRED, IT SHALL BE APPLIED AT A MINIMUM THICKNESS OF TWO INCHES.
13. THE CONTRACTOR SHALL PROTECT STOCK PILE AREAS FROM RELEASE OF ERODED SEDIMENT OR TURBID WATER. STOCK PILES SHALL BE COVERED AT ALL TIMES WHILE NOT IN USE TO KEEP THE STORED MATERIAL DRY.
14. ALL DISTURBED AREAS SHALL BE STABILIZED BY ACCEPTABLE METHODS FOR THE PREVENTION OF ONSITE EROSION UPON COMPLETION OF CONSTRUCTION.

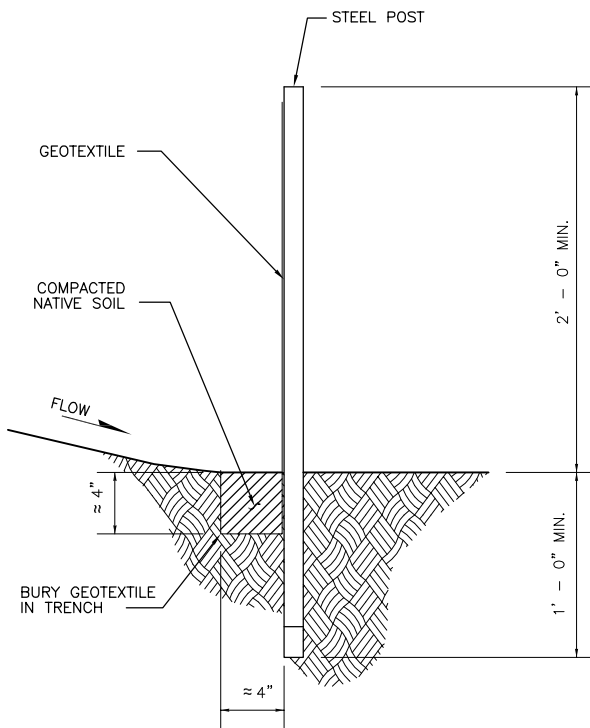

FILTER FABRIC FENCE

NOT TO SCALE

NOTE:

DURING EXCAVATION, MINIMIZE DISTURBING THE GROUND AROUND TRENCH AS MUCH AS IS FEASIBLE AND SMOOTH SURFACE FOLLOWING EXCAVATION TO AVOID CONCENTRATING FLOWS.

REFERENCE NUMBER:

APPLICANT NAME:

WASHINGTON DEPT. of FISH & WILDLIFE

PROPOSED PROJECT:

HATCHERY REDEVELOPEMENT

LOCATION: SOL DUC HATCHERY

SHEET 5 OF 7 DATE:

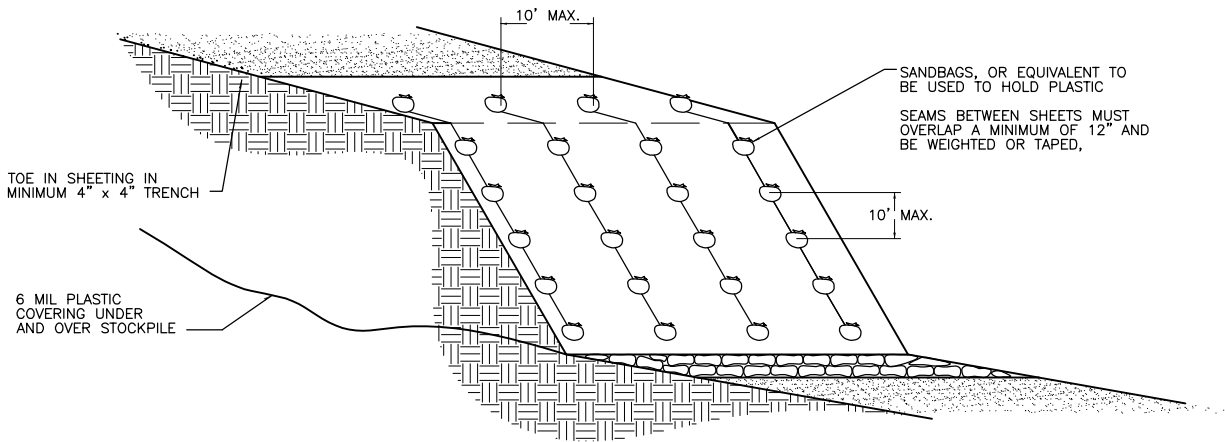

STOCKPILE COVERING DETAIL

NOT TO SCALE

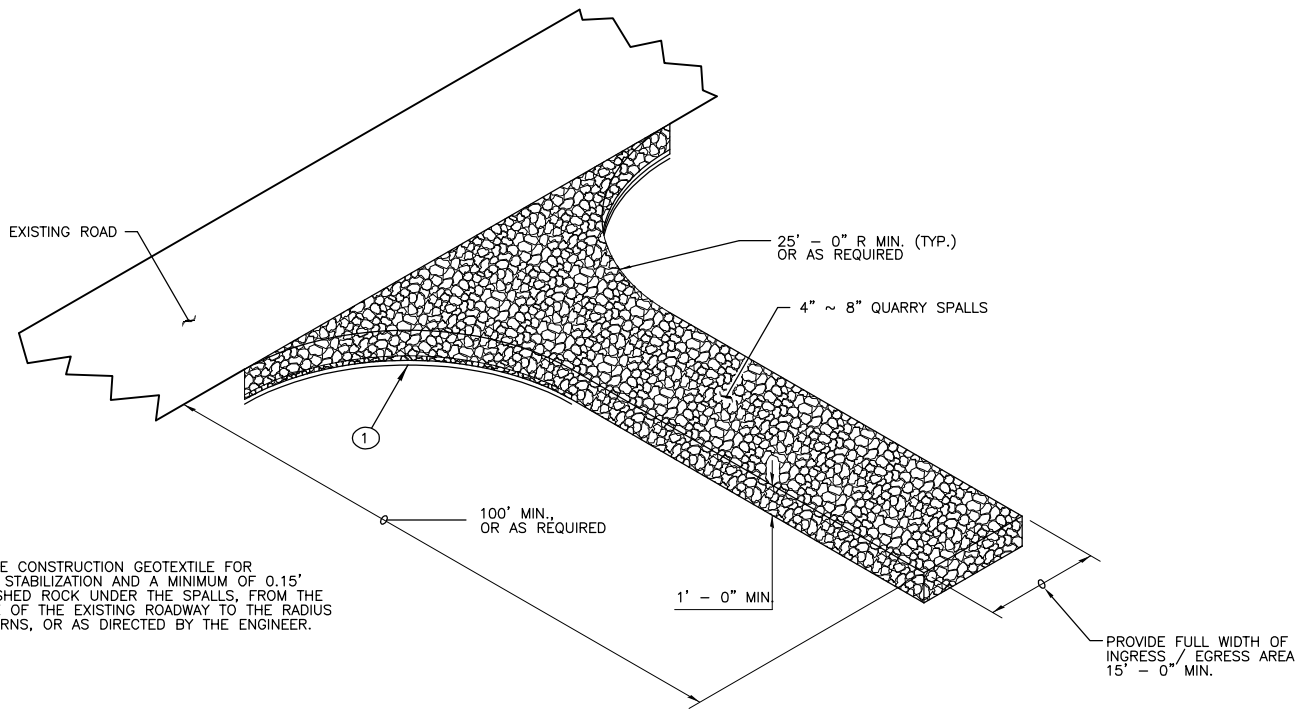

CONSTRUCTION ENTRANCE DETAIL

NOT TO SCALE

NOTE:

THE ENTRANCE SHALL BE MAINTAINED IN A CONDITION WHICH WILL PREVENT TRACKING OR FLOW OF MUD ONTO PUBLIC RIGHT-OF-WAY. THIS MAY REQUIRE PERIODIC TOP DRESSING WITH 2" STONE, AS CONDITIONS DEMAND, AND REPAIR AND/OR CLEAN OUT OF ANY STRUCTURES USED TO TRAP SEDIMENT, ALL MATERIALS SPILLED, DROPPED, WASHED, OR RACKED FROM VEHICLES ONTO ROADWAYS MUST BE REMOVED IMMEDIATELY.

REFERENCE NUMBER:
 APPLICANT NAME:
 WASHINGTON DEPT. of FISH & WILDLIFE
 PROPOSED PROJECT:
 HATCHERY REDEVELOPMENT
 LOCATION: SOL DUC HATCHERY
 SHEET 6 OF 7 DATE:

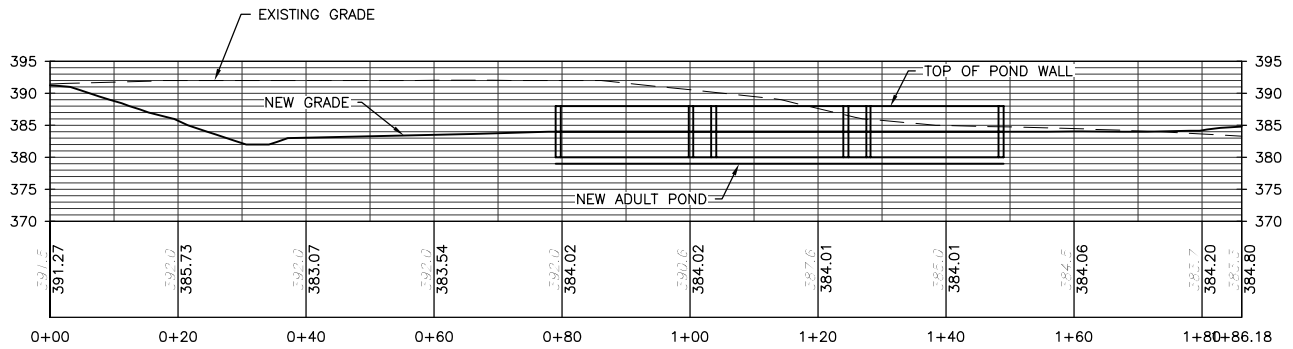

ADULT POND SECTION
SCALE: 1" = 30'

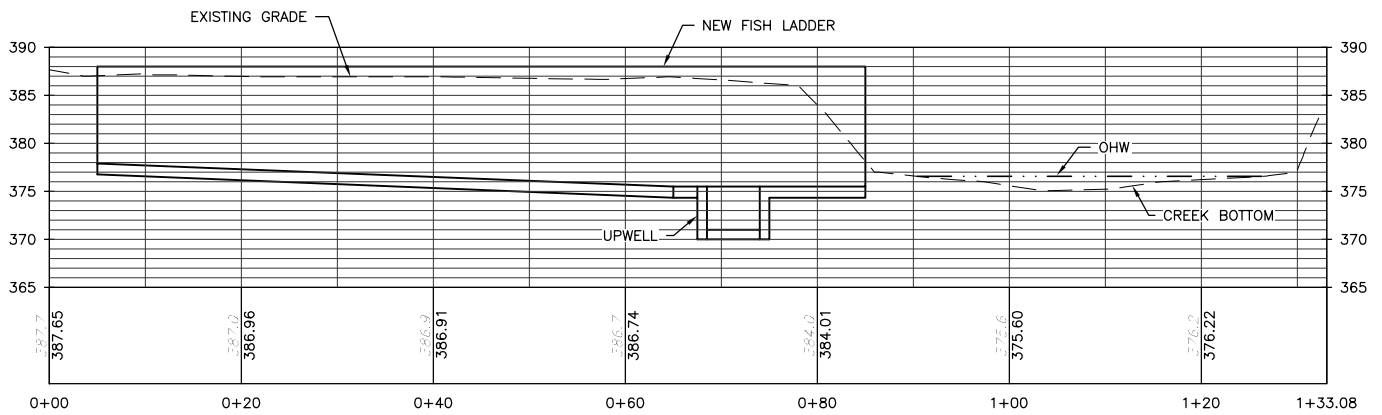

FISH LADDER SECTION
SCALE: 1" = 20'

REFERENCE NUMBER:
 APPLICANT NAME:
 WASHINGTON DEPT. of FISH & WILDLIFE
 PROPOSED PROJECT:
 HATCHERY REDEVELOPMENT
 LOCATION: SOL DUC HATCHERY
 SHEET 7 OF 7 DATE: