

BEGINNERS HOLE  
PROJECT LOCATION

**STATE MAP**  
NOT TO SCALE

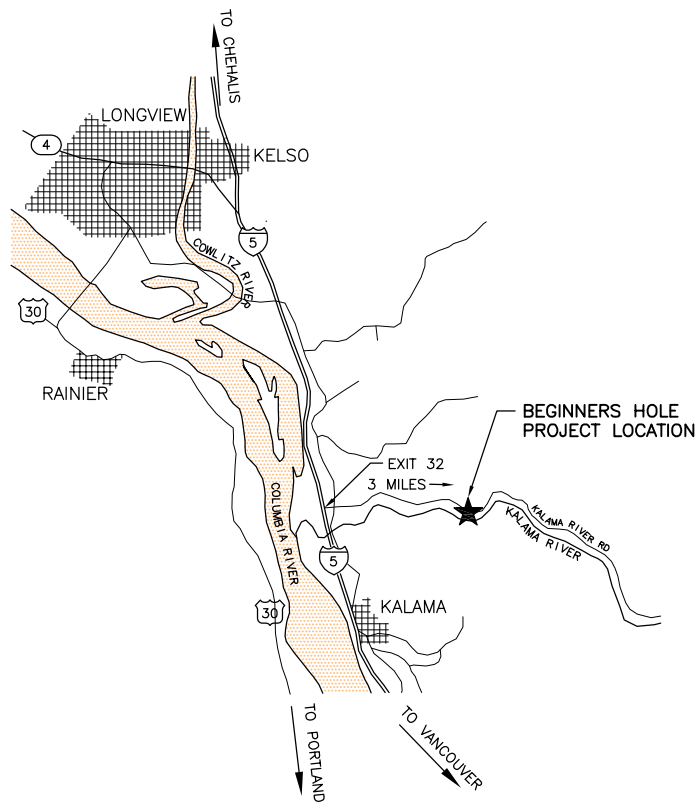

**VICINITY MAP**  
NOT TO SCALE

ENG. PROJECT NO. CZ:A058:18-1

PORTION OF: T7N, R1W, SEC 33

DRAWN BY: N. WHITE

REFERENCE NUMBER:  
APPLICANT:  
WASHINGTON DEPT. of FISH & WILDLIFE  
600 CAPITOL WAY N.  
OLYMPIA, WA 98501-1091

PROJECT LOCATION (ADDRESS):  
BEGINNERS HOLE

PROPOSED PROJECT:  
EROSION CORRECTION

ADJACENT PROPERTY OWNER:

LAT/LONG: 46.04685/-122.80710

IN: KALAMA RIVER  
NEAR/AT: KALAMA  
COUNTY: COWLITZ  
STATE: WA

1.  
2.

DATUM:  
SHEET 1 OF 3 DATE: 3-1-2018

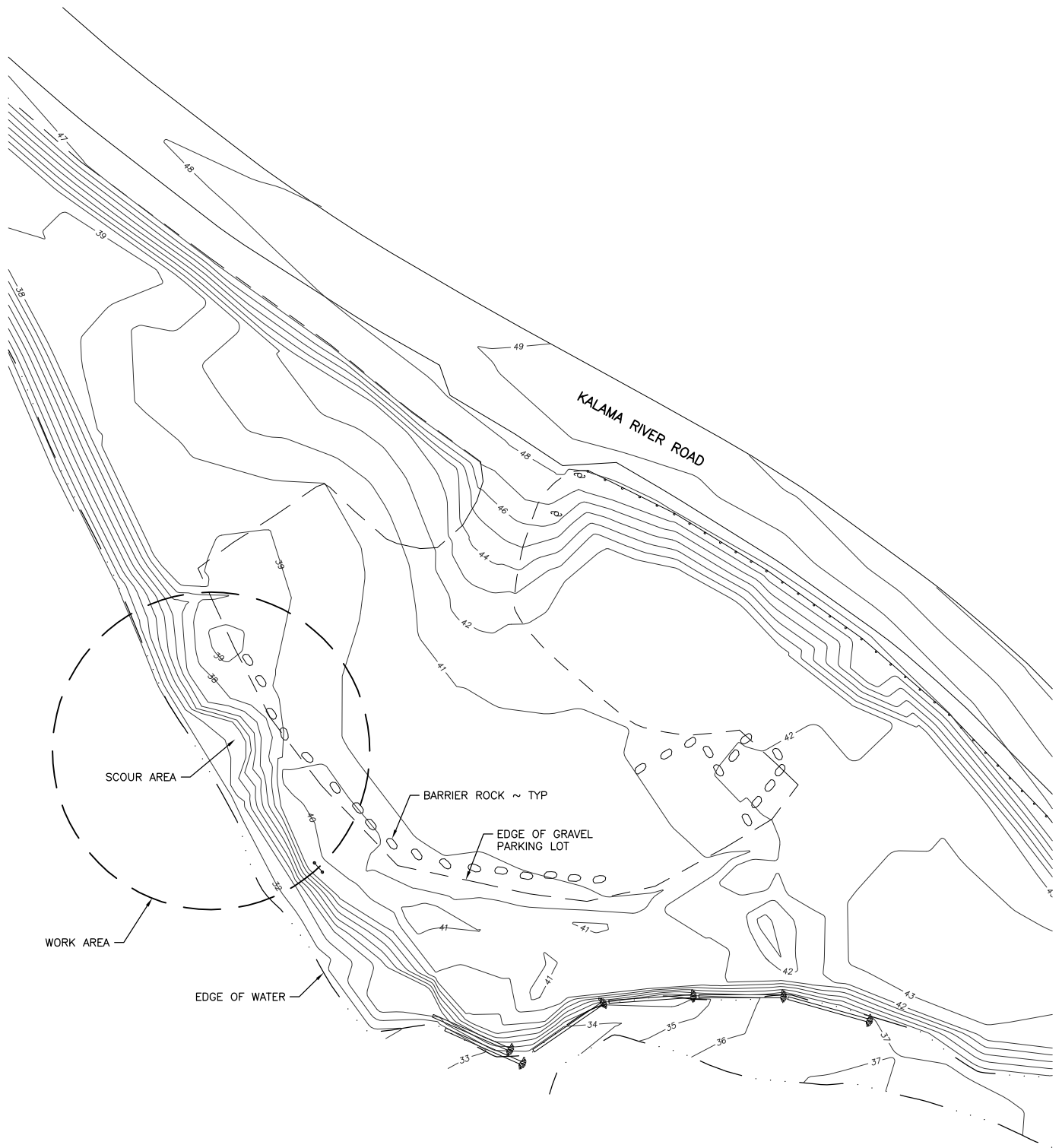

**EXISTING SITE PLAN**

SCALE: 1" = 50'



SCALE: 1" = 50'

REFERENCE NUMBER:  
APPLICANT NAME:  
WASHINGTON DEPT. of FISH & WILDLIFE  
PROPOSED PROJECT:  
EROSION CORRECTION  
LOCATION: BEGINNERS HOLE  
SHEET 2 OF 3 DATE: 3-1-2018

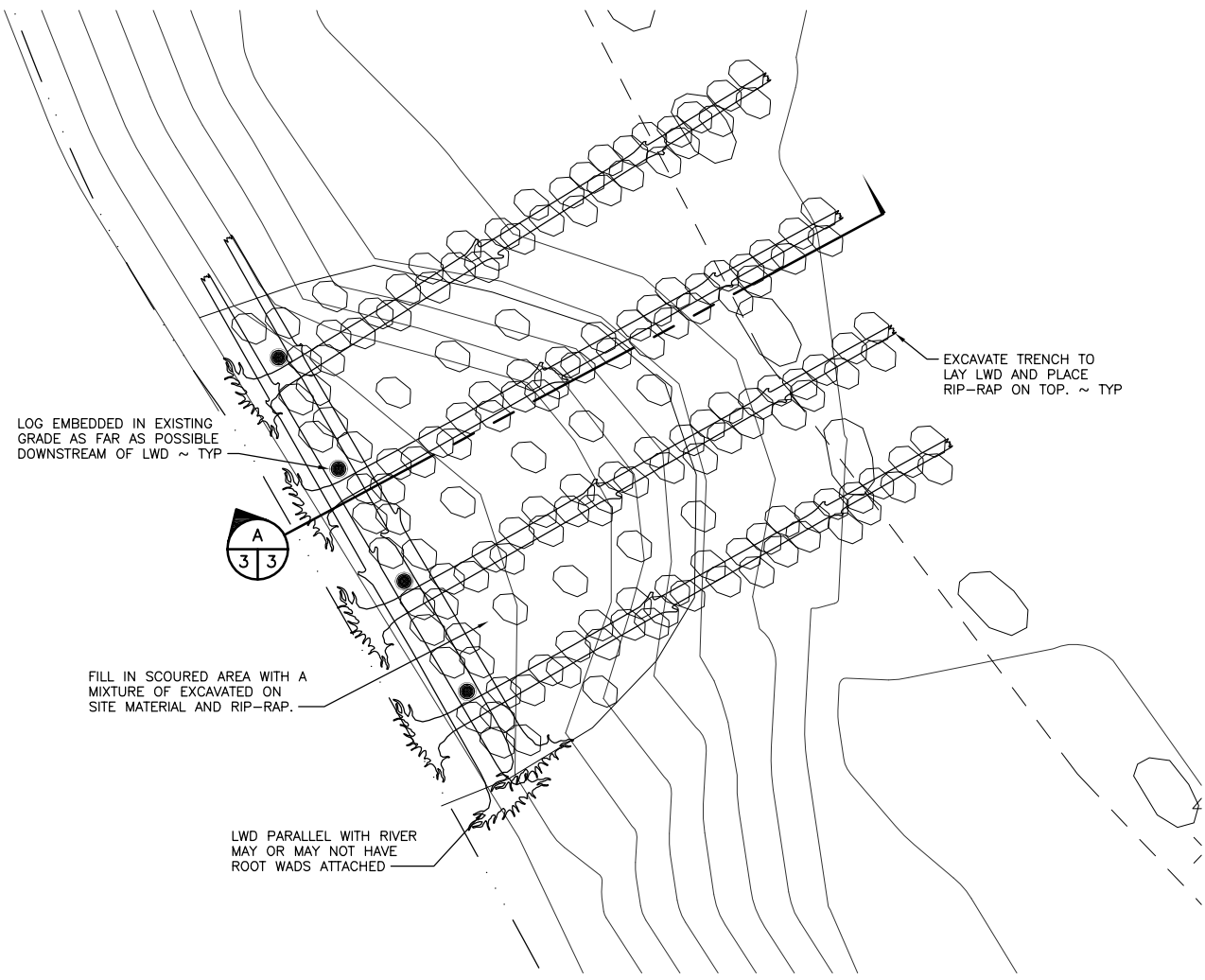

**NEW PLAN VIEW**  
NOT TO SCALE

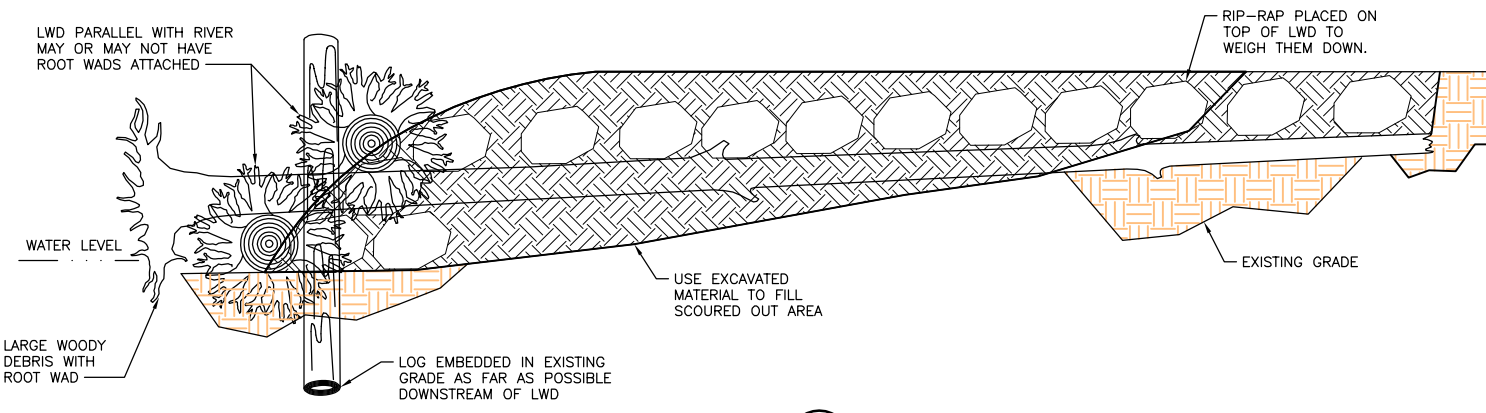

**SECTION**  
NOT TO SCALE

REFERENCE NUMBER:  
 APPLICANT NAME:  
**WASHINGTON DEPT. of FISH & WILDLIFE**  
 PROPOSED PROJECT:  
**ERROSION CORRECTION**  
 LOCATION: **BEGINNERS HOLE**  
 SHEET **3** OF **3** DATE: **3-1-2018**





2018/03/07





BE J2357

2018/03/07