

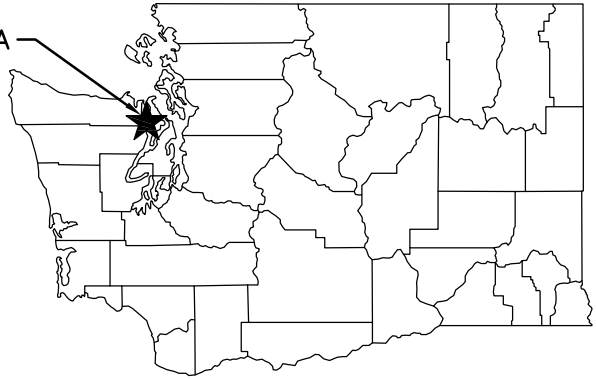

PROJECT AREA

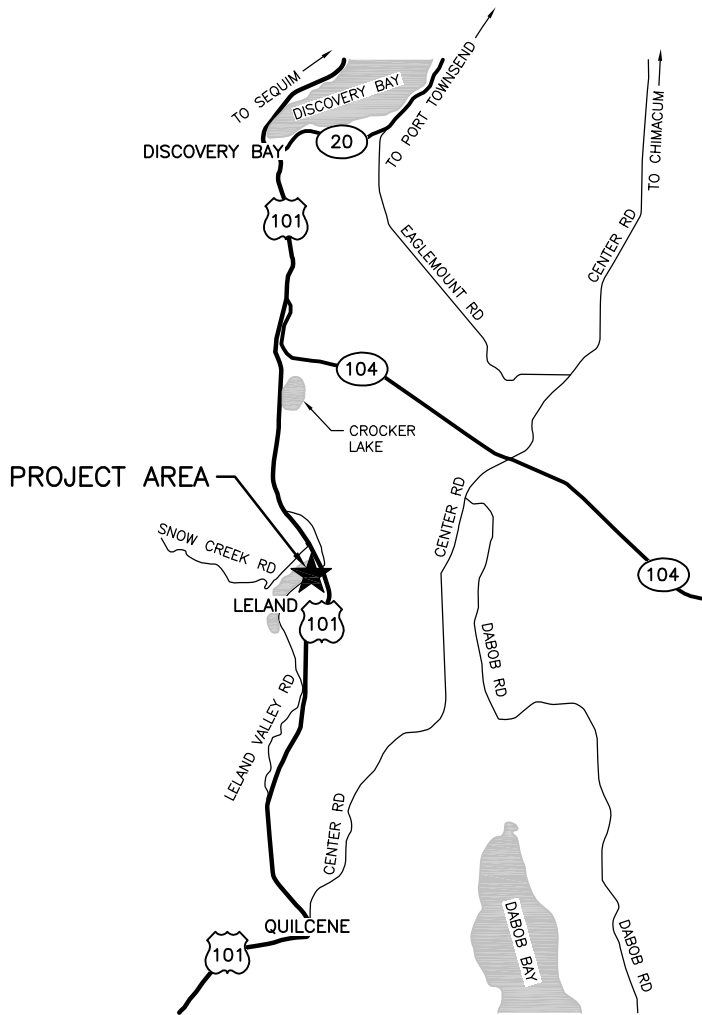

STATE MAP
NOT TO SCALE



VICINITY MAP
NOT TO SCALE

ADDRESS:
165 LELAND VALLEY RD
QUILCENE, WA, 98376

DIRECTIONS:
FROM OLYMPIA TAKE I-5 SOUTH TO EXIT
104 TO HWY 101. GO NORTH THROUGH
SHELTON, CONTINUE ON HWY 101 NORTH.
TURN LEFT ONTO LELAND VALLEY RD.
DESTINATION WILL BE ON THE RIGHT.

ENG. PROJECT NO. JF:A223:18-1

PORTION OF: SEC 24, T 28 N, R 02 W

DRAWN BY: NDB

REFERENCE NUMBER:
 APPLICANT:
 WASHINGTON DEPT. of FISH & WILDLIFE
 600 CAPITOL WAY N.
 OLYMPIA, WA 98501-1091

ADJACENT PROPERTY OWNER:
 1. JEFFERSON COUNTY
 2. BEVERLY J STOLL

PROJECT LOCATION (ADDRESS):
 LELAND LAKE
 165 LELAND VALLEY RD
 QUILCENE, WA 98376

LAT/LONG: N47.898368 / W122.875083
 DATUM: NAVD 88
 SHEET 1 OF 14 DATE: 12/21/2018

PROPOSED PROJECT:
 ACCESS RENOVATION

IN: LELAND LAKE
 NEAR/AT: LELAND
 COUNTY: JEFFERSON
 STATE: WA

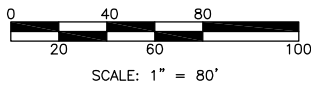
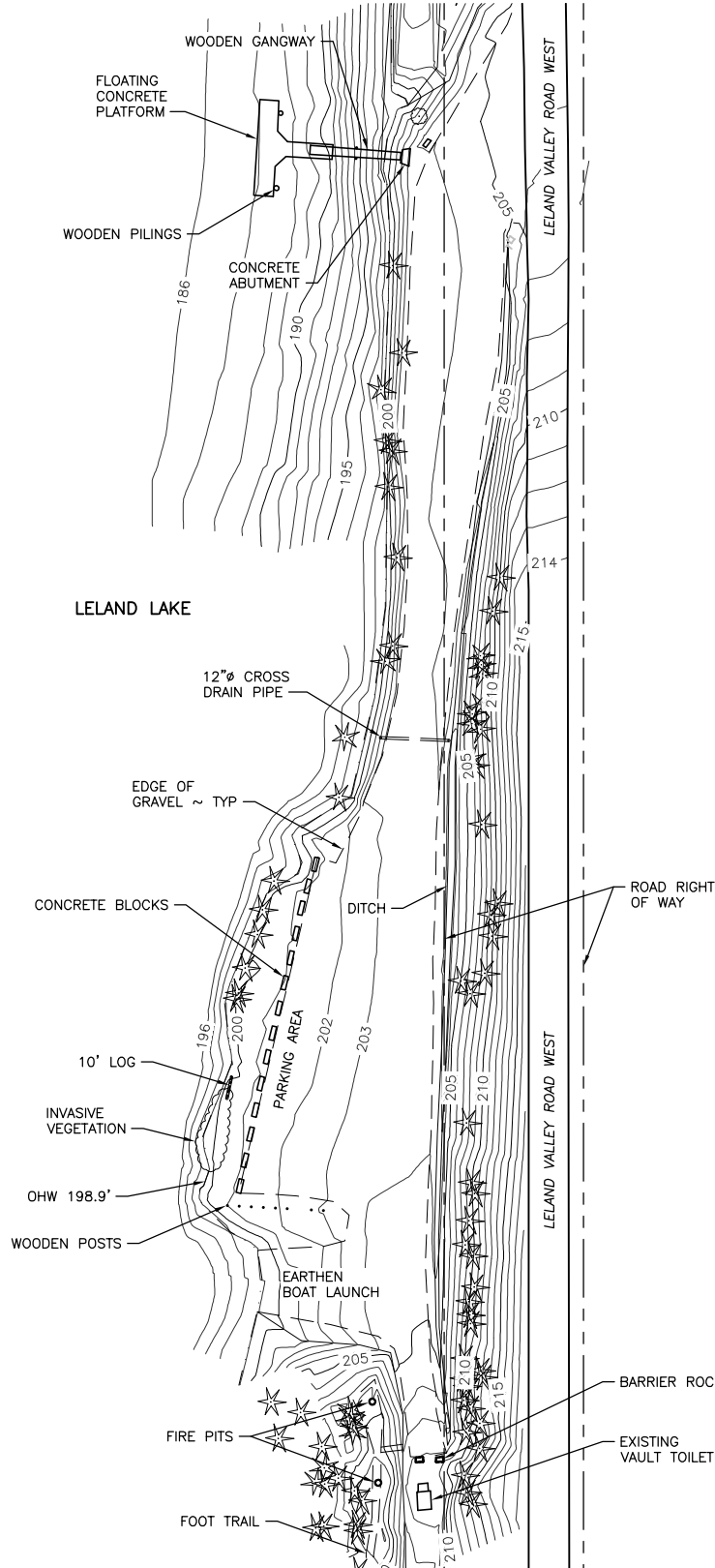
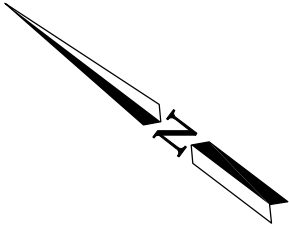

EXISTING SITE

SCALE: 1" = 80'

REFERENCE NUMBER:
 APPLICANT NAME:
 WASHINGTON DEPT. of FISH & WILDLIFE
 PROPOSED PROJECT:
 ACCESS RENOVATION
 LOCATION: LELAND LAKE
 SHEET 2 OF 14 DATE: 12/21/2018

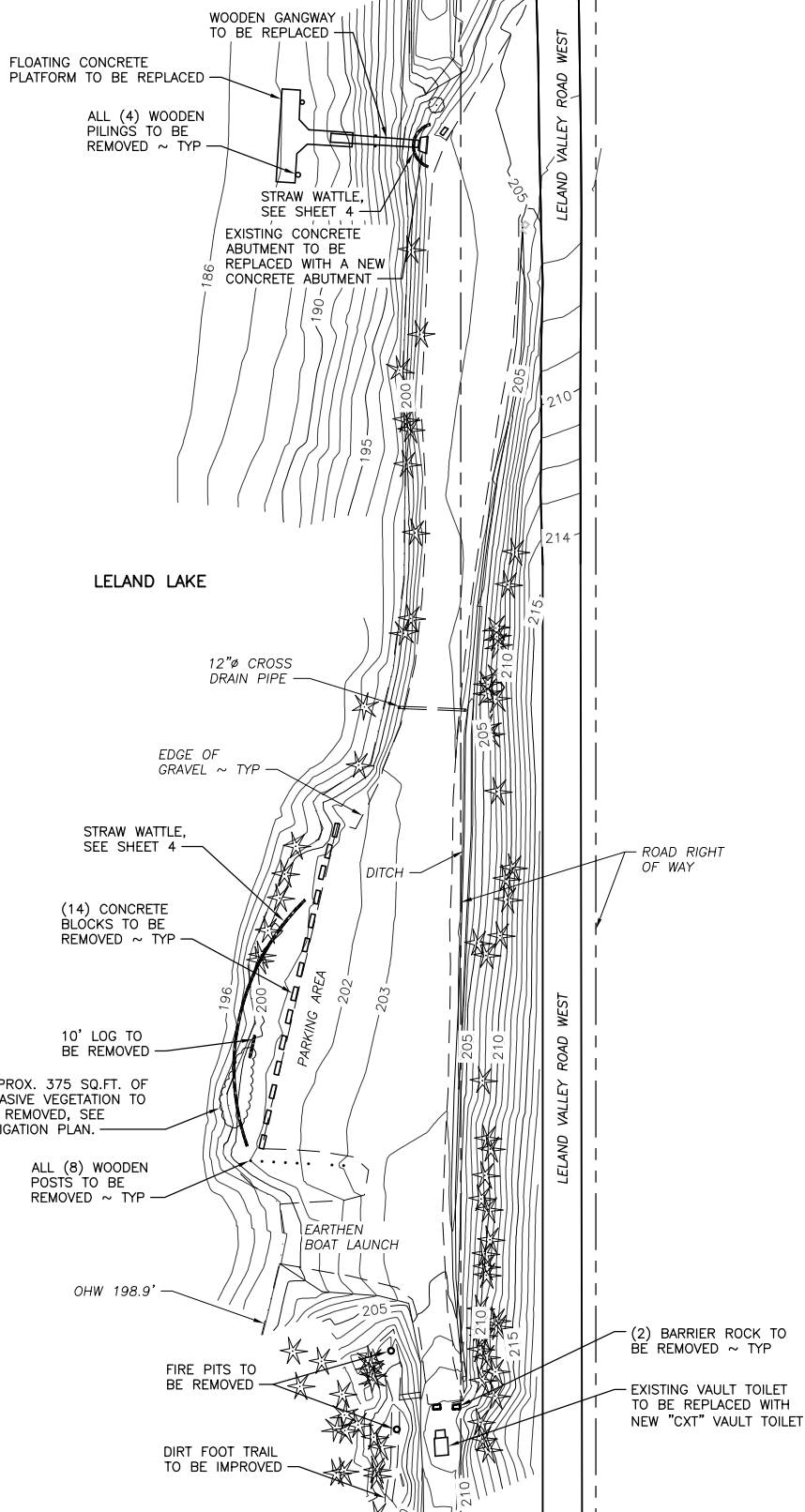
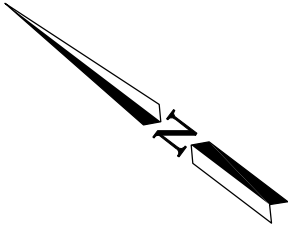

LELAND LAKE

LELAND VALLEY ROAD WEST

LELAND VALLEY ROAD WEST

**EROSION CONTROL
& DEMOLITION PLAN**

SCALE: 1" = 80'

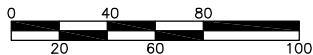

SCALE: 1" = 80'

REFERENCE NUMBER:

APPLICANT NAME:

WASHINGTON DEPT. of FISH & WILDLIFE

PROPOSED PROJECT:

ACCESS RENOVATION

LOCATION: LELAND LAKE

SHEET 3 OF 14

DATE: 12/21/2018

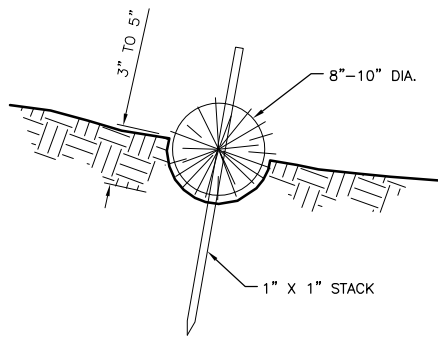

STRAW WATTLE DETAIL

NOT TO SCALE

CONSTRUCTION SPECIFICATIONS:

1. PREPARE THE SLOPE BEFORE THE WATTLING PROCEDURE IS STARTED.
2. SHALLOW GULLIES SHOULD BE SMOOTHED AS WORK PROGRESSES.
3. DIG SMALL TRENCHES ACROSS THE SLOPE ON CONTOUR, TO PLACE ROLLS IN. THE TRENCH SHOULD BE DEEP ENOUGH TO ACCOMMODATE HALF THE THICKNESS OF THE ROLL. WHEN THE SOIL IS LOOSE AND UNCOMPACTED, THE TRENCH SHOULD BE DEEP ENOUGH TO BURY THE ROLL 2/3 OF ITS THICKNESS BECAUSE THE GROUND WILL SETTLE.
4. IT IS CRITICAL THAT ROLLS ARE INSTALLED PERPENDICULAR TO WATER MOVEMENT, PARALLEL TO THE SLOPE CONTOUR.
5. START BUILDING TRENCHES AND INSTALL ROLLS FROM THE BOTTOM OF THE SLOPE AND WORK UP.
6. CONSTRUCT TRENCHES AT CONTOUR INTERVALS OF 3-12 FEET APART DEPENDING ON STEEPNESS OF SLOPE. THE STEEPER THE SLOPE, THE CLOSER TOGETHER THE TRENCHES. 1:1=10' 2:1=20' 3:1=30' 4:1=40'
7. LAY THE ROLL ALONG THE TRENCHES FITTING IT SNUGLY AGAINST THE SOIL. MAKE SURE NO GAPS EXIST BETWEEN THE SOIL AND THE STRAW WATTLE.
8. USE A STRAIGHT BAR TO DRIVE HOLES THROUGH THE WATTLE AND INTO THE SOIL FOR THE WILLOW OR WOODEN STAKES.
9. DRIVE THE STAKE THROUGH PREPARED HOLE INTO SOIL. LEAVE ONLY 1 OR 2 INCHES OF STAKE EXPOSED ABOVE ROLL.
10. IF USING WILLOW STAKES REFER TO LIVE STAKING BEST MANAGEMENT PRACTICES.
11. INSTALL STAKES AT LEAST EVERY 4 FEET APART THROUGH THE WATTLE. ADDITIONAL STAKES MAY BE DRIVEN ON THE DOWNSLOPE SIDE OF THE TRENCHES ON HIGHLY EROSION OR VERY STEEP SLOPES.
12. INSPECT THE STRAW ROLLS AND THE SLOPES AFTER SIGNIFICANT STORMS. MAKE SURE THE ROLLS ARE IN CONTACT WITH THE SOIL.
13. REPAIR ANY RILLS OR GULLYS PROMPTLY.
14. RESEED OR REPLANT VEGETATION IF NECESSARY UNTIL THE SLOPE IS STABILIZED.

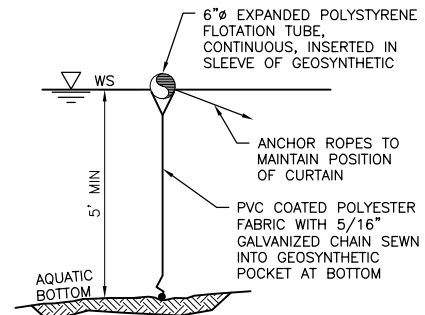

TURBIDITY CURTAIN

NOT TO SCALE

NOTES:

1. FABRIC IS 22 OZ/YD²

ROOT-WAD TO BE PLACED ALONG EDGE OF LAKE AT OHW, DO NOT ANCHOR.

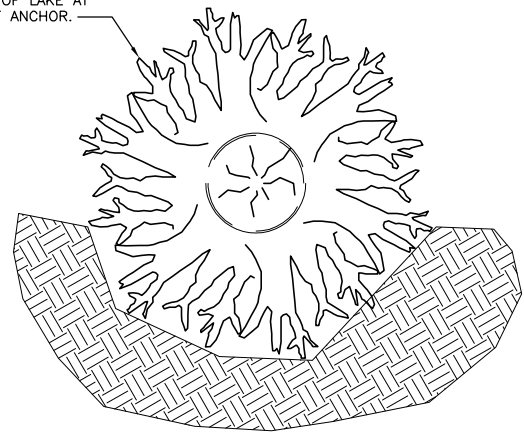

ROOT-WAD DETAIL

NOT TO SCALE

NOTES:

1. ROOTWAD =/+ 30" WIDTH; STEMS =/+ 20' LENGTH
2. ALL WOOD MATERIALS WILL BE NATIVE CONIFER (E.G. DOGLAS-FIR, WESTERN RED CEDAR, OR SPRUCE) WITH BARK INTACT (NO PEELED LOGS).
3. KEY LOG TIPS INTO BANK AND BURY WITH NATIVE FILL AND ROCK.
4. LOCATIONS AS LOCATED IN THE FIELD.

REFERENCE NUMBER:

APPLICANT NAME:

WASHINGTON DEPT. of FISH & WILDLIFE

PROPOSED PROJECT:

ACCESS RENOVATION

LOCATION: LELAND LAKE

SHEET 4 OF 14

DATE: 12/21/2018

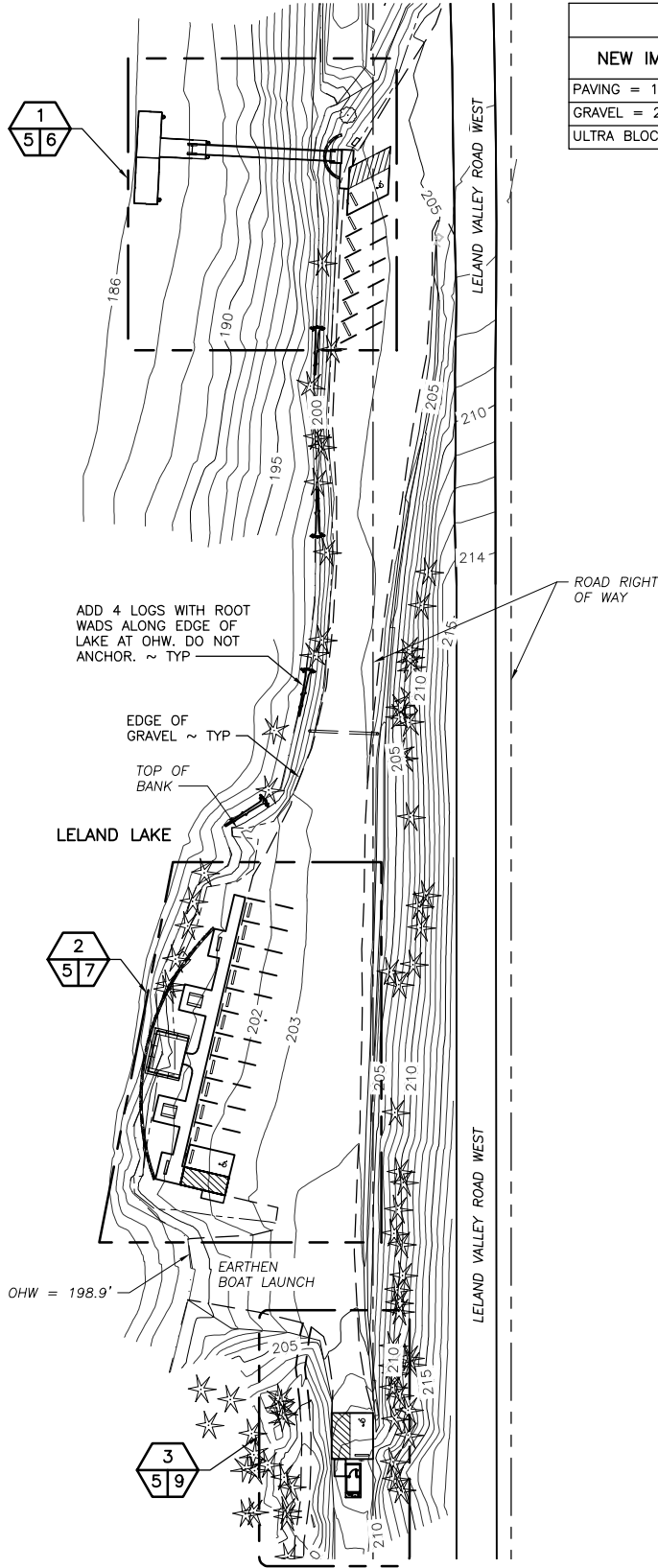
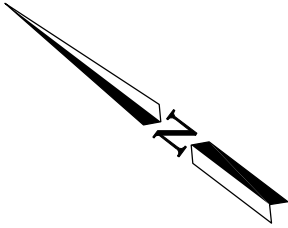

IMPERVIOUS AREAS	
NEW IMPACTED AREA	IMPACTED OVER EXISTING
PAVING = 1,156 SQ.FT.	PAVING = 1,375 SQ.FT.
GRAVEL = 246 SQ.FT.	GRAVEL = 317 SQ.FT.
ULTRA BLOCKS = 48 SQ.FT.	20 WHEELSTOPS

NEW SITE PLAN
SCALE: 1" = 40'

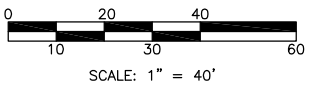

IMPERVIOUS SURFACE	
EXISTING IMPERVIOUS SURFACE TOTAL:	25,385 SQ.FT.
PROPOSED IMPERVIOUS SURFACE TOTAL:	26,835 SQ.FT.

REFERENCE NUMBER:
 APPLICANT NAME:
 WASHINGTON DEPT. of FISH & WILDLIFE
 PROPOSED PROJECT:
 ACCESS RENOVATION
 LOCATION: LELAND LAKE
 SHEET 5 OF 14 DATE: 12/21/2018

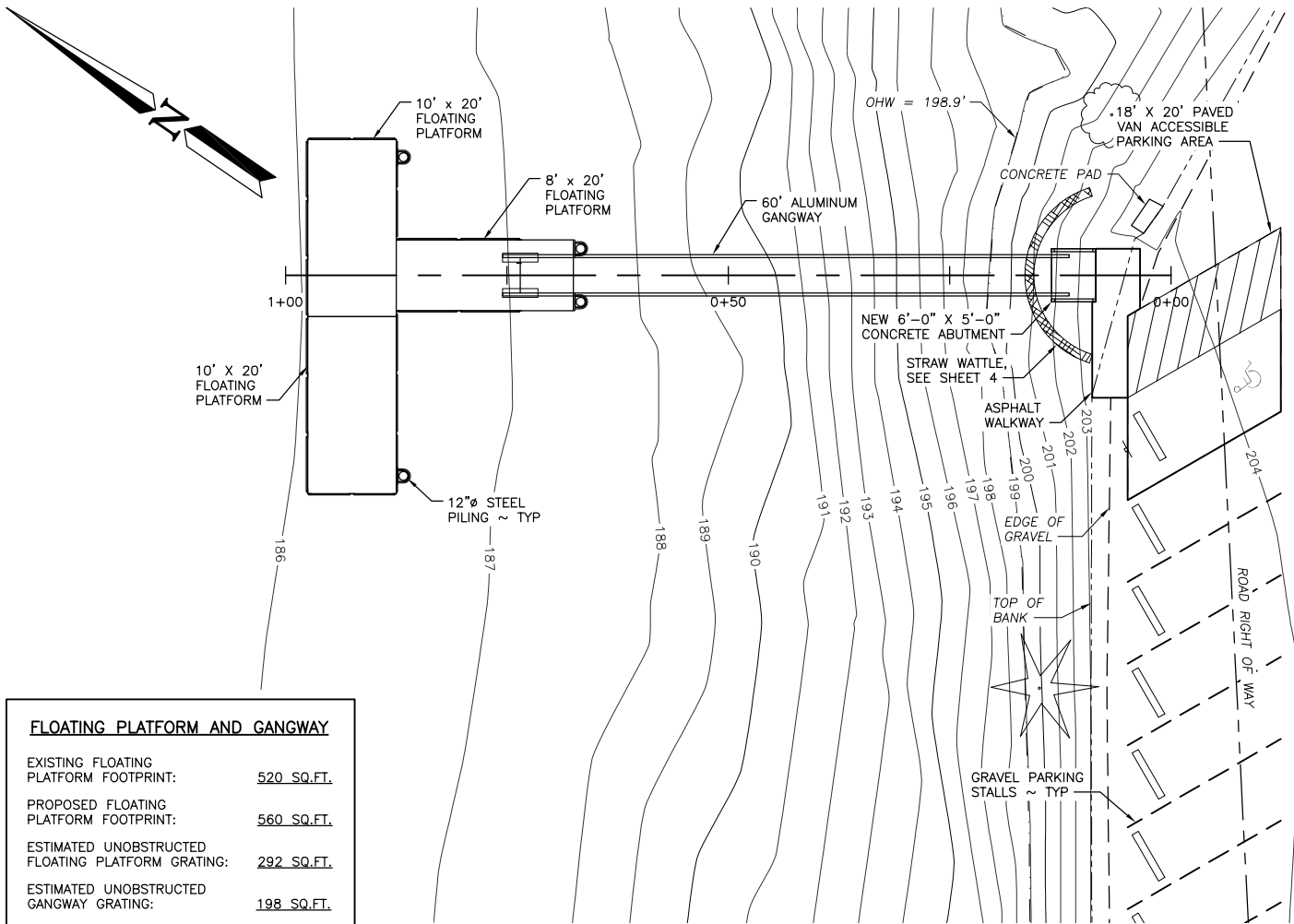

FLOATING PLATFORM AND GANGWAY	
EXISTING FLOATING PLATFORM FOOTPRINT:	520 SQ.FT.
PROPOSED FLOATING PLATFORM FOOTPRINT:	560 SQ.FT.
ESTIMATED UNOBSTRUCTED FLOATING PLATFORM GRATING:	292 SQ.FT.
ESTIMATED UNOBSTRUCTED GANGWAY GRATING:	198 SQ.FT.

FLOATING PLATFORM

SCALE: 1" = 20'

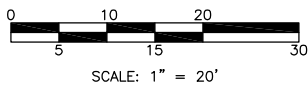
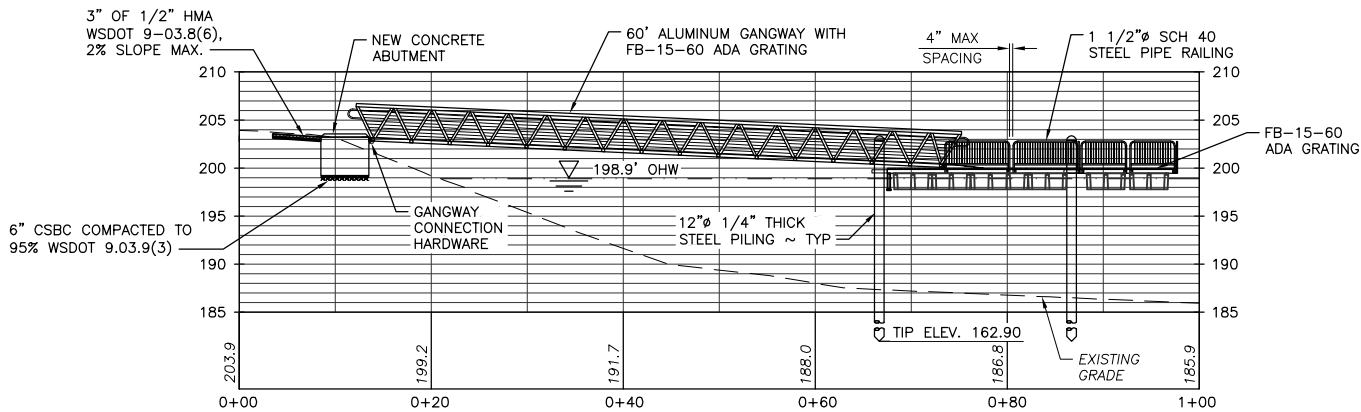

FLOATING PLATFORM PROFILE

SCALE: 1" = 20'

ABUTMENT CUT & FILL DATA cu.yd.		
MATERIAL	CUT ABOVE OHW	FILL ABOVE OHW
CONCRETE	4.24	4.44
GRAVEL CSBC	0.00	0.56
NATIVE SOIL	0.76	0.00
TOTAL CUT/FILL	5.00	5.00

REFERENCE NUMBER:
 APPLICANT NAME:
 WASHINGTON DEPT. of FISH & WILDLIFE
 PROPOSED PROJECT:
 ACCESS RENOVATION
 LOCATION: LELAND LAKE
 SHEET 6 OF 14 DATE: 12/21/2018

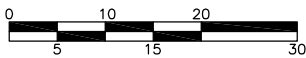
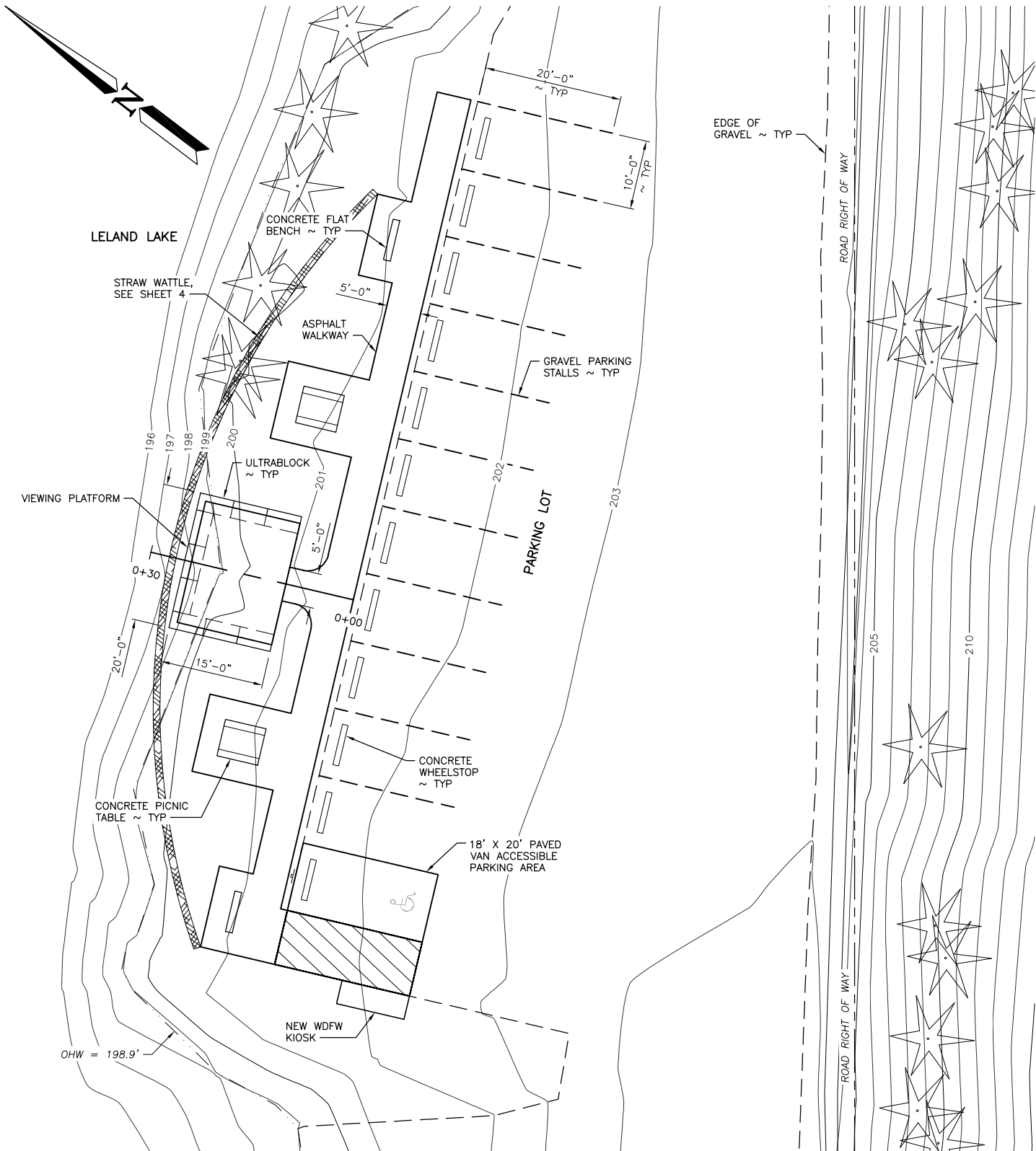

SCALE: 1" = 20'

DETAIL
SCALE: 1" = 20'

2
57

REFERENCE NUMBER:
 APPLICANT NAME:
 WASHINGTON DEPT. of FISH & WILDLIFE
 PROPOSED PROJECT:
 ACCESS RENOVATION
 LOCATION: LELAND LAKE
 SHEET 7 OF 14 DATE: 12/21/2018

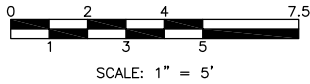
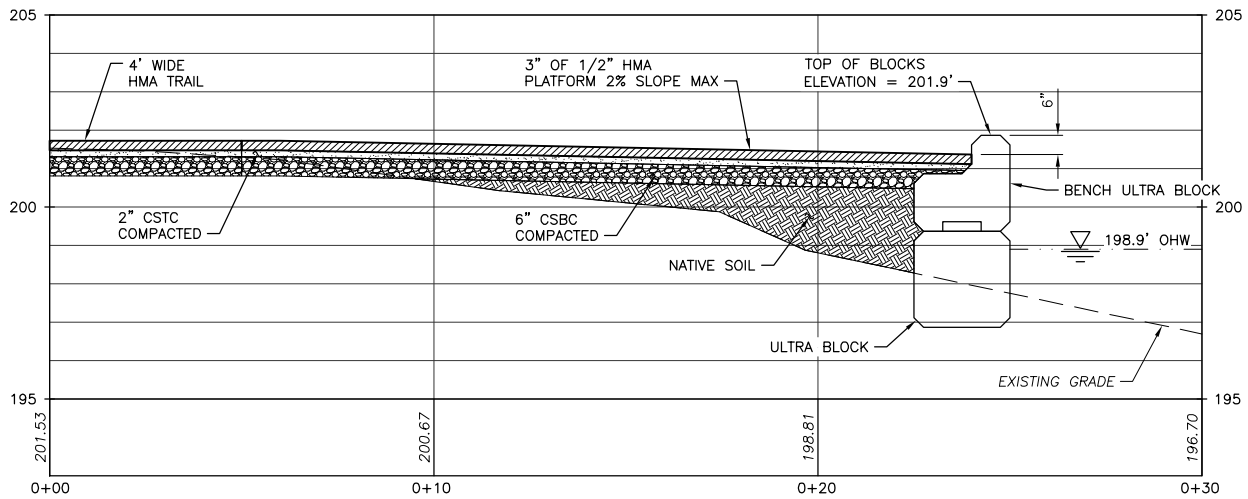

PLATFORM PROFILE

SCALE: 1" = 5'

PLATFORM CUT & FILL DATA cu.yd.

MATERIAL	CUT BELOW OHW	FILL BELOW OHW	CUT ABOVE OHW	FILL ABOVE OHW
ASPHALT	0.00	0.00	0.00	2.33
ULTRA BLOCK	0.00	8.49	0.00	9.95
GRAVEL CSBC	0.00	0.00	0.00	4.27
GRAVEL CSTC	0.00	0.00	0.00	1.55
NATIVE SOIL	6.68	0.50	8.19	5.68
TOTAL CUT/FILL	6.68	8.99	8.19	23.78
NET	2.31 FILL		15.59 FILL	

VIEWING PLATFORM

VIEWING PLATFORM SIZE:	300 SQ.FT.
VIEWING PLATFORM FOOTPRINT OVER OHW:	81 SQ.FT.
VIEWING PLATFORM SHORELINE IMPACT LENGTH:	20.75 FT.

REFERENCE NUMBER:
 APPLICANT NAME:
WASHINGTON DEPT. of FISH & WILDLIFE
 PROPOSED PROJECT:
ACCESS RENOVATION
 LOCATION: **LELAND LAKE**
 SHEET **8** OF **14** DATE: **12/21/2018**

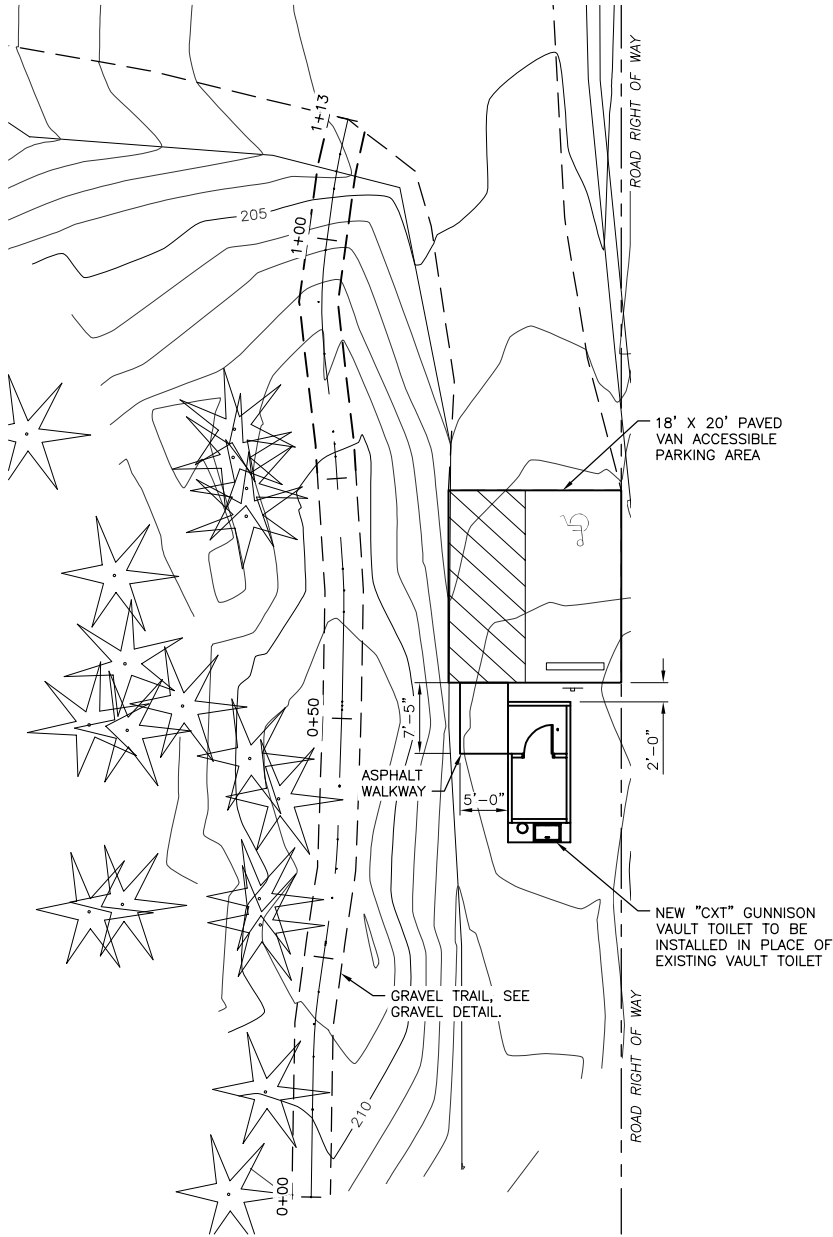
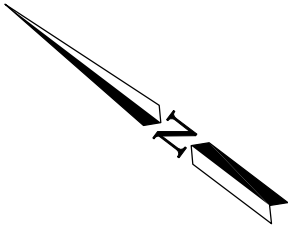

DETAIL
SCALE: 1" = 20'

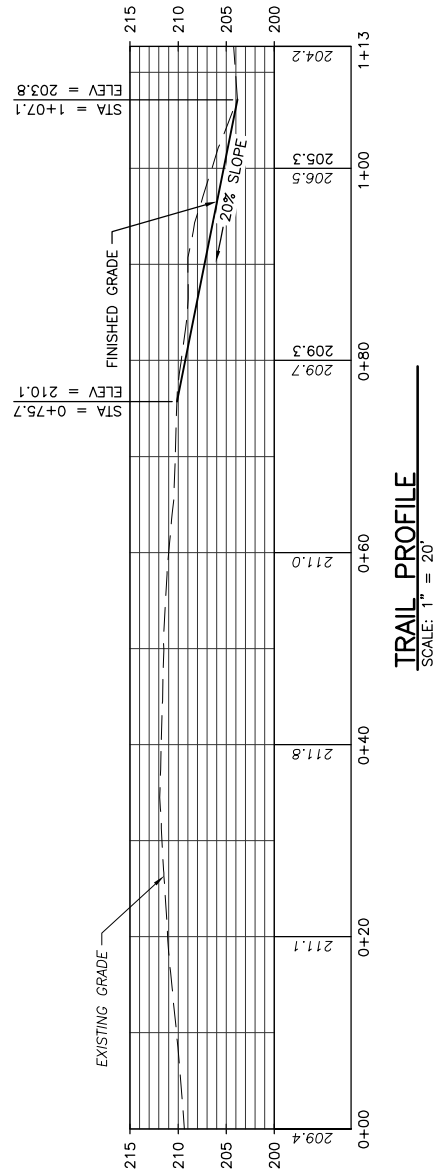
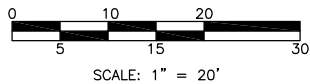

TRAIL PROFILE
SCALE: 1" = 20'

FLOATING PLATFORM LIGHT PENETRATION DATA

FLOATING PLATFORM SIZE	NUMBER OF FLOATING PLATFORMS	UNOBSTRUCTED SURFACE GRATING (SQ.FT.)	OPEN AREA OF GRATING MATERIAL (%)
10' X 20'	2	106.00	62%
8' X 20'	1	80.00	62%

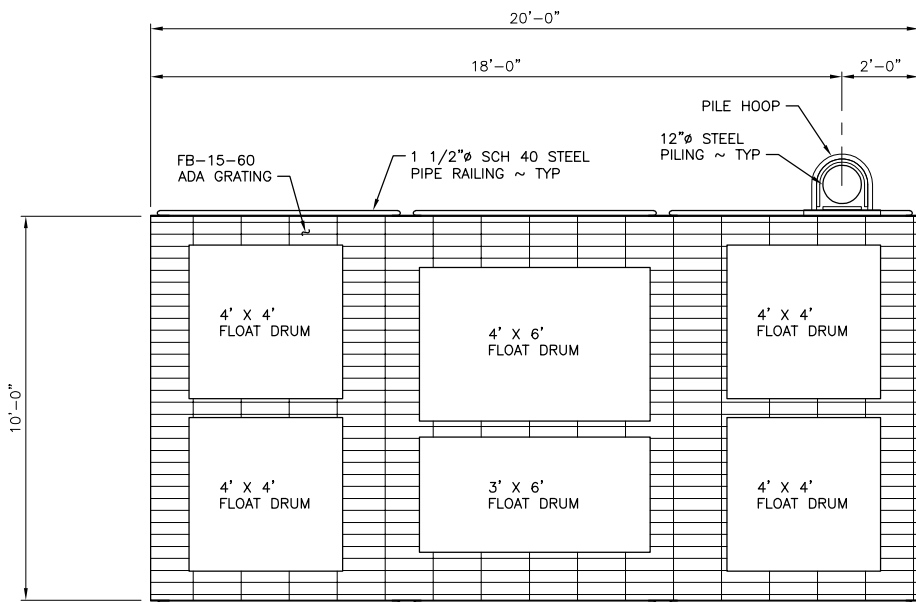

FLOATING PLATFORM PLAN

SCALE: 1" = 5'

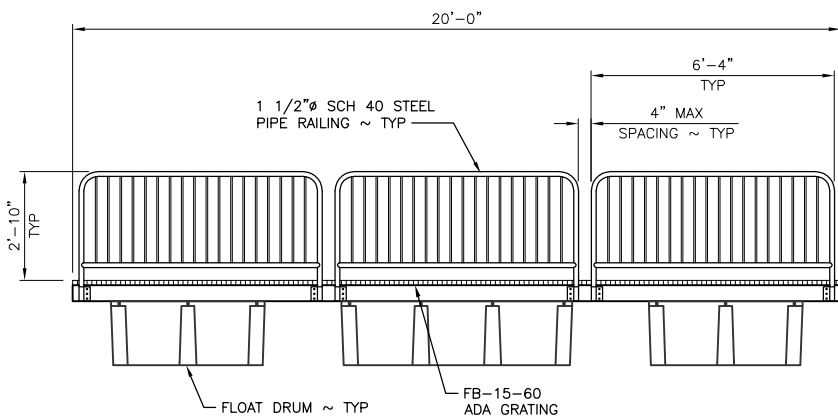

FLOATING PLATFORM ELEVATION

SCALE: 1" = 5'

REFERENCE NUMBER:
 APPLICANT NAME:
 WASHINGTON DEPT. of FISH & WILDLIFE
 PROPOSED PROJECT:
 ACCESS RENOVATION
 LOCATION: LELAND LAKE
 SHEET 10 OF 14 DATE: 12/21/2018

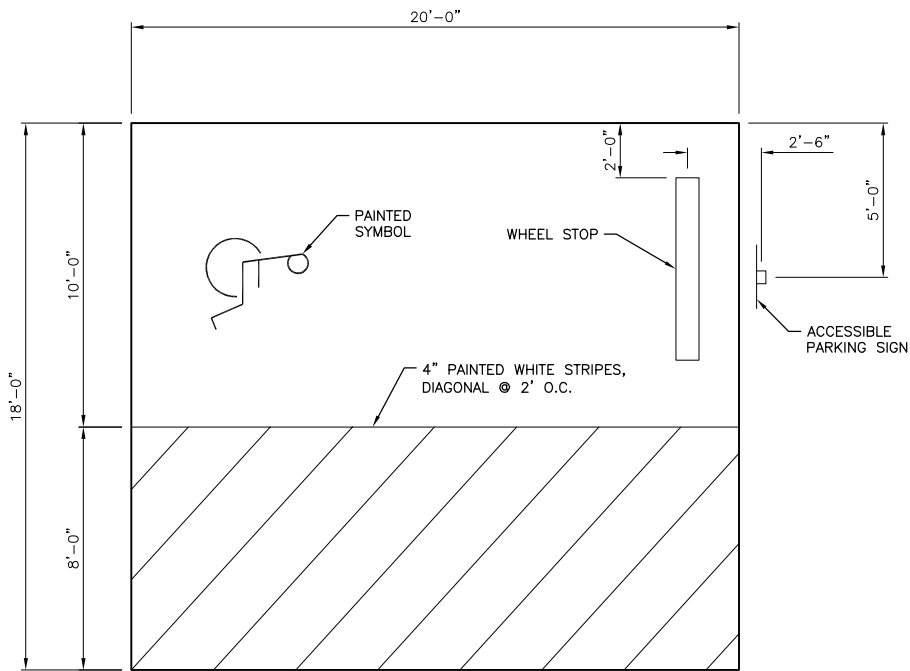

**VAN ACCESSIBLE
PARKING AREA**
NOT TO SCALE

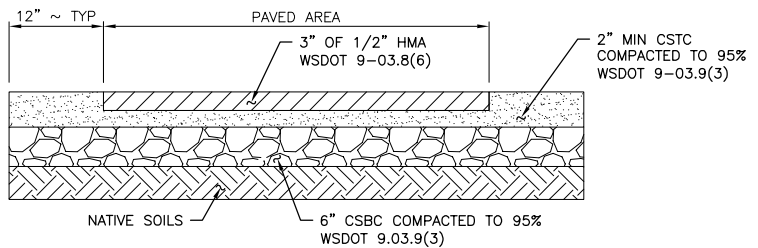

TYPICAL HMA DETAIL
NOT TO SCALE

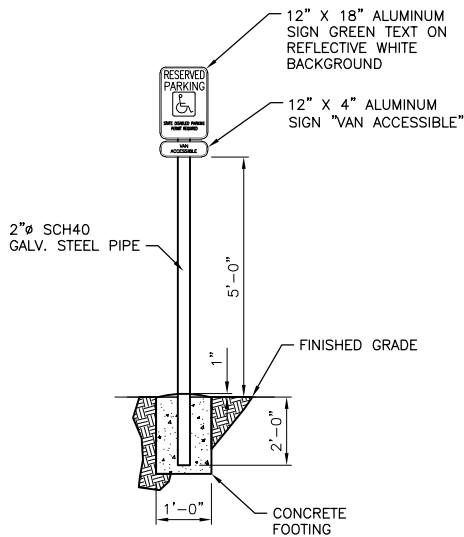

ACCESSIBLE PARKING SIGN
NOT TO SCALE

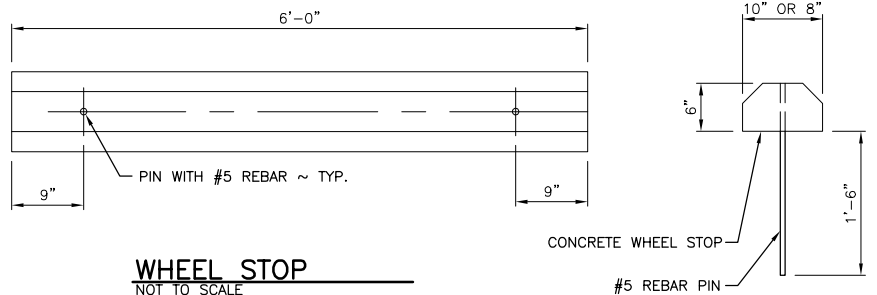

WHEEL STOP
NOT TO SCALE

REFERENCE NUMBER:
 APPLICANT NAME:
 WASHINGTON DEPT. of FISH & WILDLIFE
 PROPOSED PROJECT:
 ACCESS RENOVATION
 LOCATION: LELAND LAKE
 SHEET 11 OF 14 DATE: 12/21/2018

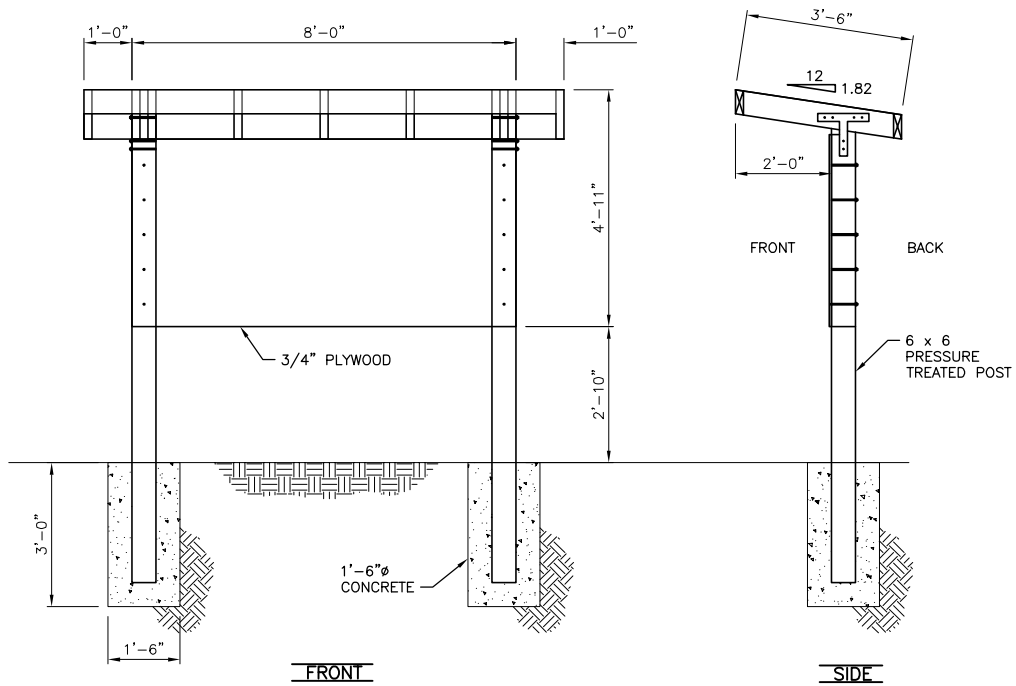

INFORMATION KIOSK #BBK-2

NOT TO SCALE

NOTE:

1. POST TO BE PLUMB AND LEVEL ALL DIRECTIONS.
2. ASSEMBLY OF POSTS, PLYWOOD, ROOF AND INSTALLATION BY CONTRACTOR.
3. KIOSK PACKAGE BBK-2 TO BE PROVIDED BY OTHERS.

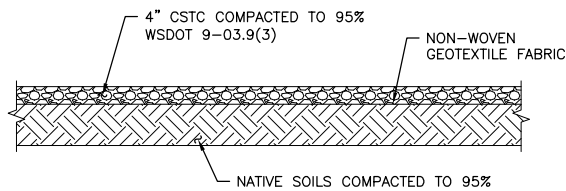

GRAVEL DETAIL

NOT TO SCALE

REFERENCE NUMBER:
 APPLICANT NAME:
 WASHINGTON DEPT. of FISH & WILDLIFE
 PROPOSED PROJECT:
 ACCESS RENOVATION
 LOCATION: LELAND LAKE
 SHEET 12 OF 14 DATE: 12/21/2018

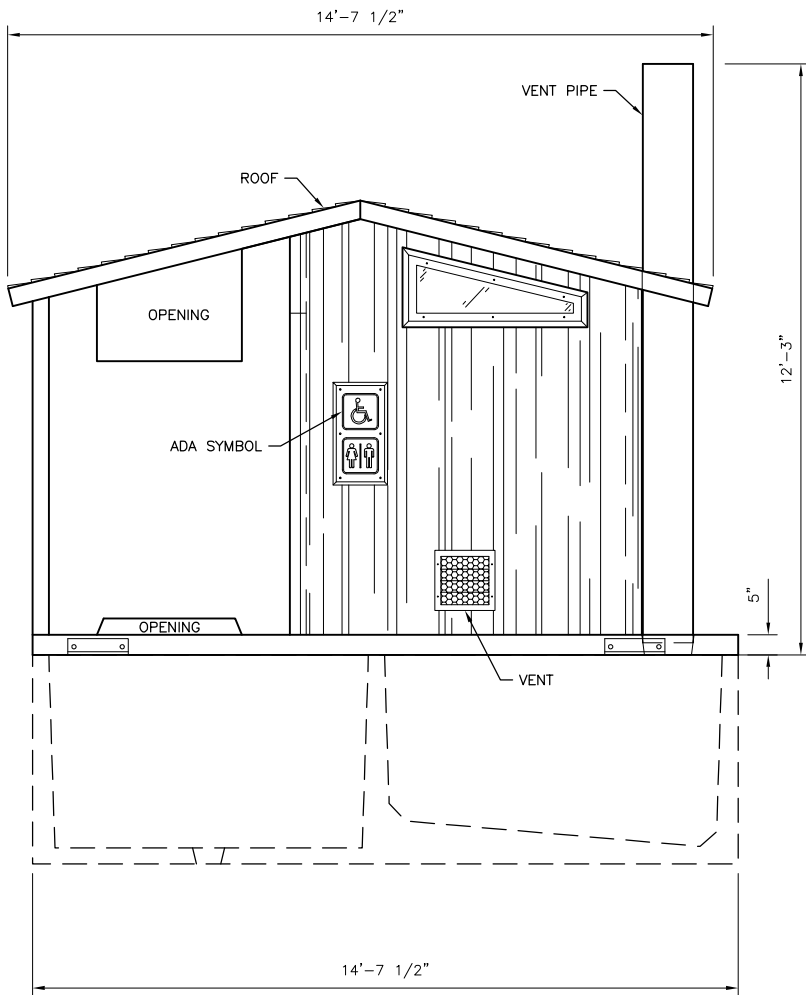

FRONT ELEVATION
NOT TO SCALE

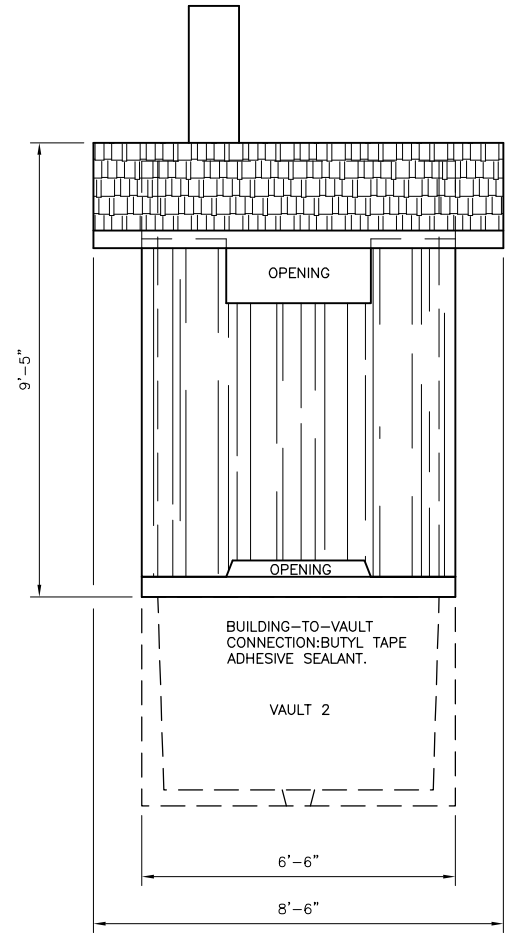

SIDE ELEVATION
NOT TO SCALE

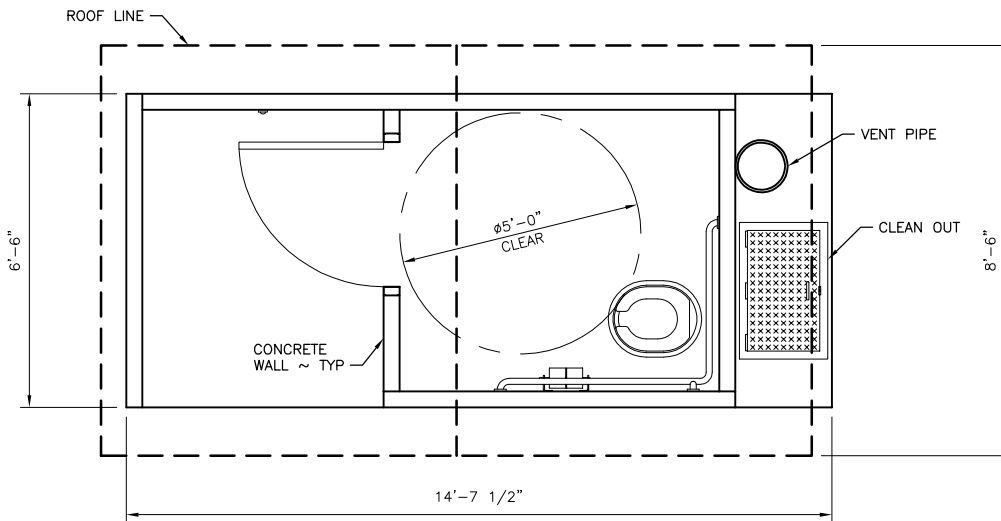

CXT VAULT TOILET PLAN
NOT TO SCALE

NOTE:

REPLACE EXISTING CONCRETE VAULT TOILET WITH NEW CXT GUNNISON CONCRETE VAULT TOILET IN SAME FOOTPRINT.

REFERENCE NUMBER:

APPLICANT NAME:

WASHINGTON DEPT. of FISH & WILDLIFE

PROPOSED PROJECT:

ACCESS RENOVATION

LOCATION: LELAND LAKE

SHEET 13 OF 14

DATE: 12/21/2018

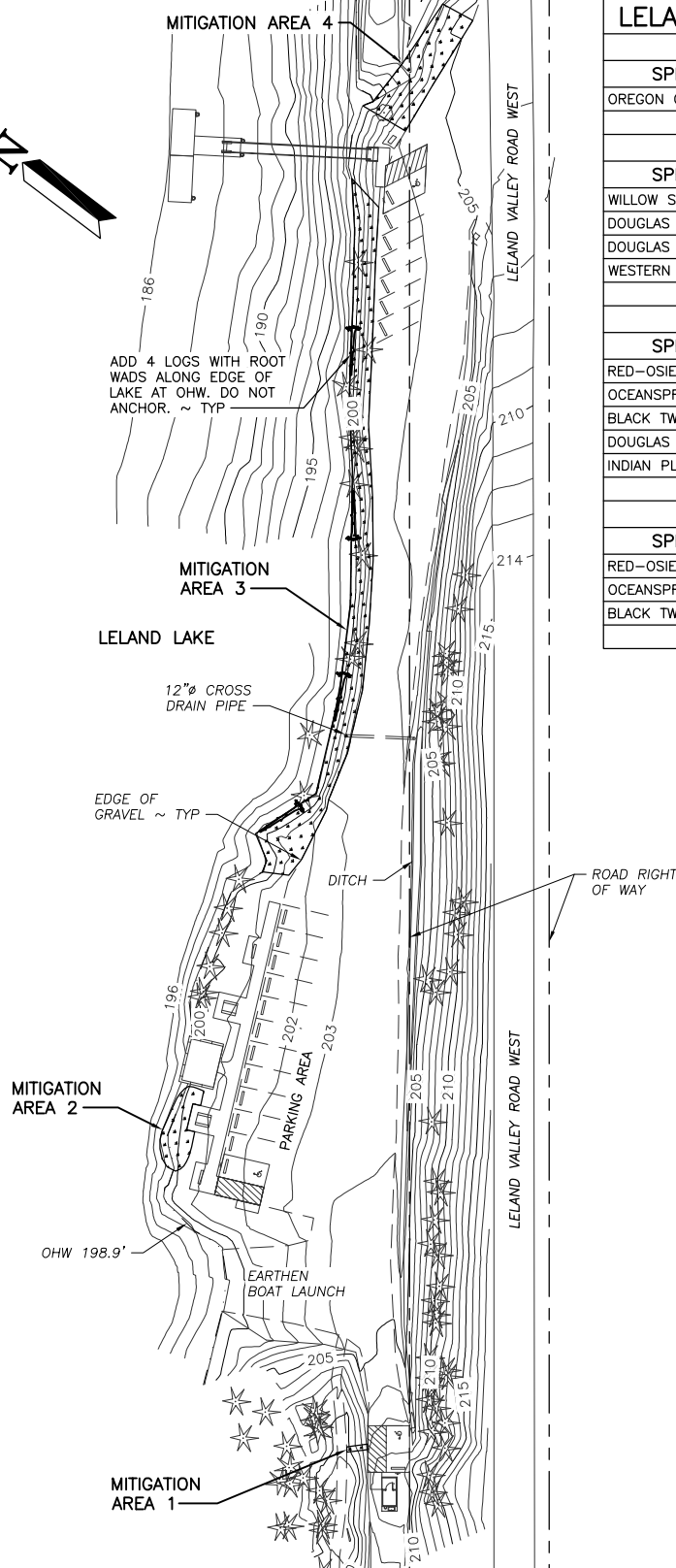
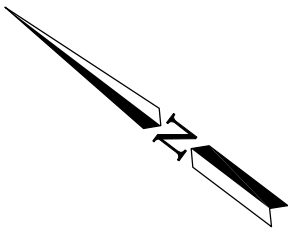

MITIGATION PLAN

SCALE: 1" = 80'



SCALE: 1" = 80'

LELAND LAKE ACCESS RENOVATION PLANTINGS

MITIGATION AREA 1 – 20 SQ.FT.

SPECIES	SIZE	QUANTITY	SPACING	REMARKS
OREGON GRAPE	PLUGS	25	1 FT OC	

MITIGATION AREA 2 – 375 SQ.FT.

SPECIES	SIZE	QUANTITY	SPACING	REMARKS
WILLOW SPP.	LIVE STAKES	30	1 FT OC	PLANT NEAR OHWM
DOUGLAS SPIREA	1 GAL	12	3 FT OC	PLANT UPLAND OF WILLOWS
DOUGLAS FIR	1 GAL	5	6 FT OC	PLANT UPLAND OF SPIREA
WESTERN RED CEDAR	1 GAL	5	6 FT OC	PLANT UPLAND OF SPIREA

MITIGATION AREA 3 – 1,900 SQ.FT.

SPECIES	SIZE	QUANTITY	SPACING	REMARKS
RED-OSIER DOGWOOD	1 GAL	20	RANDOM	PLANT ABOVE OHWM
OCEANSPRAY	1 GAL	20	RANDOM	PLANT ABOVE OHWM
BLACK TWINBERRY	1 GAL	20	RANDOM	PLANT ABOVE OHWM
DOUGLAS SPIREA	1 GAL	20	RANDOM	PLANT ABOVE OHWM
INDIAN PLUM	1 GAL	20	RANDOM	PLANT ABOVE OHWM

MITIGATION AREA 4 – 900 SQ.FT.

SPECIES	SIZE	QUANTITY	SPACING	REMARKS
RED-OSIER DOGWOOD	1 GAL	10	5 FT OC	
OCEANSPRAY	1 GAL	10	5 FT OC	
BLACK TWINBERRY	1 GAL	10	5 FT OC	

REFERENCE NUMBER:

APPLICANT NAME:

WASHINGTON DEPT. of FISH & WILDLIFE

PROPOSED PROJECT:

ACCESS RENOVATION

LOCATION: LELAND LAKE

SHEET 14 OF 14

DATE: 12/21/2018