

PROJECT LOCATION
STATE MAP
NOT TO SCALE

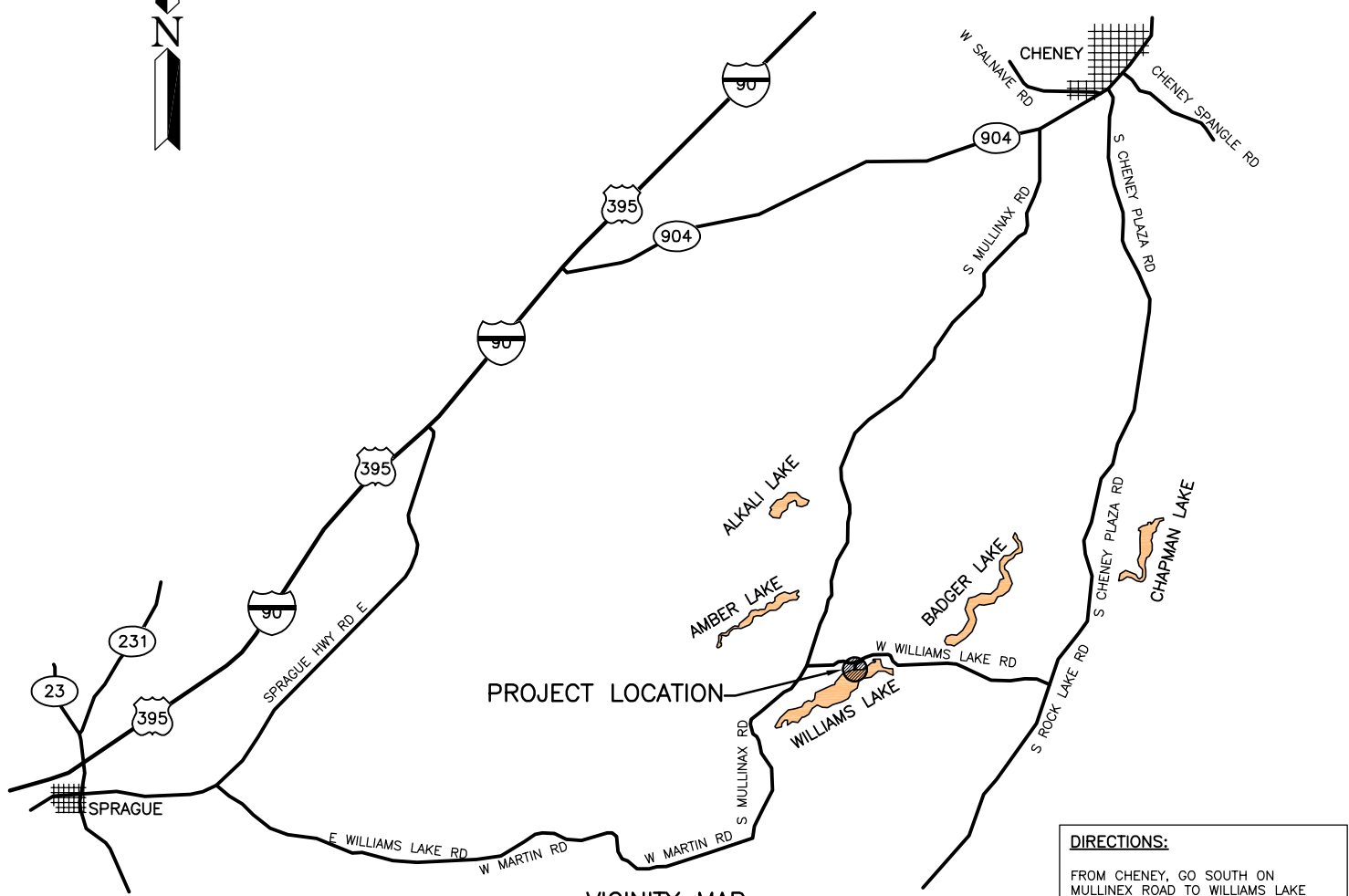

PROJECT LOCATION
VICINITY MAP
NOT TO SCALE

DIRECTIONS:
FROM CHENEY, GO SOUTH ON MULLINEX ROAD TO WILLIAMS LAKE ROAD, THEN EAST ON WILLIAMS LAKE ROAD 1 MILE TO PUBLIC FISHING SIGN.

ENG. PROJECT NO. SE:A435:18-1 PORTION OF: S. 6&7, T 21 N, R 41 E, DRAWN BY: A. JOHNSON

REFERENCE NUMBER:
APPLICANT:
WASHINGTON DEPT. of FISH & WILDLIFE
600 CAPITOL WAY N.
OLYMPIA, WA 98501-1091

PROJECT LOCATION (ADDRESS):
WILLIAMS LAKE ACCESS
WILLIAMS LAKE RD
CHENEY, WA 99004

PROPOSED PROJECT:
ACCESS REDEVELOPMENT

ADJACENT PROPERTY OWNER:
1.
2.

LAT/LONG: 47.3330/-117.6777
DATUM: NAVD 88
SHEET 1 OF 15 DATE: 11/30/2018

IN: WILLIAMS LAKE
NEAR/AT: CHENEY
COUNTY: SPOKANE
STATE: WA

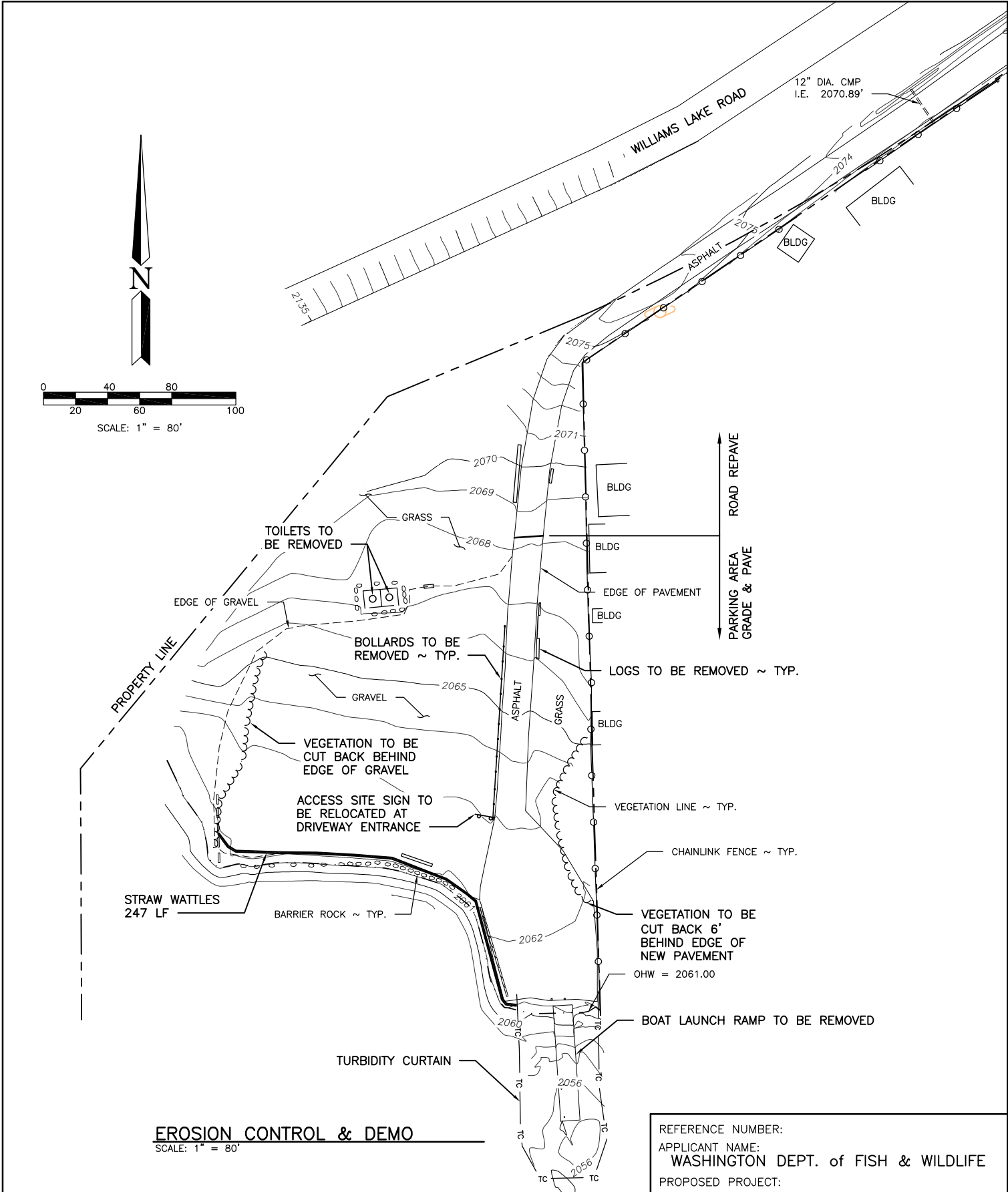

EROSION CONTROL & DEMO

SCALE: 1" = 80'

REFERENCE NUMBER:
 APPLICANT NAME:
 WASHINGTON DEPT. of FISH & WILDLIFE
 PROPOSED PROJECT:
 ACCESS REDEVELOPMENT
 LOCATION: WILLIAMS LAKE ACCESS
 SHEET 3 OF 15 DATE: 11/30/2018

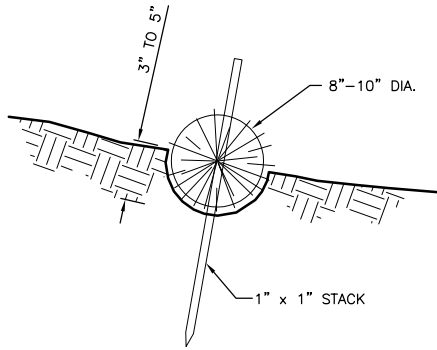

STRAW WATTLE DETAIL

NOT TO SCALE

CONSTRUCTION SPECIFICATIONS:

1. PREPARE THE SLOPE BEFORE THE WATTLING PROCEDURE IS STARTED.
2. SHALLOW GULLIES SHOULD BE SMOOTHED AS WORK PROGRESSES.
3. DIG SMALL TRENCHES ACROSS THE SLOPE ON CONTOUR, TO PLACE ROLLS IN. THE TRENCH SHOULD BE DEEP ENOUGH TO ACCOMMODATE HALF THE THICKNESS OF THE ROLL. WHEN THE SOIL IS LOOSE AND UNCOMPACTED, THE TRENCH SHOULD BE DEEP ENOUGH TO BURY THE ROLL 2/3 OF ITS THICKNESS BECAUSE THE GROUND WILL SETTLE.
4. IT IS CRITICAL THAT ROLLS ARE INSTALLED PERPENDICULAR TO WATER MOVEMENT, PARALLEL TO THE SLOPE CONTOUR.
5. START BUILDING TRENCHES AND INSTALL ROLLS FROM THE BOTTOM OF THE SLOPE AND WORK UP.
6. CONSTRUCT TRENCHES AT CONTOUR INTERVALS OF 3-12 FEET APART DEPENDING ON STEEPNESS OF SLOPE. THE STEEPER THE SLOPE, THE CLOSER TOGETHER THE TRENCHES.
1:1=10' 2:1=20' 3:1=30' 4:1=40'
7. LAY THE ROLL ALONG THE TRENCHES FITTING IT SNUGLY AGAINST THE SOIL. MAKE SURE NO GAPS EXIST BETWEEN THE SOIL AND THE STRAW WATTLE.
8. USE A STRAIGHT BAR TO DRIVE HOLES THROUGH THE WATTLE AND INTO THE SOIL FOR THE WILLOW OR WOODEN STAKES.
9. DRIVE THE STAKE THROUGH PREPARED HOLE INTO SOIL. LEAVE ONLY 1 OR 2 INCHES OF STAKE EXPOSED ABOVE ROLL.
10. IF USING WILLOW STAKES REFER TO LIVE STAKING BEST MANAGEMENT PRACTICES.
11. INSTALL STAKES AT LEAST EVERY 4 FEET APART THROUGH THE WATTLE. ADDITIONAL STAKES MAY BE DRIVEN ON THE DOWNSLOPE SIDE OF THE TRENCHES ON HIGHLY EROSION OR VERY STEEP SLOPES.
12. INSPECT THE STRAW ROLLS AND THE SLOPES AFTER SIGNIFICANT STORMS. MAKE SURE THE ROLLS ARE IN CONTACT WITH THE SOIL.
13. REPAIR ANY RILLS OR GULLYS PROMPTLY.
14. RESEED OR REPLANT VEGETATION IF NECESSARY UNTIL THE SLOPE IS STABILIZED.

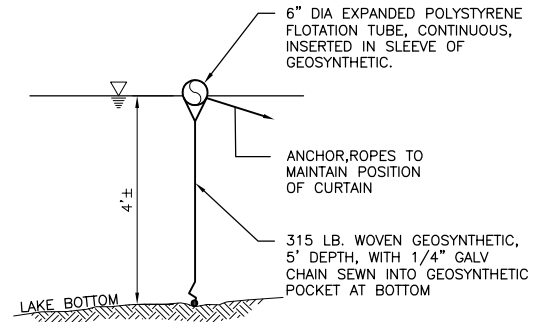

NOTES:

1. SILT CURTAIN AVAILABLE FROM NORTHWEST FININGS, KENT, WA.
2. GEOSYNTHETIC SHALL BE PERMEATEX 2315 OR EQUAL.

TURBIDITY CURTAIN

NOT TO SCALE

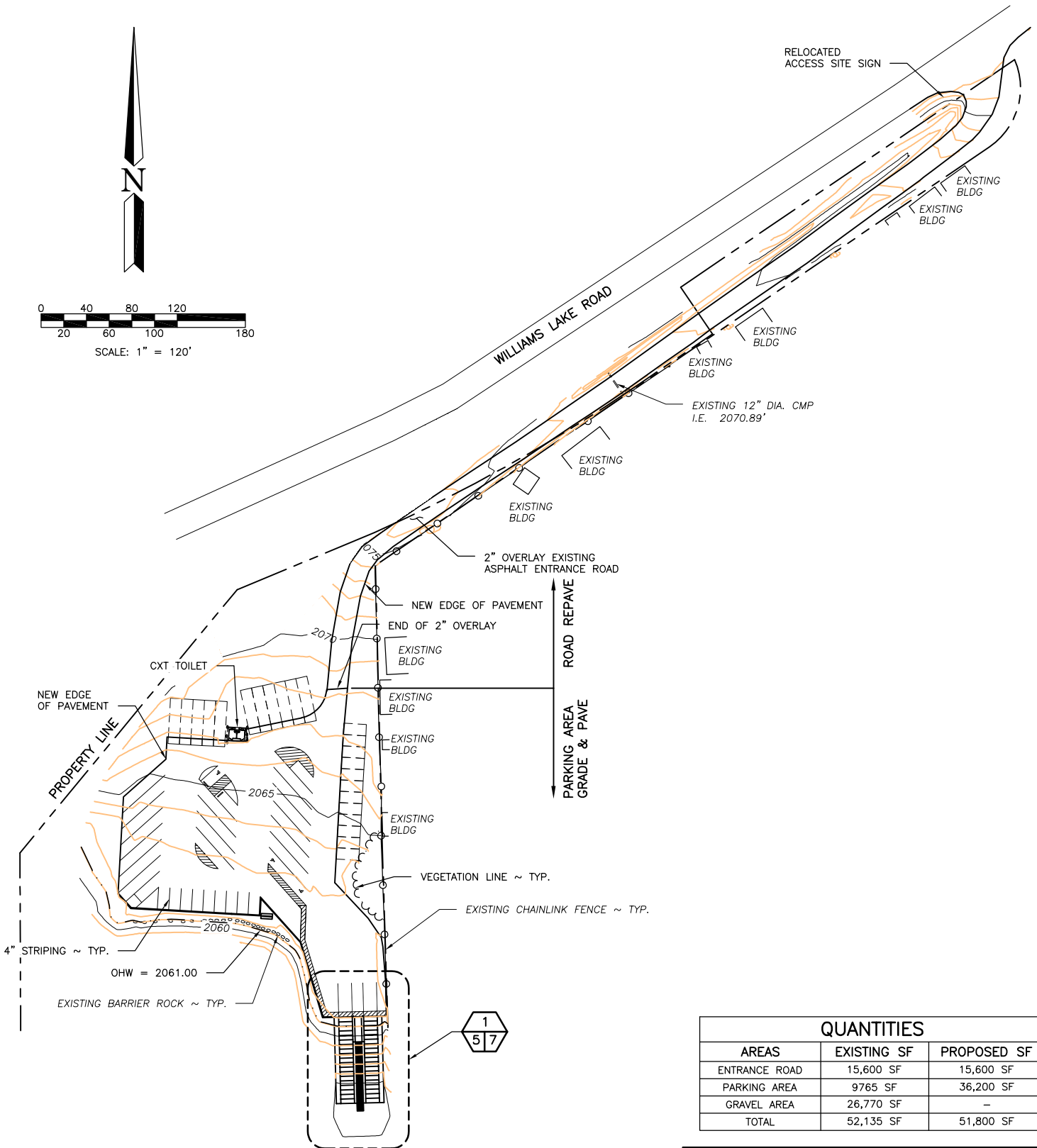
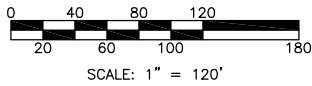

PROPOSED SITE
SCALE: 1" = 120'

QUANTITIES		
AREAS	EXISTING SF	PROPOSED SF
ENTRANCE ROAD	15,600 SF	15,600 SF
PARKING AREA	9765 SF	36,200 SF
GRAVEL AREA	26,770 SF	-
TOTAL	52,135 SF	51,800 SF

REFERENCE NUMBER:
 APPLICANT NAME:
 WASHINGTON DEPT. of FISH & WILDLIFE
 PROPOSED PROJECT:
 ACCESS REDEVELOPMENT
 LOCATION: WILLIAMS LAKE ACCESS
 SHEET 5 OF 15 DATE: 11/30/2018

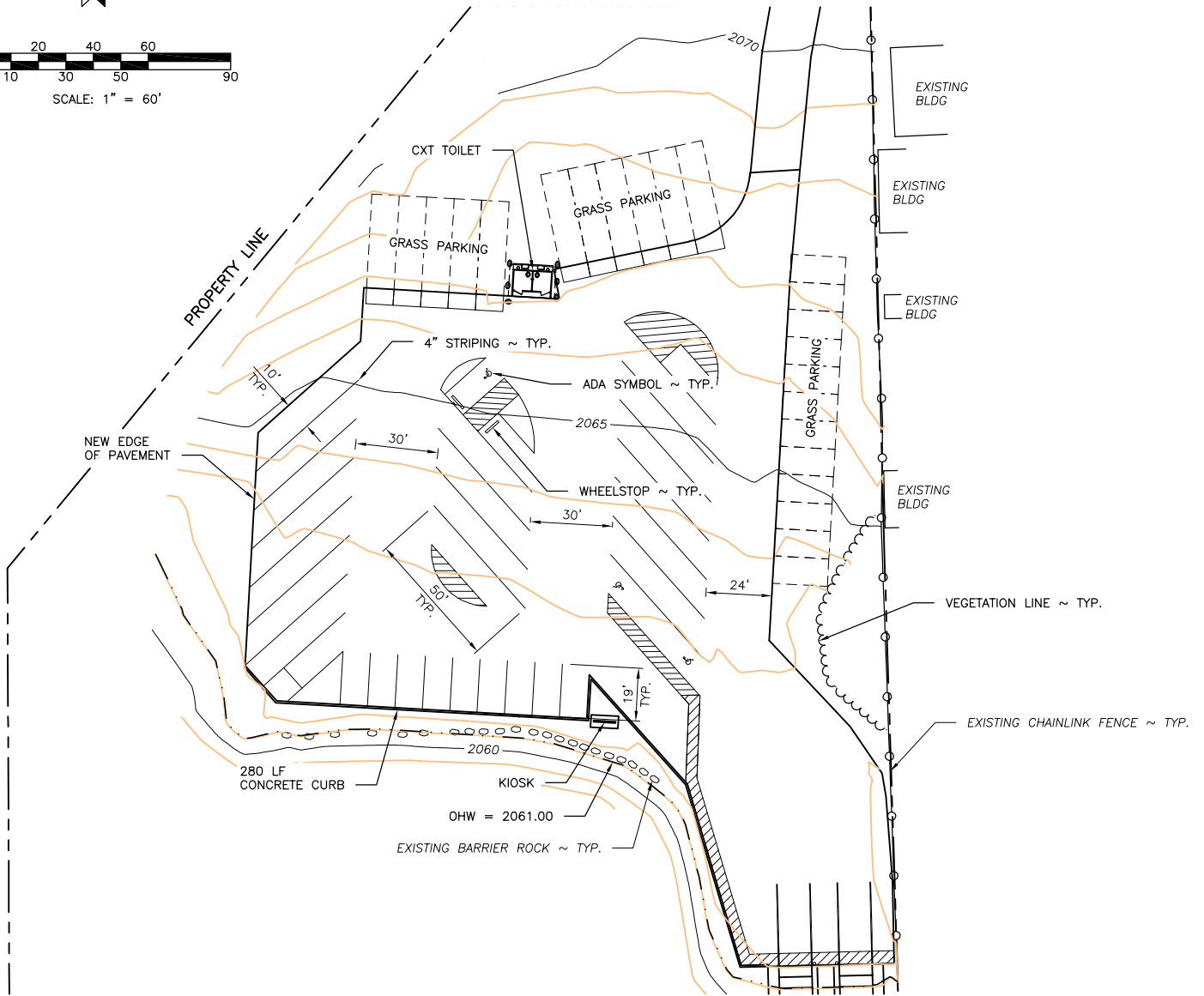
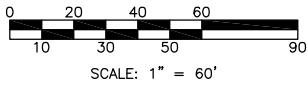

PARKING PLAN
SCALE: 1" = 60'

REFERENCE NUMBER:
APPLICANT NAME:
WASHINGTON DEPT. of FISH & WILDLIFE
PROPOSED PROJECT:
ACCESS REDEVELOPMENT
LOCATION: WILLIAMS LAKE ACCESS
SHEET 6 OF 15 DATE: 11/30/2018

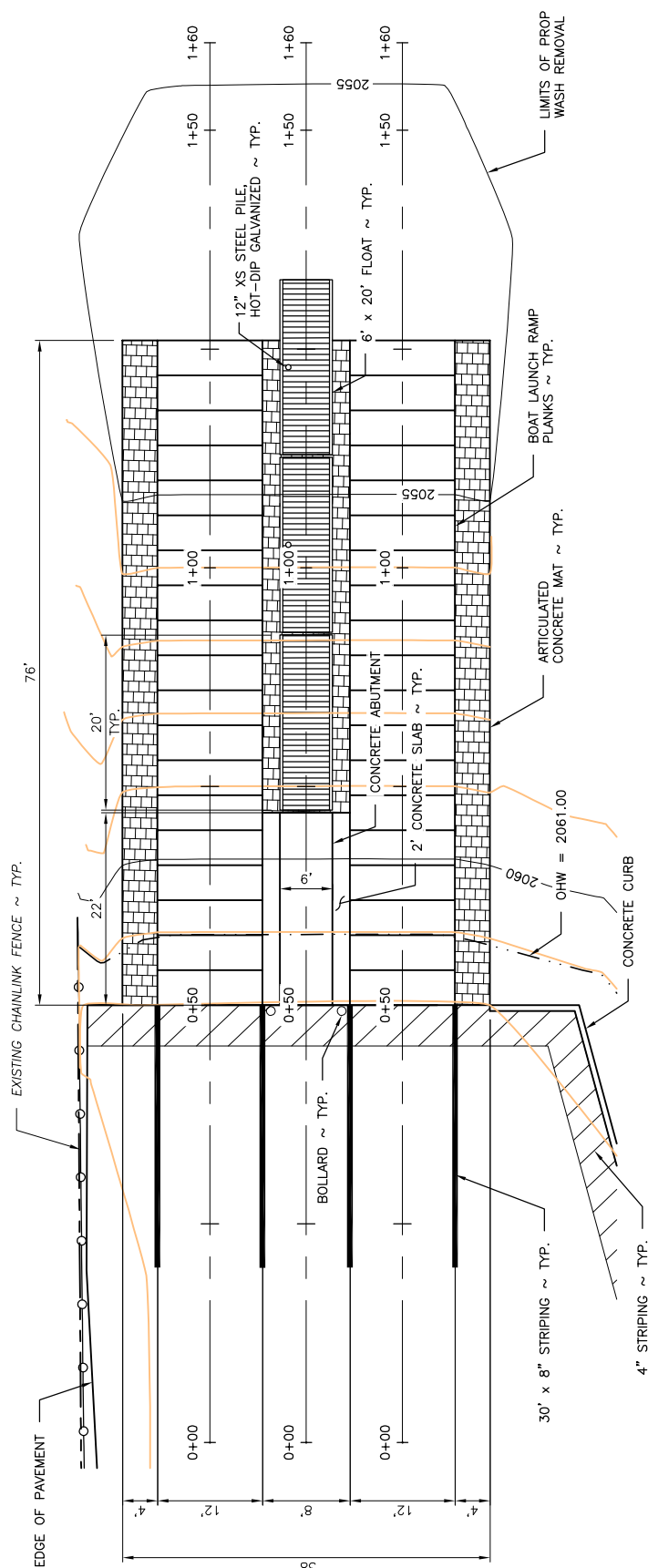

BOAT RAMP PLAN
 SCALE: 1" = 20'

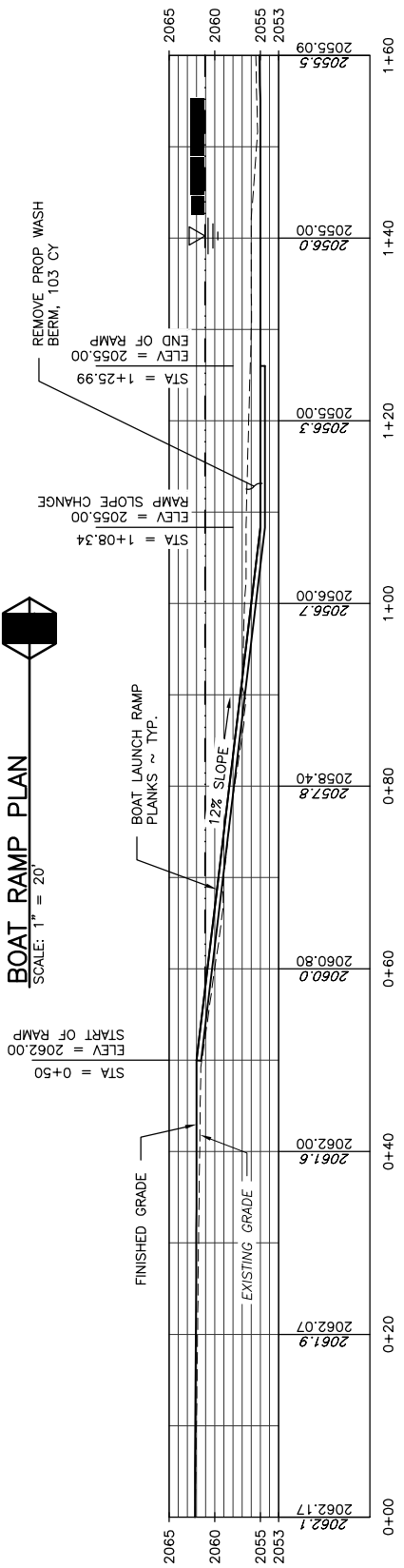

QUANTITIES

MATERIAL	BELOW OHW	ABOVE OHW
EXISTING RAMP PLANKS	812 SF/-15 CY	58 SF/-1 CY
CONCRETE RAMP PLANKS	1631 SF/12 CY	193 SF/4 CY
ARTICULATED CONCRETE MAT	1091 SF/21 CY	59 SF/1 CY
CONCRETE ABUTMENT	83 SF/3 CY	132 SF/4 CY
CONCRETE SLABS	56 SF/1 CY	33 SF/1 CY
BERM	2063 SF/-103 CY	-
TOTAL	-81 CY	9 CY

WEST BOAT RAMP PROFILE
 SCALE: 1" = 20'

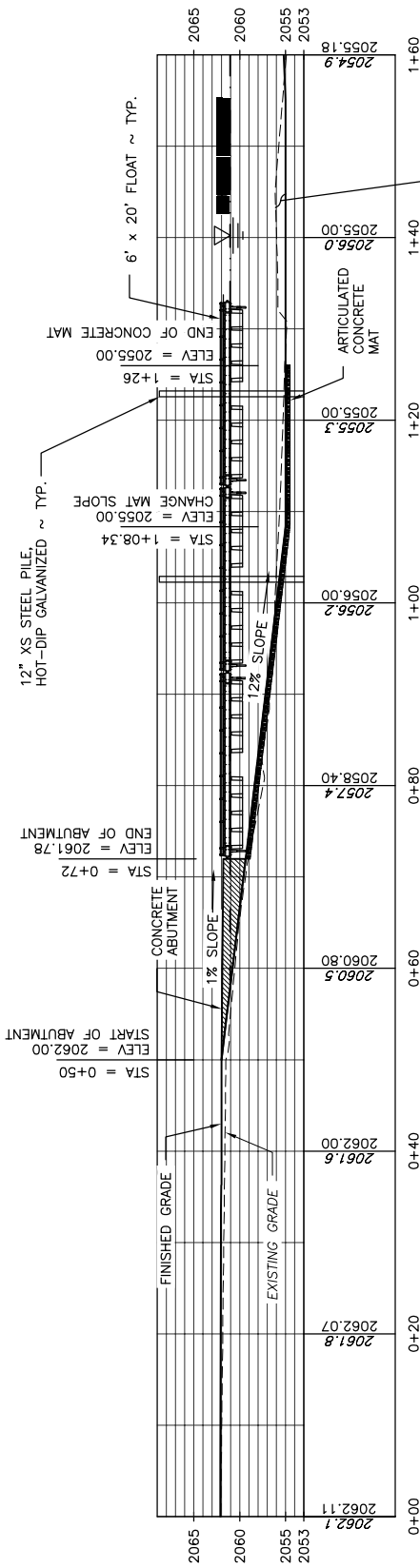

FLOAT & ABUTMENT PROFILE
SCALE: 1" = 20'

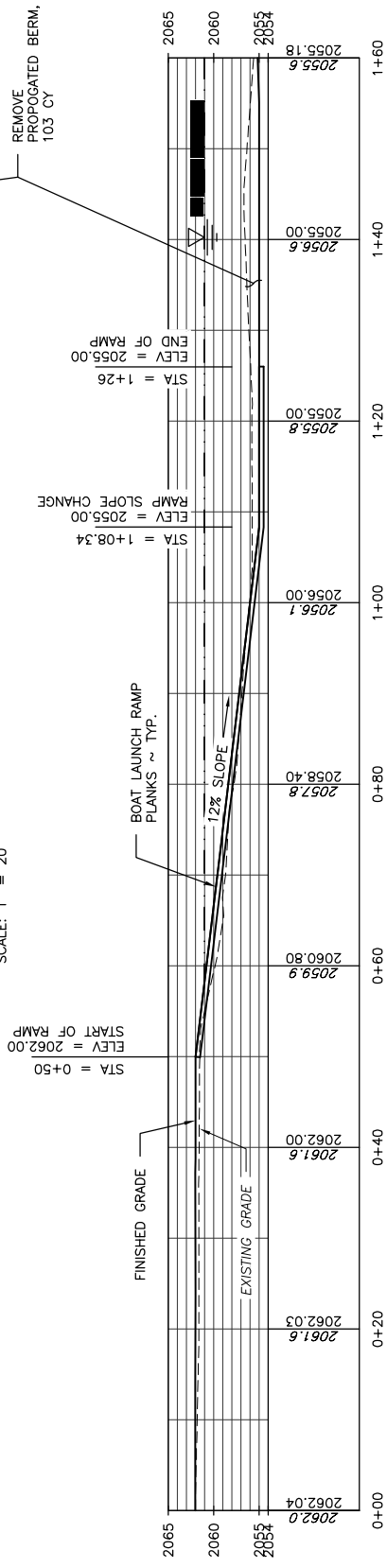

EAST BOAT RAMP PROFILE
SCALE: 1" = 20'

REFERENCE NUMBER:
 APPLICANT NAME:
 WASHINGTON DEPT. of FISH & WILDLIFE
 PROPOSED PROJECT:
 ACCESS REDEVELOPMENT
 LOCATION: WILLIAMS LAKE ACCESS
 SHEET 8 OF 15 DATE: 11/30/2018