

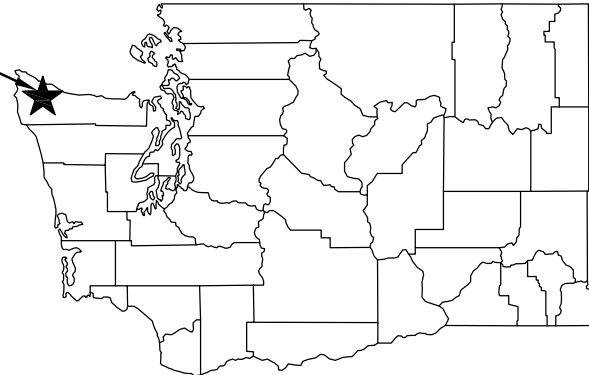

PROJECT
LOCATION

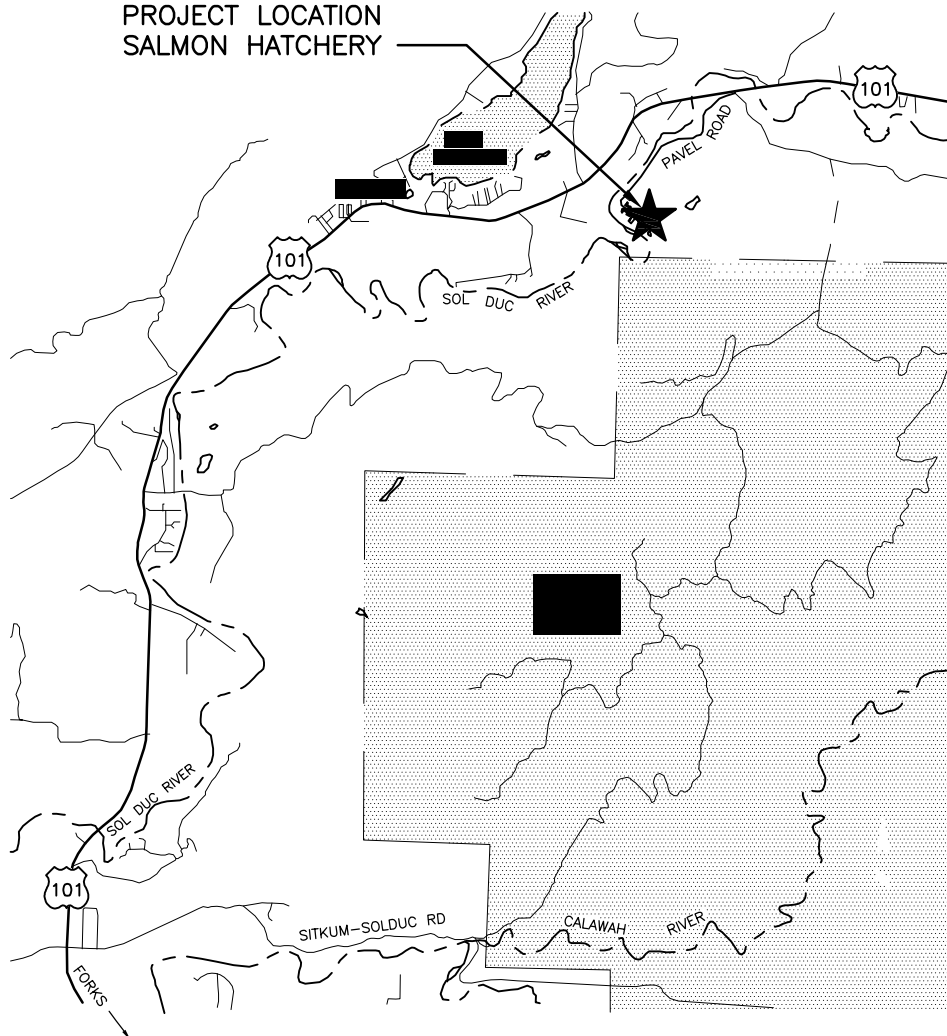

PROJECT LOCATION
SALMON HATCHERY



ADDRESS:
1426 PAVEL ROAD
BEAVER, WA, 98305

DIRECTIONS
FROM OLYMPIA, TAKE I-5 SOUTH TO EXIT 104 TO HWY 101. TAKE 101 TO HWY 8
THEN HWY 12 TO ABERDEEN THEN HOQUIAM TO HWY 101 AGAIN. STAY ON HWY
101 NORTH UNTIL YOU COME TO THE TOWN OF FORKS. ABOUT 11 MILES NORTH
OF FORKS YOU WILL SEE A SIGN FOR THE HATCHERY. TURN RIGHT AND STAY TO
THE RIGHT ONTO PAVEL ROAD, GO TO THE END OF THE ROAD TO THE HATCHERY.

SECTION 36, T. 30 N., R. 13 W.

NOT TO SCALE

**WASHINGTON STATE
DEPARTMENT OF FISH AND WILDLIFE**

DESIGNED BY _____
DRAWN BY S. ASHLER
DATE 12-03-18
FILE NAME A040181p

**SALMON HATCHERY - ACCESS
REDEVELOPMENT
VICINITY MAP**

PROJECT NO.
CM:A40:18-1

SHEET OF
1 1

APPROVED BY _____

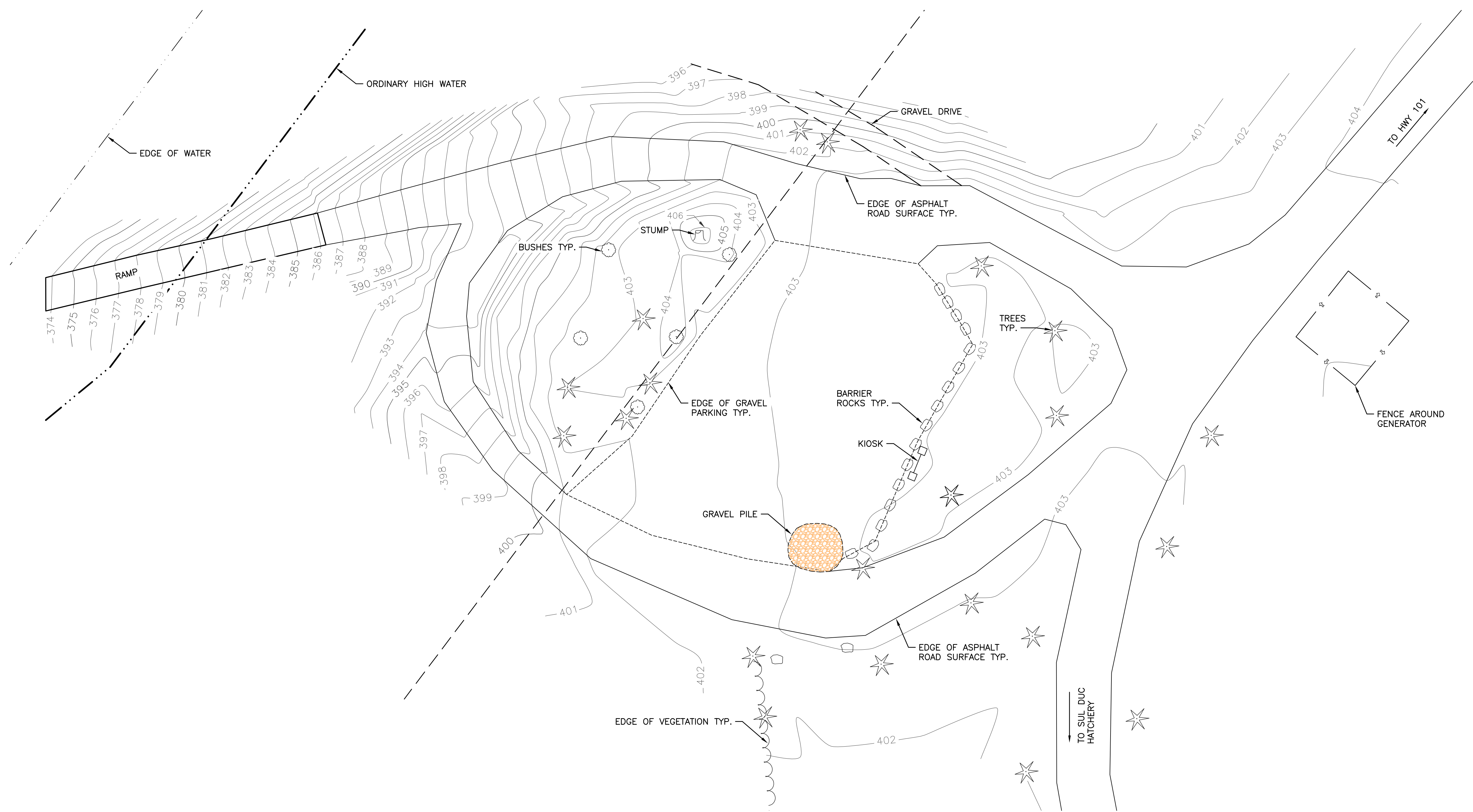
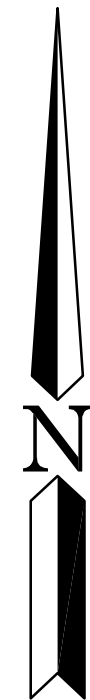

EXISTING SITE PLAN

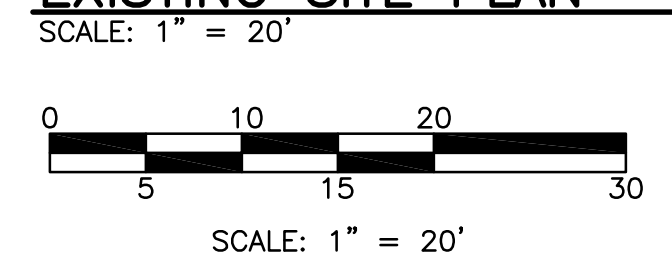

WASHINGTON STATE
DEPARTMENT OF FISH AND WILDLIFE

SYM	DATE	REVISION DESCRIPTION	BY
APPROVED AND RELEASED FOR CONSTRUCTION			
CHIEF ENGINEER		DATE:	
PROGRAM		DATE:	

DESIGNED BY	X
CHECKED BY	X
DRAWN BY	S. ASHLER
DATE	11-20-18

SALMON HATCHERY – ACCESS AREA
ACCESS REDEVELOPMENT
EXISTING SITE PLAN

PROJECT NO. CM:A040:18-1	
SHEET	OF
2	7

NOT APPROVED FOR CONSTRUCTION

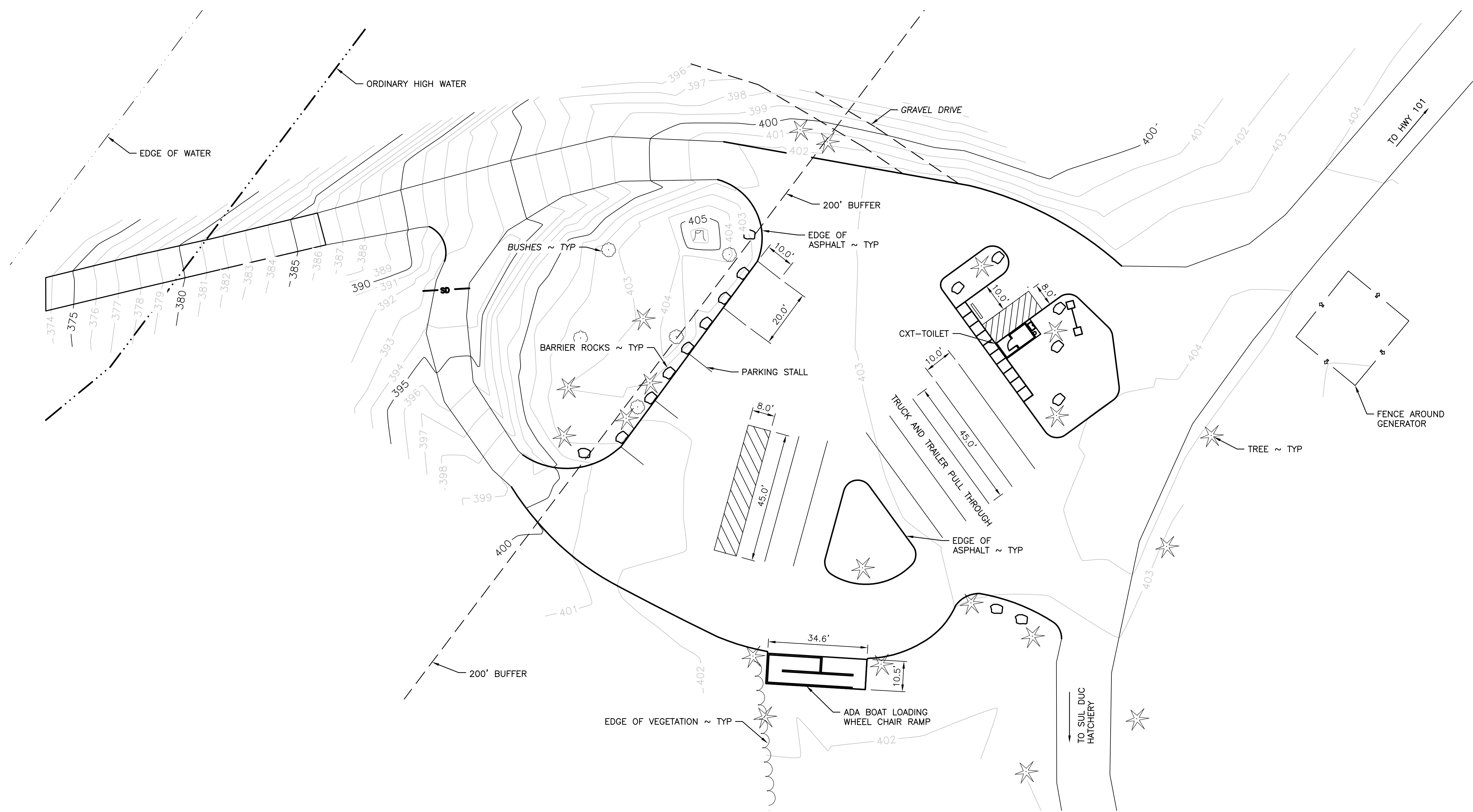
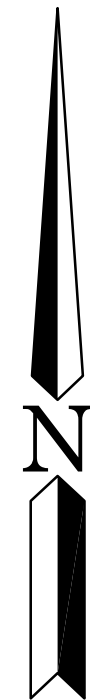

NEW SITE PLAN
 SCALE: 1" = 20'

SCALE: 1" = 20'

WASHINGTON STATE
DEPARTMENT OF FISH AND WILDLIFE

SYM	DATE	REVISION / DESCRIPTION	BY
APPROVED AND RELEASED FOR CONSTRUCTION			
CHIEF ENGINEER		DATE:	
PROGRAM		DATE:	
		DESIGNED BY <u> X </u>	
		CHECKED BY <u> X </u>	
		DRAWN BY <u> S. ASHLER </u>	
		DATE <u> 11-28-18 </u>	

SALMON HATCHERY – ACCESS AREA
ACCESS REDEVELOPMENT
NEW SITE PLAN

PROJECT NO. CM:A040:18-1	
SHEET 7	OF 9

NOT APPROVED FOR CONSTRUCTION